

\$\$\$\$\$\$SYTIME\$\$\$\$\$\$
 \$\$\$\$\$\$USER\$\$\$\$\$\$
 \$\$\$\$\$\$GN\$\$\$\$\$\$
 \$\$\$\$\$\$NAME\$\$\$\$\$\$

SOIL TEST RESULTS															
SAMPLE NO.	OFFSET	STATION	DEPTH INTERVAL	AASHTO CLASS.	LL	PL. I.	% BY WEIGHT				% PASSING SIEVES			% MOISTURE	% ORGANIC
							C. SAND	F. SAND	SILT	CLAY	10	40	200		
S-30	CL	200+60	0-2	A-6(6)	30	16	16	32.8	16.8	34.4	99	92	57		
S-37	CL	200+60	2-3.3	A-4	37	NP	10.3	50.2	19.2	20.2	100	97	50		
SS-32	40RT	201+60	1.14-1.44	A-7-5(22)	59	25	8.9	16	16.5	58.6	100	96	78		
SS-33	40RT	201+60	2.66-2.96	A-7-5(12)	52	22	19	27.7	24.9	28.3	96	85	59		
SS-34	20RT	202+70	0.0-0.3	A-7-6(6)	46	18	26.5	28.9	14.2	30.4	100	85	50		
SS-35	20RT	202+70	2.65-2.95	A-2-4(0)	32	NP	25.9	51.2	14.8	8.1	98	88	30		
SS-36	CL	203+80	1.0-1.3	A-6(5)	37	15	24.9	29.8	15	30.4	100	87	50		
SS-37	30RT	204+80	0.63-0.93	A-7-6(12)	54	26	24.7	18.2	10.5	46.6	96	84	56		
SS-38	30RT	204+80	2.14-2.44	A-2-4(0)	39	NP	33.4	38.4	20.1	8	96	75	35		
MS-39	30RT	204+80	6.8-7.1	A-2-4(0)										16.9	
SS-40	50LT	206+20	1.1-1.4	A-7-5(5)	54	12	9.3	43.5	21	26.2	100	98	58		
SS-41	50LT	206+20	2.62-2.92	A-5	51	NP	14.7	55.4	15.8	14.1	100	97	41		
SS-42	50LT	206+20	5.66-5.96	A-2-5(0)	41	NP	25	54.4	10.6	10.1	100	92	30		

(NC 16)

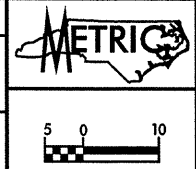

PROJECT REFERENCE NO.	SHEET NO.
R-2206C	54
ROADWAY DESIGN ENGINEER	HYDRAULICS ENGINEER
INCOMPLETE PLANS DO NOT USE FOR R/W ACQUISITION PRELIMINARY PLANS DO NOT USE FOR CONSTRUCTION	
CONST. REV.	
R/W REV.	

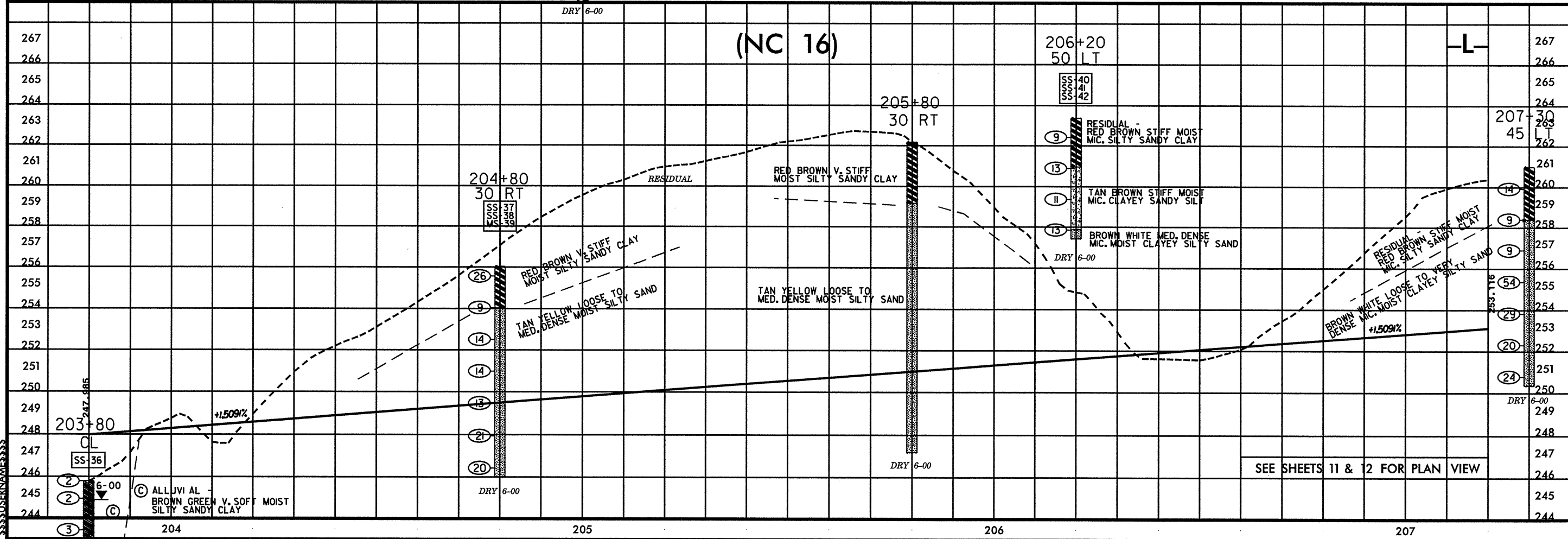
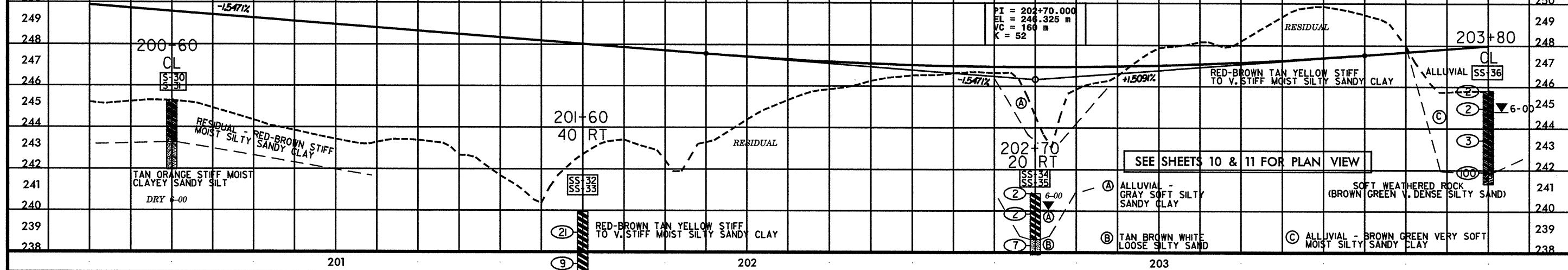

(NC 16)

SEE SHEETS 11 & 12 FOR PLAN VIEW