

222+80 222+90 223+00 223+10 223+20 223+30 223+40

F.A. PROJECT NO. STP-16(31)

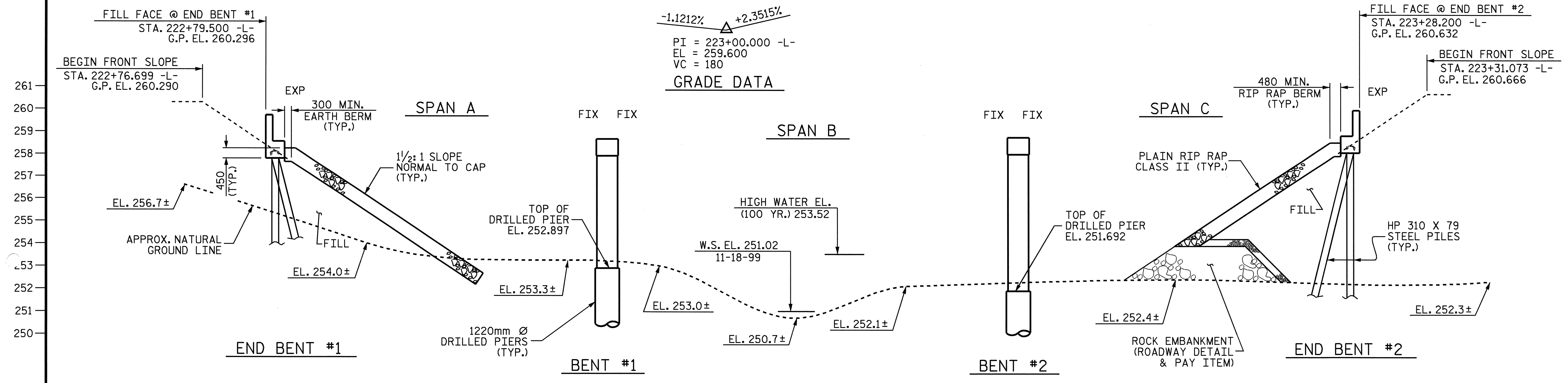

GRADE DATA
 -1.1212% +2.3515%
 PI = 223+00.000 -L-
 EL = 259.600
 VC = 180

SECTION ALONG CONTROL LINE-LEFT LANE

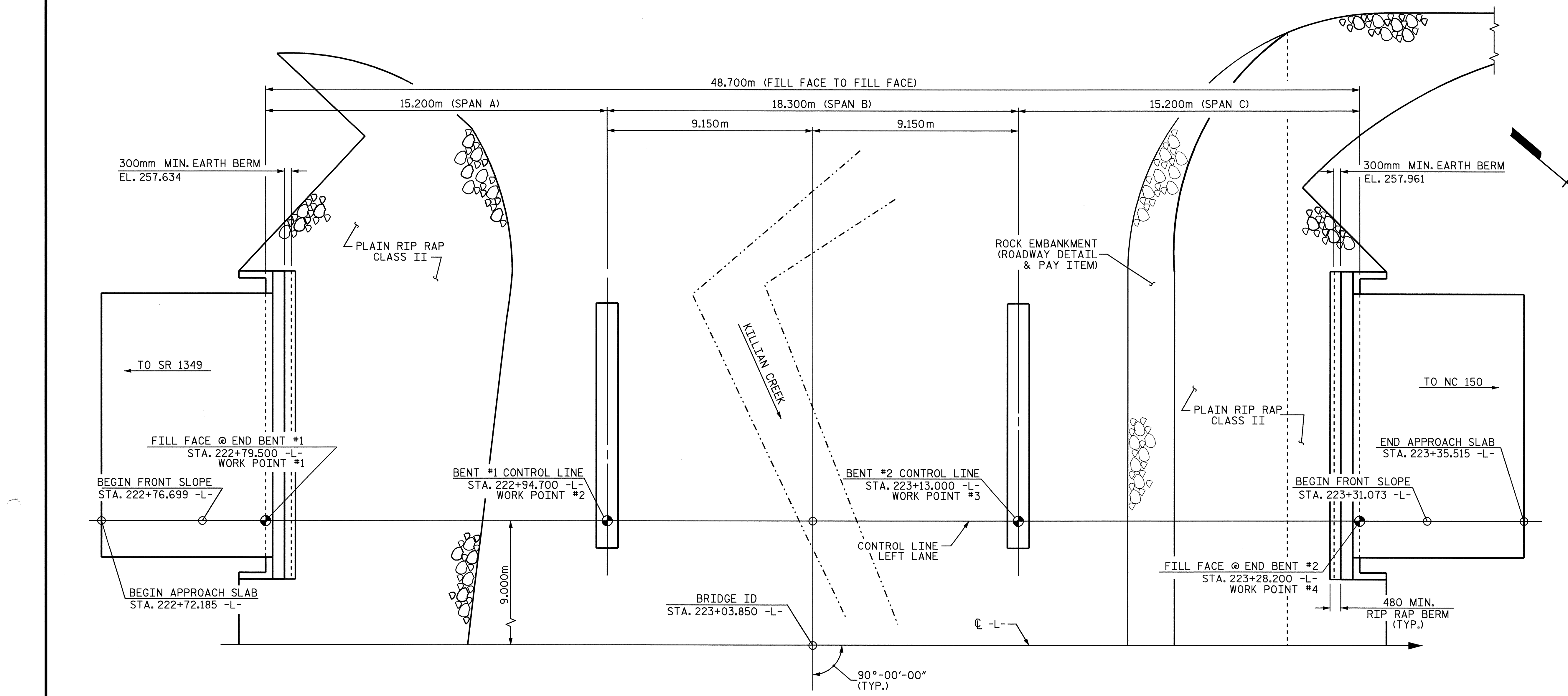

PLAN

(PILES NOT SHOWN FOR CLARITY)

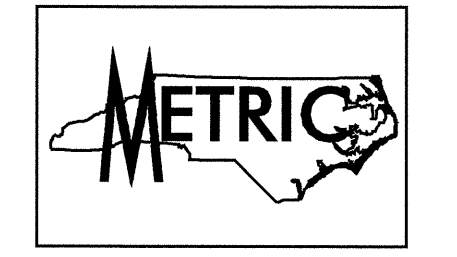
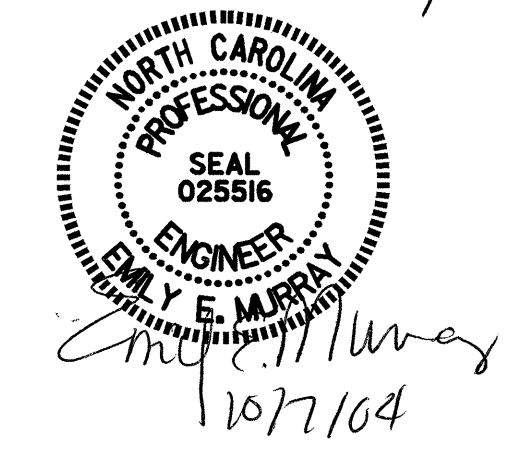
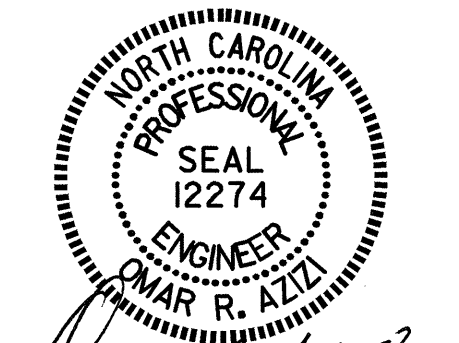

PROJECT NO. R-2206C
 LINCOLN/CATAWBA COUNTY
 STATION: 223+03.850 -L-

SHEET 1 OF 3 BRIDGE NO. 296

STATE OF NORTH CAROLINA
 DEPARTMENT OF TRANSPORTATION
 RALEIGH
GENERAL DRAWING
 FOR BRIDGE ON NC 16 OVER
 KILLIAN CREEK BETWEEN SR 1349
 AND NC 150
LEFT LANE

REVISIONS						SHEET NO.	
NO.	BY:	DATE:	NO.	BY:	DATE:	S-132	
1			3			TOTAL SHEETS	374
2			4				

DRAWN BY : W.D. CRUTCHER DATE : 05-04
 CHECKED BY : T.L. AVERETTE DATE : 05-04

07-OCT-2004 14:30
 w:\squadq\2206e\Final Plans\Str. 9\R2206C_SD_GD_09.dgn
 dcrutcher

STR. #9