

PROJECT REFERENCE NO. R-2206C		SHEET NO. EC-47/CONST.8	
R/W SHEET NO.			
ROADWAY DESIGN ENGINEER		HYDRAULICS ENGINEER	
CONST. REV.			
R/W REV.			

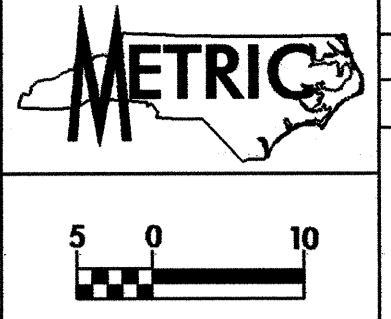

-L-
 PI Sta 199+75.908
 $\Delta = 25^\circ 54' 22.0''$ (RT)
 $L = 1,356.440$
 $T = 690.016$
 $R = 3,000.000$
 $e = 0.02$
 $RO = 35m$

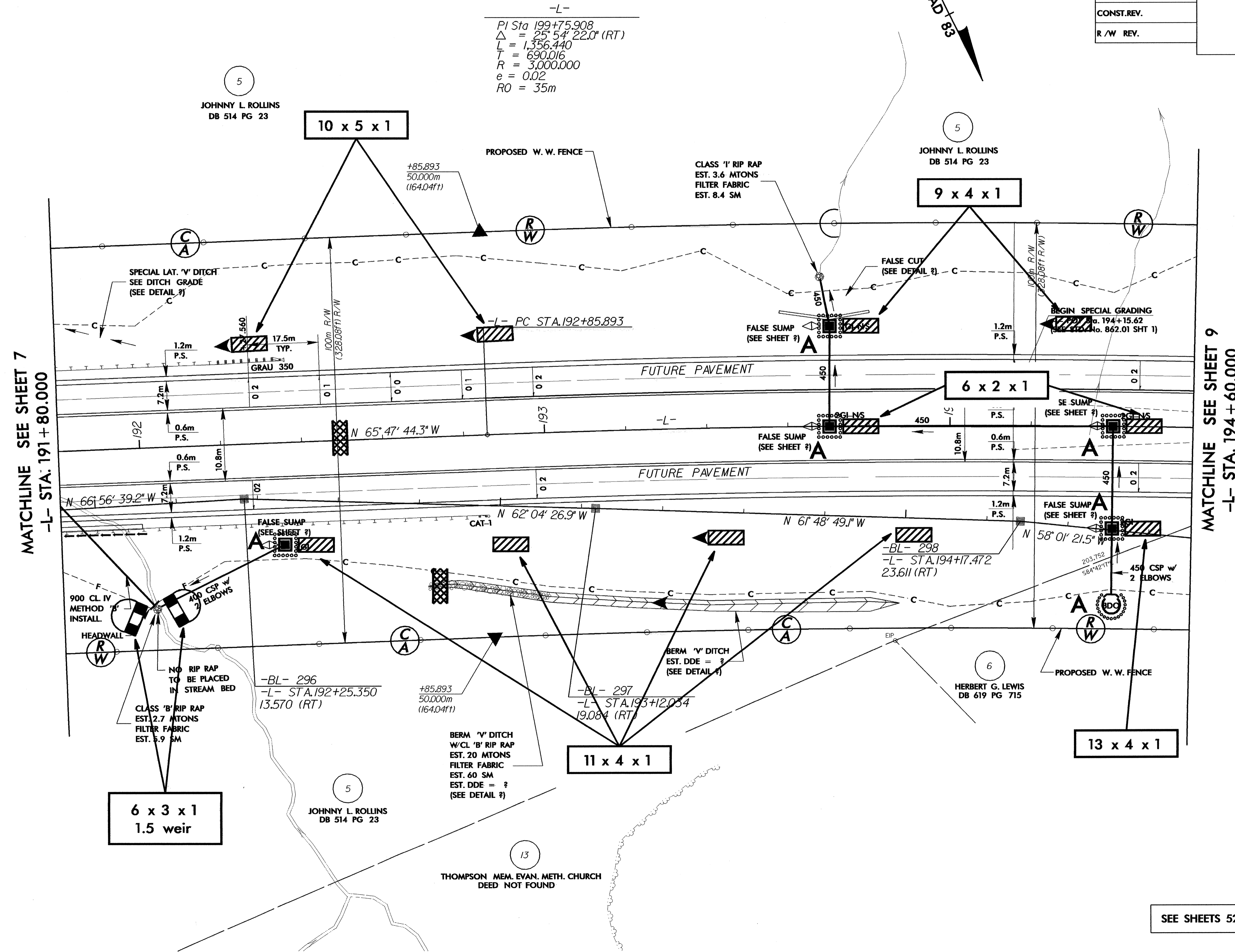

MATCHLINE SEE SHEET 7
 -L- STA. 191+80.000

MATCHLINE SEE SHEET 9
 -L- STA. 194+60.000

SEE SHEETS 52 & 53 FOR -L- PROFILE