

**METRIC**

5 0 10

CONST. REV.

R/W REV.

PROJECT REFERENCE NO. R-2206C	SHEET NO. EC-66/CONST.27
R/W SHEET NO.	HYDRAULICS ENGINEER
ROADWAY DESIGN ENGINEER	

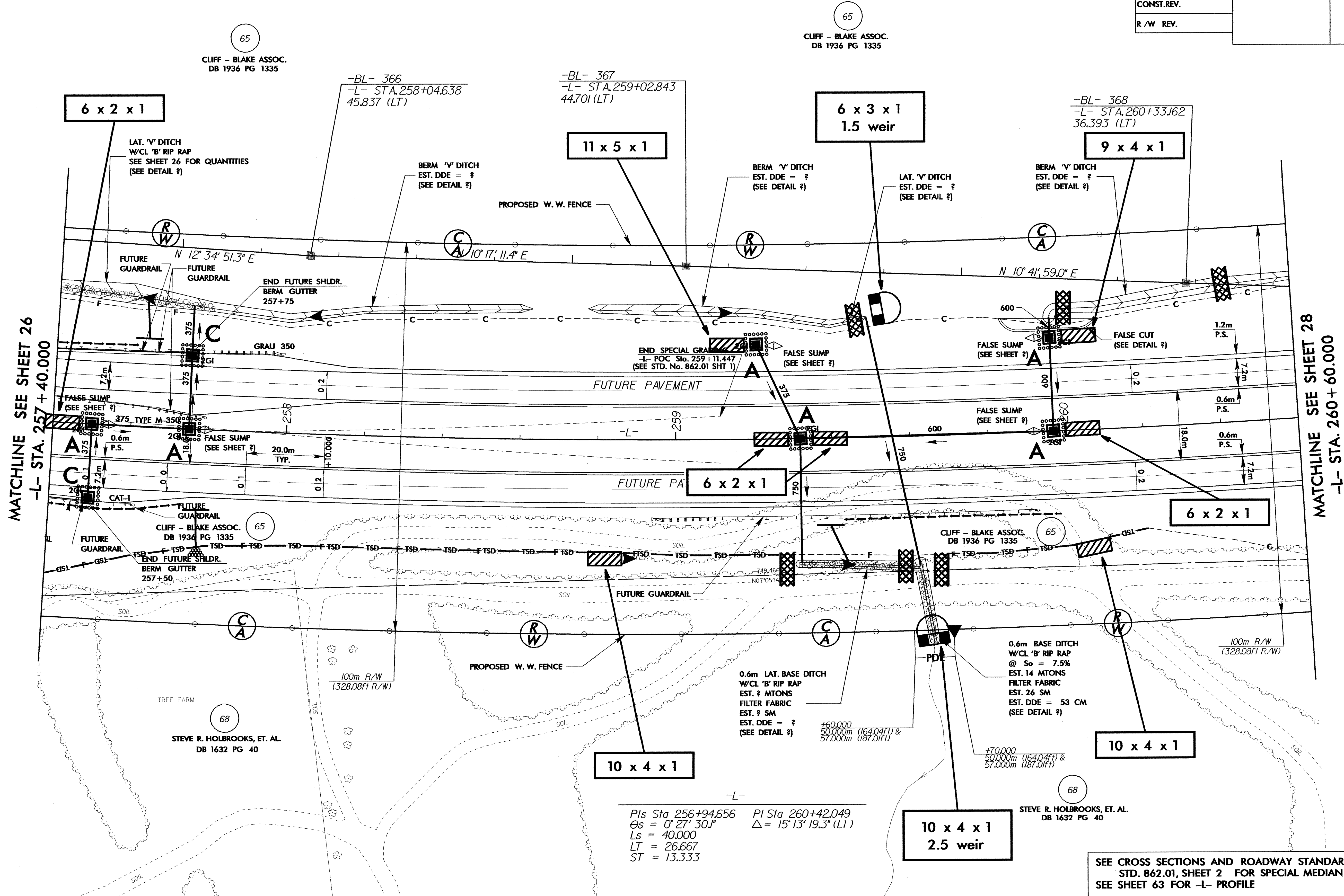
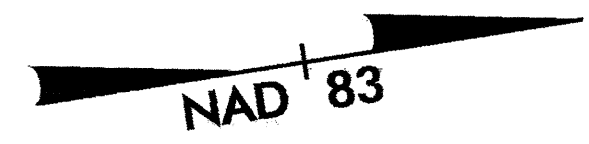

65  
CLIFF - BLAKE ASSOC.  
DB 1936 PG 1335

65  
CLIFF - BLAKE ASSOC.  
DB 1936 PG 1335

65  
CLIFF - BLAKE ASSOC.  
DB 1936 PG 1335

68  
STEVE R. HOLBROOKS, ET. AL.  
DB 1632 PG 40

65  
CLIFF - BLAKE ASSOC.  
DB 1936 PG 1335

68  
STEVE R. HOLBROOKS, ET. AL.  
DB 1632 PG 40

-L-  
 PIs Sta 256+94.656    PI Sta 260+42.049  
 Os = 0° 27' 30.1"    Δ = 15° 13' 19.3" (LT)  
 Ls = 40.000  
 LT = 26.667  
 ST = 13.333

SEE CROSS SECTIONS AND ROADWAY STANDARD DRAWINGS,  
 STD. 862.01, SHEET 2 FOR SPECIAL MEDIAN GRADING.  
 SEE SHEET 63 FOR -L- PROFILE

MATCHLINE SEE SHEET 26  
 -L- STA. 257 + 40.000

MATCHLINE SEE SHEET 28  
 -L- STA. 260 + 60.000