

BM #2 : 8" NAIL IN ROOT OF 24" Ø HEMLOCK
 9 FEET LEFT OF STA. 13+62.00 -L-
 ELEV. 2733.95

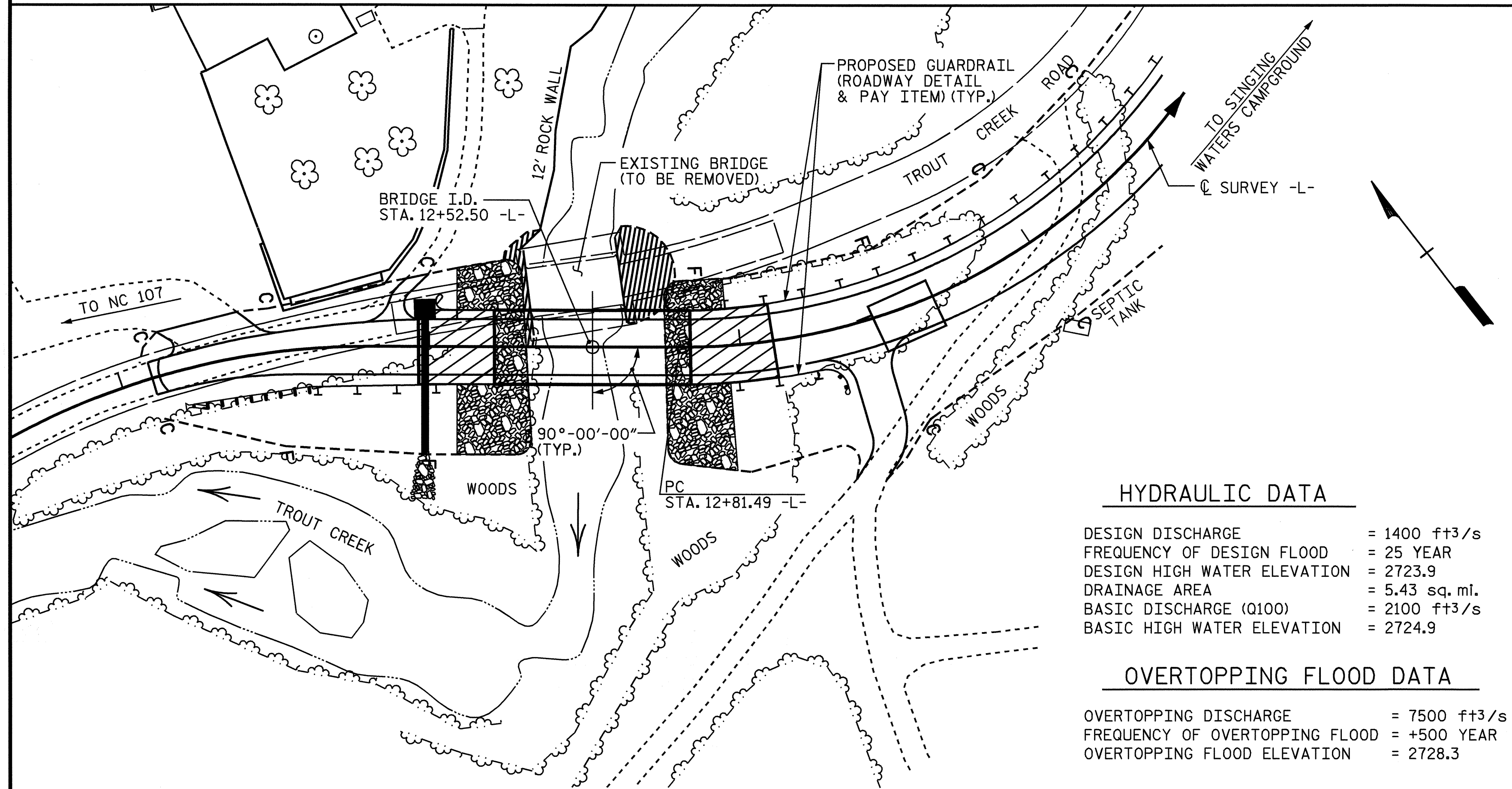

HYDRAULIC DATA

DESIGN DISCHARGE = 1400 ft³/s
 FREQUENCY OF DESIGN FLOOD = 25 YEAR
 DESIGN HIGH WATER ELEVATION = 2723.9
 DRAINAGE AREA = 5.43 sq. mi.
 BASIC DISCHARGE (Q100) = 2100 ft³/s
 BASIC HIGH WATER ELEVATION = 2724.9

OVERTOPPING FLOOD DATA

OVERTOPPING DISCHARGE = 7500 ft³/s
 FREQUENCY OF OVERTOPPING FLOOD = +500 YEAR
 OVERTOPPING FLOOD ELEVATION = 2728.3

LOCATION SKETCH
 FOR UTILITY INFORMATION, SEE UTILITY PLANS AND SPECIAL PROVISIONS.

TOTAL BILL OF MATERIAL

	REMOVAL OF EXISTING STRUCTURE	UNCLASSIFIED STRUCTURE EXCAVATION	CLASS A CONCRETE	BRIDGE APPROACH SLABS	REINFORCING STEEL	HP 12 X 53 STEEL PILES		STEEL PILE POINTS	CONCRETE BARRIER RAIL	PLAIN RIP RAP CLASS II (2'-0" THICK)	FILTER FABRIC FOR DRAINAGE	ELASTOMERIC BEARINGS	3'-0" X 1'-9" PRESTRESSED CONCRETE CORED SLABS	
	LUMP SUM	LUMP SUM	CU.YDS.	LUMP SUM	LBS.	NO.	LIN.FT.	EACH	LIN.FT.	TONS	SQ.YDS.	LUMP SUM	NO.	LIN.FT.
SUPERSTRUCTURE				LUMP SUM					119.50			LUMP SUM	9	537.75
END BENT 1		LUMP SUM	12.1		1793	7	455.0	7		132	146			
END BENT 2			12.0		1764	7	385.0	7		104	115			
TOTAL	LUMP SUM	LUMP SUM	24.1	LUMP SUM	3557	14	840.0	14	119.50	236	261	LUMP SUM	9	537.75

PROJECT NO. B-3667
JACKSON COUNTY
 STATION: 12+52.50 -L-

SHEET 3 OF 3

STATE OF NORTH CAROLINA
 DEPARTMENT OF TRANSPORTATION
 RALEIGH

GENERAL DRAWING
 FOR BRIDGE ON SR 1131
 OVER TROUT CREEK
 BETWEEN NC 107 AND
 SINGING WATERS CAMPGROUND



DRAWN BY : K. McCAULEY DATE : 1/30/04
 CHECKED BY : A. L. MEADOWS DATE : 8/13/04

09-SEP-2004 15:39
 W:\squadp\3667\str1\kmccauley\Microstation\B3667.sd_6D_01.dgn
 kmccauley

REVISIONS						SHEET NO.
NO.	BY:	DATE:	NO.	BY:	DATE:	S-3
1			3			TOTAL SHEETS
2			4			37