

08\_SEP\_2004 08:58  
 y:\Roadway\Projects\U2408\proj\U2408.pf1  
 vta\ferro

**METRIC**  
 2.5 0 5  
 CONST. REV.  
 R/W REV.

PROJECT REFERENCE NO. U-2408	SHEET NO. 44
ROADWAY DESIGN ENGINEER NORTH CAROLINA PROFESSIONAL SEAL 9/1/04	HYDRAULICS ENGINEER NORTH CAROLINA PROFESSIONAL SEAL 9/1/04

BM #7 EL=255.648 m  
 CHISELED SQUARE ON N.W. SIDE OF CONC. SLAB  
 AT TELEPHONE BOOTH. 16' FROM EP OF BESSEMER  
 CITY ROAD. (NC 274) ON THE EAST SIDE OF ROAD  
 ACROSS FROM BB&T BANK.

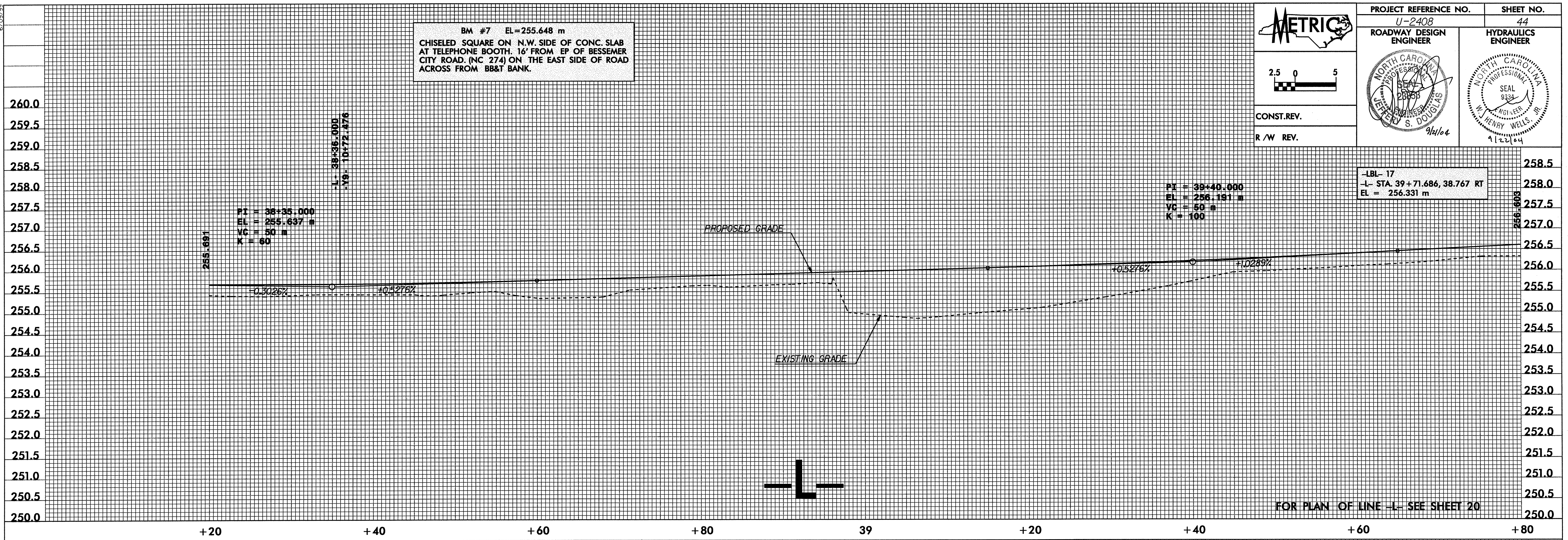

FOR PLAN OF LINE -L- SEE SHEET 20

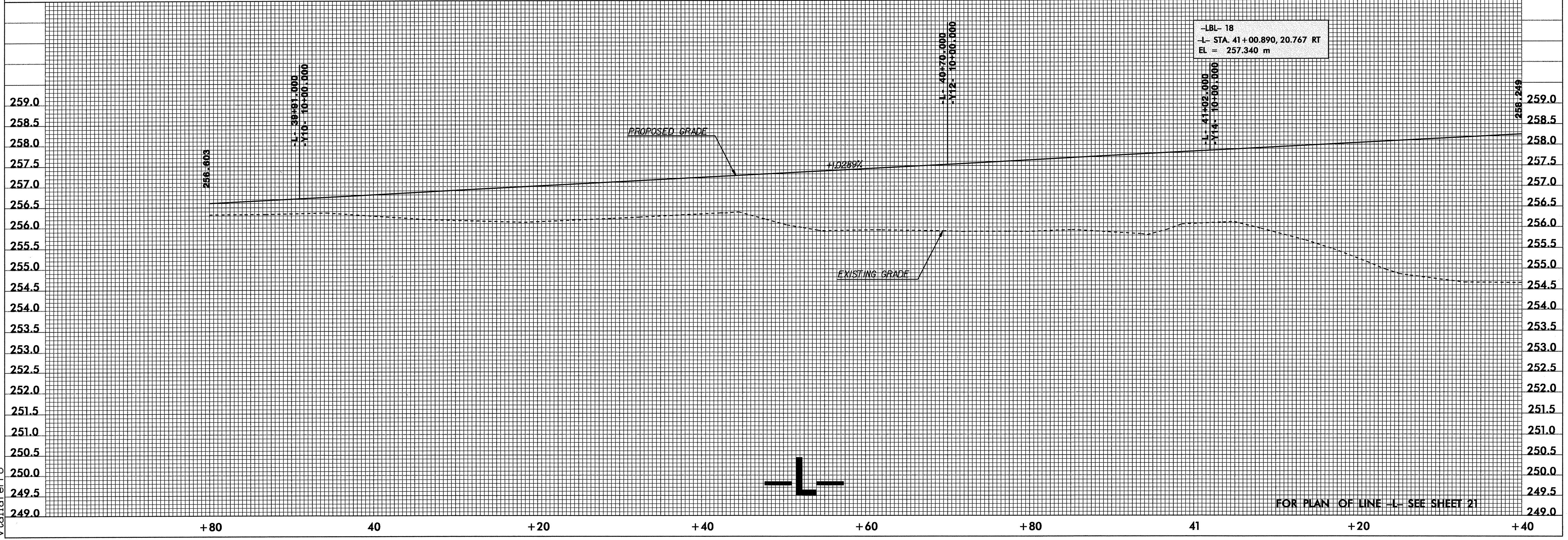

FOR PLAN OF LINE -L- SEE SHEET 21