

6/10/99

BM \*J8 - RR SPIKE IN 18" DOUBLE WINGED ELM  
 -BL- 69+82,295.3 m RT.  
 -L- 75+00.5,299.4 m RT.  
 EL = 238.482

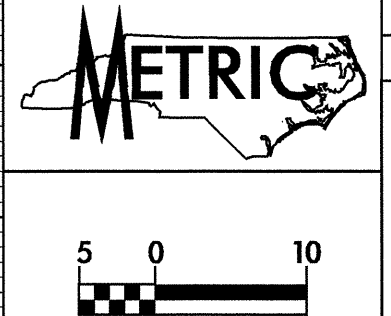

PROJECT REFERENCE NO. R-2568B SHEET NO. 35

ROADWAY DESIGN ENGINEER

HYDRAULICS ENGINEER

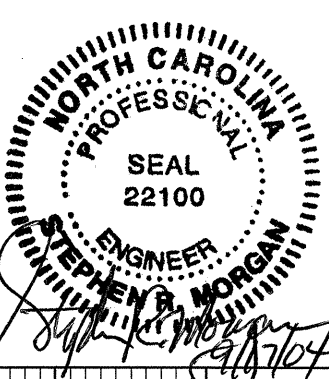
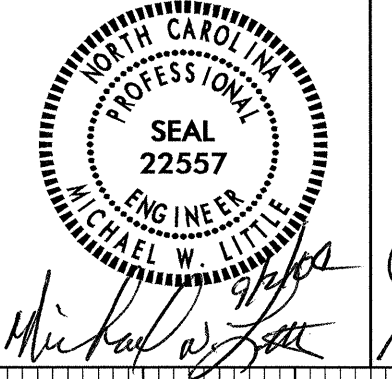

CONST. REV.

R / W REV.

BM \*J9 - RR SPIKE IN 18" BLACK CHERRY  
 -BL- 70+69,353.7 m LT.  
 -RTL2- 75+69.3,360.3 m LT.  
 EL = 250.595

-L-

-LTLN2-

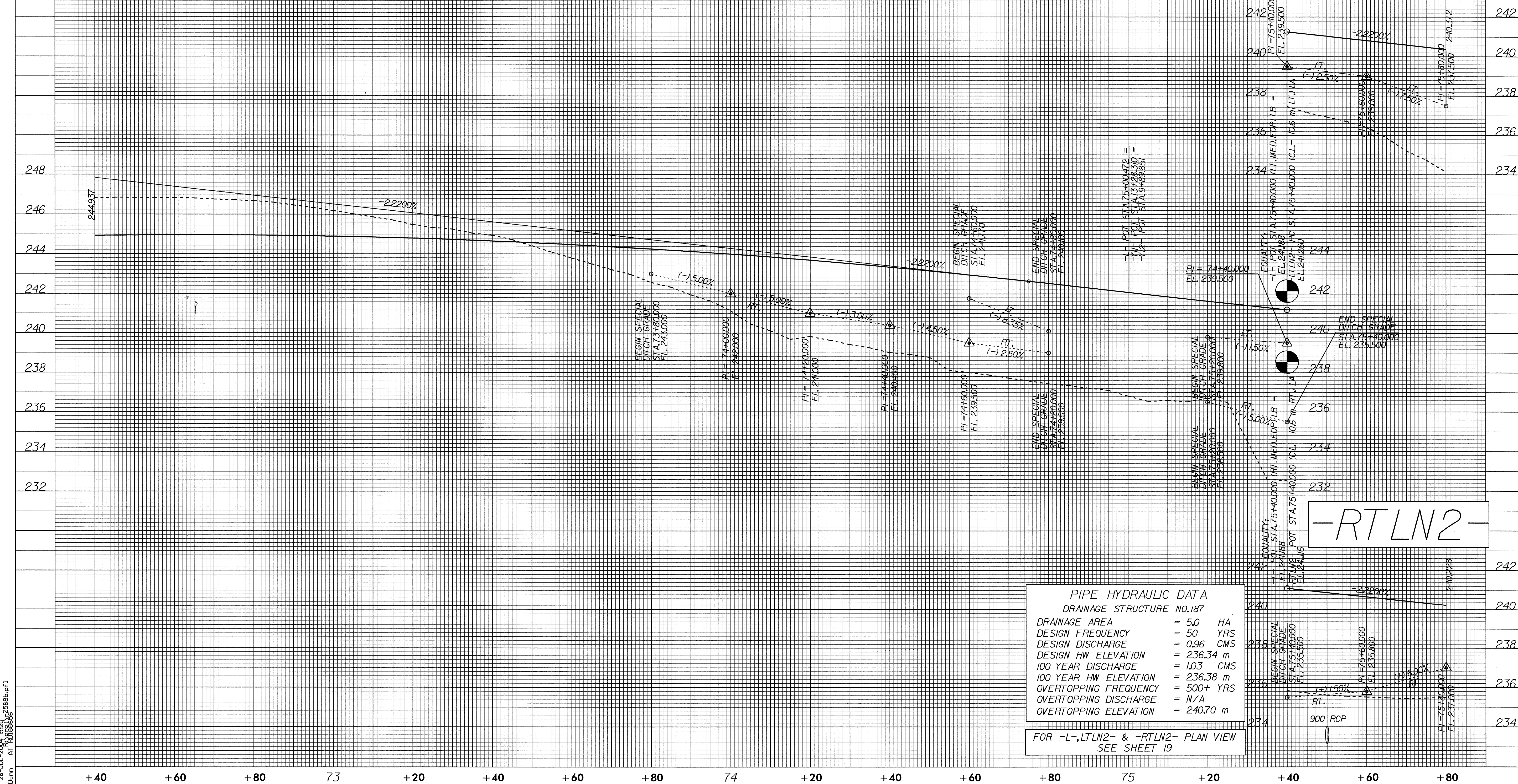

PIPE HYDRAULIC DATA  
 DRAINAGE STRUCTURE NO.187

DRAINAGE AREA	= 5.0	HA
DESIGN FREQUENCY	= 50	YRS
DESIGN DISCHARGE	= 0.96	CMS
DESIGN HW ELEVATION	= 236.34	m
100 YEAR DISCHARGE	= 1.03	CMS
100 YEAR HW ELEVATION	= 236.38	m
OVERTOPPING FREQUENCY	= 500+	YRS
OVERTOPPING DISCHARGE	= N/A	
OVERTOPPING ELEVATION	= 240.70	m

FOR -L-,LTLN2- & -RTL2- PLAN VIEW  
 SEE SHEET 19

26-JUL-2004 15:20  
 AT R-2568B-35  
 RWDunn