

| | | | |
|-----------------|-----------------------------|-------------|--------------|
| STATE | STATE PROJECT REFERENCE NO. | SHEET NO. | TOTAL SHEETS |
| N.C. | R-2568B | RF-2 | |
| STATE PROJ. NO. | F.A. PROJ. NO. | DESCRIPTION | |
| | | | |

PLANTING DETAILS

LIVE STAKES PLANTING DETAIL

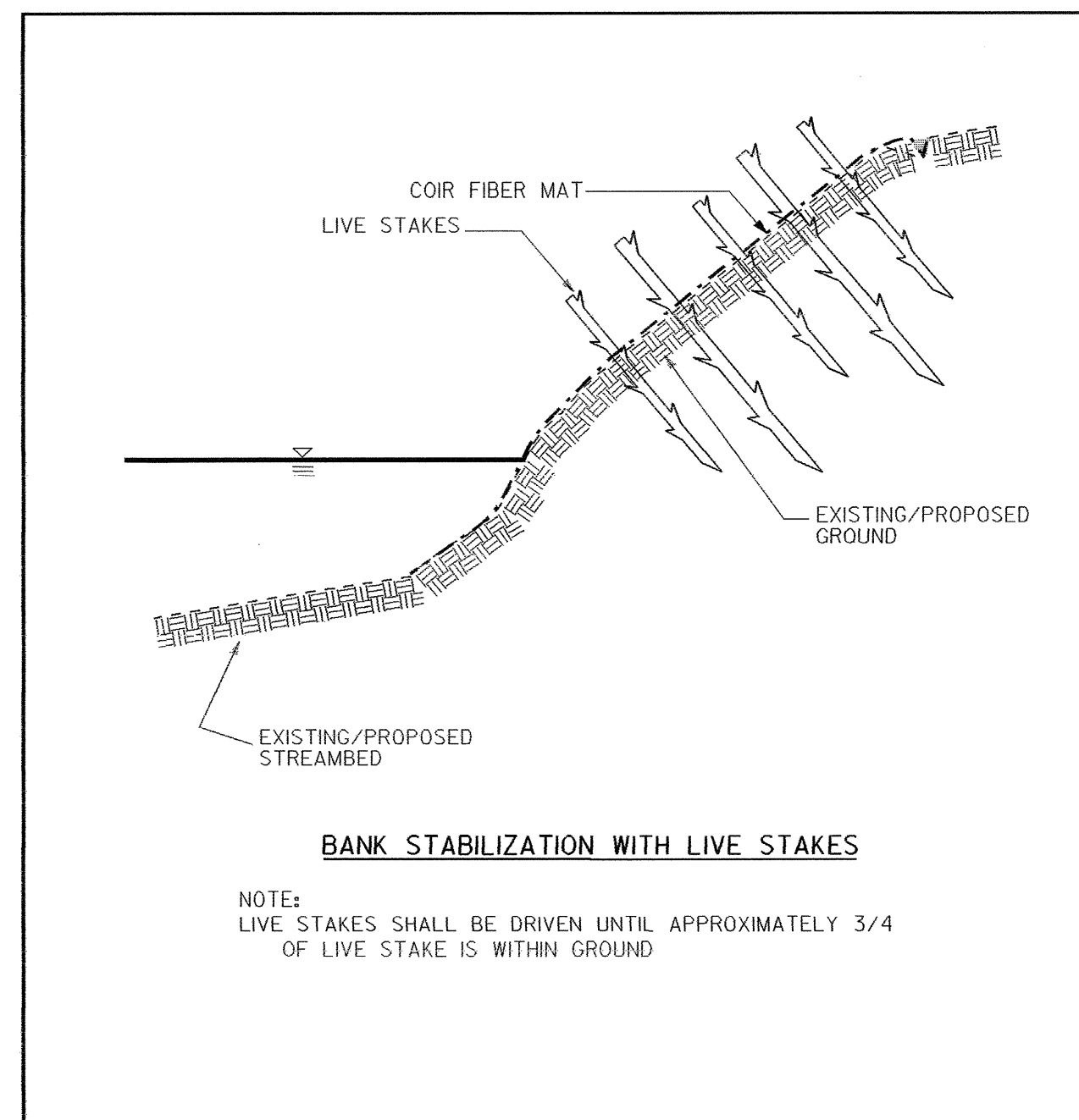
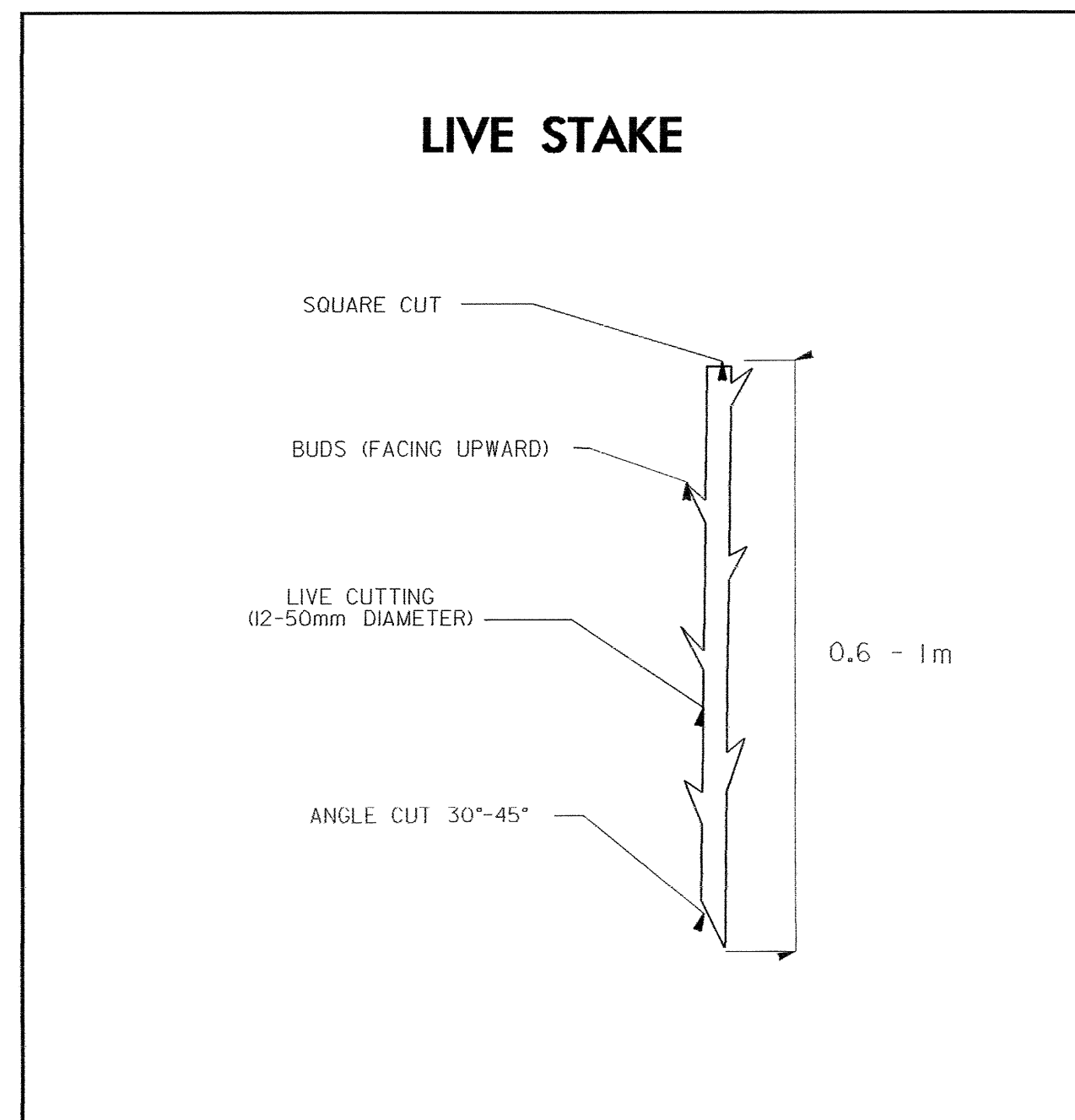

BAREROOT PLANTING DETAIL DIBBLE PLANTING METHOD USING THE KBC PLANTING BAR

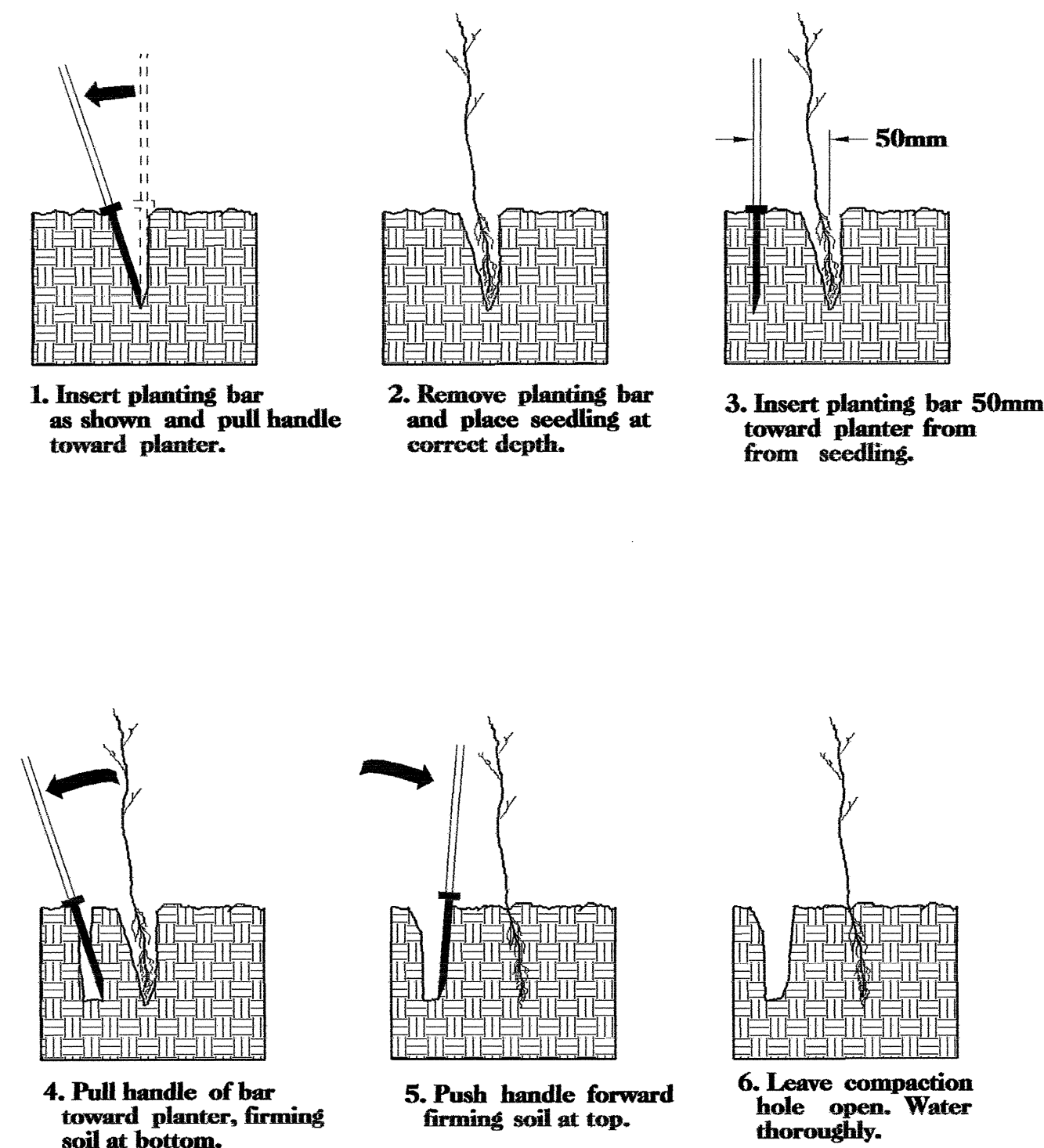

PLANTING NOTES:

PLANTING BAG
During planting, seedlings shall be kept in a moist canvas bag or similar container to prevent the root systems from drying.



KBC PLANTING BAR
Planting bar shall have a blade with a triangular cross section, and shall be 300mm long, 100mm wide and 25mm thick at center.

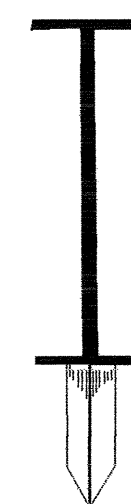

ROOT PRUNING
All seedlings shall be root pruned, if necessary, so that no roots extend more than 250mm below the root collar.

- TYPE 1 STREAMBANK REFORESTATION SHALL BE PLANTED 0.9m TO 1.52m ON CENTER, RANDOM SPACING, AVERAGING 1.22m ON CENTER, APPROXIMATELY 6726 PLANTS PER HECTARE.
- TYPE 2 STREAMBANK REFORESTATION SHALL BE PLANTED 1.8m TO 3.0m ON CENTER, RANDOM SPACING, AVERAGING 2.4m ON CENTER, APPROXIMATELY 1680 PLANTS PER HECTARE.
- NOTE: TYPE 1 AND TYPE 2 STREAMBANK REFORESTATION SHALL BE PAID FOR AS "STREAMBANK REFORESTATION"

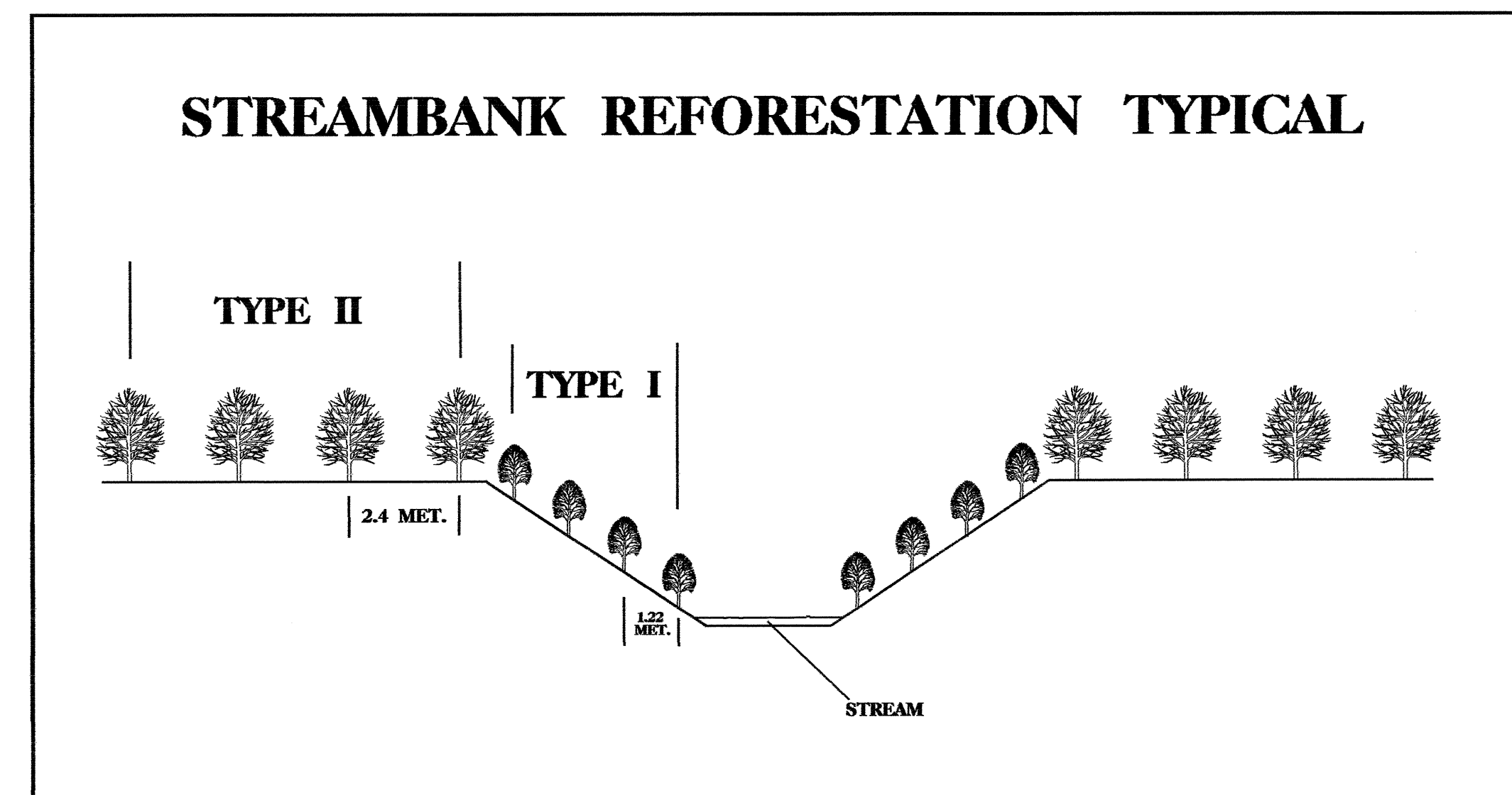

STREAMBANK REFORESTATION

MIXTURE, TYPE, SIZE, AND FURNISH SHALL CONFORM TO THE FOLLOWING:

TYPE 1

| | | |
|-------------------|---------------|------------------------|
| 50% SALIX NIGRA | BLACK WILLOW | 0.6m to 1m LIVE STAKES |
| 50% CORNUS AMOMUM | SILKY DOGWOOD | 0.6m to 1m LIVE STAKES |

TYPE 2

| | | |
|-----------------------------|--------------|------------------|
| 25% LIRIODENDRON TULIPIFERA | TULIP POPLAR | 300mm - 460mm BR |
| 25% JUGLANS NIGRA | BLACK WALNUT | 300mm - 460mm BR |
| 25% FRAXINUS PENNSYLVANICA | GREEN ASH | 300mm - 460mm BR |
| 25% QUERCUS ALBA | WHITE OAK | 300mm - 460mm BR |

- SEE PLAN SHEETS FOR AREAS TO BE PLANTED

STREAMBANK REFORESTATION DETAIL SHEET

N.C.D.O.T. - ROADSIDE ENVIRONMENTAL UNIT