

UTILITIES BY OTHERS

NOTE:
ALL PROPOSED UTILITY WORK
SHOWN ON THIS SHEET WILL
BE DONE BY OTHERS

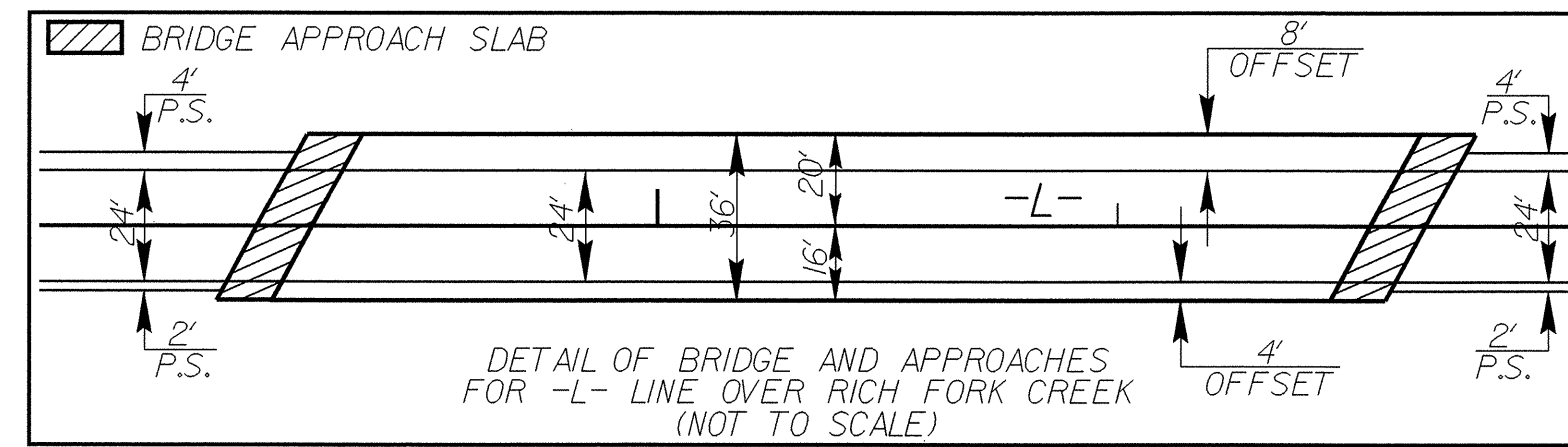

DAVIDSON COUNTY COMMUNITY COLLEGE
D.B. 415 PG. 66

JOHN H. DAVIS AND WIFE,
KATHERINE H. DAVIS
D.B. 600 PG. 923

SHERMAN A. YEARGAN, JR., TRUSTEE
UNDER THE WILL OF R. WALKER
MARTIN, DECEASED, FOR THE BENEFIT
OF MARY ALLISON BAILEY
D.B. 682 PG. 526

-L- POT STA 14+50
BEGIN TIP PROJECT B-4096

-L- POT STA 27+00
END TIP PROJECT B-4096

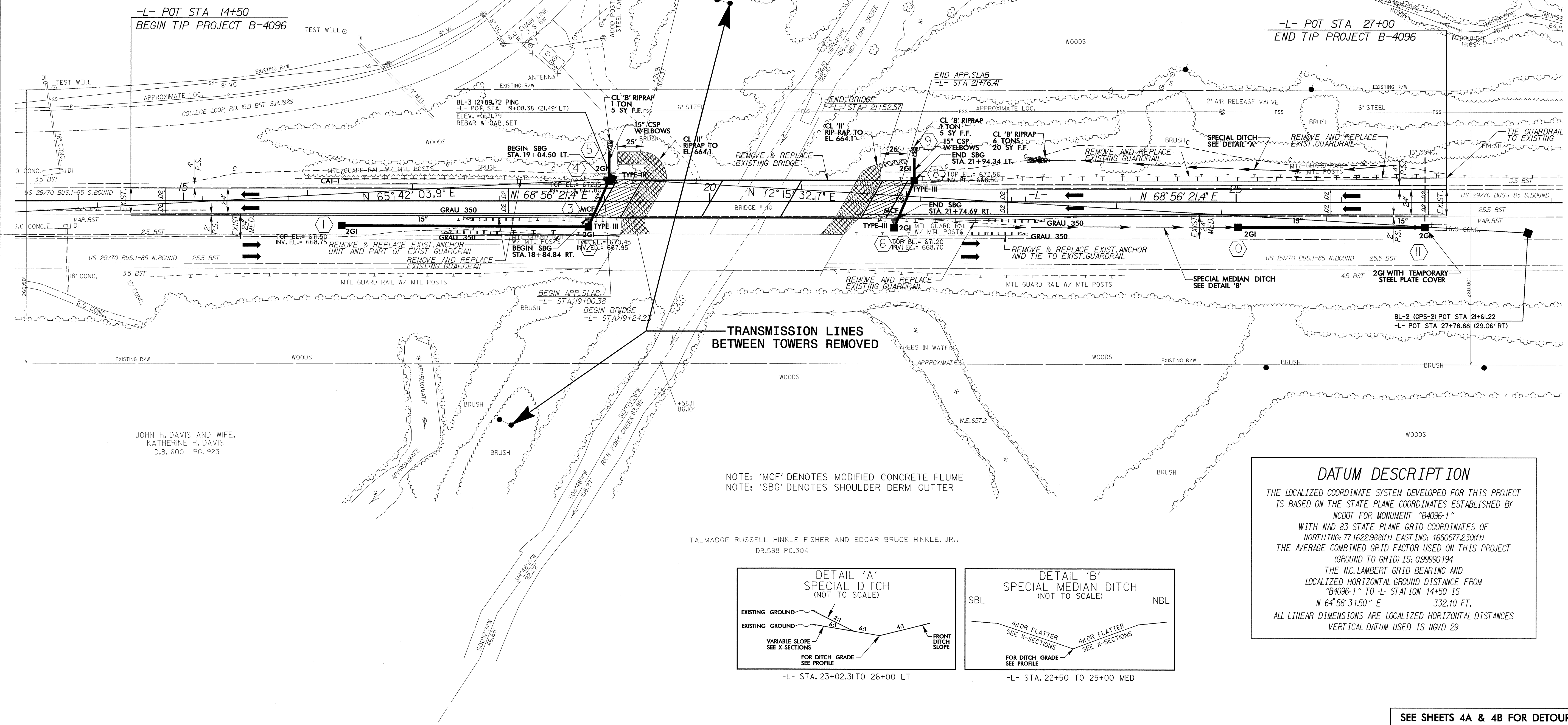

TRANSMISSION LINES
BETWEEN TOWERS REMOVED

NOTE: 'MCF' DENOTES MODIFIED CONCRETE FLUME
NOTE: 'SBG' DENOTES SHOULDER BERM GUTTER

DATUM DESCRIPTION

THE LOCALIZED COORDINATE SYSTEM DEVELOPED FOR THIS PROJECT IS BASED ON THE STATE PLANE COORDINATES ESTABLISHED BY MCDOT FOR MONUMENT "B4096-1" WITH NAD 83 STATE PLANE GRID COORDINATES OF NORTHING: 771622988(11) EASTING: 1650577230(11) THE AVERAGE COMBINED GRID FACTOR USED ON THIS PROJECT (GROUND TO GRID) IS: 0.99990194 THE N.C. LAMBERT GRID BEARING AND LOCALIZED HORIZONTAL GROUND DISTANCE FROM "B4096-1" TO -L- STATION 14+50 IS N 64°56'31.50" E 332.10 FT. ALL LINEAR DIMENSIONS ARE LOCALIZED HORIZONTAL DISTANCES VERTICAL DATUM USED IS NGVD 29

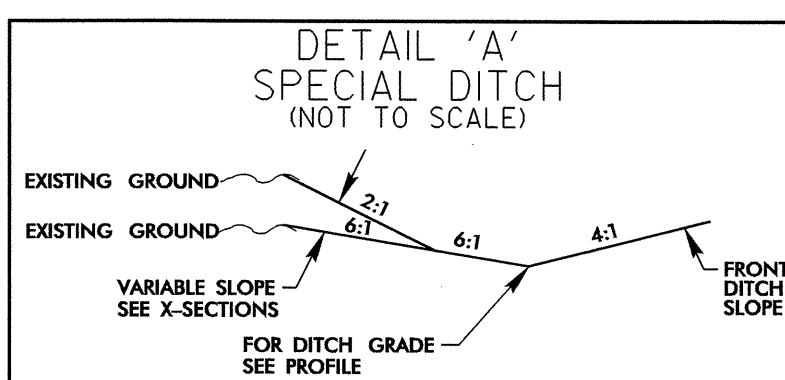

-L- STA. 23+02.31 TO 26+00 LT

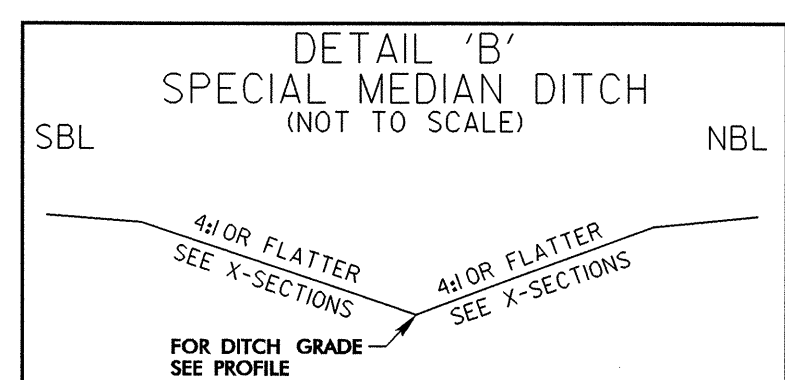

-L- STA. 22+50 TO 25+00 MED

SEE SHEETS 4A & 4B FOR DETOUR
SEE SHEET 5 FOR PROFILE

8/17/99
 05-JUL-2004 08:31
 P:\D0111\1031\1031-2216
 1031-2216.dwg
 1031-2216.dgn