

| | |
|------------|-----------|
| T.I.P. NO. | SHEET NO. |
| U-2912 | UC-1 |

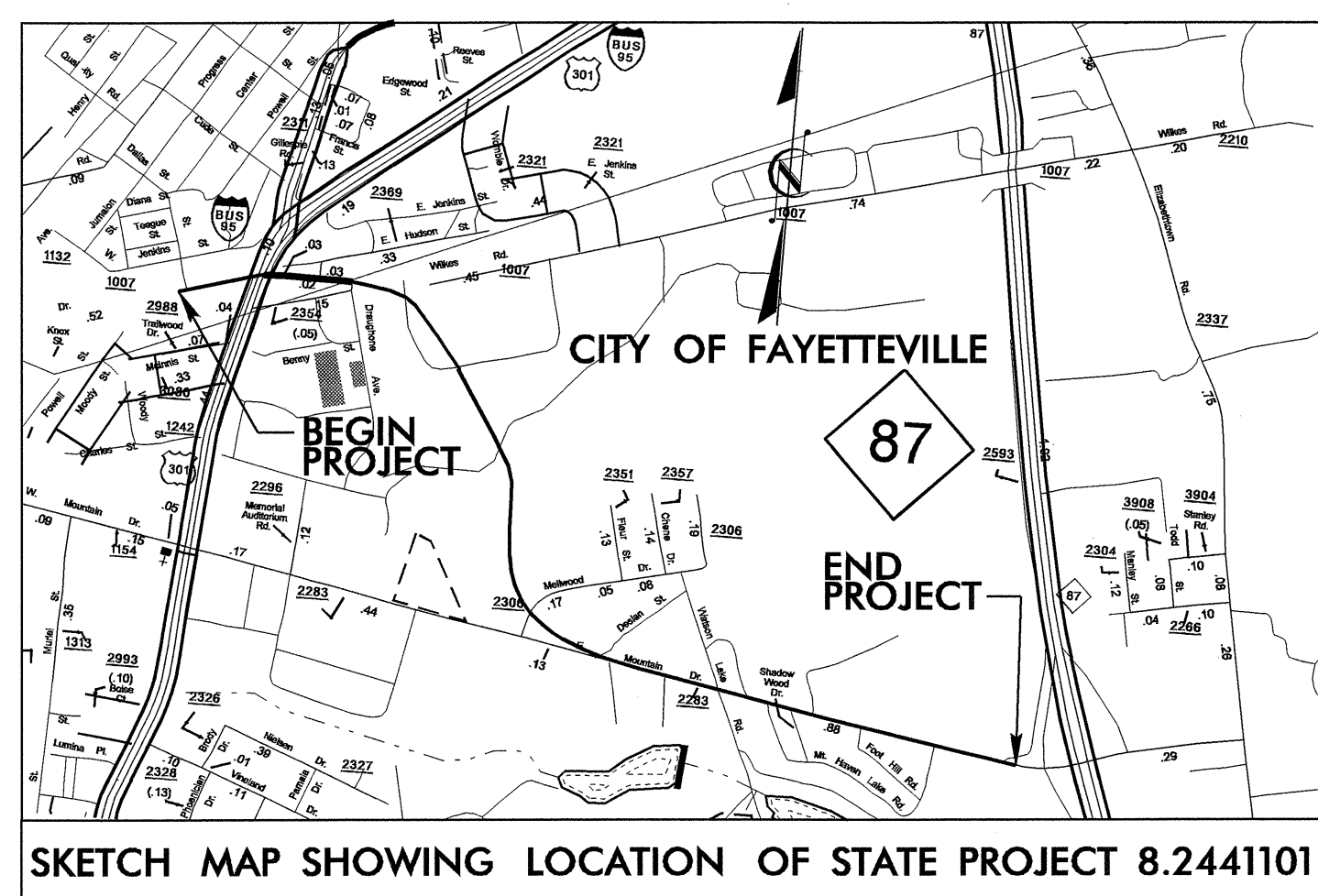

SKETCH MAP SHOWING LOCATION OF STATE PROJECT 8.2441101

STATE OF NORTH CAROLINA
DIVISION OF HIGHWAYS

**UTILITY CONSTRUCTION PLANS
CUMBERLAND COUNTY**

LOCATION: OWEN DRIVE EXTENSION FROM EAST OF I-95 BUSINESS/US 301 TO NC 87 AT EAST MOUNTAIN DRIVE

TYPE OF WORK: UTILITY RELOCATION

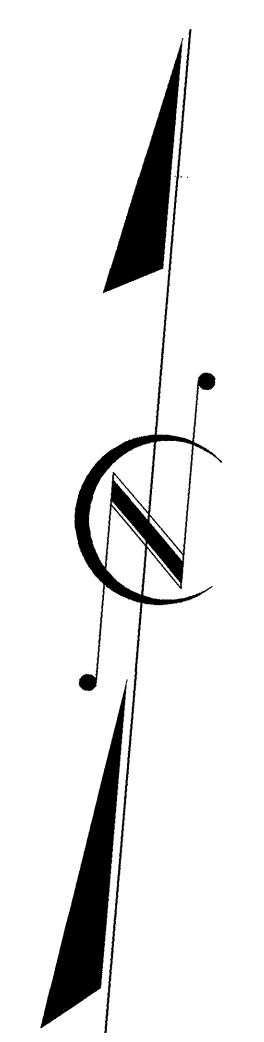
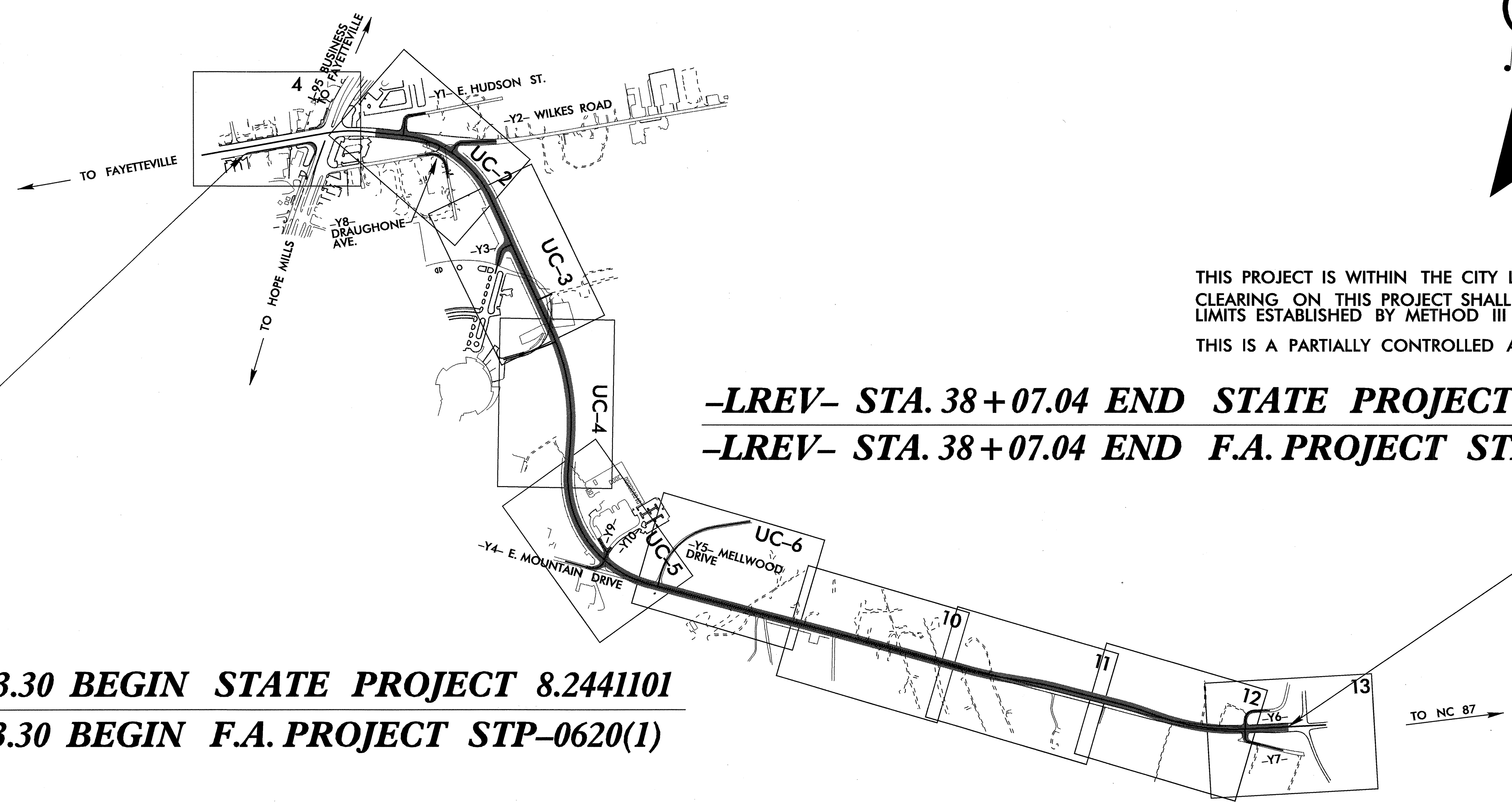

THIS PROJECT IS WITHIN THE CITY LIMITS OF FAYETTEVILLE. CLEARING ON THIS PROJECT SHALL BE PERFORMED TO THE LIMITS ESTABLISHED BY METHOD III
THIS IS A PARTIALLY CONTROLLED ACCESS PROJECT.

-LREV- STA. 38+07.04 END STATE PROJECT 8.2441101
-LREV- STA. 38+07.04 END F.A. PROJECT STP-0620(1)

-LREV- STA. 6+93.30 BEGIN STATE PROJECT 8.2441101
-LREV- STA. 6+93.30 BEGIN F.A. PROJECT STP-0620(1)

TIP: U-2912

| INDEX OF SHEETS | |
|-----------------|----------------------------------|
| SHEET NO. | DESCRIPTION |
| UC-1 | TITLE SHEET |
| UC-2 THRU UC-6 | UTILITY CONSTRUCTION PLAN SHEETS |
| UC-7 THRU UC-8 | DETAIL SHEETS |

WATER AND SEWER OWNERS ON PROJECT

(1) WATER-PWC OF FAYETTEVILLE
(2) SANITARY SEWER-PWC OF FAYETTEVILLE

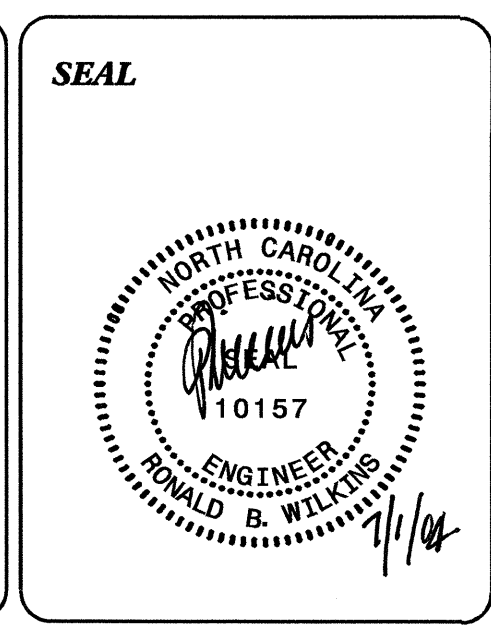

PREPARED IN THE OFFICE OF:
**DIVISION OF HIGHWAYS
DESIGN SERVICES
UTILITY SECTION**

1591 MAIL SERVICES CENTER
RALEIGH NC 27699-1591
PHONE (919) 256-4128
FAX (919) 256-4119

Roger Worthington, P.E. UTILITIES SECTION ENGINEER
R. B. Wilkins, P.E. UTILITIES SQUAD LEADER PROJECT ENGINEER
Steve Godbold UTILITIES PROJECT DESIGNER