

BILL OF MATERIAL					
END BENT 1					
BAR NO.	NO.	SIZE	TYPE	LENGTH	WEIGHT
B1	8	#9	1	46'-10"	1274
B2	4	#5	STR	44'-6"	186
B3	8	#4	STR	23'-5"	125
B4	11	#4	STR	2'-5"	18
D1	24	#6	STR	1'-6"	54
H1	6	#4	6	6'-0"	24
H2	6	#4	6	5'-9"	23
H3	6	#4	7	6'-1"	24
H4	6	#4	7	6'-4"	25
H5	12	#4	STR	3'-5"	27
S1	56	#4	2	7'-5"	277
S2	56	#4	3	3'-2"	118
S3	14	#4	4	6'-6"	61
S4	4	#4	5	4'-6"	12
V1	20	#4	STR	4'-5"	59
V2	20	#4	STR	4'-6"	60
REINFORCING STEEL = 2367 LBS					
CLASS A CONCRETE					
POUR #1 (CAP & WINGS) = 12.4 C.Y.					
POUR #2 (WINGS) = 1.4 C.Y.					
POUR #3 (LATERAL GUIDES) = 0.1 C.Y.					
TOTAL CLASS A CONCRETE = 13.9 C.Y.					
HP 12 X 53 STEEL PILES					
NO. 7 140 LIN. FT.					

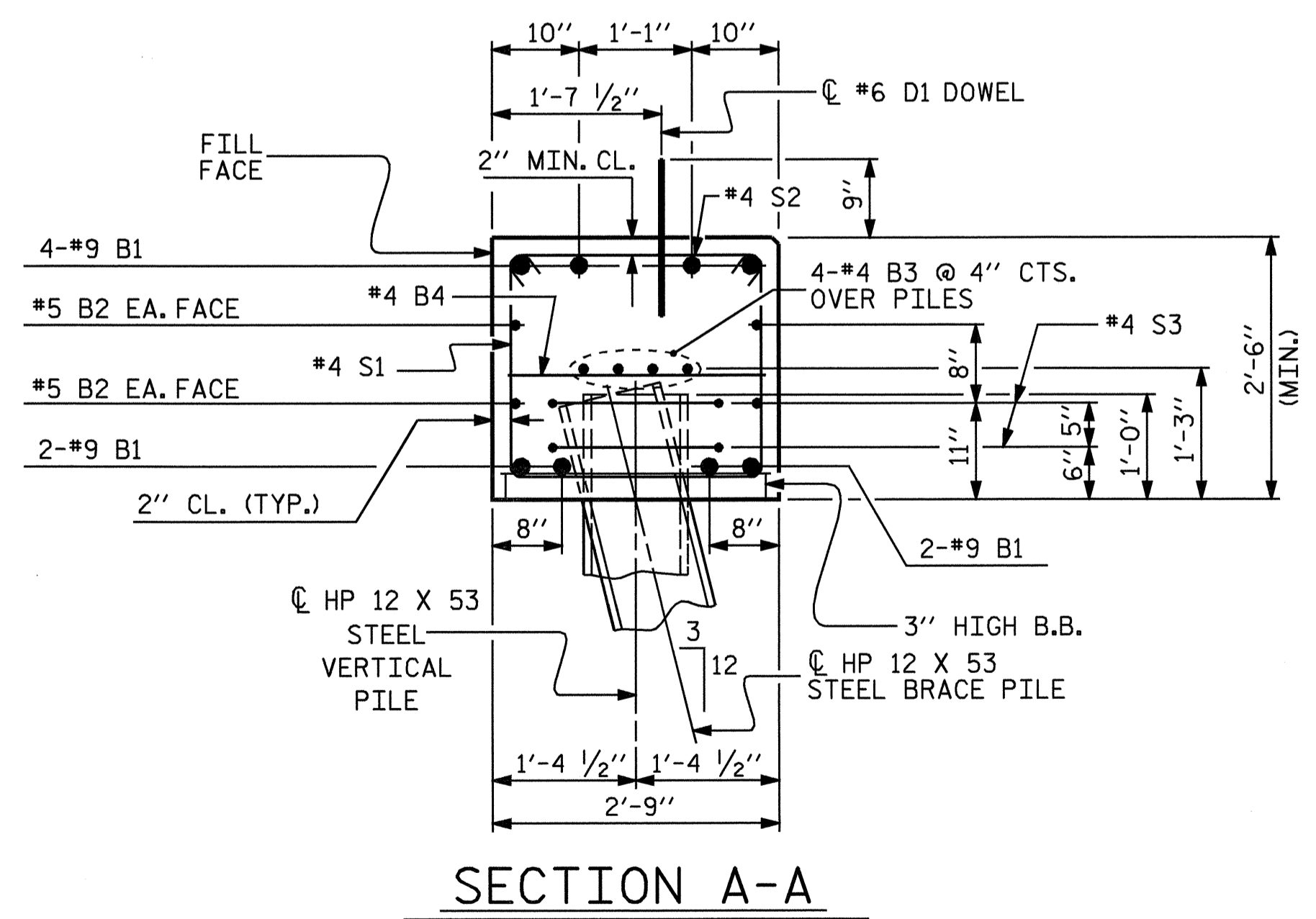
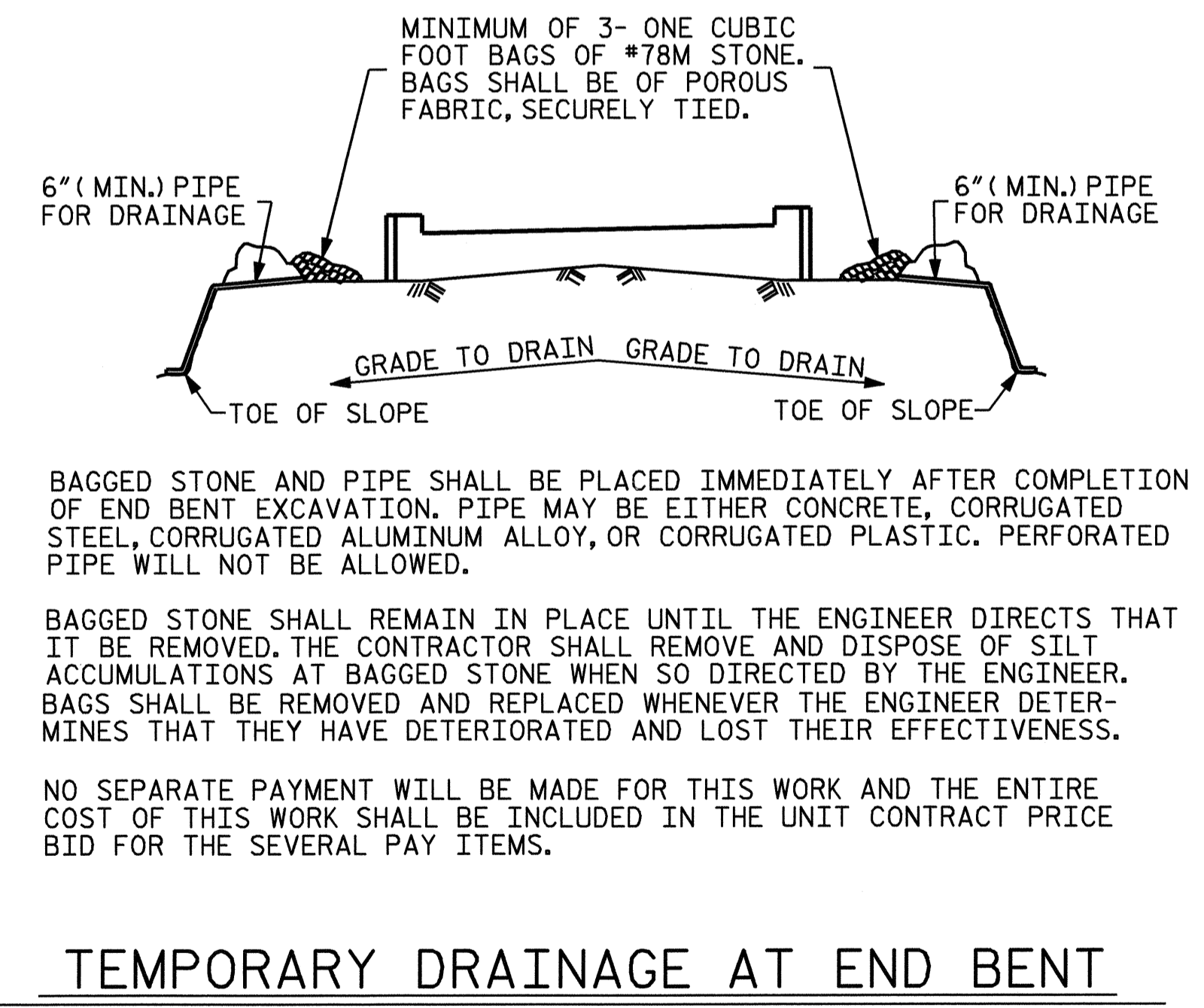

PROJECT NO. B-2963
DURHAM COUNTY
 STATION: 29+92.50-L-
 SHEET 3 OF 3

STATE OF NORTH CAROLINA
 DEPARTMENT OF TRANSPORTATION
 RALEIGH

SUBSTRUCTURE
 END BENT 1

REVISIONS				SHEET NO.
NO.	BY:	DATE:	NO.	DATE:
1			3	
2			4	

S-18
 TOTAL SHEETS 32

