

Ronald W. King

BEGIN STATE SIGNING PROJECT
B-2963 -L- STA 10+18.000

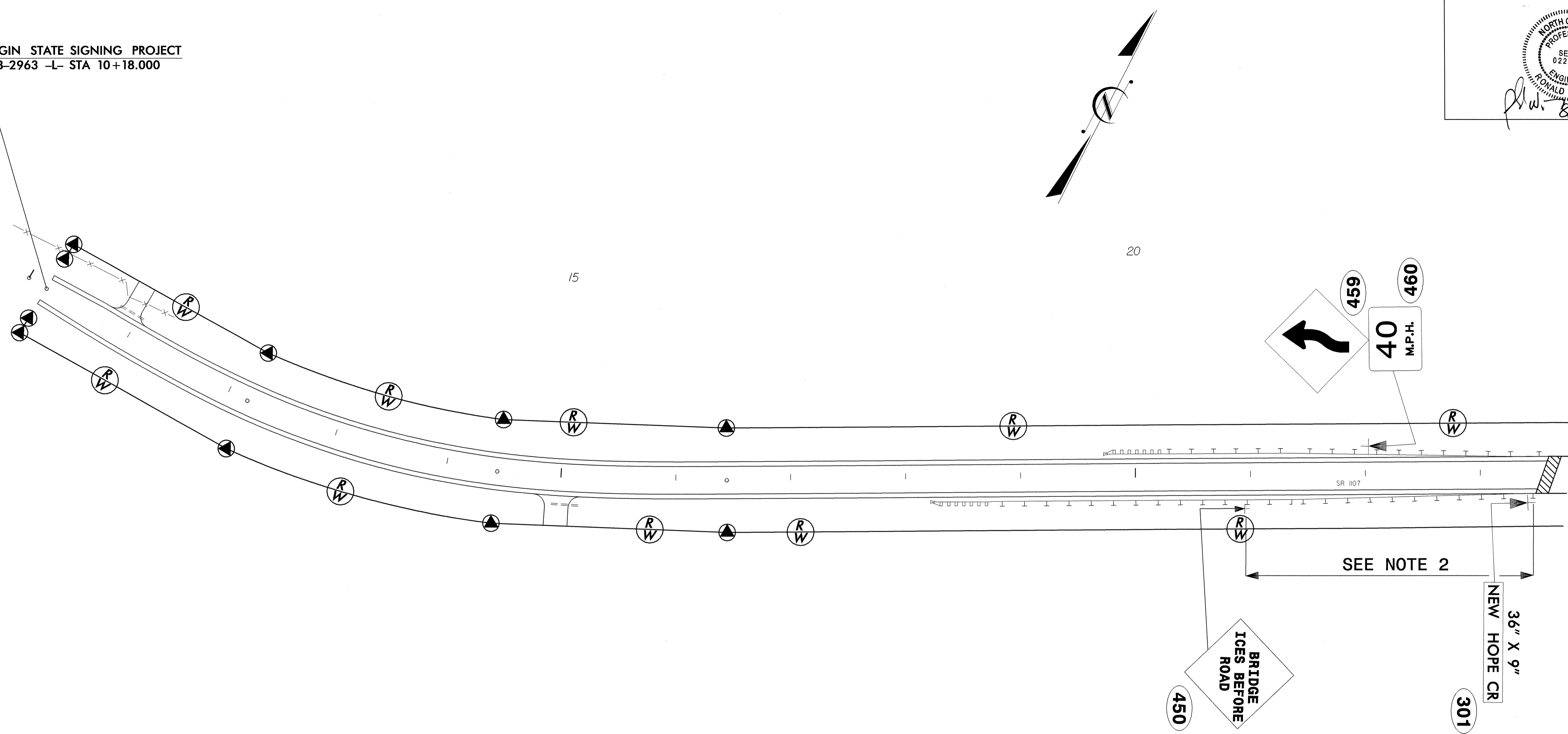

POSTED OR 85TH PERCENTILE SPEED MPH (KMH)	MINIMUM FT (M)	DESIRED FT (M)	MAXIMUM FT (M)
30 (50)	100 (30)	150 (46)	350 (107)
35 (55)	150 (46)	225 (69)	425 (130)
40 (65)	225 (69)	300 (91)	500 (152)
45 (70)	300 (91)	375 (114)	575 (175)
50 (80)	375 (114)	450 (137)	650 (198)
55 (90)	450 (137)	550 (168)	750 (229)
60 (95)	550 (168)	650 (198)	850 (259)
65 (105)	650 (198)	750 (229)	950 (290)
70 (115)	750 (229)	850 (259)	1050 (320)

- SEE ROADWAY STANDARD NO. 904.50 FOR MOUNTING OF TYPE 'D', 'E', AND 'F' SIGNS ON 'U' CHANNEL POSTS.
- SEE CHART FOR PLACEMENT OF BRIDGE ICES BEFORE ROAD SIGNS. DISTANCES SHOWN IN MINIMUM ROAD COLUMNS ARE FOR LEVEL ROADWAYS. MAKE CORRECTIONS FOR GRADES. IF 48-INCH (1219 MM) SIGNS ARE USED, THE LEGIBILITY DISTANCE MAY BE INCREASED TO 200 FEET (61 M). THIS WOULD ALLOW REDUCING THE CHART SPECIFIED DISTANCE BY 75 FEET (23 M).
- USE 48x48 (1219x1219) BRIDGE ICES BEFORE ROAD SIGNS WHEN ROADWAY HAS TWO OR MORE LANES IN EACH DIRECTION. USE 36x36 (914x914) SIGNS WHEN ROADWAY HAS ONE LANE IN EACH DIRECTION.
- IF THE BRIDGE IS OVER A MAJOR STREAM OR RIVER, A SIGN FOR THE NAME OF THE STREAM OR RIVER SHOULD BE INSTALLED AT EACH APPROACH. THESE DESIGNS WILL BE COMPLETED BY THE SIGNING SECTION UPON REQUEST.
- SIGNS FURNISHED BY CONTRACTOR.
- DISPOSAL OF SIGN SYSTEM, U-CHANNEL.
- RELOCATE SIGN, TYPE D, E, OR F.
- DISPOSAL OF SUPPORT, U-CHANNEL.
- DISPOSAL OF SUPPORT, WOOD

SR 1107
STA 10+18 TO 23+50
PROPOSED ROADWAY