

**METRIC**

CONST. REV. \_\_\_\_\_  
R/W REV. \_\_\_\_\_

PROJECT REFERENCE NO. <b>R 5/3C</b>	SHEET NO. <b>30</b>
RW SHEET NO.	
ROADWAY DESIGN ENGINEER	HYDRAULICS ENGINEER
<b>PRELIMINARY PLANS</b> DO NOT USE FOR CONSTRUCTION <b>INCOMPLETE PLANS</b> DO NOT USE FOR R/W ACQUISITION	

ADAPTED FROM:  
TGS ENGINEERS  
SUITE 141  
975 WALNUT STREET  
CARY, NC 27511

PREPARED BY:  
**CATLIN**  
ENGINEERS and SCIENTISTS  
WILMINGTON, NORTH CAROLINA

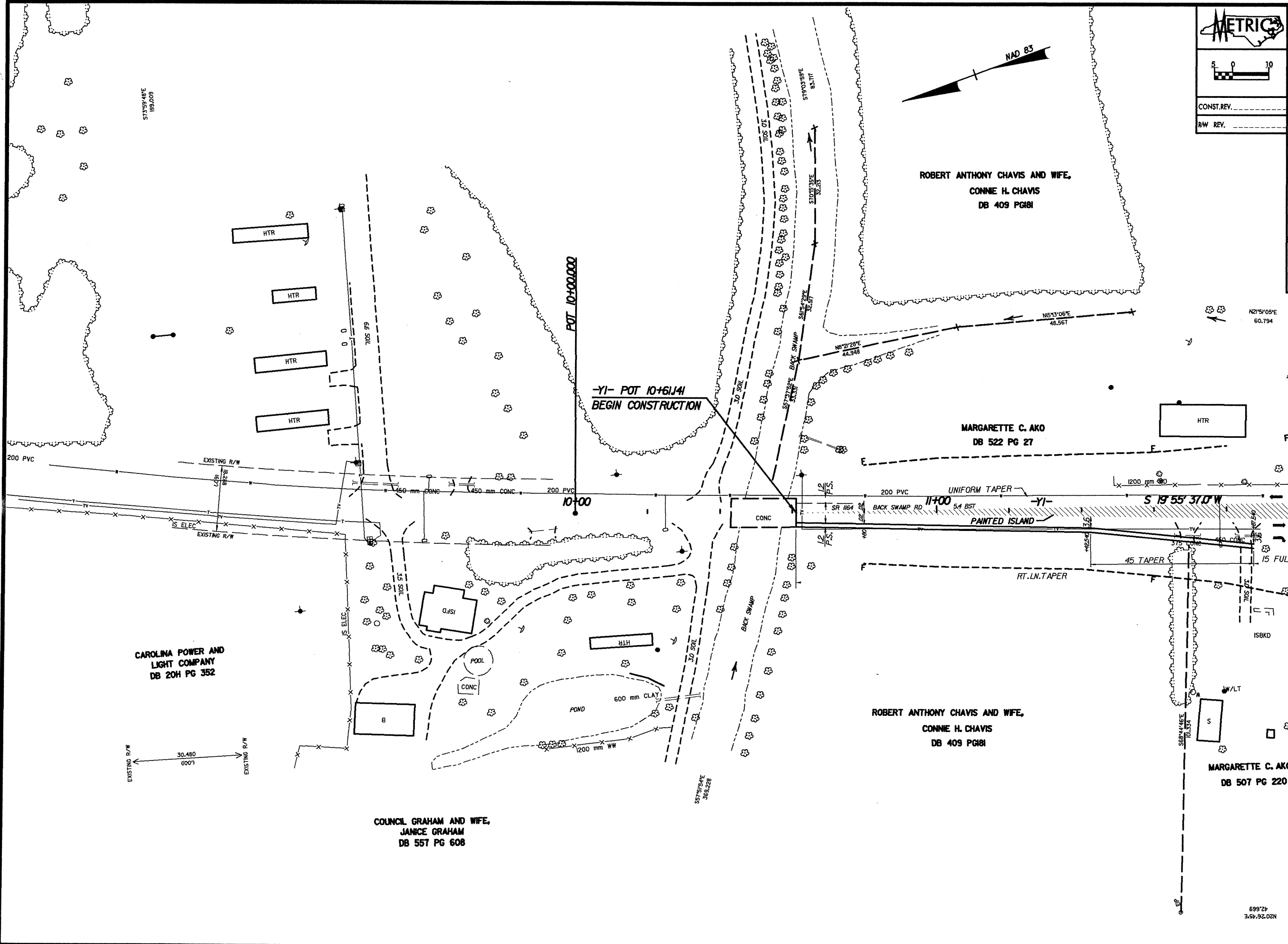

MATCHLINE STA 12 + 00.000 MATCH TO SHT. NO. 6

CAROLINA POWER AND LIGHT COMPANY  
DB 20H PG 352

COUNCIL GRAHAM AND WIFE,  
JANICE GRAHAM  
DB 557 PG 608

ROBERT ANTHONY CHAVIS AND WIFE,  
CONNIE H. CHAVIS  
DB 409 PG81

MARGARETTE C. AHO  
DB 522 PG 27

ROBERT ANTHONY CHAVIS AND WIFE,  
CONNIE H. CHAVIS  
DB 409 PG81

MARGARETTE C. AHO  
DB 507 PG 220

42.669  
N20°26'45"E