

-Y6-
 PI Sta 10+82.962
 $\Delta = 64^{\circ} 26' 00.7" (RT)$
 $L = 67.475$
 $T = 37.809$
 $R = 60.000$
 SE = AS SHOWN

PIs Sta 26+04.487
 $\Theta_s = 5^{\circ} 43' 46.5"$
 $L_s = 60.000$
 $LT = 40.021$
 $ST = 20.019$

-Y5-
 PI Sta 26+62.001
 $\Delta = 14^{\circ} 15' 47.5" (RT)$
 $L = 74.682$
 $T = 37.535$
 $R = 300.000$
 SE = 8%

PIs Sta 27+19.167
 $\Theta_s = 5^{\circ} 43' 46.5"$
 $L_s = 60.000$
 $LT = 40.021$
 $ST = 20.019$

PREPARED BY:
CALIN
 ENGINEERS and SCIENTISTS
 WILMINGTON, NORTH CAROLINA

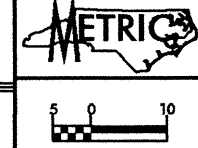

PROJECT REFERENCE NO. R 5/3C	SHEET NO. 32
R/W SHEET NO.	
ROADWAY DESIGN ENGINEER	HYDRAULICS ENGINEER
PRELIMINARY PLANS DO NOT USE FOR CONSTRUCTION	
INCOMPLETE PLANS DO NOT USE FOR R/W ACQUISITION	

TGS
 ADAPTED FROM:
 TGS ENGINEERS
 SUITE 141
 975 WALNUT STREET
 CARY, NC 27511

	1998	
	1/3	2025
	0.5	0.5
	1.5	1.5
-Y5-		
(SR 1207)		47
48		110
113		

DENOTES REMOVAL & OBLITERATION OF EXIST. PAVEMENT

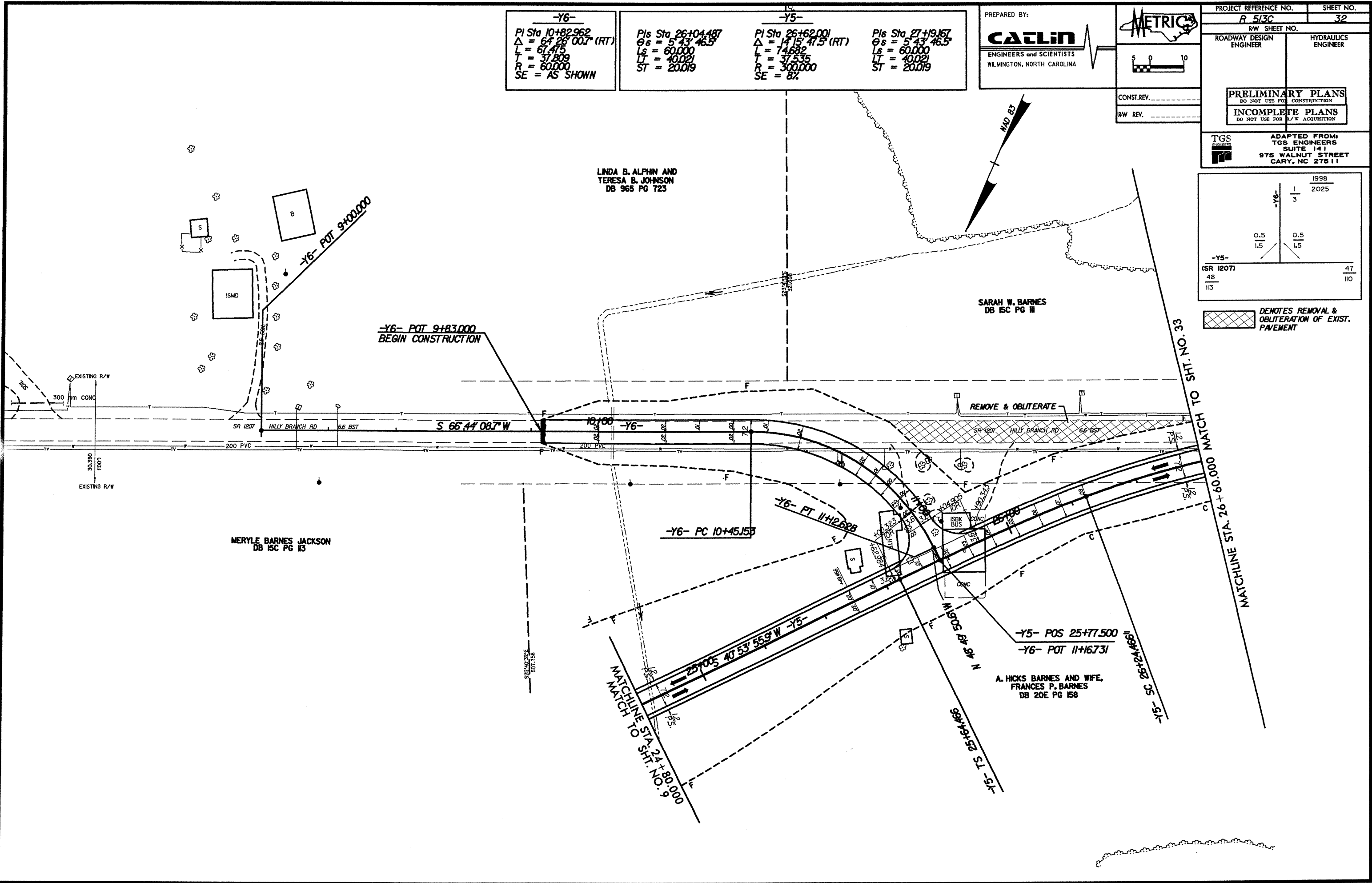

LINDA B. ALPHIN AND
 TERESA B. JOHNSON
 DB 965 PG 723

SARAH W. BARNES
 DB 15C PG 11

MERYLE BARNES JACKSON
 DB 15C PG 13

A. HICKS BARNES AND WIFE,
 FRANCES P. BARNES
 DB 20E PG 158

 SYSTEMS
 11/11/2025 10:00:00
 11/11/2025 10:00:00
