

Pls Sta 11+59.464 $\theta_s = 3' 41'' 18.9$ $L_s = 150.000$ $LT = 100.022$ $ST = 50.020$	-Y2- Pls Sta 14+38.589 $\Delta = 22' 15'' 18.7$ (LT) $L = 452.517$ $T = 229.147$ $R = 1,165.000$	Pls Sta 17+11.979 $\theta_s = 3' 41'' 18.9$ $L_s = 150.000$ $LT = 100.022$ $ST = 50.020$	Pls Sta 11+48.906 $\theta_s = 3' 43'' 13.8$ $L_s = 150.000$ $LT = 100.022$ $ST = 50.020$	-Y2- LT Pls Sta 14+25.395 $\Delta = 22' 17'' 28.8$ (LT) $L = 447.345$ $T = 226.511$ $R = 1,155.000$ $SE = 5\%$	Pls Sta 16+96.249 $\theta_s = 3' 43'' 13.8$ $L_s = 150.000$ $LT = 100.022$ $ST = 50.020$	-Y2- RT Pls Sta 11+71.345 $\theta_s = 3' 40'' 22.1$ $L_s = 150.000$ $LT = 100.022$ $ST = 50.020$	Pls Sta 14+51.788 $\Delta = 22' 17'' 12.2$ (LT) $L = 455.103$ $T = 230.465$ $R = 1,170.000$ $SE = 5\%$	Pls Sta 17+26.446 $\theta_s = 3' 40'' 22.1$ $L_s = 150.000$ $LT = 100.022$ $ST = 50.020$
--	---	--	--	--	--	---	---	--

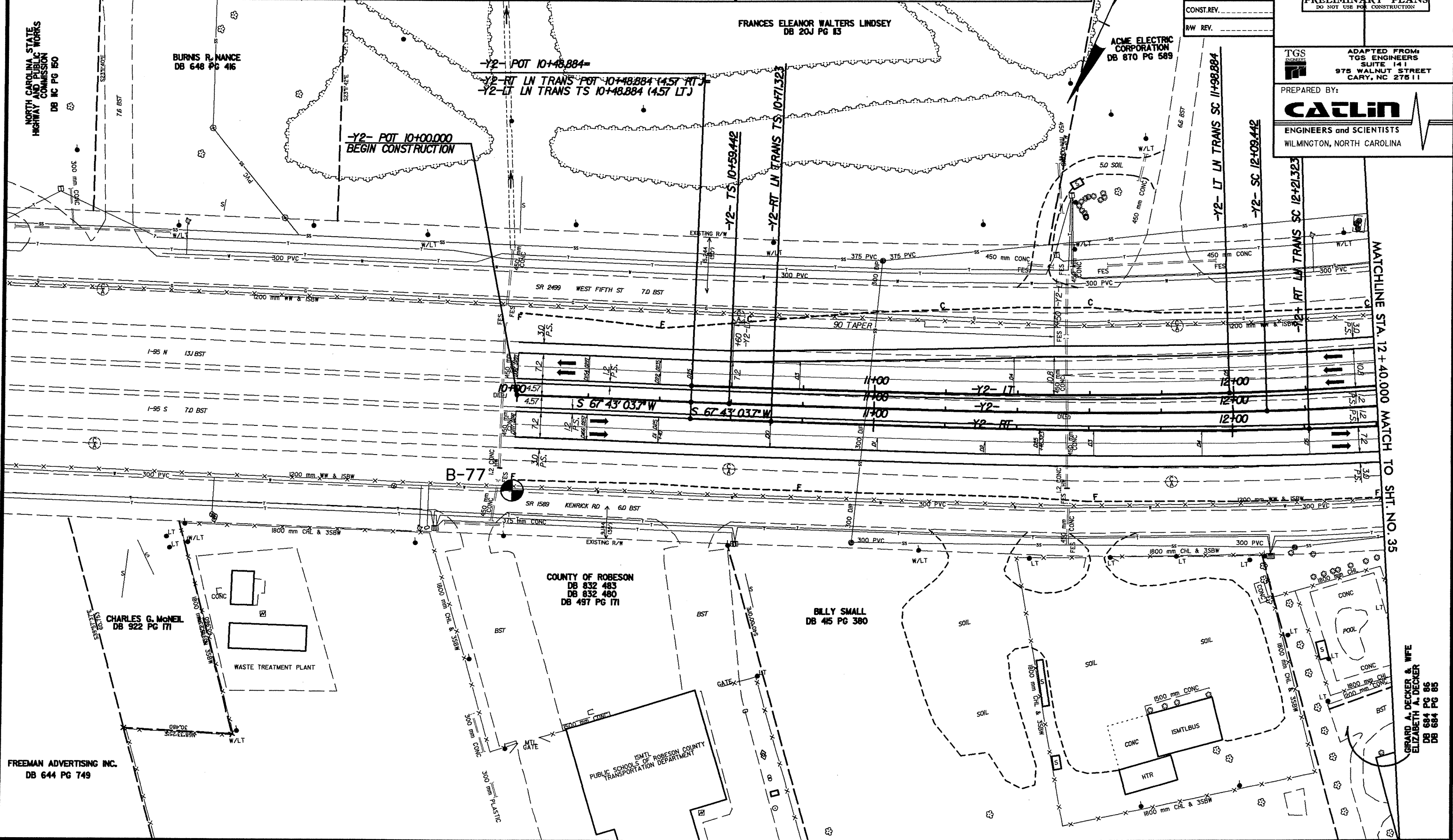

PROJECT REFERENCE NO. R 513C	SHEET NO. 34
ROADWAY DESIGN ENGINEER	HYDRAULICS ENGINEER
PRELIMINARY PLANS DO NOT USE FOR CONSTRUCTION	
TGS ENGINEERS ADAPTED FROM: TGS ENGINEERS SUITE 141 975 WALNUT STREET CARY, NC 27511	
PREPARED BY: CALIN ENGINEERS and SCIENTISTS WILMINGTON, NORTH CAROLINA	



FREEMAN ADVERTISING INC.
DB 644 PG 749

GIRARD A. DECKER & WIFE
ELIZABETH A. DECKER
DB 684 PG 86
DB 684 PG 85