

POURING SEQUECE

CONCRETE QUANTITY BREAKDOWN			
POUR 1	POUR 2	POUR 3	POUR 4
100.2 CUBIC METERS	170.1 CUBIC METERS	164.6 CUBIC METERS	224.9 CUBIC METERS

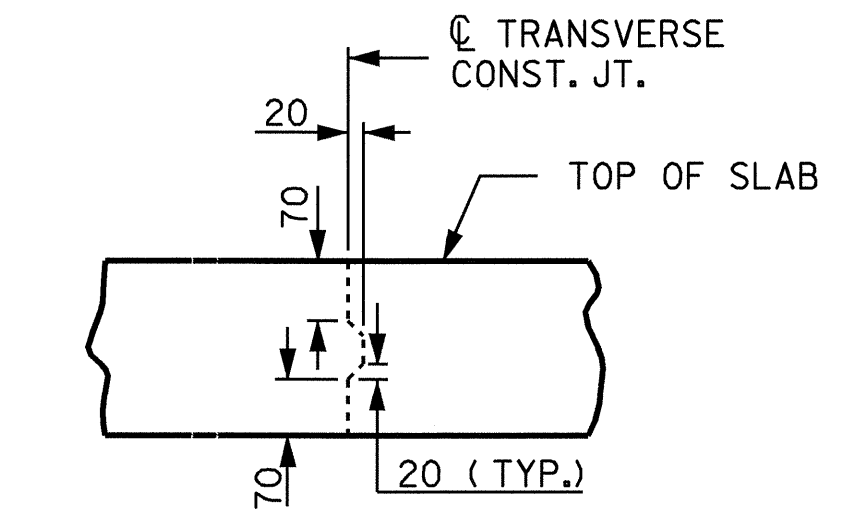

TRANSVERSE CONSTRUCTION JOINT DETAIL
SLAB REINFORCING STEEL SHALL BE CONTINUOUS THRU JOINT

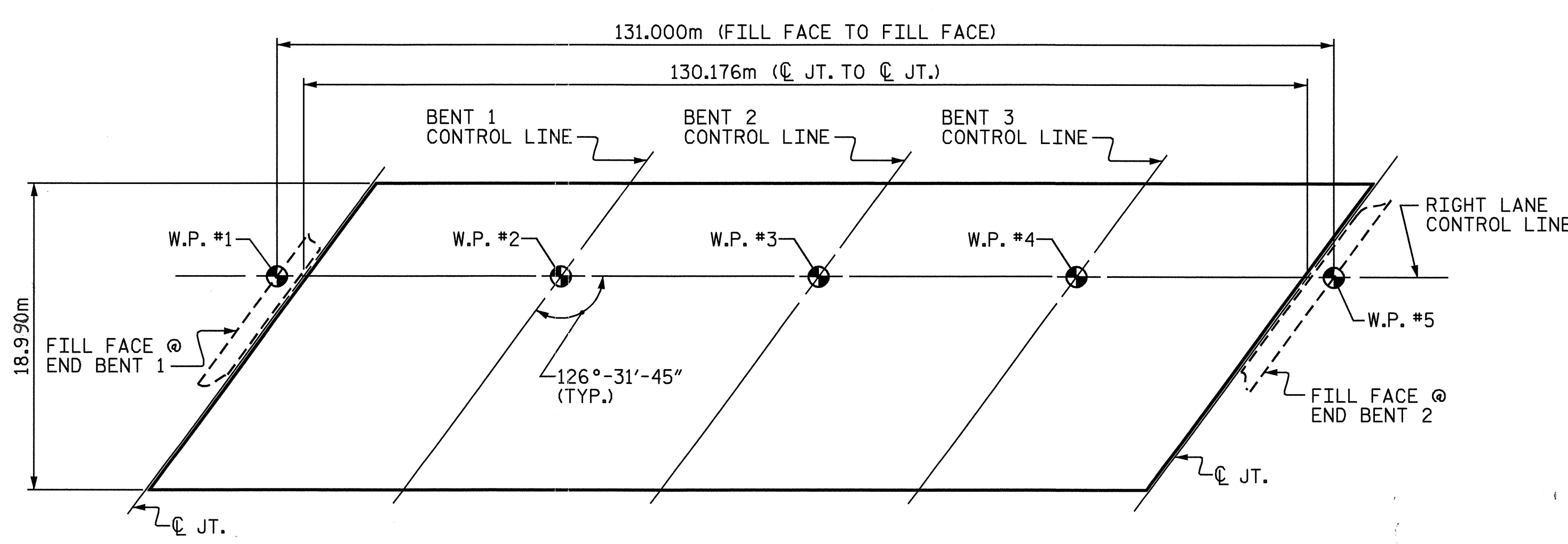

LAYOUT FOR COMPUTING AREA
OF REINFORCED CONCRETE DECK SLAB
(SQ. METER = 2465.5)

ASSEMBLED BY : T.A. WALTER	DATE : 9/28/00
CHECKED BY : N.O. TRAN	DATE : 11/01/02
DRAWN BY : JMB 5/87	REV. 5/16/97 EEM/RGW
CHECKED BY : SJD 9/87	

REINFORCING BAR SCHEDULE

BAR NO.	SIZE	TYPE	LENGTH	WEIGHT	BAR NO.	SIZE	TYPE	LENGTH	WEIGHT
* A1	1550	16	STR	9820	23623				
A2	1550	16	STR	9760	23479				
* A3	6	19	STR	5880	79				
* A101	12	16	STR	9520	177				
* A102	6	16	STR	17640	164				
* A103	6	16	STR	17040	159				
* A104	6	16	STR	16440	153				
* A105	6	16	STR	15820	147				
* A106	6	16	STR	15220	142				
* A107	6	16	STR	14600	136				
* A108	6	16	STR	14000	130				
* A109	6	16	STR	13400	125				
* A110	6	16	STR	12780	119				
* A111	6	16	STR	12180	113				
* A112	6	16	STR	11580	108				
* A113	6	16	STR	10960	102				
* A114	6	16	STR	10360	96				
* A115	6	16	STR	9740	91				
* A116	6	16	STR	9140	85				
* A117	6	16	STR	8540	80				
* A118	6	16	STR	7920	74				
* A119	6	16	STR	7320	68				
* A120	6	16	STR	6720	63				
* A121	6	16	STR	6100	57				
* A122	6	16	STR	5500	51				
* A123	6	16	STR	4880	45				
* A124	6	16	STR	4280	40				
* A125	6	16	STR	3680	34				
* A126	6	16	STR	3060	28				
* A127	6	16	STR	2460	23				
* A128	6	16	STR	1860	17				
* A129	6	16	STR	1240	12				
* A130	6	16	STR	640	6				
A201	12	16	STR	9460	176				
A202	6	16	STR	17640	164				
A203	6	16	STR	17040	159				
A204	6	16	STR	16440	153				
A205	6	16	STR	15820	147				
A206	6	16	STR	15220	142				
A207	6	16	STR	14600	136				
A208	6	16	STR	14000	130				
A209	6	16	STR	13400	125				
A210	6	16	STR	12780	119				
A211	6	16	STR	12180	113				
A212	6	16	STR	11580	108				
A213	6	16	STR	10960	102				
A214	6	16	STR	10360	96				
A215	6	16	STR	9740	91				
A216	6	16	STR	9140	85				
A217	6	16	STR	8540	80				
A218	6	16	STR	7920	74				
A219	6	16	STR	7320	68				
A220	6	16	STR	6720	63				
A221	6	16	STR	6100	57				
A222	6	16	STR	5500	51				
A223	6	16	STR	4880	45				
A224	6	16	STR	4280	40				
A225	6	16	STR	3680	34				
A226	6	16	STR	3060	28				
A227	6	16	STR	2460	23				
A228	6	16	STR	1860	17				
A229	6	16	STR	1240	12				
A230	6	16	STR	640	6				
* B1	129	13	STR	8620	1105				
* B2	166	22	STR	11600	5858				
* B3	166	13	STR	6820	1125				
* B4	83	22	STR	17400	4393				
* B5	166	13	STR	7420	1224				
* B6	166	22	STR	11100	5605				
* B7	129	13	STR	7820	1003				
B8	680	16	STR	16840	17772				
* G1	4	16	STR	12120	75				
J1	150	13	4	440	66				
* K1	8	16	1	2560	32				
* K2	16	16	2	2600	65				
K3	20	16	STR	3580	111				
* S1	120	13	3	1200	143				
REINFORCING STEEL									kg. 44072
* EPOXY COATED REINFORCING STEEL									kg. 46975

* THESE BARS ARE EPOXY COATED

BAR TYPES

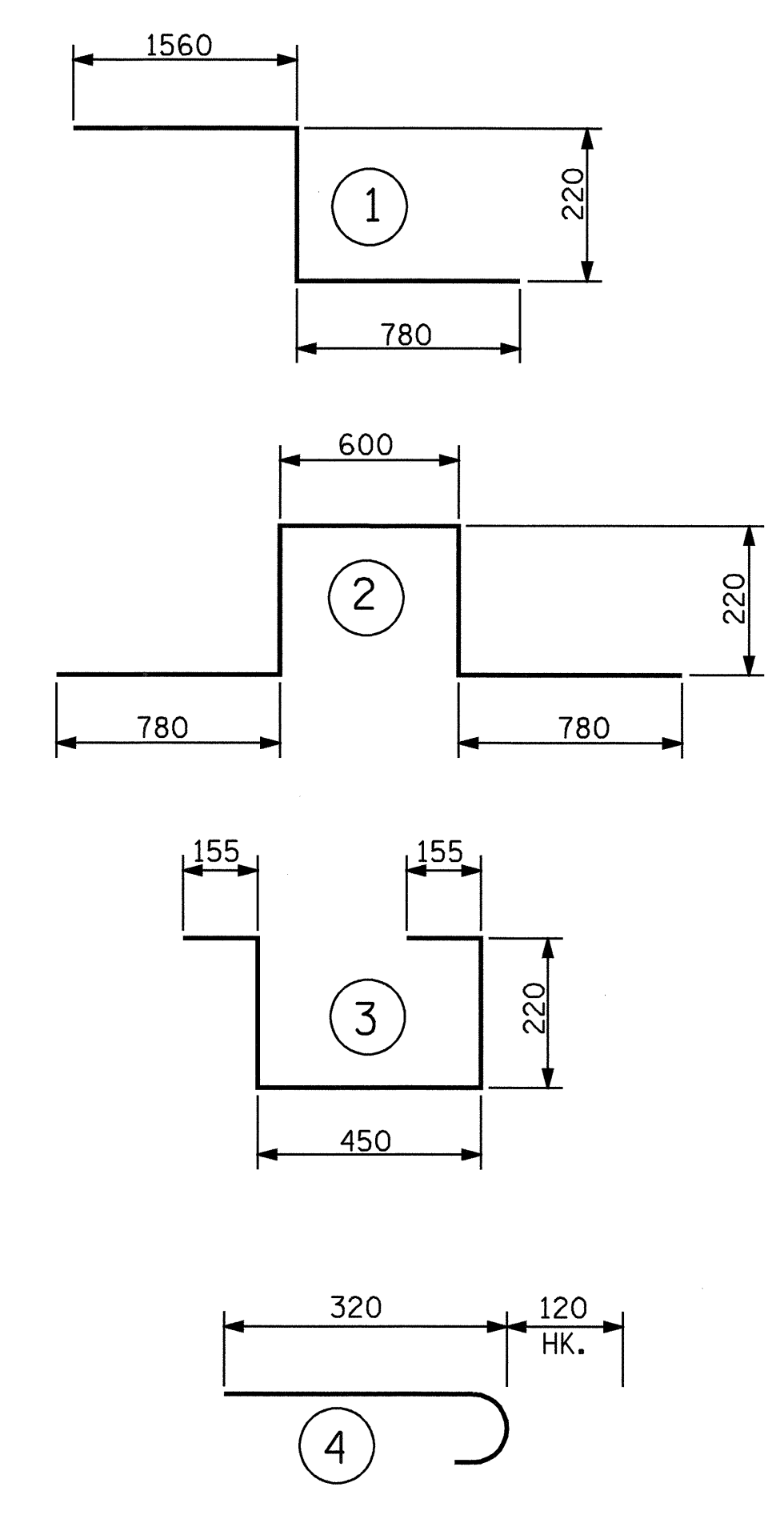

ALL BAR DIMENSIONS ARE OUT TO OUT

GROOVING BRIDGE FLOORS	
BRIDGE DECK *	2520.0 SQ.METER
TOTAL	2520.0 SQ.METER

* INCLUDES QUANTITY ON APPROACH SLABS

BAR SIZE	SUPERSTRUCTURE EXCEPT APPROACH SLABS, PARAPET, AND BARRIER RAIL		APPROACH SLABS		PARAPET AND BARRIER RAIL
	EPOXY COATED	UNCOATED	EPOXY COATED	UNCOATED	
#13	610	540	610	540	840
#16	770	660	770	660	1050
#19	920	790	1190	790	1330
#22	1580	1060			
#25	2080	1390			

SUPERSTRUCTURE REINFORCING STEEL LENGTHS ARE BASED ON THE FOLLOWING MINIMUM SPLICE LENGTHS

	CLASS AA CONCRETE	REINFORCING STEEL	EPOXY COATED REINFORCING STEEL
	(CU.METER)	(kg)	(kg)
SPAN A-D	695.8	44,072	46,975
TOTALS**	695.8	44,072	46,975

** QUANTITIES FOR BARRIER RAIL ARE NOT INCLUDED

PROJECT NO. R-513C
ROBESON COUNTY
STATION: 277+68.339 -L-

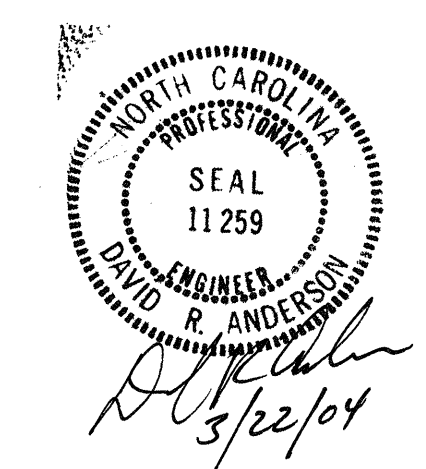

STATE OF NORTH CAROLINA
DEPARTMENT OF TRANSPORTATION
RALEIGH
SUPERSTRUCTURE BILL OF MATERIAL (RIGHT LANE)

REVISIONS				SHEET NO.
NO.	BY:	DATE:	NO.	
1			3	9-190
2			4	
TOTAL SHEETS				312