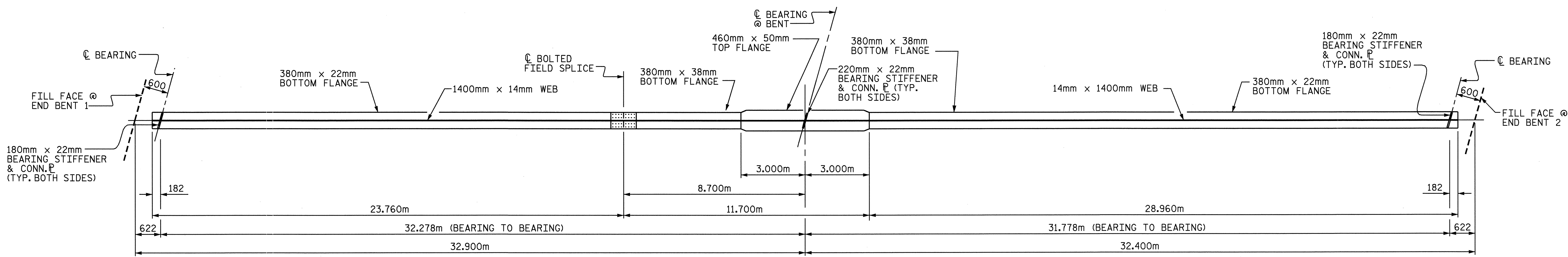
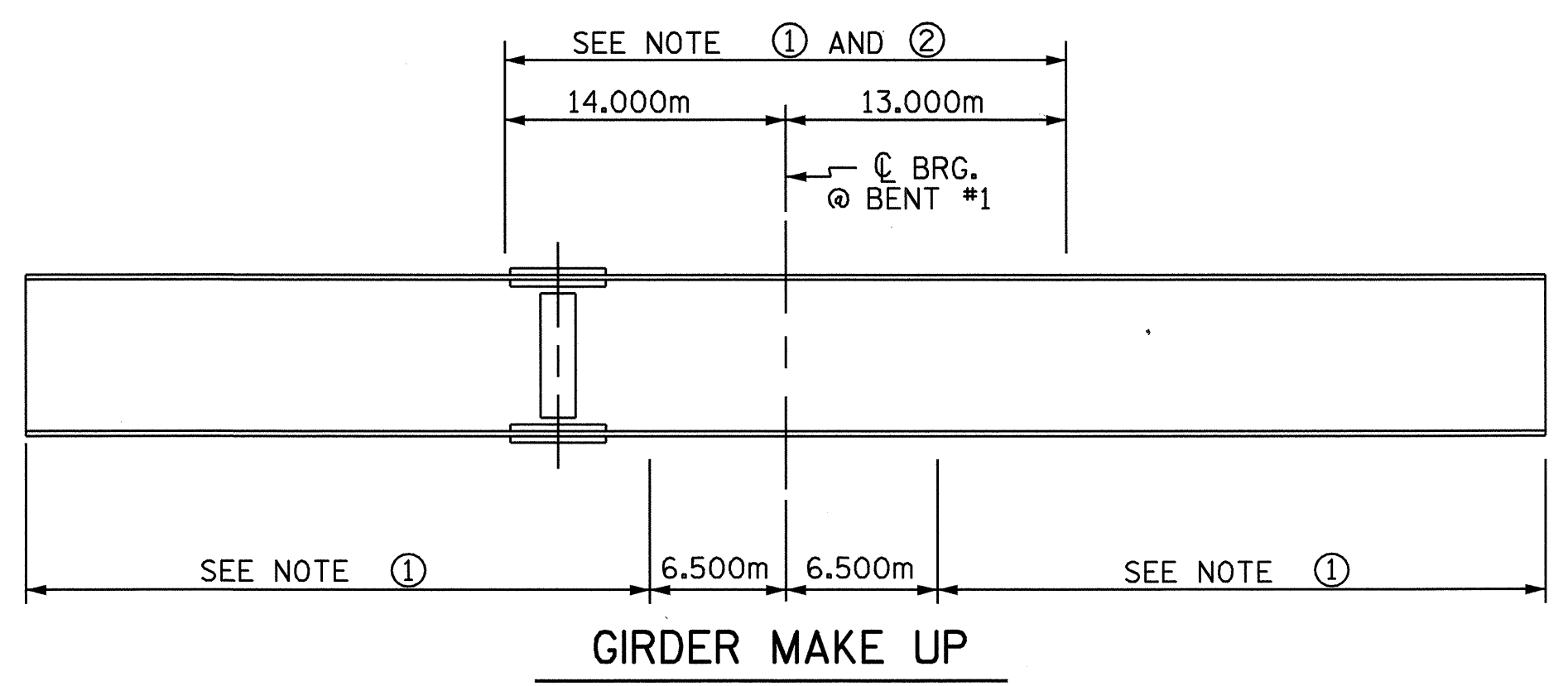
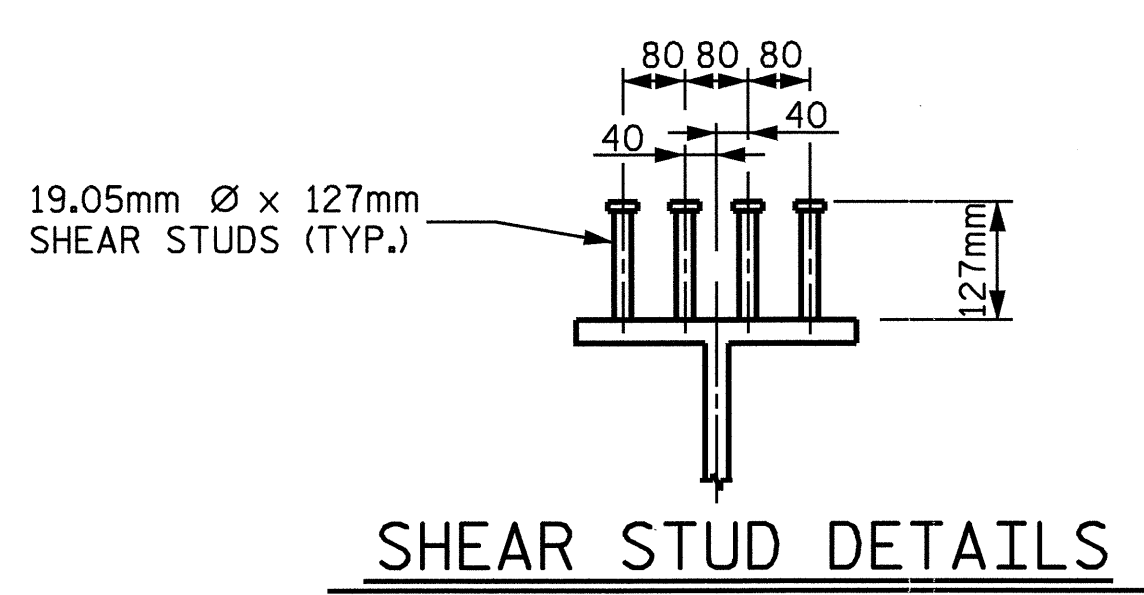

**PLATE GIRDER ELEVATION**  
(STUDS ON BOLTED FIELD SPLICE NOT SHOWN)



**BOTTOM FLANGE DETAIL**



NOTE ① : CHARPY V-NOTCH TESTS ARE REQUIRED FOR ALL TOP OR BOTTOM FLANGE PLATES WHICH FALL WITHIN THESE LIMITS, ALL WEB PLATES, AND ALL SPLICE PLATES. IF A PERMITTED SHOP FLANGE SPLICE IS NOT USED, CHARPY V-NOTCH TESTS WILL BE REQUIRED FOR THE ENTIRE FLANGE PLATE. FOR CHARPY V-NOTCH TESTS, SEE ARTICLE 1072-9 OF THE STANDARD SPECIFICATIONS.

NOTE ② : NO WELDING OF FORMS OR FALSEWORK TO THE TOP FLANGE WILL BE PERMITTED IN THIS REGION.

**CHARPY V-NOTCH TESTS FOR CONTINUOUS PLATE GIRDERS**

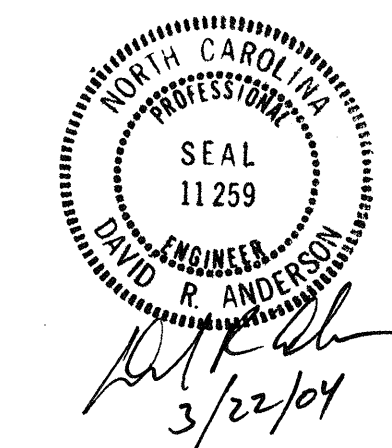
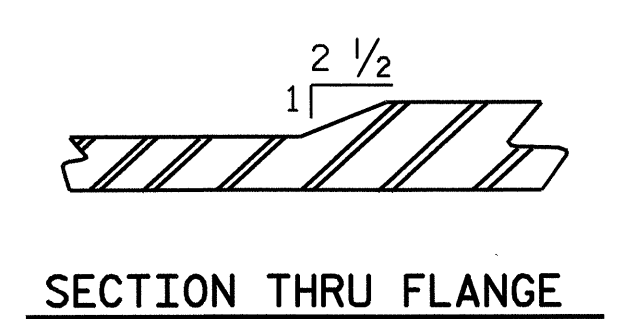
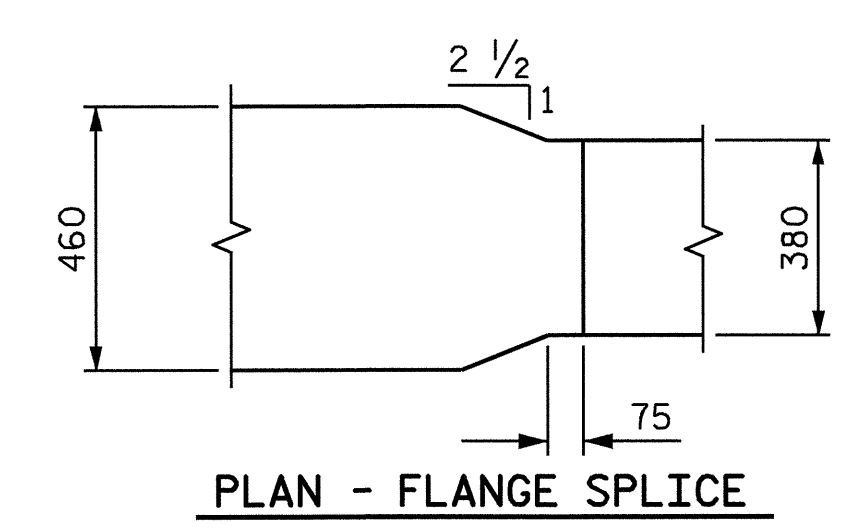

PROJECT NO. R-513C  
ROBESON COUNTY  
STATION: 318+10.648 -L-

SHEET 1 OF 3

STATE OF NORTH CAROLINA  
DEPARTMENT OF TRANSPORTATION  
RALEIGH

**SUPERSTRUCTURE  
STRUCTURAL STEEL**

REVISIONS					SHEET NO.
NO.	BY:	DATE:	NO.	BY:	DATE:
1			3		
2			4		

TOTAL SHEETS: 312

DRAWN BY : N. Q. TRAN DATE : JUN.01  
CHECKED BY : T. A. WALTER DATE : 10-24-02