

BM *4 RR SPIKE IN BASE OF 750mm PINE
86.610 RT OF -L- STA.284+93.432 EL= 42.011

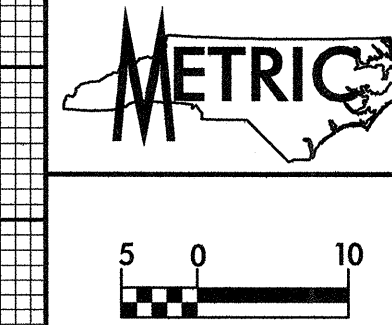

PROJECT REFERENCE NO. R-513C	SHEET NO. 104
ROADWAY DESIGN ENGINEER	HYDRAULICS ENGINEER
CONST. REV.	
R / W REV.	

TGS ENGINEERS
975 WALNUT STREET, SUITE 141
CARY, NC 27511
PH (919) 319-8850

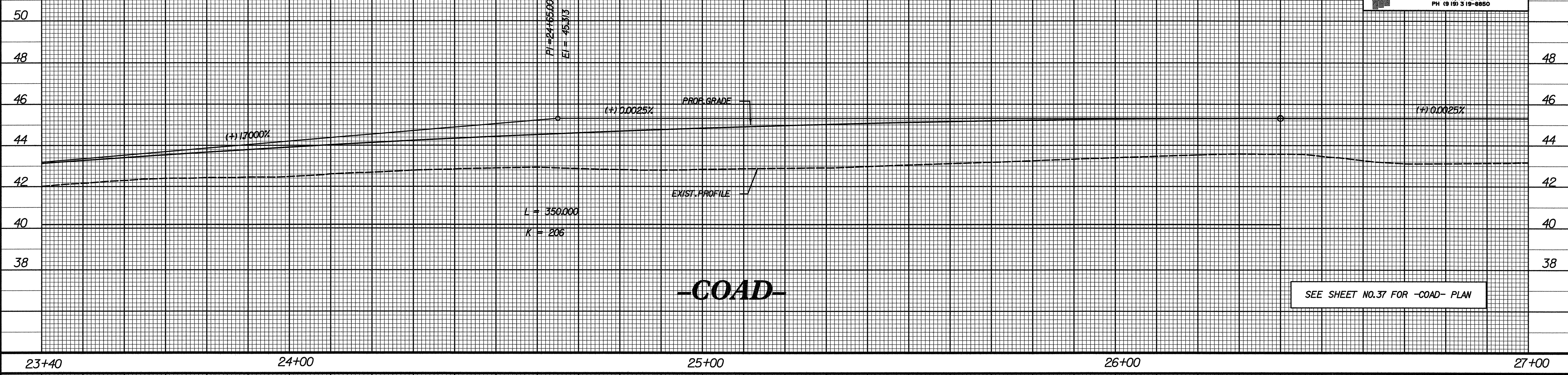

SEE SHEET NO.37 FOR -COAD- PLAN

BM *4 RR SPIKE IN BASE OF 750mm PINE
86.610 RT OF -L- STA.284+93.432 EL= 42.011

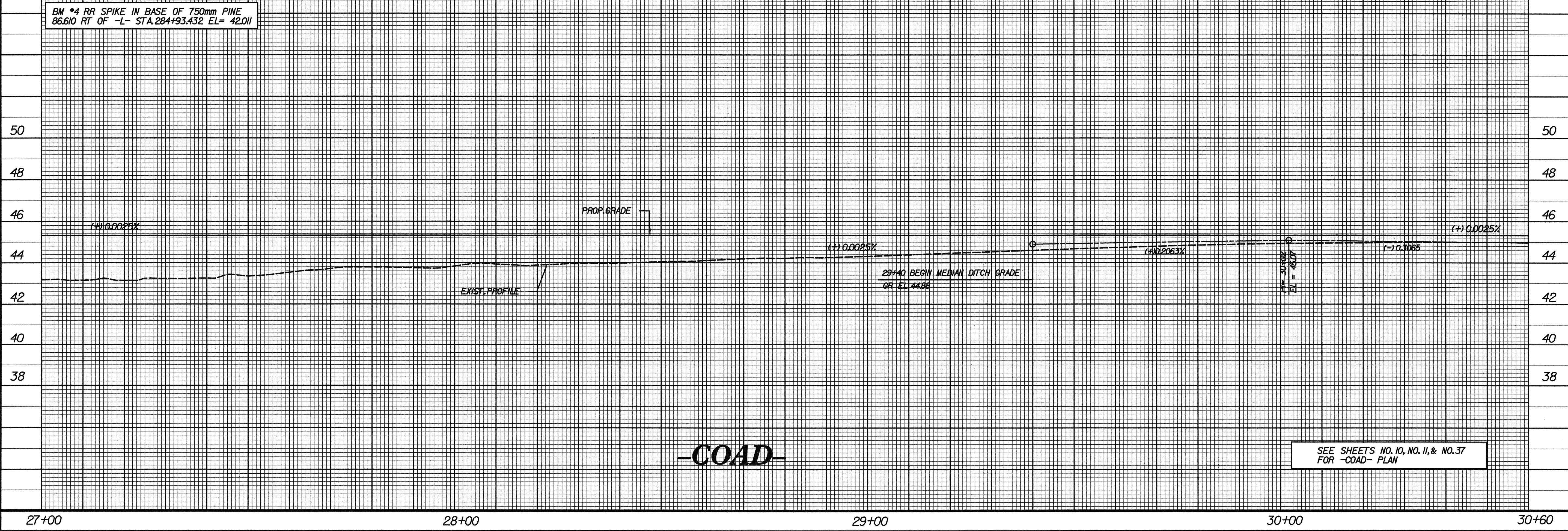

SEE SHEETS NO.10, NO.11, & NO.37 FOR -COAD- PLAN

\$\$\$\$\$SYTIME\$\$\$\$\$
\$\$\$\$\$DGN\$\$\$\$\$
\$\$\$\$\$L\$\$\$\$\$
\$\$\$\$\$MINI\$\$\$\$\$
\$\$\$\$\$US\$\$\$\$\$
\$\$\$\$\$N\$\$\$\$\$
\$\$\$\$\$A\$\$\$\$\$
\$\$\$\$\$L\$\$\$\$\$
\$\$\$\$\$\$\$\$\$\$