

**UTILITY CONSTRUCTION**

**-L-**  
 Pls Sta 287+56.600 PI Sta 290+71.002 Pls Sta 293+78.672  
 $\theta s = 2' 33'' 28.3''$   $\Delta = 22' 02'' 53.6''$  (LT)  $\theta s = 2' 33'' 28.3''$   
 $Ls = 125.000$   $L = 538.740$   $Ls = 125.000$   
 $LT = 83.342$   $T = 272.744$   $LT = 83.342$   
 $ST = 41.675$   $R = 1,400.000$   $ST = 41.675$   
 $SE = 4\%$

**-Y8-**  
 Pls Sta 18+33.523 PI Sta 21+11.541 Pls Sta 23+63.120  
 $\theta s = 2' 31'' 04.2''$   $\Delta = 18' 31'' 40.1''$  (LT)  $\theta s = 1' 11'' 22.3''$   
 $Ls = 127.000$   $L = 467.271$   $Ls = 60.000$   
 $LT = 84.675$   $T = 235.693$   $LT = 40.001$   
 $ST = 42.341$   $R = 1,445.000$   $ST = 20.001$   
 $SE = 3\%$

**RAMP B**  
 Pls Sta 0+35.107 PI Sta 1+25.158 Pls Sta 2+09.426  
 $\theta s = 5' 03'' 47.5''$   $\Delta = 16' 28'' 40.6''$  (LT)  $\theta s = 3' 49'' 11.0''$   
 $Ls = 60.000$   $L = 129.418$   $Ls = 60.000$   
 $R1=1382.300$   $T = 65.158$   $LT = 40.009$   
 $R2=450.000$   $R = 450.000$   $ST = 20.008$   
 $LT = 35.107$   $SE = 6\%$   
 $ST = 24.930$

**RAMP "C"**  
 Pls Sta 0+20.001  
 $\theta s = 1' 12'' 44.8''$   
 $Ls = 60.000$   
 $LT = 40.001$   
 $ST = 20.001$   
 $R=1417.700$   
 $SE=4\%$

**PROP. 95M-600MM STEEL ENCASEMENT PIPE, 6.35MM THICK BY OPEN CUT**

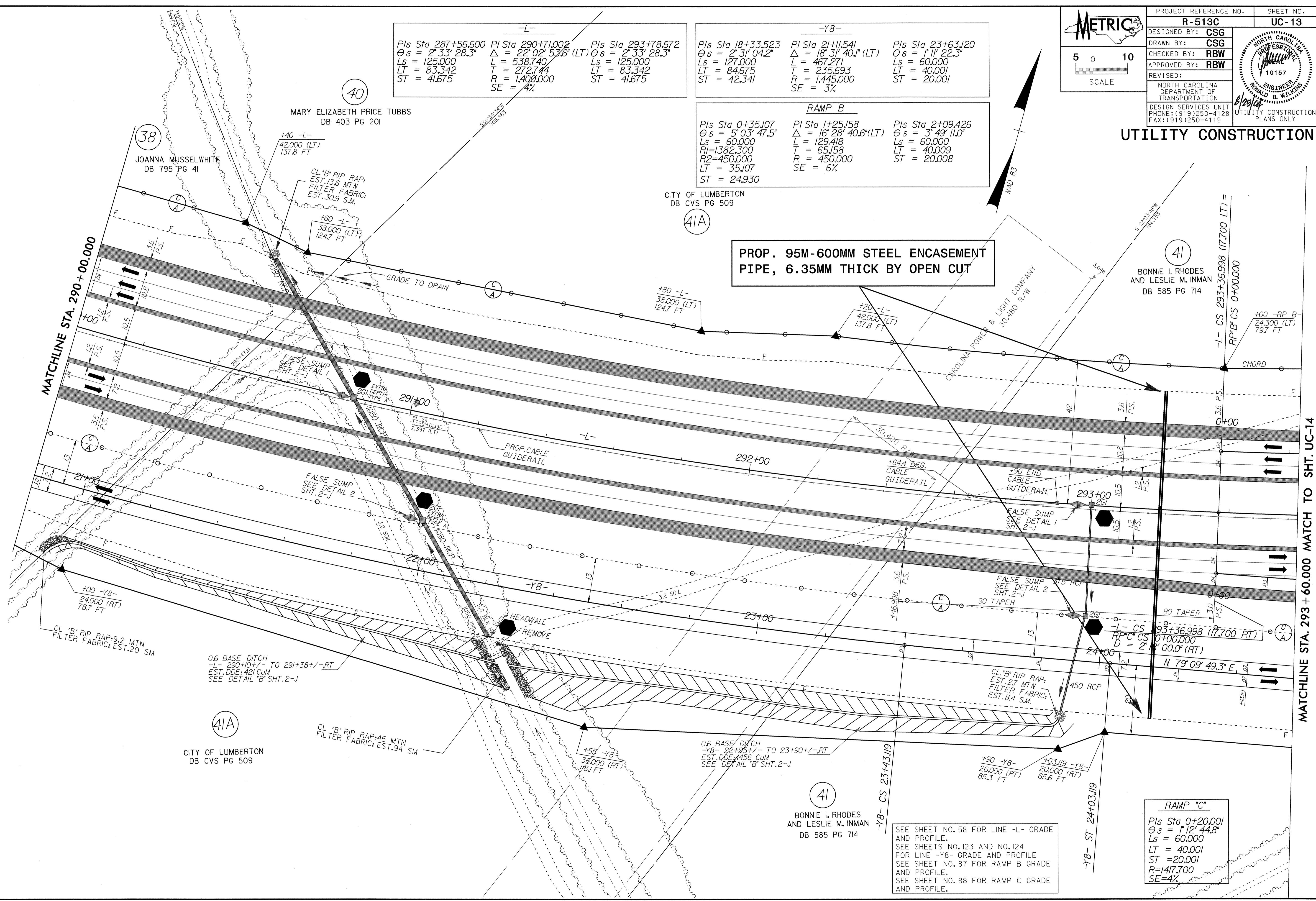

(38) JOANNA MUSSELWHITE  
 DB 795 PG 41

(40) MARY ELIZABETH PRICE TUBBS  
 DB 403 PG 201

(41A) CITY OF LUMBERTON  
 DB CVS PG 509

(41) BONNIE I. RHODES  
 AND LESLIE M. INMAN  
 DB 585 PG 714

(41A) CITY OF LUMBERTON  
 DB CVS PG 509

(41) BONNIE I. RHODES  
 AND LESLIE M. INMAN  
 DB 585 PG 714

SEE SHEET NO. 58 FOR LINE -L- GRADE AND PROFILE.  
 SEE SHEETS NO. 123 AND NO. 124 FOR LINE -Y8- GRADE AND PROFILE.  
 SEE SHEET NO. 87 FOR RAMP B GRADE AND PROFILE.  
 SEE SHEET NO. 88 FOR RAMP C GRADE AND PROFILE.