

NOTE:
 ALL PROPOSED UTILITY WORK
 SHOWN ON THIS SHEET WILL
 BE DONE BY OTHERS

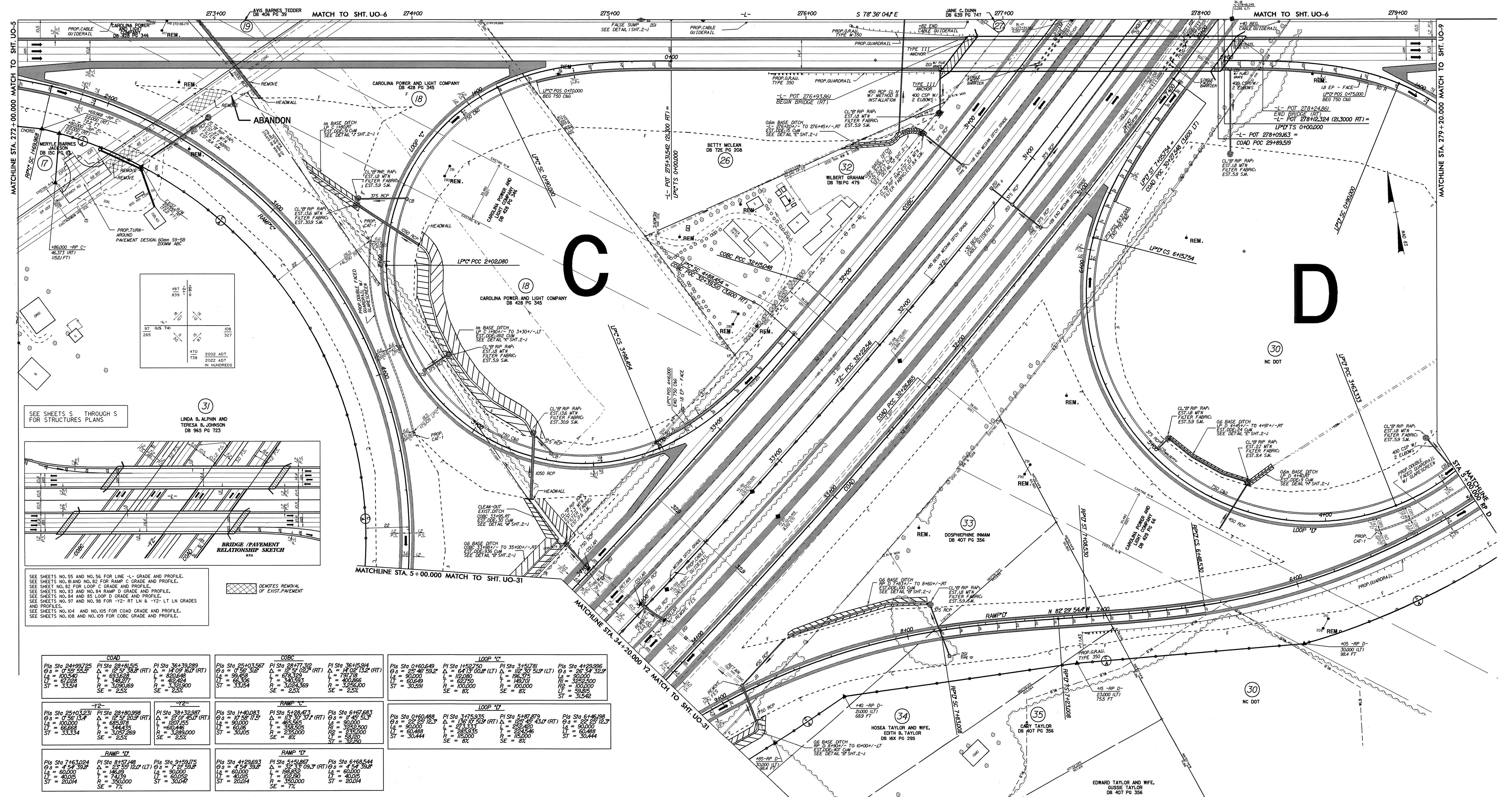

SEE SHEETS S THROUGH S FOR STRUCTURES PLANS

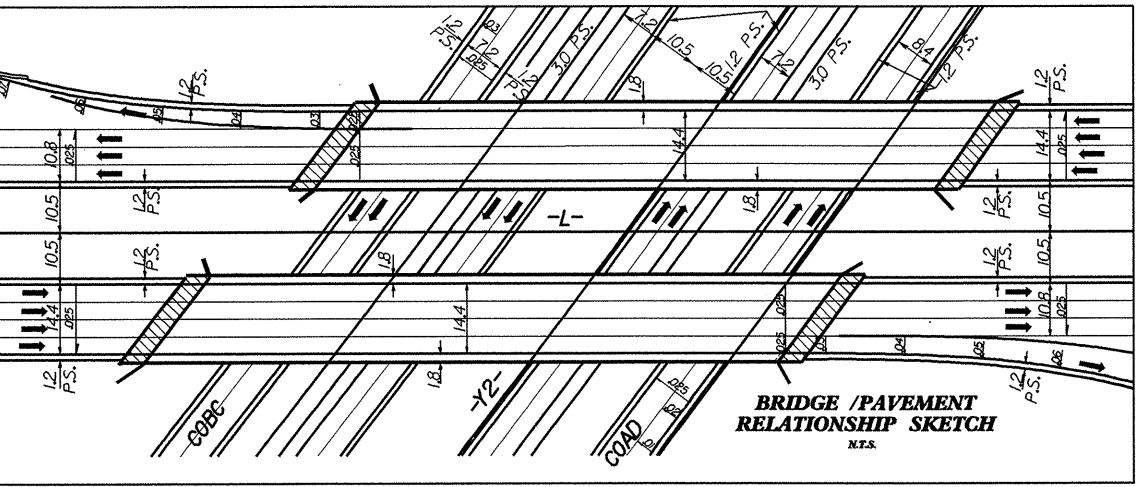

SEE SHEETS NO. 55 AND NO. 56 FOR LINE -L- GRADE AND PROFILE.
 SEE SHEETS NO. 8 AND NO. 82 FOR RAMP C GRADE AND PROFILE.
 SEE SHEET NO. 83 FOR LOOP C GRADE AND PROFILE.
 SEE SHEETS NO. 83 AND NO. 84 RAMP D GRADE AND PROFILE.
 SEE SHEETS NO. 84 AND 85 LOOP D GRADE AND PROFILE.
 SEE SHEETS NO. 97 AND NO. 98 FOR -Y2- RT LN & -Y2- LT LN GRADES AND PROFILES.
 SEE SHEETS NO. 104 AND NO. 105 FOR COAD GRADE AND PROFILE.
 SEE SHEETS NO. 108 AND NO. 109 FOR COBC GRADE AND PROFILE.

| | | | | | |
|--|---|---|--|--|--|
| <p>COAD</p> <p>PI Sta 24+997.25 PI Sta 28+81.515 $\Delta = 12.57$ (RT) $\Delta = 12.57$ (RT) $\theta_s = 0.57$ 35.5' $\theta_s = 0.57$ 38.2' (RT) $L = 61.228$ $L = 40.228$ $R = 3050.269$ $R = 3050.269$ $ST = 33.544$ $SE = 2.52$</p> | <p>COBC</p> <p>PI Sta 25+035.67 PI Sta 28+77.312 $\Delta = 12.57$ (RT) $\Delta = 12.57$ (RT) $\theta_s = 0.57$ 31.6' $\theta_s = 0.57$ 31.7' (RT) $L = 79.716$ $L = 40.228$ $R = 3050.269$ $R = 3050.269$ $ST = 33.544$ $SE = 2.52$</p> | <p>LOOP 'C'</p> <p>PI Sta 0+606.49 PI Sta 1+527.750 $\Delta = 25.46$ 59.2' $\Delta = 64.17$ 100.7' (LT) $\theta_s = 0.57$ 31.6' $\theta_s = 1.22$ 51.9' (LT) $L = 110.280$ $L = 66.713$ $R = 62.500$ $R = 100.000$ $ST = 30.591$ $SE = 8.2$</p> | <p>LOOP 'D'</p> <p>PI Sta 1+527.750 PI Sta 3+451.781 $\Delta = 64.17$ 100.7' (LT) $\Delta = 112.30$ 51.9' (LT) $\theta_s = 1.22$ 51.9' (LT) $\theta_s = 2.57$ 32.9' $L = 110.280$ $L = 66.713$ $R = 100.000$ $R = 3242.500$ $ST = 30.591$ $SE = 8.2$</p> | <p>RAMP 'C'</p> <p>PI Sta 1+400.83 PI Sta 1+527.750 $\Delta = 12.57$ (RT) $\Delta = 12.57$ (RT) $\theta_s = 0.57$ 31.7' (RT) $\theta_s = 0.57$ 31.7' (RT) $L = 60.916$ $L = 40.228$ $R = 3050.269$ $R = 3050.269$ $ST = 30.005$ $SE = 8.2$</p> | <p>RAMP 'D'</p> <p>PI Sta 1+400.83 PI Sta 1+527.750 $\Delta = 12.57$ (RT) $\Delta = 12.57$ (RT) $\theta_s = 0.57$ 31.7' (RT) $\theta_s = 0.57$ 31.7' (RT) $L = 60.916$ $L = 40.228$ $R = 3050.269$ $R = 3050.269$ $ST = 30.005$ $SE = 8.2$</p> |
| <p>RAMP 'Y2'</p> <p>PI Sta 7+453.024 PI Sta 8+571.448 $\Delta = 4.57$ 39.8' $\Delta = 23.59$ 12.0' (LT) $\theta_s = 0.57$ 39.8' $\theta_s = 1.22$ 51.9' (LT) $L = 60.916$ $L = 102.896$ $R = 3050.269$ $R = 3050.269$ $ST = 20.014$ $SE = 7.2$</p> | <p>RAMP 'Y1'</p> <p>PI Sta 4+293.693 PI Sta 5+411.897 $\Delta = 23.59$ 12.0' (LT) $\Delta = 32.33$ 09.3' (RT) $\theta_s = 1.22$ 51.9' (LT) $\theta_s = 1.22$ 51.9' (RT) $L = 60.916$ $L = 102.896$ $R = 3050.269$ $R = 3050.269$ $ST = 20.014$ $SE = 7.2$</p> | | | | |

26-FEB-2004 11:42:11 AM P:\0007-513c\l.psh
 R:\JOHNSON