

AREA I - US 74

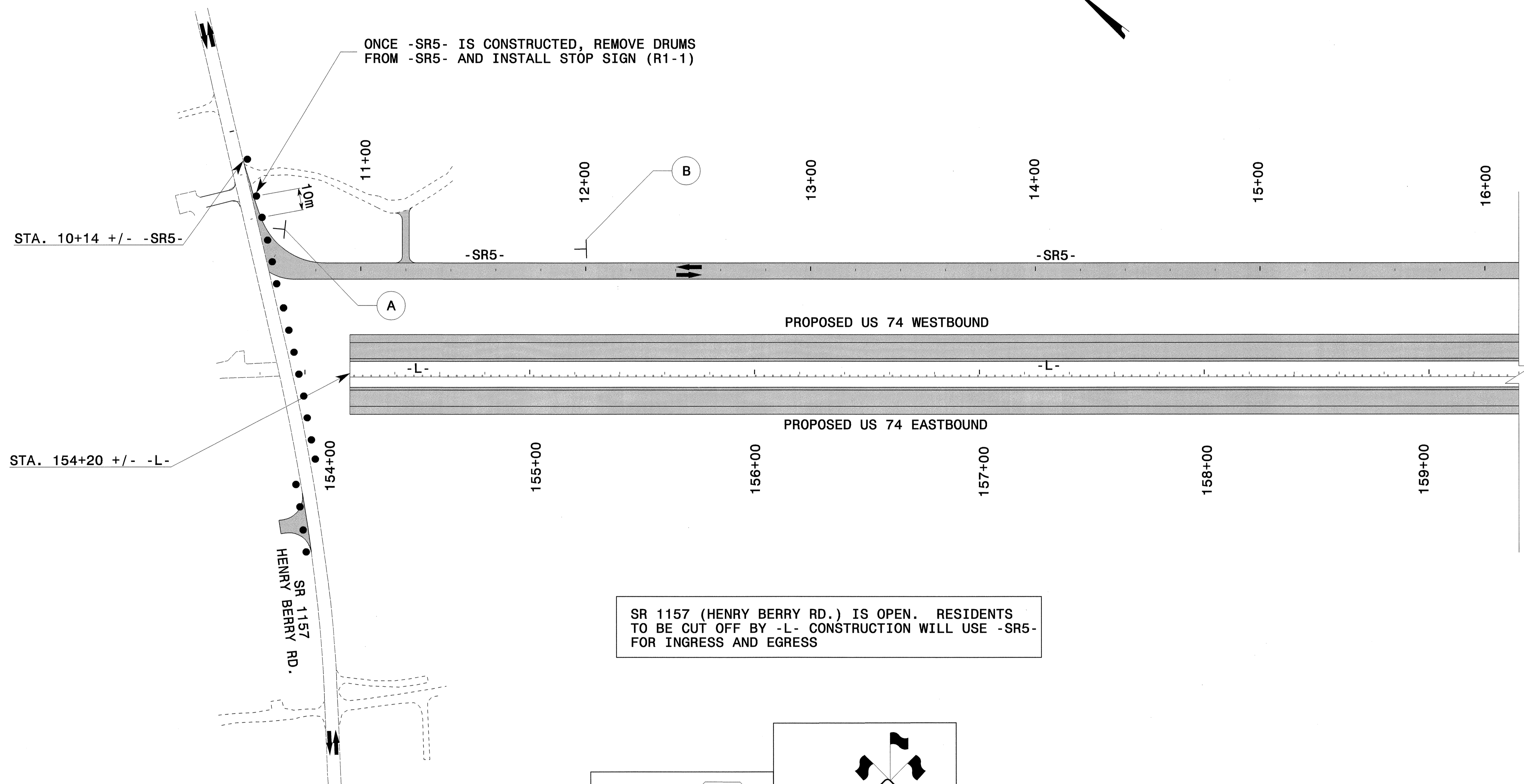

PROJ. REFERENCE NO. R-0513BB/C	SHEET NO. TCP-9
-----------------------------------	--------------------



STA. 10+14 +/- -SR5-

STA. 154+20 +/- -L-

ONCE -SR5- IS CONSTRUCTED, REMOVE DRUMS FROM -SR5- AND INSTALL STOP SIGN (R1-1)

PROPOSED US 74 WESTBOUND

PROPOSED US 74 EASTBOUND

SR 1157
HENRY BERRY RD.

SR 1157 (HENRY BERRY RD.) IS OPEN. RESIDENTS TO BE CUT OFF BY -L- CONSTRUCTION WILL USE -SR5- FOR INGRESS AND EGRESS

BREAKLINE
SEE SHEET TCP-10

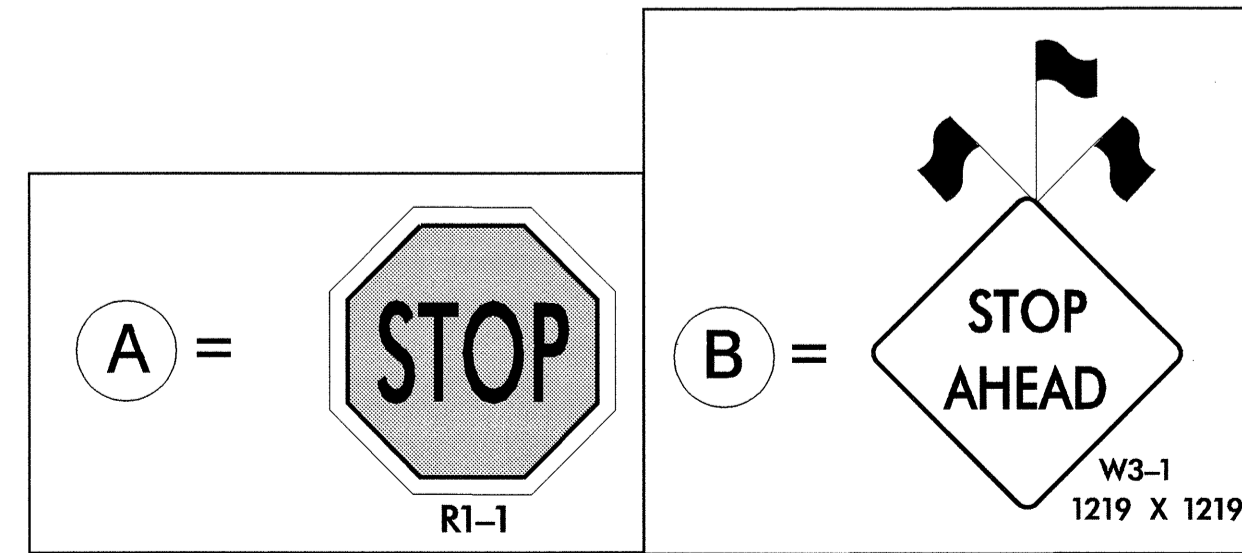

APPROVED: *John S. Kite Jr.* DATE: 6/25/04

SEAL

**PHASE I
-L- CONSTRUCTION**

SCALE: NONE		REVISIONS
DATE: JAN 04		
DWG. BY: MHS		
DESIGN BY: MHS		
REVIEWED BY: CLM		

24-JUN-2004 11:55 AM
 C:\SAPR\B13C.TC.TCP009.dgn
 M:\TECHNICAL\AT\TET\2003\