

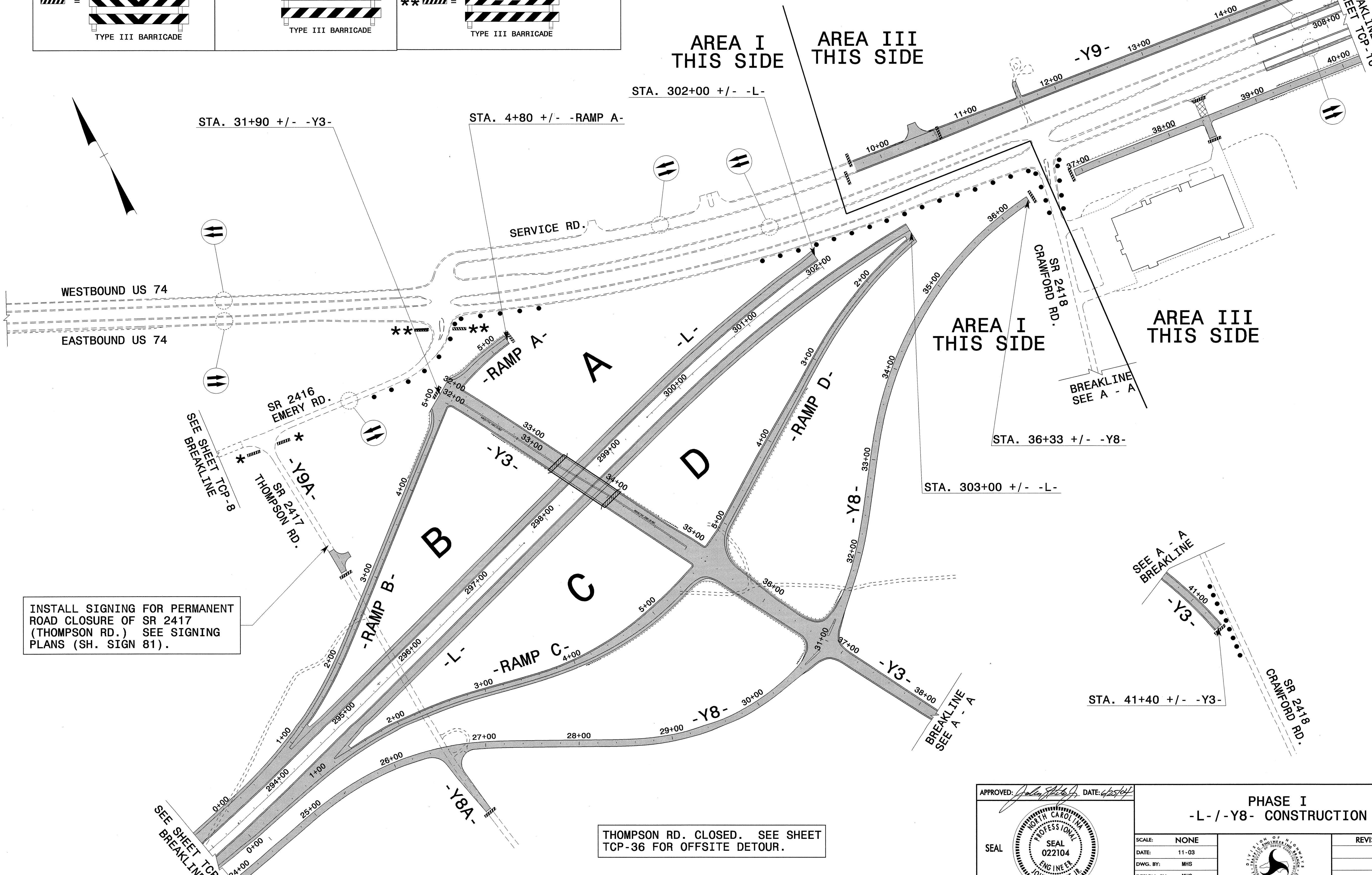

PROJ. REFERENCE NO.	SHEET NO.
R-0513BB/C	TCP-14

AREA I & AREA III

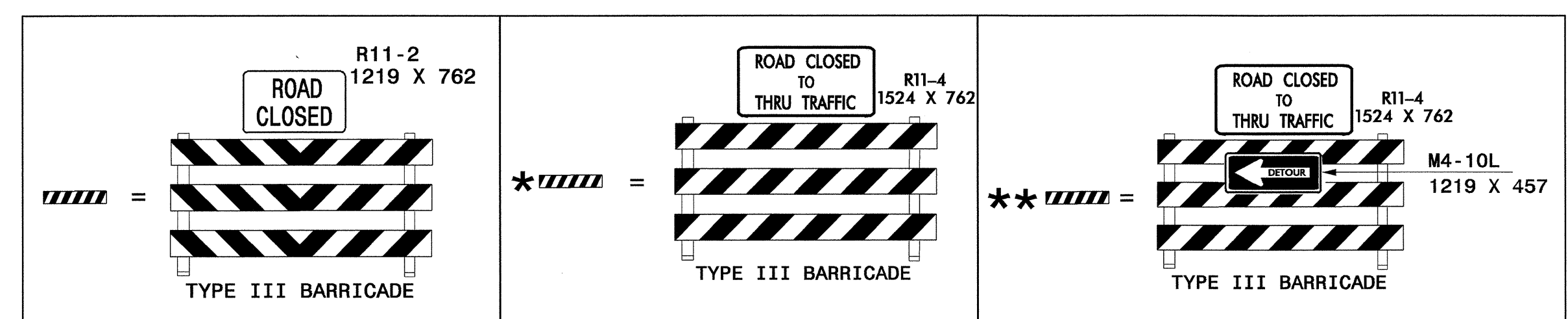

INSTALL SIGNING FOR PERMANENT ROAD CLOSURE OF SR 2417 (THOMPSON RD.) SEE SIGNING PLANS (SH. SIGN 81).

THOMPSON RD. CLOSED. SEE SHEET TCP-36 FOR OFFSITE DETOUR.

APPROVED: *[Signature]* DATE: 6/25/04

SEAL

PHASE I							
-L- / -Y8- CONSTRUCTION							
SCALE: NONE							
DATE: 11-03							
DWG. BY: MHS							
DESIGN BY: MHS							
REVIEWED BY: CLM	<table border="1"> <tr> <th colspan="2">REVISIONS</th> </tr> <tr> <td> </td> <td> </td> </tr> <tr> <td> </td> <td> </td> </tr> </table>	REVISIONS					
REVISIONS							
<small>CADD FILE: RS13C TC TCP-14.DGN</small>							

24-JUN-2004 11:26
 F:\TCP\FINAL TCP-36\1212231
 insteemom