

# AREA II I-95

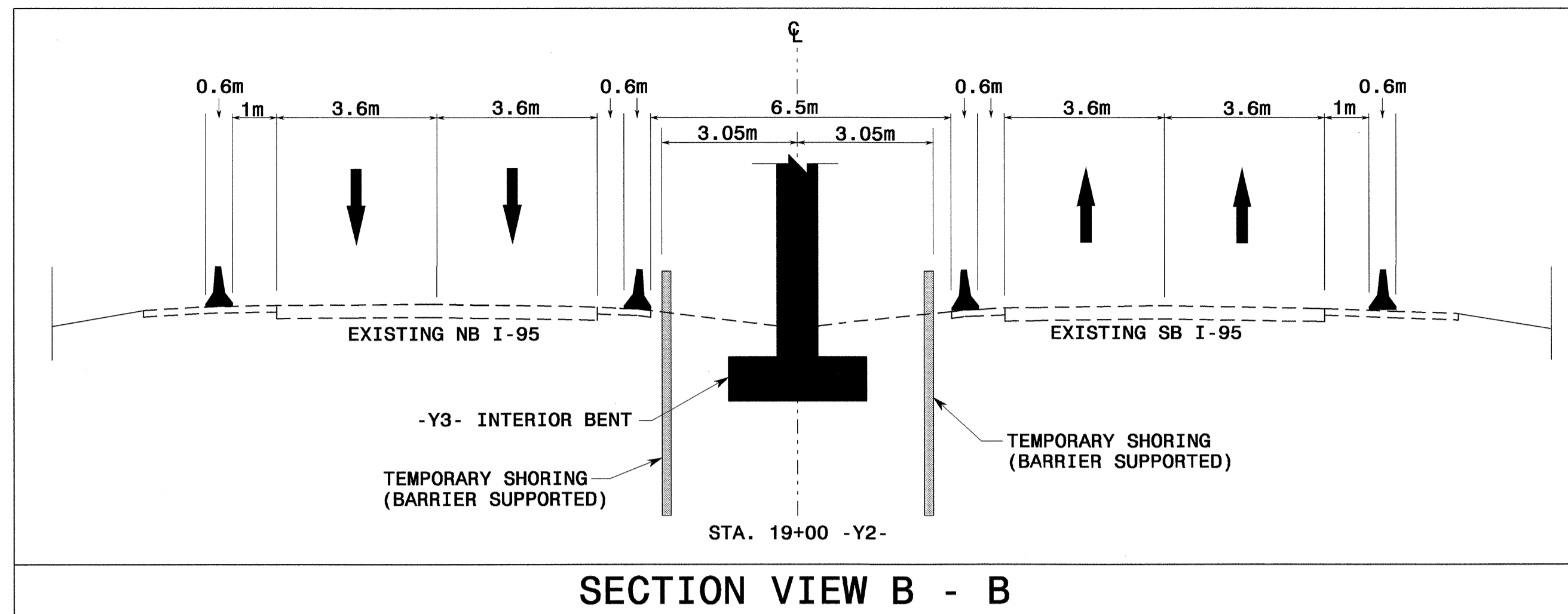

PROJ. REFERENCE NO. R-0513BB/C	SHEET NO. TCP-15
-----------------------------------	---------------------



FOR DESIGN OF TEMPORARY SHORING, USE THE FOLLOWING SOIL PARAMETERS:  
 UNIT WEIGHT OF SOIL ABOVE WATER TABLE,  $\gamma = 120$  pcf  
 UNIT WEIGHT OF SOIL BELOW WATER TABLE,  $\gamma' = 60$  pcf  
 FRICTION ANGLE,  $\phi = 30^\circ$   
 COHESION,  $c = 0$  pcf

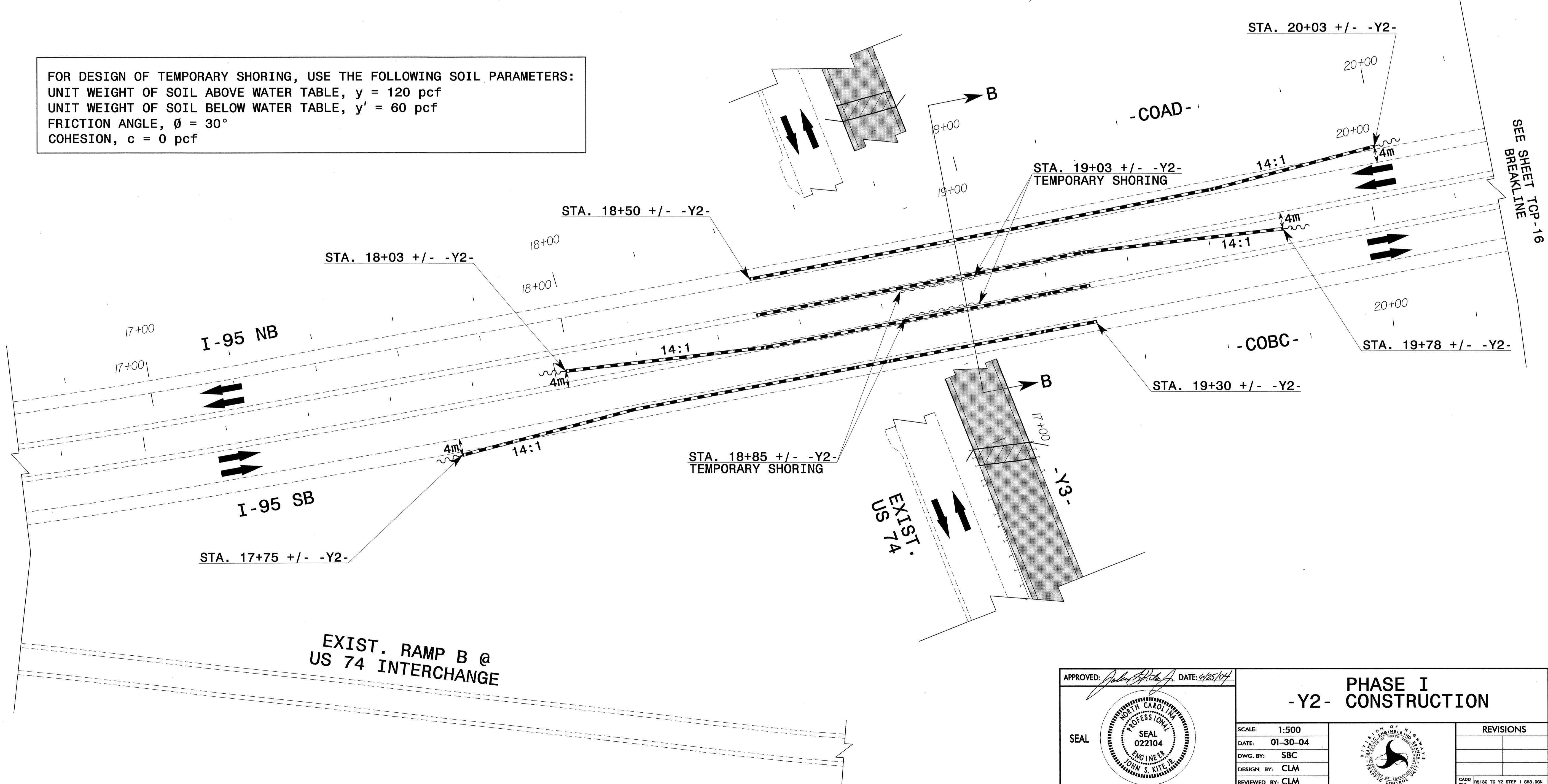

APPROVED: *[Signature]* DATE: 01/30/04

SEAL: NORTH CAROLINA PROFESSIONAL ENGINEER JOHN S. KITE, INC. SEAL 022104

<b>PHASE I -Y2- CONSTRUCTION</b>	
SCALE: 1:500	REVISIONS
DATE: 01-30-04	
DWG. BY: SBC	
DESIGN BY: CLM	
REVIEWED BY: CLM	

24-JUN-2004 11:26  
 FA-TCP\FINAL  
 mstefelman AT TETC22331