

# AREA III EXISTING US 74



PROJ. REFERENCE NO. R-0513BB/C	SHEET NO. TCP-28
-----------------------------------	---------------------

ALL LANES ARE 3.6m WIDE  
UNLESS OTHERWISE SHOWN

SR 2499 IS CLOSED. SEE OFFSITE  
DETOUR MAP ON SHEET TCP-38

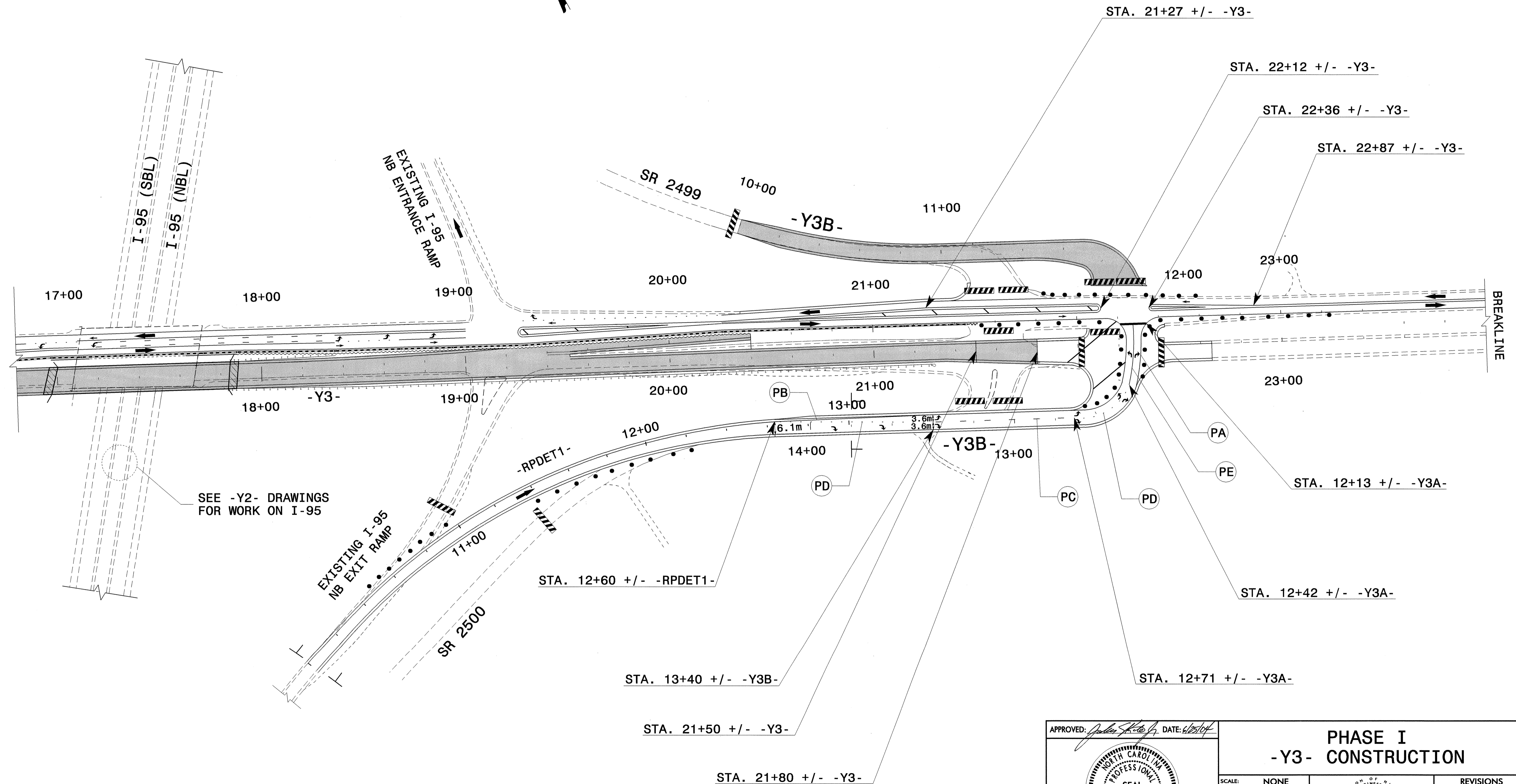

SEE -Y2- DRAWINGS  
FOR WORK ON I-95

APPROVED: *John S. Kite, Jr.* DATE: 6/21/04

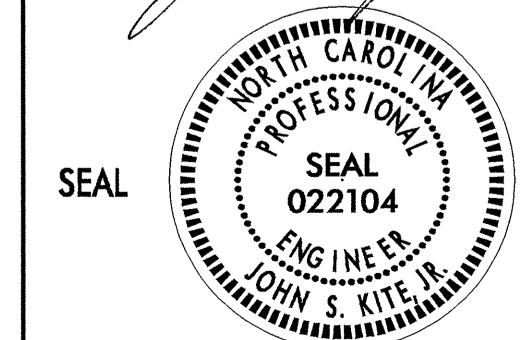

## PHASE I -Y3- CONSTRUCTION

SCALE: NONE  
DATE: 1-04  
DWG. BY: MHS  
DESIGN BY: MHS  
REVIEWED BY: CLM

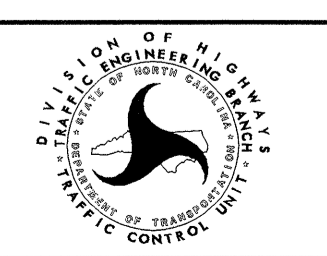

NO.	REVISIONS

24-JUN-2004 11:31  
 FA:\TCP\FINAL TCP\5133C\_TC-TCP028.dgn  
 msteelman AT TETC21231