



PROJ. REFERENCE NO.	SHEET NO.
R-0513BB/C	TCP-41B

STA. 23+00 +/- -Y3-
SUGGESTED MESSAGES

MESSAGE NO. 1	MESSAGE NO. 2
US 74 CLOSED 1 MILE	TRAFFIC OFFICER AHEAD

CHANGEABLE MESSAGE SIGN

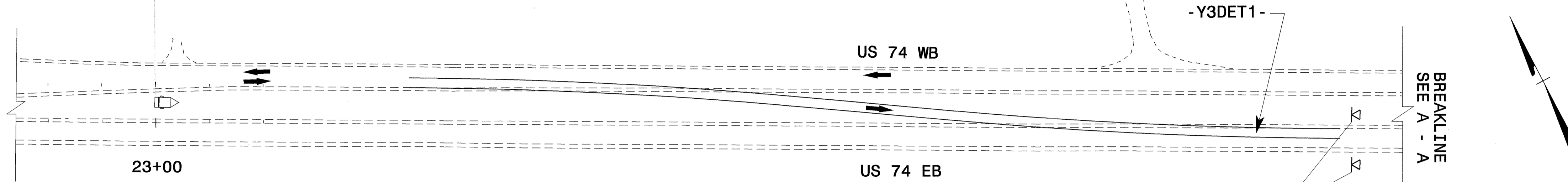

<p>A =</p> <p>W20-5 R 1219 X 1219</p>	<p>B =</p> <p>W4-2R 1219 X 1219</p>
<p>C =</p> <p>W20-5 R 1219 X 1219</p>	<p>D =</p> <p>G21-60 3048 X 1219</p> <p>ALL TRAFFIC EXIT 1 MILE</p>

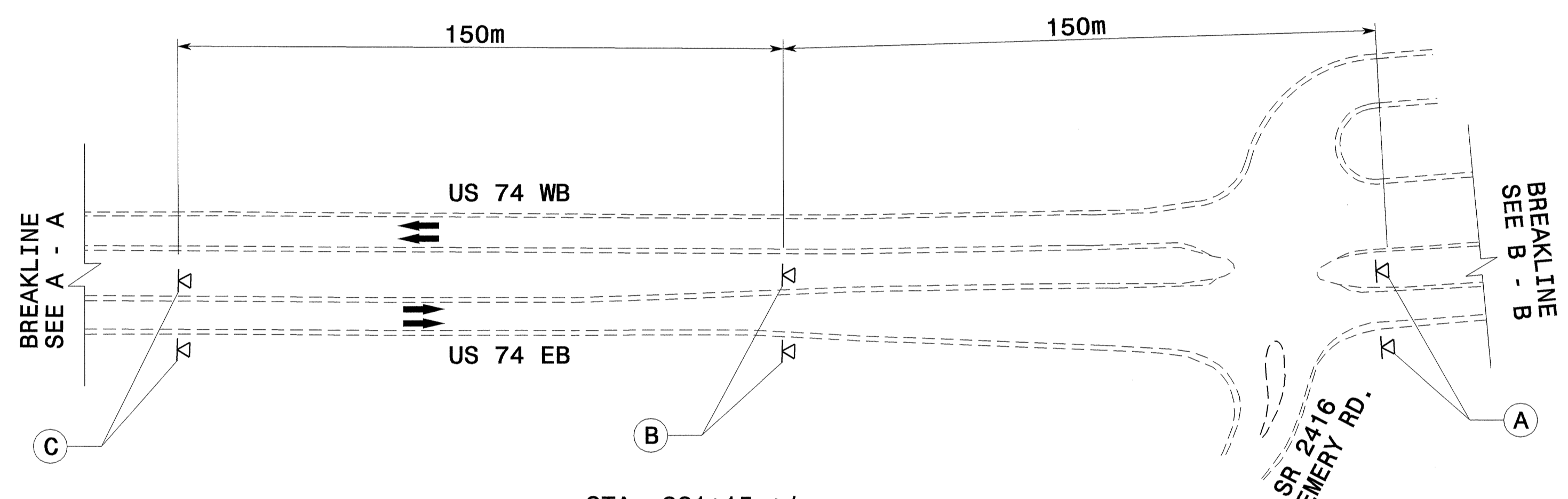

STA. 321+15 +/-
SUGGESTED MESSAGES

MESSAGE NO. 1	MESSAGE NO. 2	MESSAGE NO. 3
TRAFFIC OFFICER AHEAD	ALL TRAFFIC EXIT	PREPARE TO STOP

CHANGEABLE MESSAGE SIGN

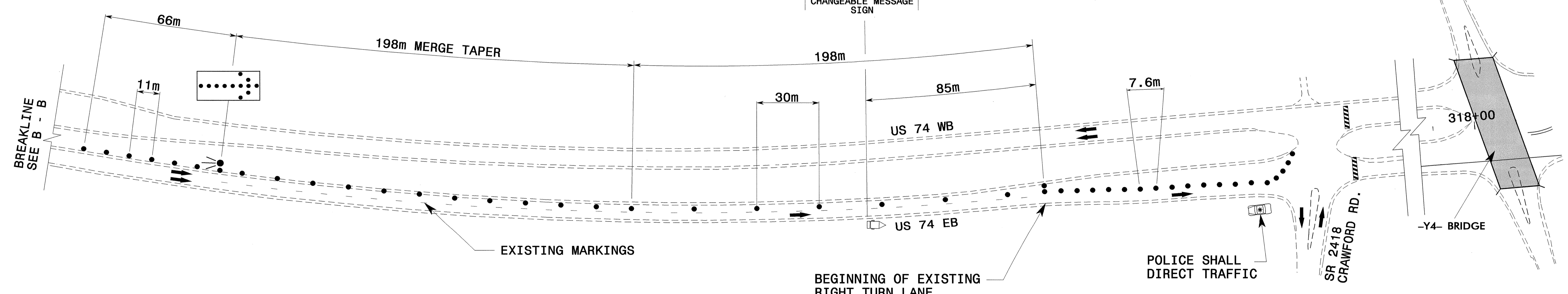

SEE TCP-40 FOR OFFSITE DETOUR ROUTE

APPROVED: <i>[Signature]</i> DATE: 6/25/04	<p>PHASE I TEMP. US 74 ROAD CLOSURE SIGNING FOR BRIDGE WORK</p>									
SCALE: NONE	DATE: 3-04	<table border="1"> <tr> <th colspan="2">REVISIONS</th> </tr> <tr> <td> </td> <td> </td> </tr> <tr> <td> </td> <td> </td> </tr> <tr> <td> </td> <td> </td> </tr> </table>	REVISIONS							
REVISIONS										
DWG. BY: MHS	DESIGN BY: MHS									
REVIEWED BY: CLM										

24-JUN-2004 11:38
 FA-TCP-FINAL TOP:\S\B513C-TC-TCP041B.dgn
 mstfeelmam AT TETC23231