

AREA II: I-95

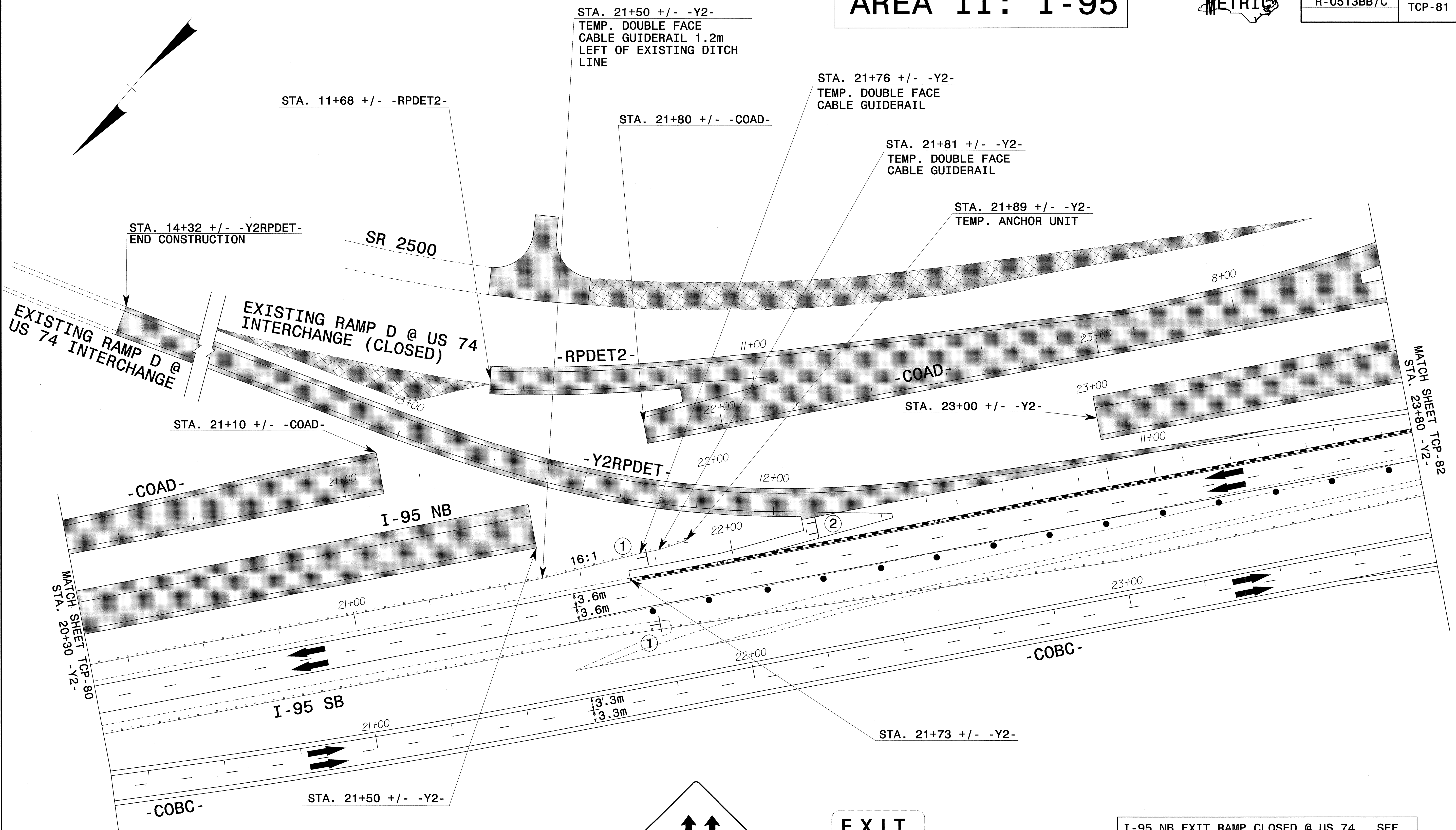

PROJ. REFERENCE NO.	SHEET NO.
R-0513BB/C	TCP-81



REMOVE AND REERECT THE EXISTING SIGNS ON TEMPORARY WOOD POSTS PAID FOR IN THE SIGNING PLANS. PLACE THE SIGNS 9 METERS FROM THE EDGE OF TRAVEL LANE IF NO GUARDRAIL INVOLVED, OTHERWISE 6 METERS WITH 2.1 METER VERTICAL CLEARANCE FROM THE EDGE OF TRAVEL LANE TO THE BOTTOM EDGE OF THE EXISTING SIGN.

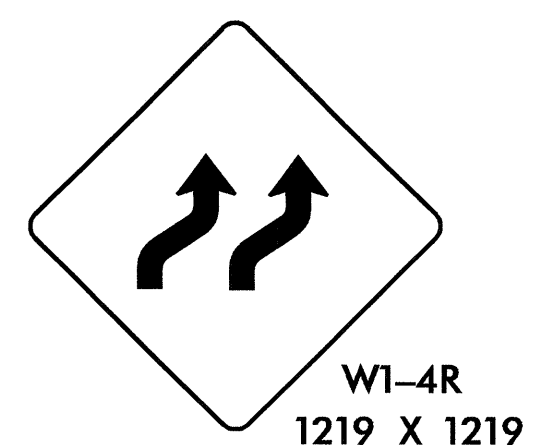

STA. 21+78 +/- -Y2-

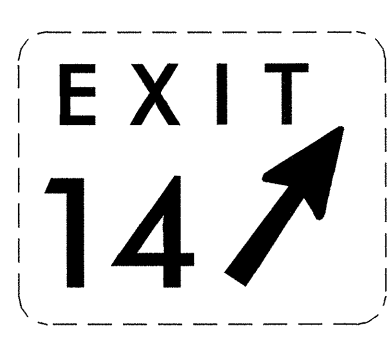

RELOCATED GUIDE SIGN

I-95 NB EXIT RAMP CLOSED @ US 74. SEE OFFSITE DETOUR SIGNING ON SHEET TCP-114.

APPROVED: *[Signature]* DATE: 01/30/04

SEAL

**PHASE IIC
-Y2- CONSTRUCTION**

SCALE: 1:500		REVISIONS
DATE: 01-30-04		
DWG. BY: SBC		
DESIGN BY: CLM		
REVIEWED BY: CLM		

CADD FILE

24-JUN-2004 10:01 E:\CP\SYR555\EC.TC.TCP081.dgn