

# AREA II: I-95

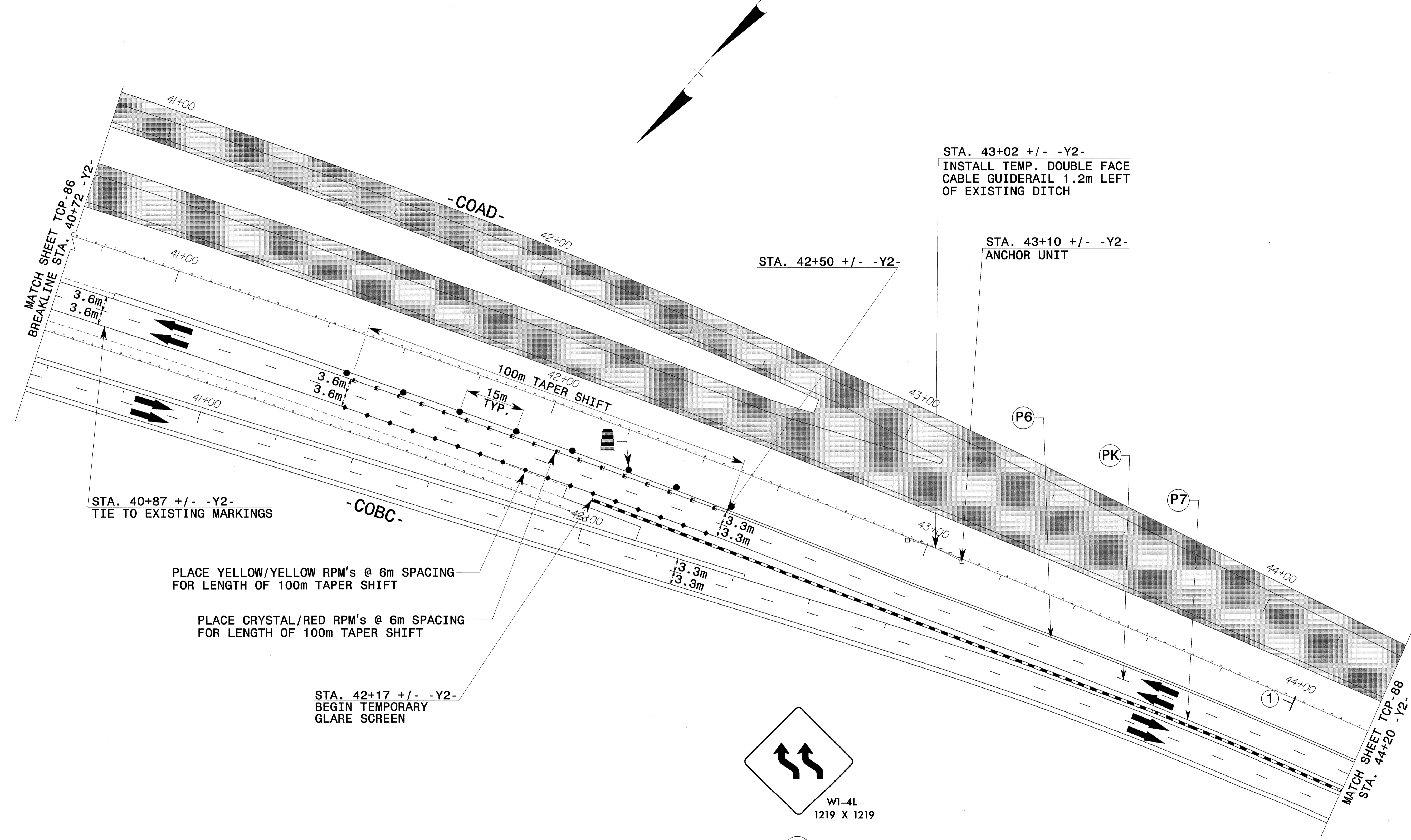

PROJ. REFERENCE NO.	SHEET NO.
R-0513BB/C	TCP-87



STA. 43+02 +/- -Y2-  
INSTALL TEMP. DOUBLE FACE  
CABLE GUIDERAIL 1.2m LEFT  
OF EXISTING DITCH

STA. 43+10 +/- -Y2-  
ANCHOR UNIT

STA. 42+50 +/- -Y2-

STA. 40+87 +/- -Y2-  
TIE TO EXISTING MARKINGS

PLACE YELLOW/YELLOW RPM's @ 6m SPACING  
FOR LENGTH OF 100m TAPER SHIFT

PLACE CRYSTAL/RED RPM's @ 6m SPACING  
FOR LENGTH OF 100m TAPER SHIFT

STA. 42+17 +/- -Y2-  
BEGIN TEMPORARY  
GLARE SCREEN

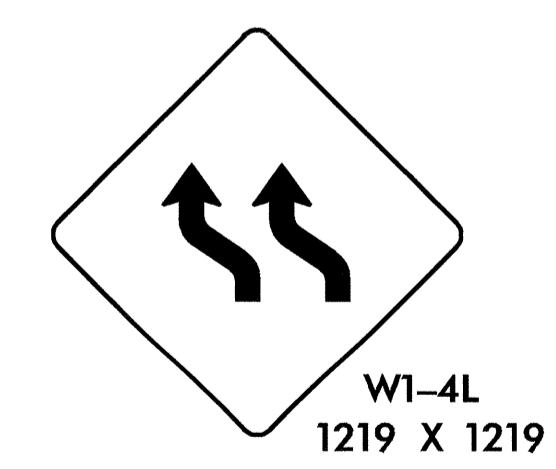

1

STA. 44+00 +/- -Y2-

25-JUN-2004 09:56  
 F:\TCP\FINAL TCP\513BB\C.TC.TCP087.dgn  
 msteeleman AT TELC1231

APPROVED: <i>[Signature]</i> DATE: 6/25/04	<b>PHASE IIC -Y2- CONSTRUCTION</b>									
SCALE: 1:500	DATE: 01-30-04	<table border="1"> <tr> <th colspan="2">REVISIONS</th> </tr> <tr> <td> </td> <td> </td> </tr> <tr> <td> </td> <td> </td> </tr> <tr> <td> </td> <td> </td> </tr> </table>	REVISIONS							
REVISIONS										
DWG. BY: SBC	DESIGN BY: CLM									
REVIEWED BY: CLM										