

# AREA II: I-95

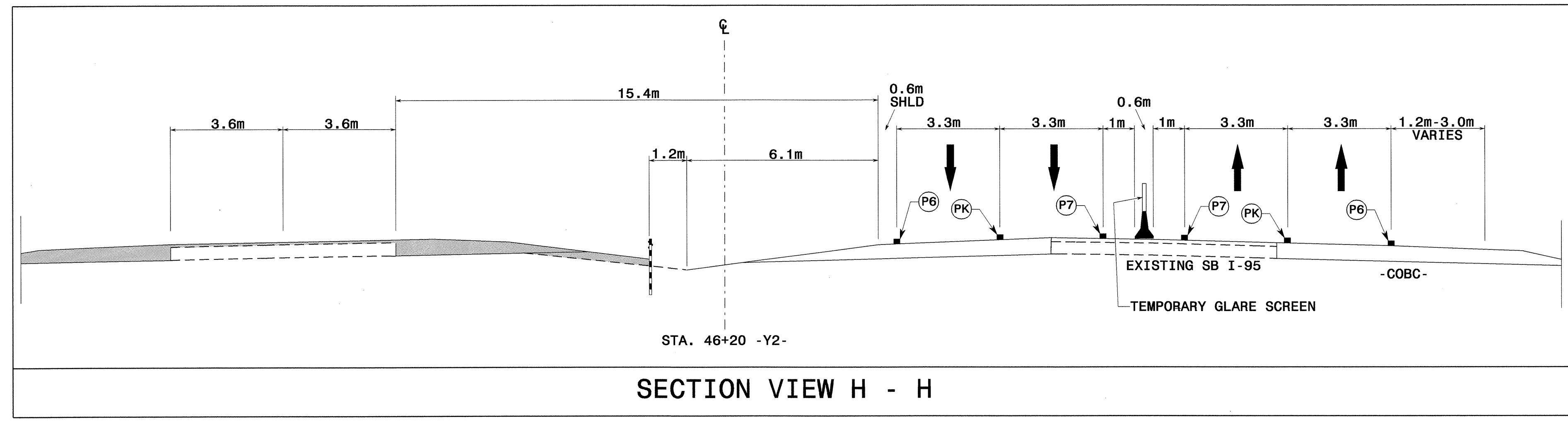

PROJ. REFERENCE NO. R-0513BB/C	SHEET NO. TCP-88
-----------------------------------	---------------------

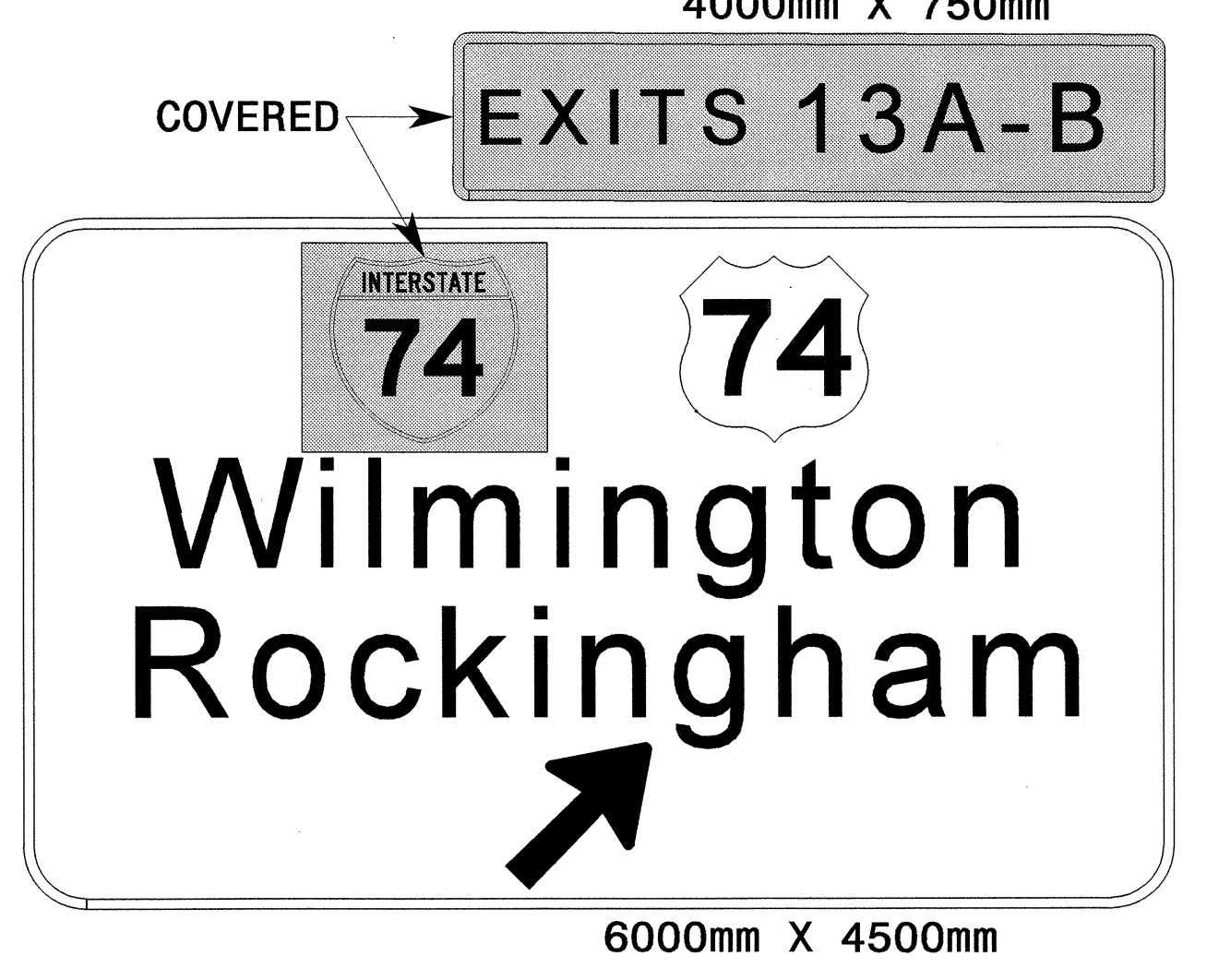
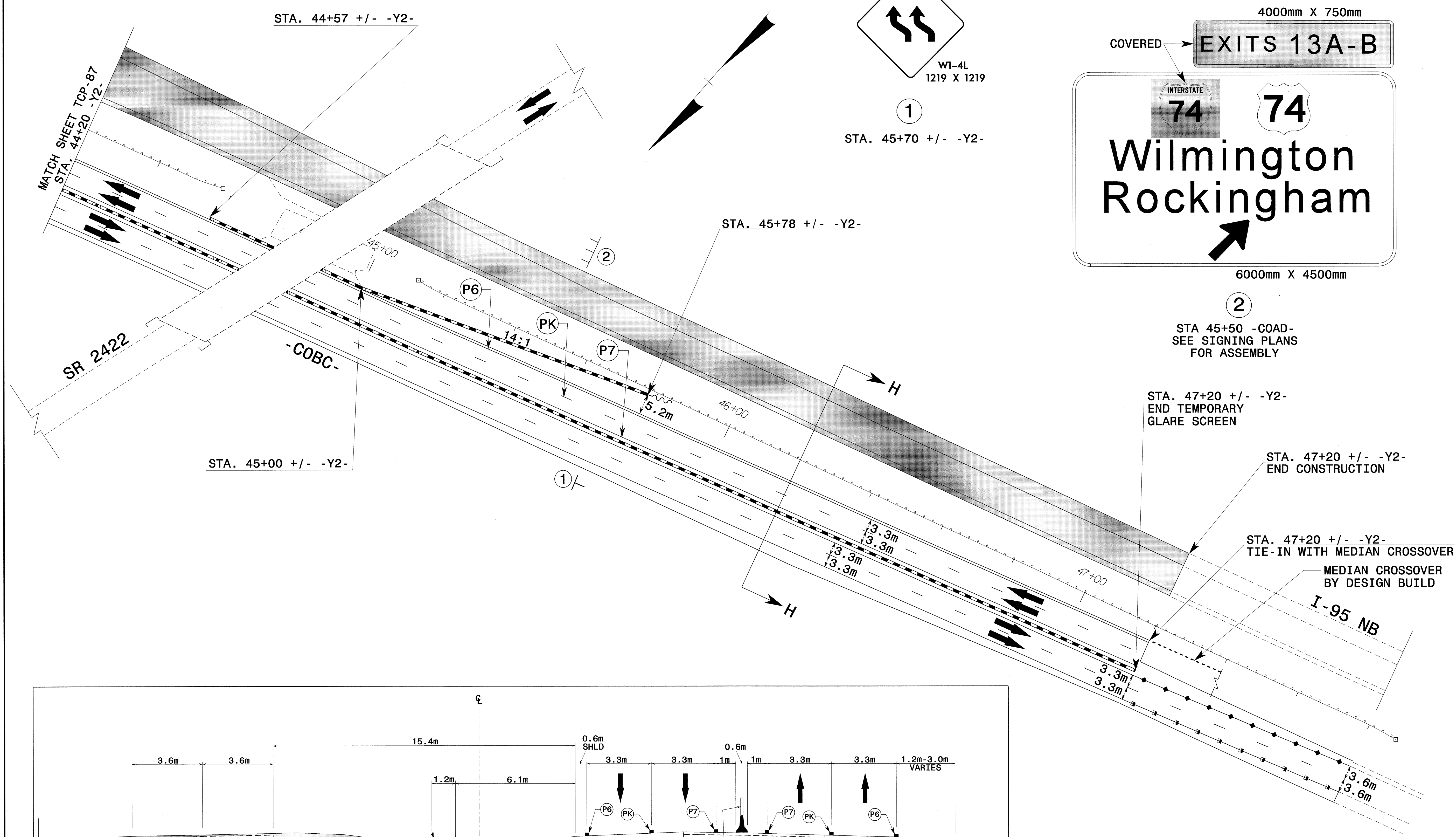

APPROVED: *[Signature]* DATE: 4/25/04

SEAL: NORTH CAROLINA PROFESSIONAL ENGINEER SEAL 022104 JOHN S. KITE, JR.

SCALE: 1:500  
DATE: 01-30-04  
DWG. BY: SBC  
DESIGN BY: CLM  
REVIEWED BY: CLM

PHASE IIC  
-Y2- CONSTRUCTION

REVISIONS

CADD FILE

25-JUN-2004 09:57 F:\TCP\FINAL TCP\513BB\IC\_TCP088.dgn msteelman AT TELC12231