

# AREA III EXISTING US 74

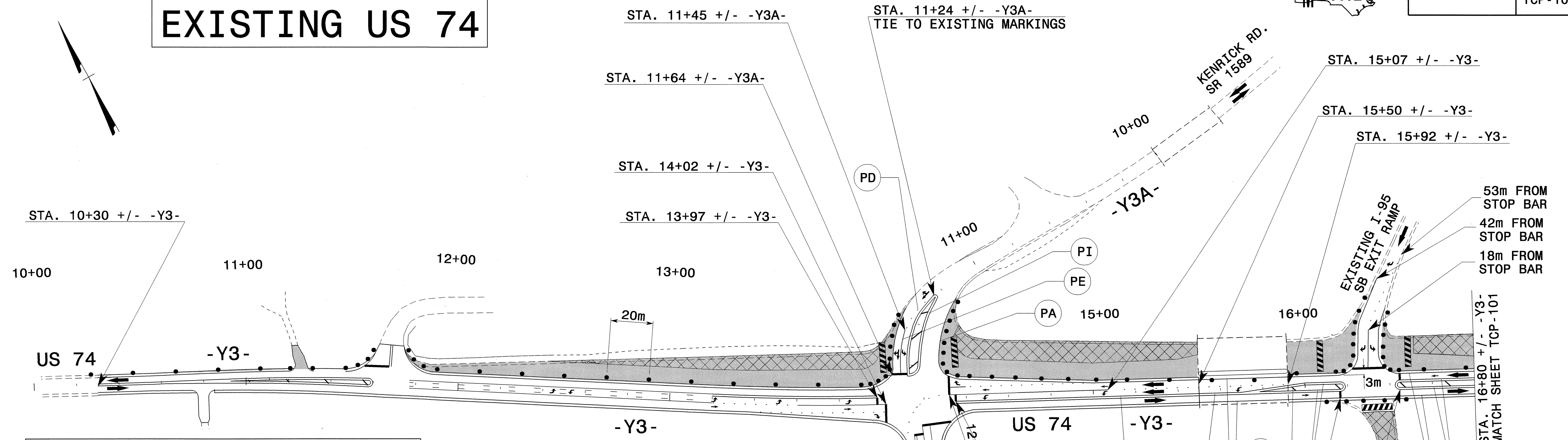

PROJ. REFERENCE NO. R-0513BB/C	SHEET NO. TCP-100
-----------------------------------	----------------------



CONSTRUCT -Y3A- UNDER A ROAD CLOSURE UPON COMPLETION OF CONSTRUCTION AND OPENING OF -Y3B- (NORTHERN SECTION)

SEE SHEET TCP-110 AND 111 FOR OFFSITE DETOUR

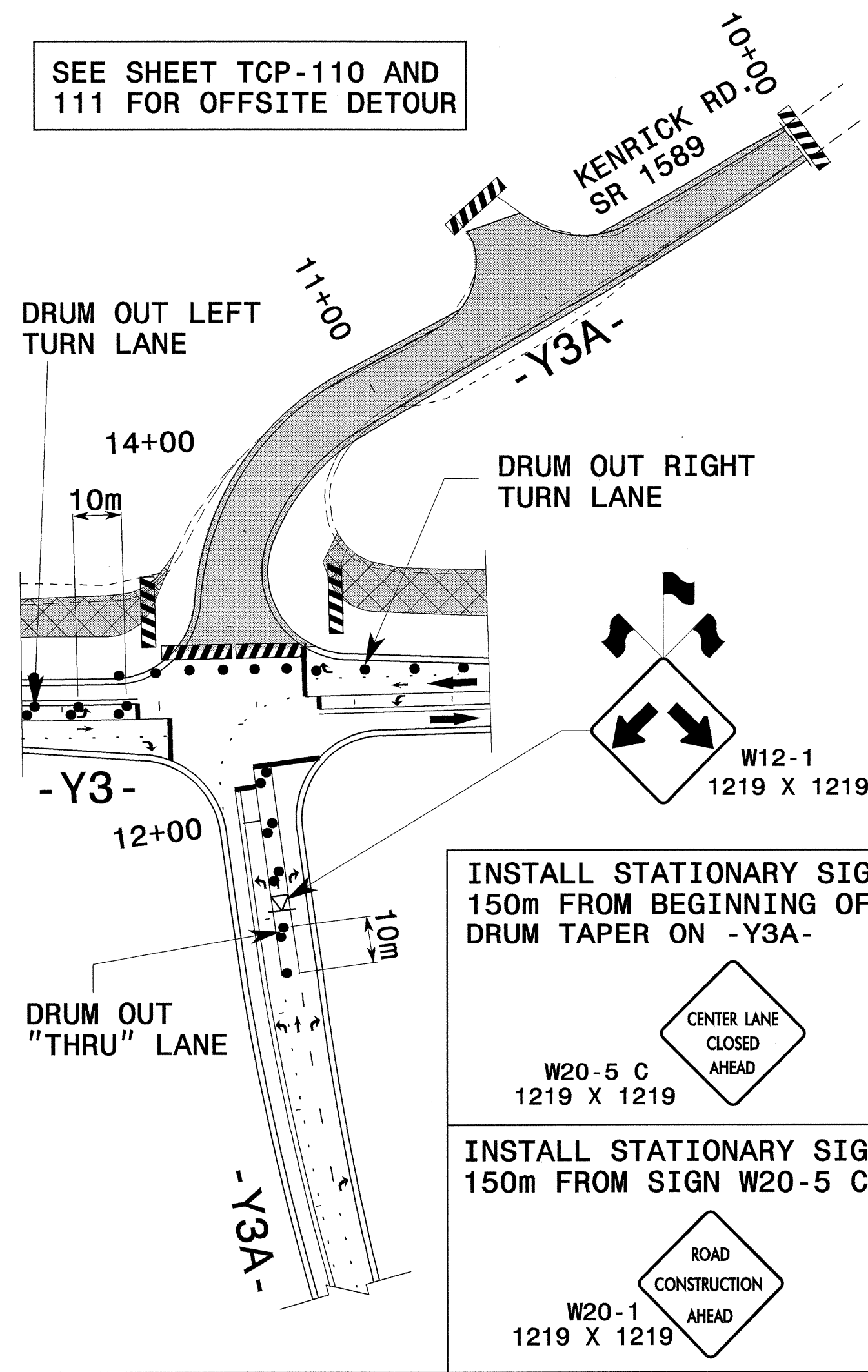

INSTALL STATIONARY SIGN 150m FROM BEGINNING OF DRUM TAPER ON -Y3A-

INSTALL STATIONARY SIGN 150m FROM SIGN W20-5 C

FINAL PAVEMENT MARKING PATTERN ON -Y3A- AFTER CONSTRUCTION

SEE PM-23 FOR FINAL PAVEMENT MARKING STATIONING ON -Y3A- USE PAINT MARKINGS.

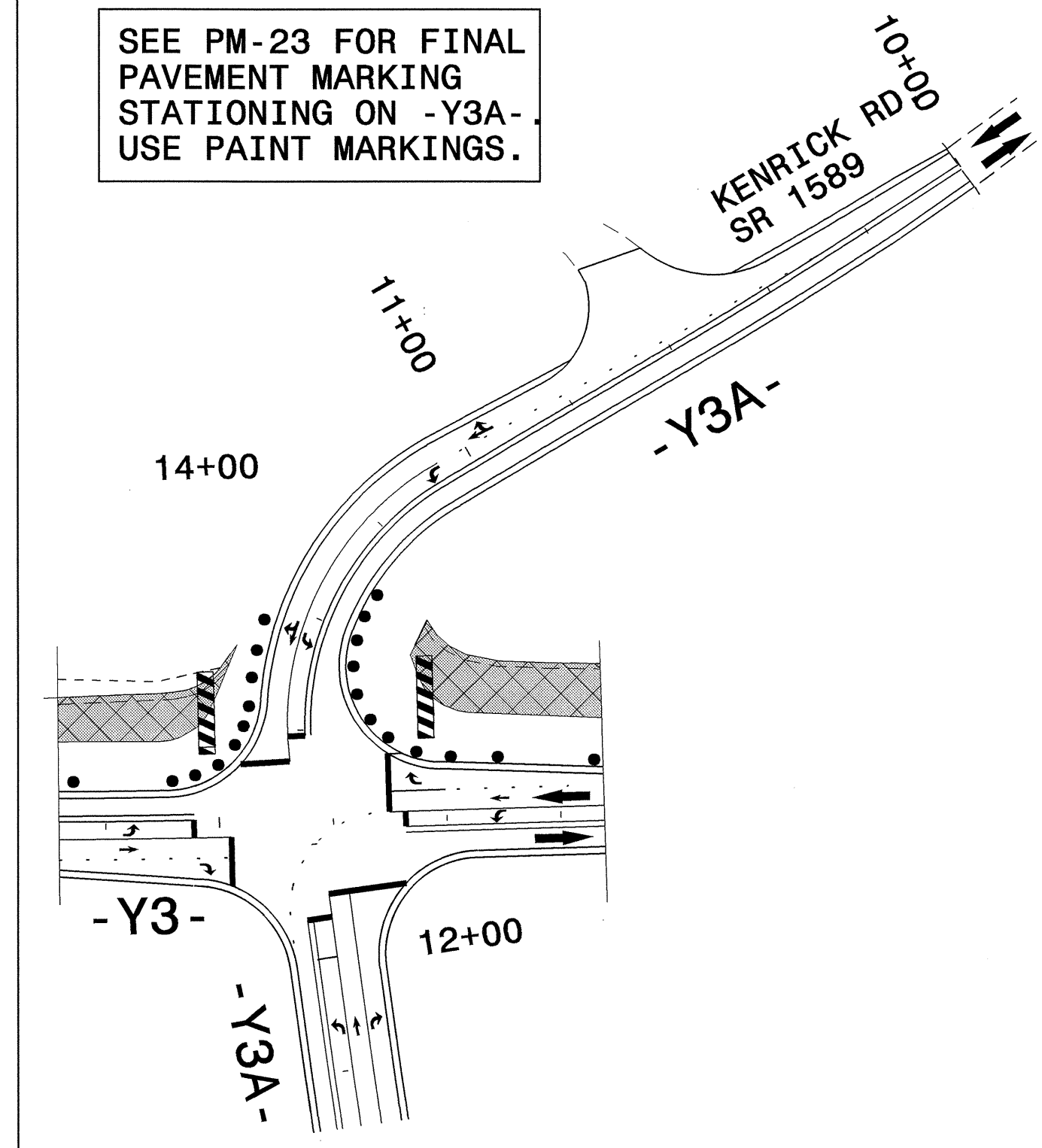

I-95 SB ENTRANCE RAMP CLOSED. TRAFFIC DETOURED TO SR 1207 (HILLY BRANCH RD.) SEE SHEET TCP-108 FOR DETOUR SIGNING.

ALL LANES ARE 3.6m WIDE UNLESS OTHERWISE SHOWN

PLACE TEMPORARY PAINT PAVEMENT MARKINGS AND MARKERS ON -Y3- IN THE FINAL PATTERN FROM STA. 10+30 +/- -Y3- TO STA. 15+07 +/- -Y3- UNLESS OTHERWISE SHOWN. SEE PM-23 FOR STATIONING OF PAVEMENT MARKINGS.

PLACE TEMPORARY PAINT PAVEMENT MARKINGS AND MARKERS ON -Y3A- (HILLY BRANCH RD.) IN THE FINAL PATTERN FROM STA. 11+89 +/- -Y3- TO STA. 13+80 +/- -Y3-. SEE PM-23 FOR STATIONING OF PAVEMENT MARKINGS.

APPROVED: *John S. Kite, Jr.* DATE: 6/25/04

## PHASE II -Y3A- CONSTRUCTION

SCALE: 1:1000  
DATE: 10-17-03  
DWG. BY: MHS  
DESIGN BY: MHS  
REVIEWED BY: CLM

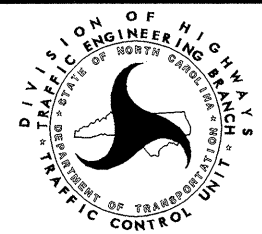

REVISIONS	

24-JUN-2004 12:10  
F:\YCP\FINAL TCP\SR1589\TC-TCP100.dgn  
ms:peelmont AT TELC10231