

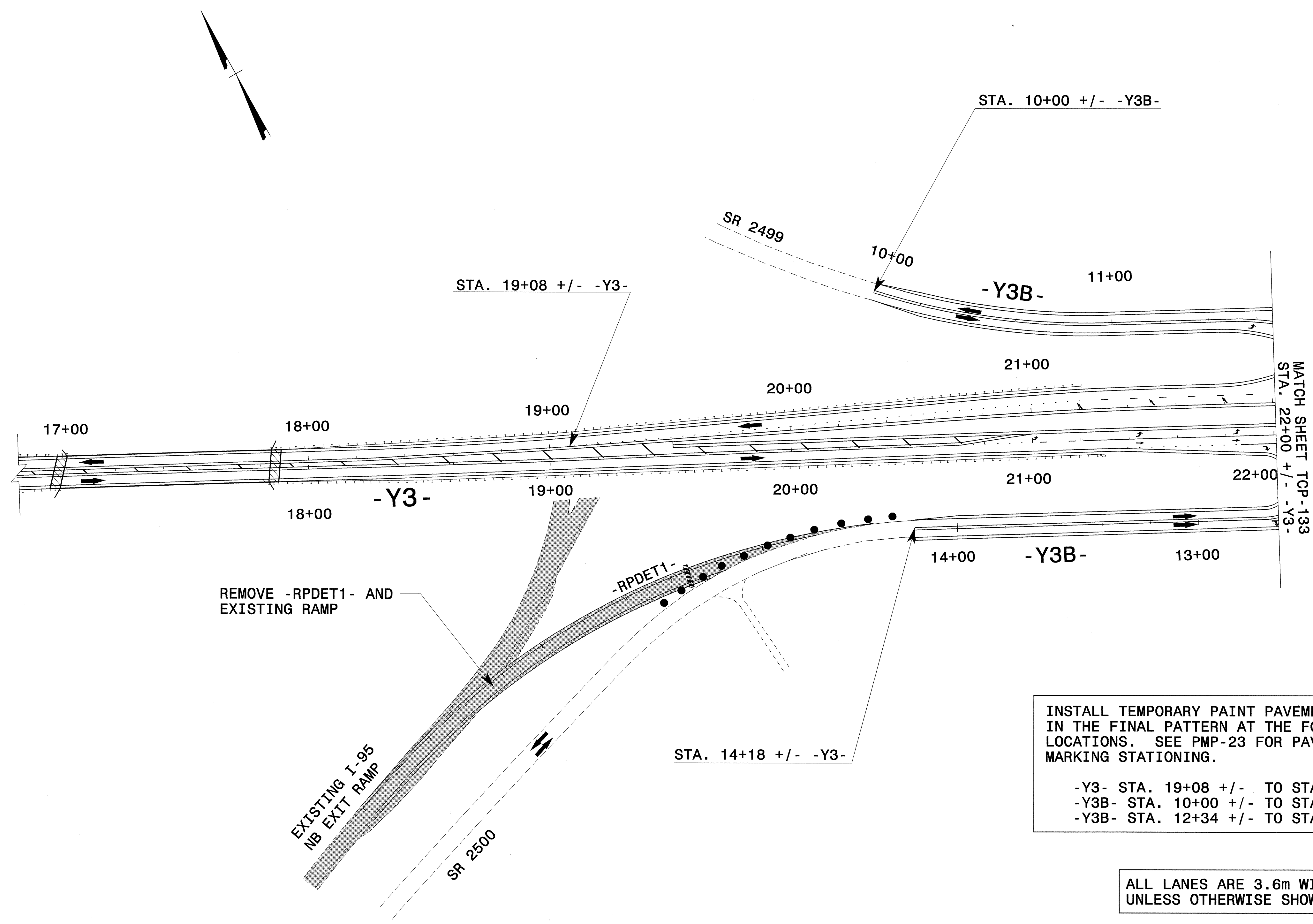

PROJ. REFERENCE NO.	SHEET NO.
R-0513BB/C	TCP-132



INSTALL TEMPORARY PAINT PAVEMENT MARKINGS IN THE FINAL PATTERN AT THE FOLLOWING LOCATIONS. SEE PMP-23 FOR PAVEMENT MARKING STATIONING.

- Y3- STA. 19+08 +/- TO STA. 23+94 +/-
- Y3B- STA. 10+00 +/- TO STA. 11+98 +/-
- Y3B- STA. 12+34 +/- TO STA. 14+18 +/-

ALL LANES ARE 3.6m WIDE UNLESS OTHERWISE SHOWN

24-JUN-2004 10:24  
 F:\TCP\FINAL TCP\SAR513C-TC-TCP132.dgn  
 msTeeliman AT TETC1231

APPROVED: *[Signature]* DATE: 6/25/04

SEAL

**PHASE III**  
**-Y3- TEMP. TRAFFIC PATTERN**

SCALE: NONE		REVISIONS
DATE: 5-04		
DWG. BY: MHS		
DESIGN BY: MHS		
REVIEWED BY: CLM		

CADD FILE: R513C TC TOP128A.DGN