

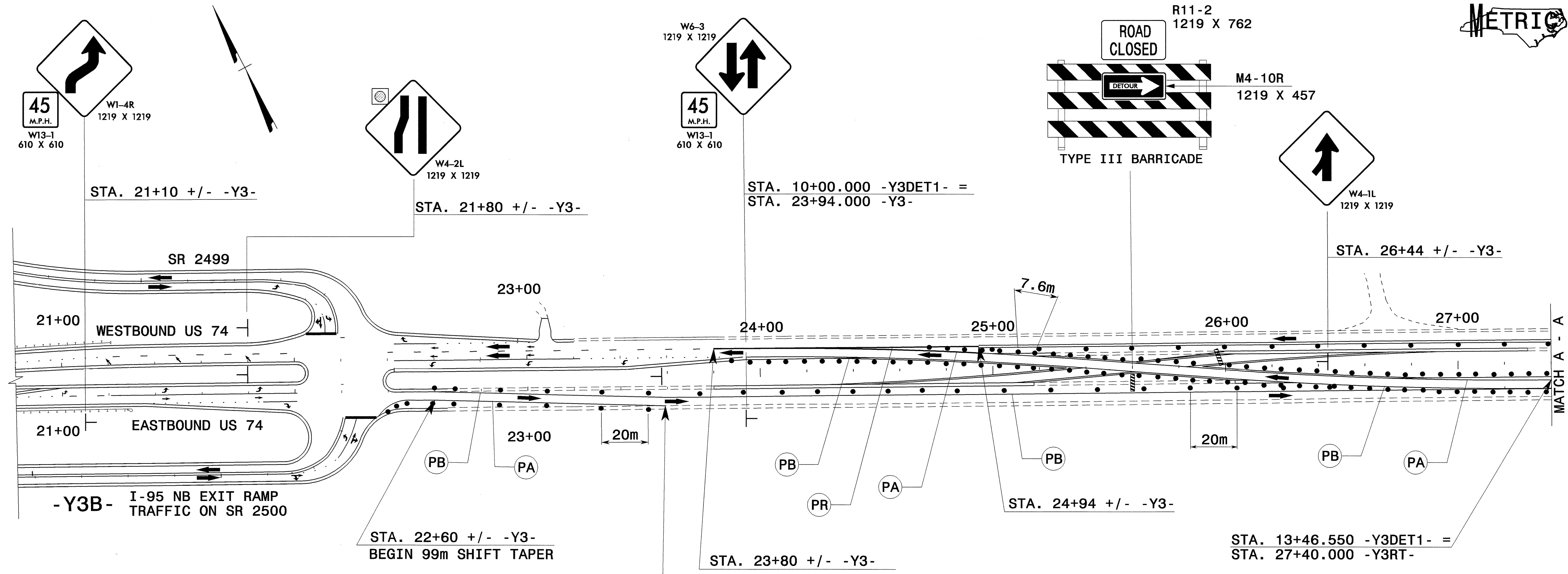

PROJ. REFERENCE NO. R-0513BB/C	SHEET NO. TCP-141
-----------------------------------	----------------------



SUGGESTED MESSAGE

MESSAGE NO. 1	MESSAGE NO. 2	MESSAGE NO. 3
TRAFFIC SHIFT AHEAD	MEDIAN CROSSING	1/4 MILE AHEAD

CHANGEABLE MESSAGE SIGN

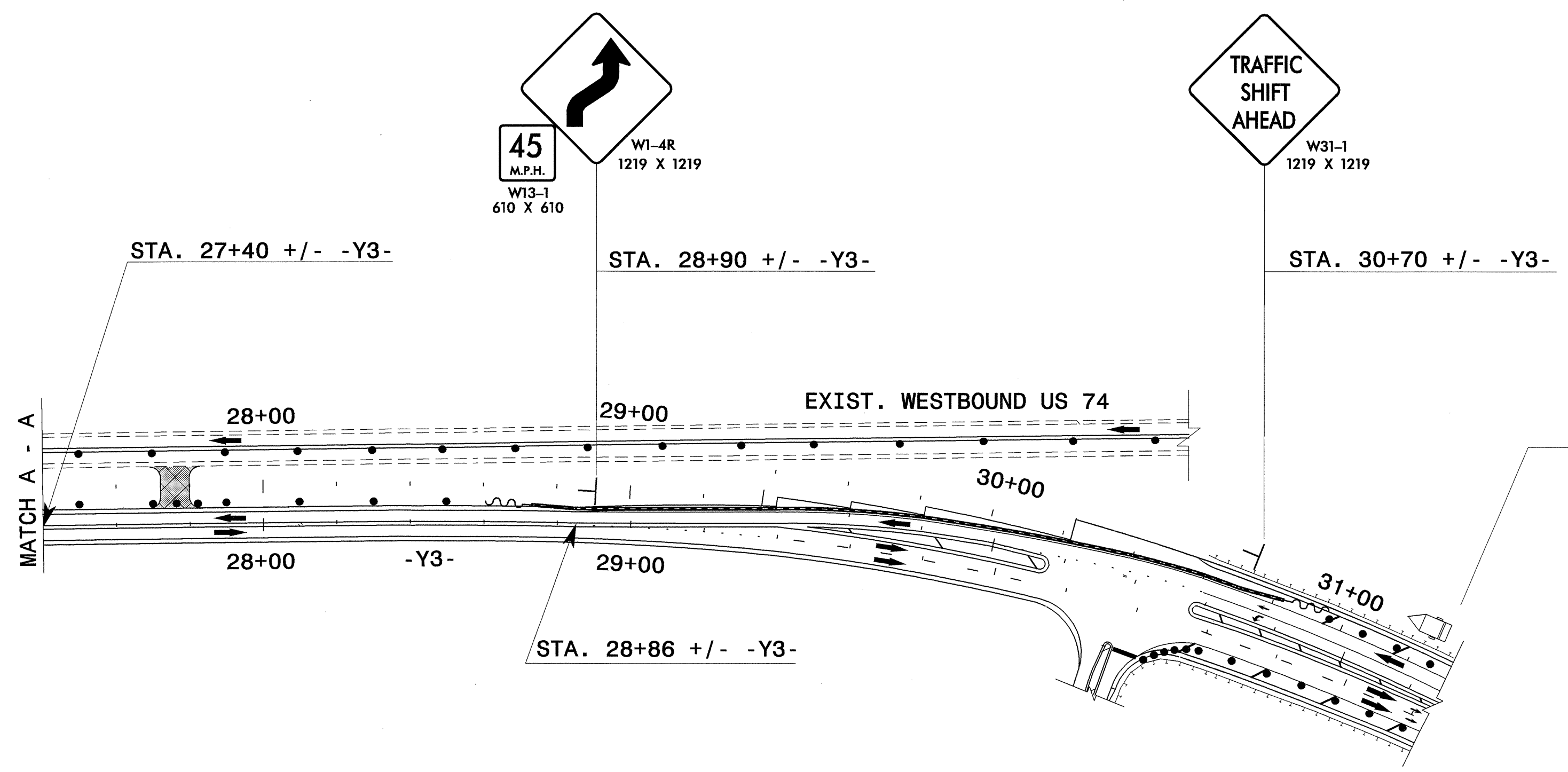

CROSSOVER TRAFFIC CONTROL AND SIGNING IS FOR CROSSOVER SHOWN ON SHEET TCP-133

ALL LANES ARE 3.6m WIDE UNLESS OTHERWISE SHOWN

APPROVED: *[Signature]* DATE: 6/25/04

SEAL

CROSSOVER SIGNING FOR PHASE III (US 74 WB BUS. ON CROSSOVER)

SCALE: NONE		<table border="1"> <tr> <th colspan="2">REVISIONS</th> </tr> <tr> <td> </td> <td> </td> </tr> <tr> <td> </td> <td> </td> </tr> <tr> <td> </td> <td> </td> </tr> </table>	REVISIONS							
REVISIONS										
DATE: 3-04										
DWG. BY: MHS										
DESIGN BY: MHS										

REVIEWED BY: CLM

CADD FILE: CROSSOVER SIGNING 4.DGN

24-JUN-2004 12:29
 P:\TCP\FINAL TCP-SAR536_TC-TCP141.dgn
 mls:telman AT TELC:\231