

PAVEMENT SCHEDULE (FINAL DESIGN)

6/16/99

C1	PROP. APPROX. 80 mm ASPHALT CONC. SURFACE COURSE, TYPE S9.5B, AT AN AVERAGE RATE OF 96 kg PER SQ. METER IN EACH OF TWO LAYERS.	D4	PROP. VAR. DEPTH ASPHALT CONC. INTERMEDIATE COURSE, TYPE I19.0C, AT AN AVERAGE RATE OF 2.45 kg PER SQ. METER PER 1 mm DEPTH, TO BE PLACED IN LAYERS NOT LESS THAN 55 mm OR GREATER THAN 110 mm IN DEPTH.
C2	PROP. VAR. DEPTH ASPHALT CONC. SURFACE COURSE, TYPE S9.5B, AT AN AVERAGE RATE OF 2.40 kg PER SQ. METER PER 1 mm DEPTH, TO BE PLACED IN LAYERS NOT TO EXCEED 40 mm IN DEPTH.	E1	PROP. APPROX. 75 mm ASPHALT CONC. BASE COURSE, TYPE B25.0C, AT AN AVERAGE RATE OF 183.75 kg PER SQ. METER.
C3	PROP. APPROX. 100 mm ASPHALT CONC. SURFACE COURSE, TYPE S12.5C, AT AN AVERAGE RATE OF 120 kg PER SQ. METER IN EACH OF TWO LAYERS.	E2	PROP. VAR. DEPTH ASPHALT CONC. BASE COURSE, TYPE B25.0C, AT AN AVERAGE RATE OF 2.45 kg PER SQ. METER PER 1 mm DEPTH, TO BE PLACED IN LAYERS NOT LESS THAN 75 mm IN DEPTH OR GREATER THAN 140 mm IN DEPTH.
C4	PROP. VAR. DEPTH ASPHALT CONC. SURFACE COURSE, TYPE S12.5C, AT AN AVERAGE RATE OF 2.4 kg PER SQ. METER PER 1 mm DEPTH, TO BE PLACED IN LAYERS NOT LESS THAN 35 mm IN DEPTH OR GREATER THAN 60 mm IN DEPTH.	J1	PROP. 150 mm AGGREGATE BASE COURSE.
D1	PROP. APPROX. 65 mm ASPHALT CONC. INTERMEDIATE COURSE, TYPE I19.0B, AT AN AVERAGE RATE OF 159.25 kg PER SQ. METER.	J2	PROP. 250 mm AGGREGATE BASE COURSE.
D2	PROP. VAR. DEPTH ASPHALT CONC. INTERMEDIATE COURSE, TYPE I19.0B, AT AN AVERAGE RATE OF 2.45 kg PER SQ. METER PER 1 mm DEPTH, TO BE PLACED IN LAYERS NOT LESS THAN 55 mm OR GREATER THAN 110 mm IN DEPTH.	P	PRIME COAT AT THE RATE OF 1.58 L PER SQ. METER.
D3	PROP. APPROX. 65 mm ASPHALT CONC. INTERMEDIATE COURSE, TYPE I19.0C, AT AN AVERAGE RATE OF 159.25 kg PER SQ. METER.	T	EARTH MATERIAL.

NOTE: PAVEMENT EDGE SLOPES ARE 1:1 UNLESS SHOWN OTHERWISE.



PROJECT REFERENCE NO. R-513BB	SHEET NO. 2
ROADWAY DESIGN ENGINEER 06-03-04	PAVEMENT DESIGN ENGINEER

Richard A. Shillingburg

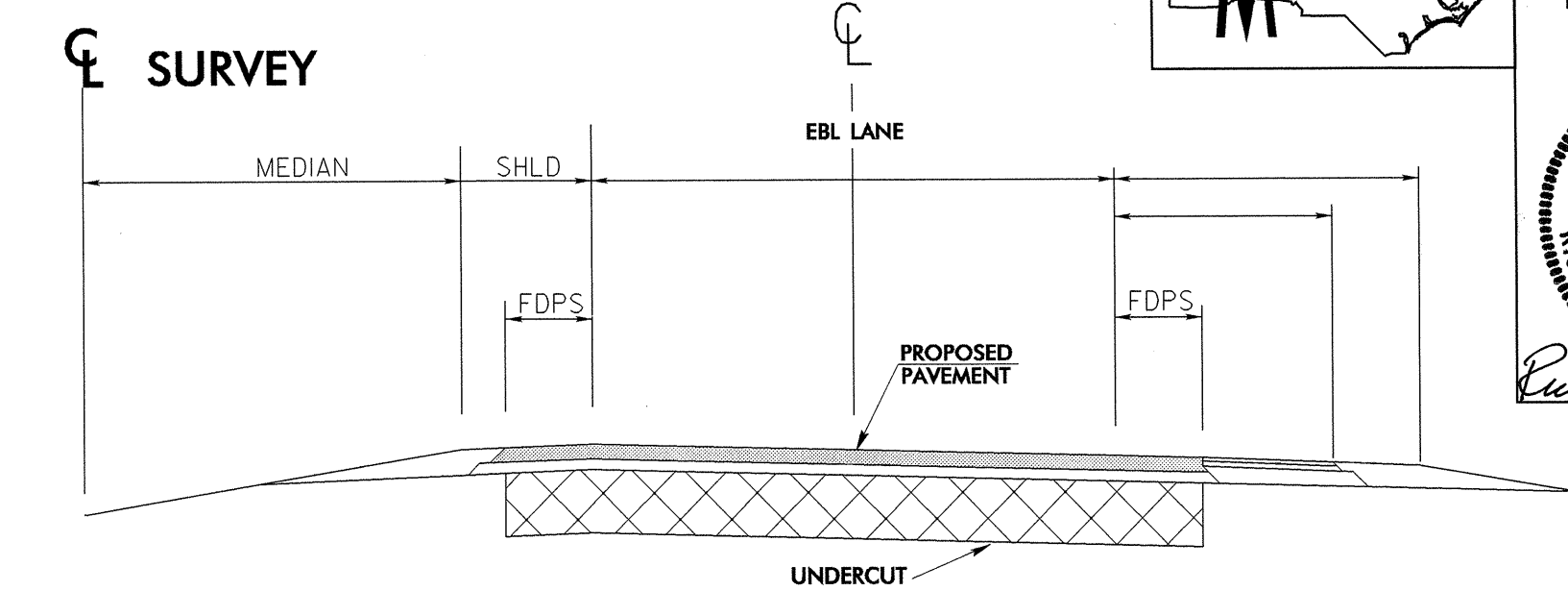

DETAIL OF UNDERCUT EXCAVATION
-L- STA. 209+80 TO 213+70

**** 6:1 NORMAL MEDIAN SLOPES IN SUPERELEVATED SECTIONS 6:1 ON LOW SIDE OF SE AND VAR. TO MAX. 4:1 ON HIGH SIDE OF SE.**

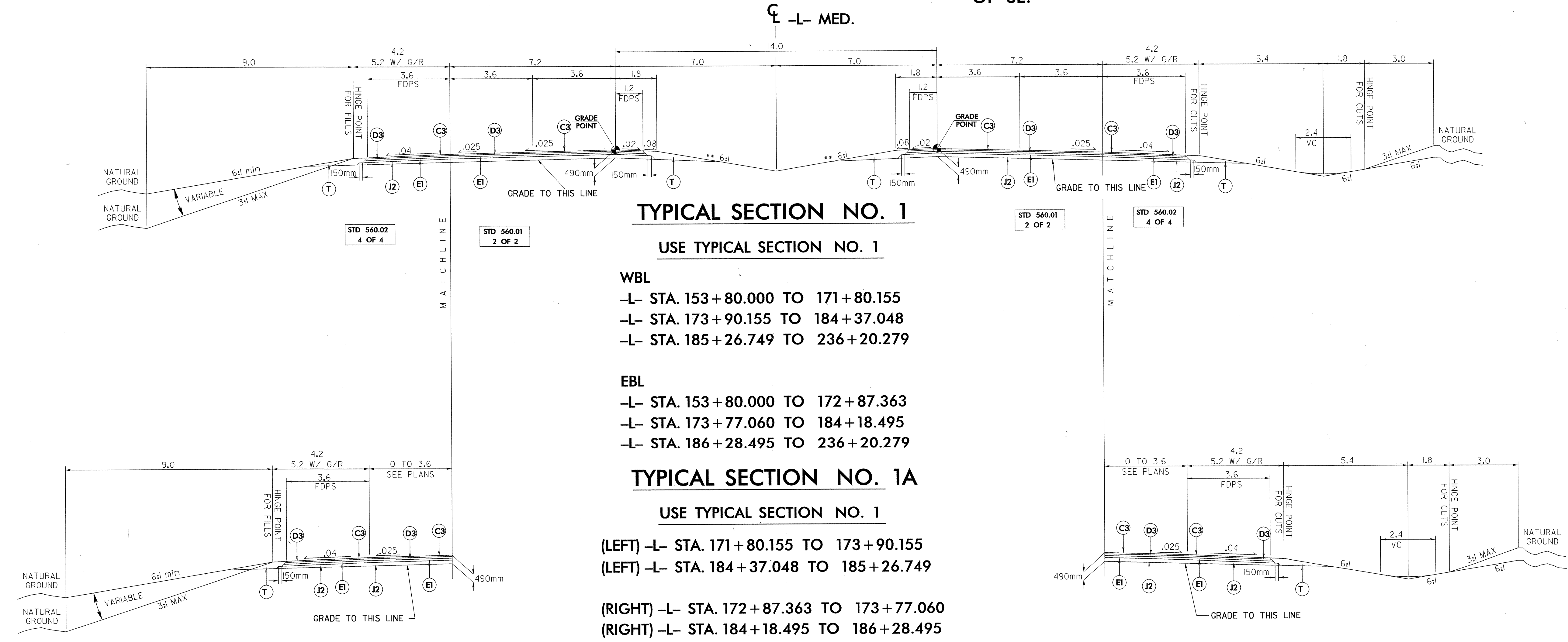

23-FEB-2004 08:03 R-513bb.txd
T.L.Snell AT 10:28:24 AM