

PROJECT REFERENCE NO. R-513 BB	SHEET NO. 2-D
ROADWAY DESIGN ENGINEER 16-03-04	

-RB-
 PI Sta 16+02.778
 $\Delta = 34^{\circ} 29' 05.9''$ (RT)
 L = 78.244
 T = 40.347
 R = 130.000
 SE = 0.080
 RUNOFF = SEE PLANS

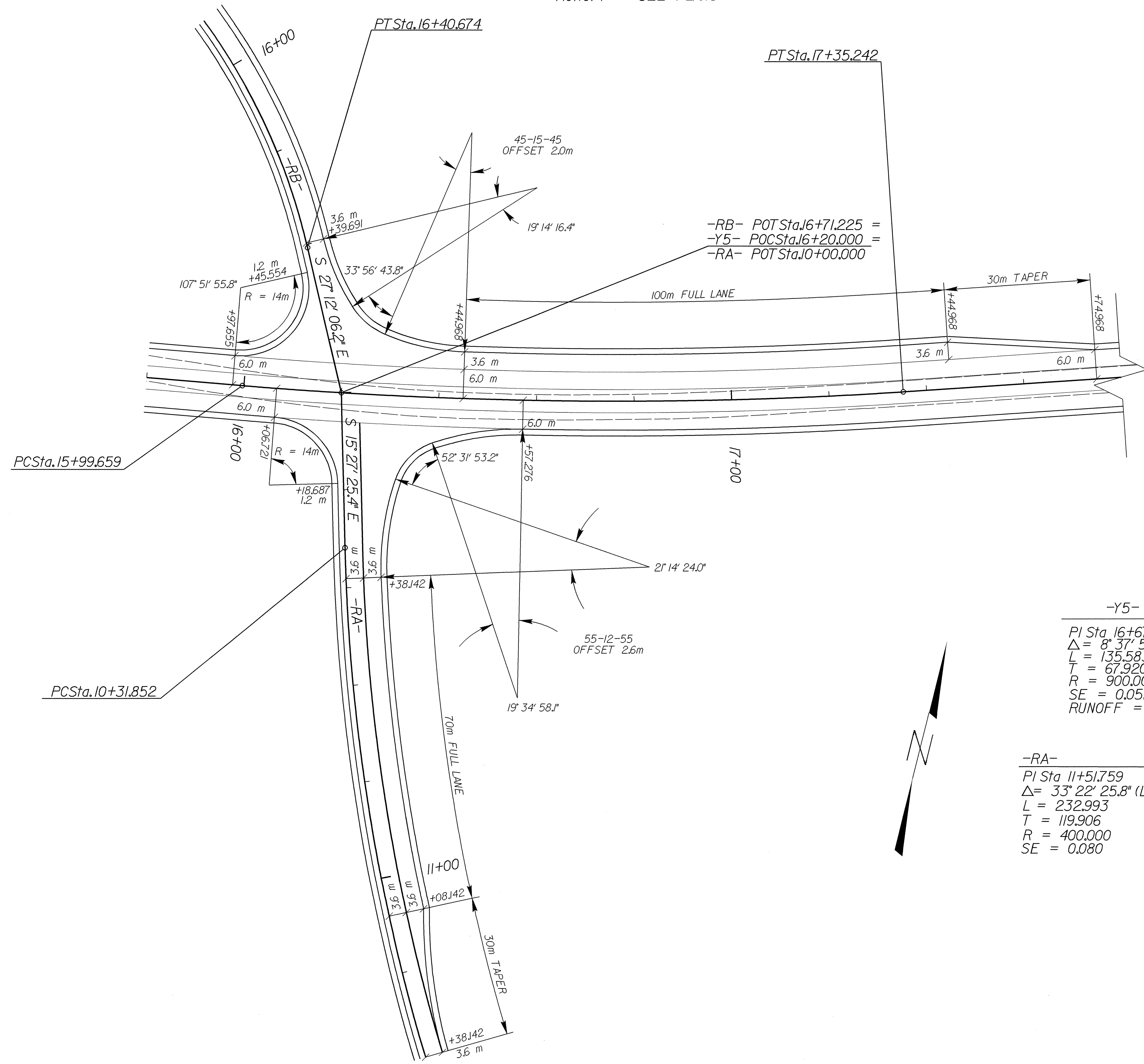

-Y5-
 PI Sta 16+67.579
 $\Delta = 8^{\circ} 37' 53.4''$ (LT)
 L = 135.583
 T = 67.920
 R = 900.000
 SE = 0.052
 RUNOFF = 42m

-RA-
 PI Sta 11+51.759 Pls Sta 12+86.860
 $\Delta = 33^{\circ} 22' 25.8''$ (LT) $\Theta_s = 4^{\circ} 43' 36.8''$
 L = 232.993 Ls = 66.000
 T = 119.906 LT = 44.016
 R = 400.000 ST = 22.014
 SE = 0.080

