

-RPDET2- DETOUR DETAIL

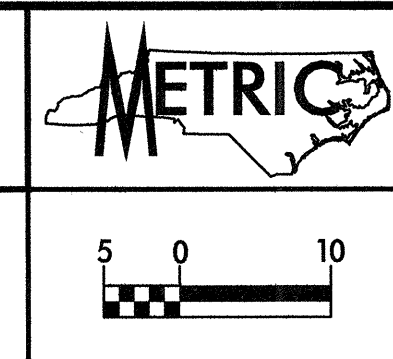

PROJECT REFERENCE NO. R-513C	SHEET NO. 2-5
R / W SHEET NO.	
ROADWAY DESIGN ENGINEER TGS ENGINEERS 12300 7/16/04	HYDRAULICS ENGINEER TGS ENGINEERS 20754 7/16/04
TGS ENGINEERS 975 WALNUT STREET, SUITE 141 CARY, NC 27511 PH (919) 319-8850	

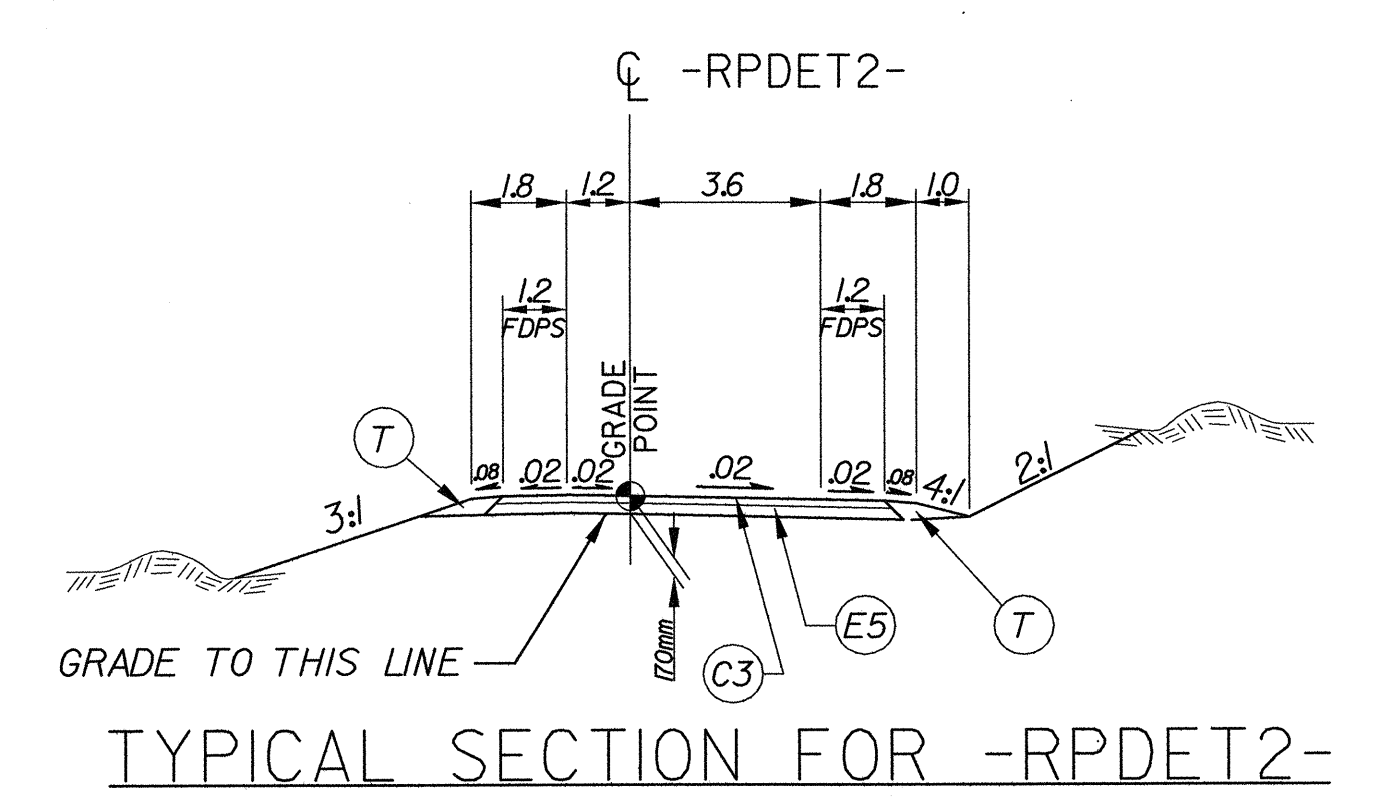

USE TYPICAL SECTION FOR:
LINE -RPDET2- STA. 10+00.000 TO STA. 13+23.089

NOTES:
*WIDENING & RESURFACING ONLY AS FOLLOWS:
LINE -RPDET2- STA. 11+67.833 TO 13+23.089
*REFER TO SHEET 2 FOR PAVEMENT SCHEDULE

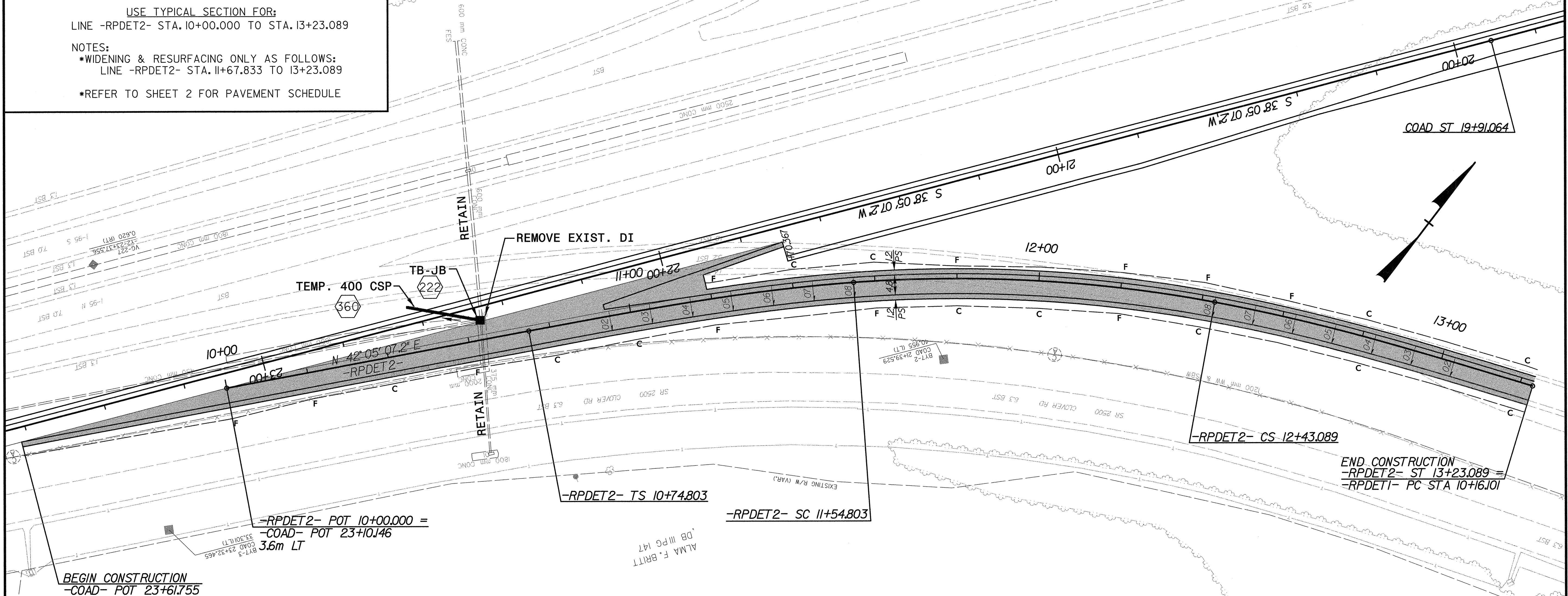

-RPDET2-		
PIs Sta. 11+28.173	PI Sta. 11+99.181	PIs Sta. 12+69.789
Os = 6° 32' 53.1"	Δ = 14° 27' 09.2" (RT)	Os = 6° 32' 53.1"
Ls = 80.000	L = 88.286	Ls = 80.000
LT = 53.370	T = 44.378	LT = 53.370
ST = 26.700	R = 350.000	ST = 26.700

SEE SHEET NO. 137 FOR LINE -RPDET2- GRADE AND PROFILE.
SEE SHEET NO. 37 FOR LINE -COAD- PLAN.

8/17/04
 TGS ENGINEERS
 975 WALNUT STREET, SUITE 141
 CARY, NC 27511
 PH (919) 319-8850

07/14/2004 08:19:52 AM