

REVISIONS

| | |
|-----|-------------|
| NO. | DESCRIPTION |
| | |

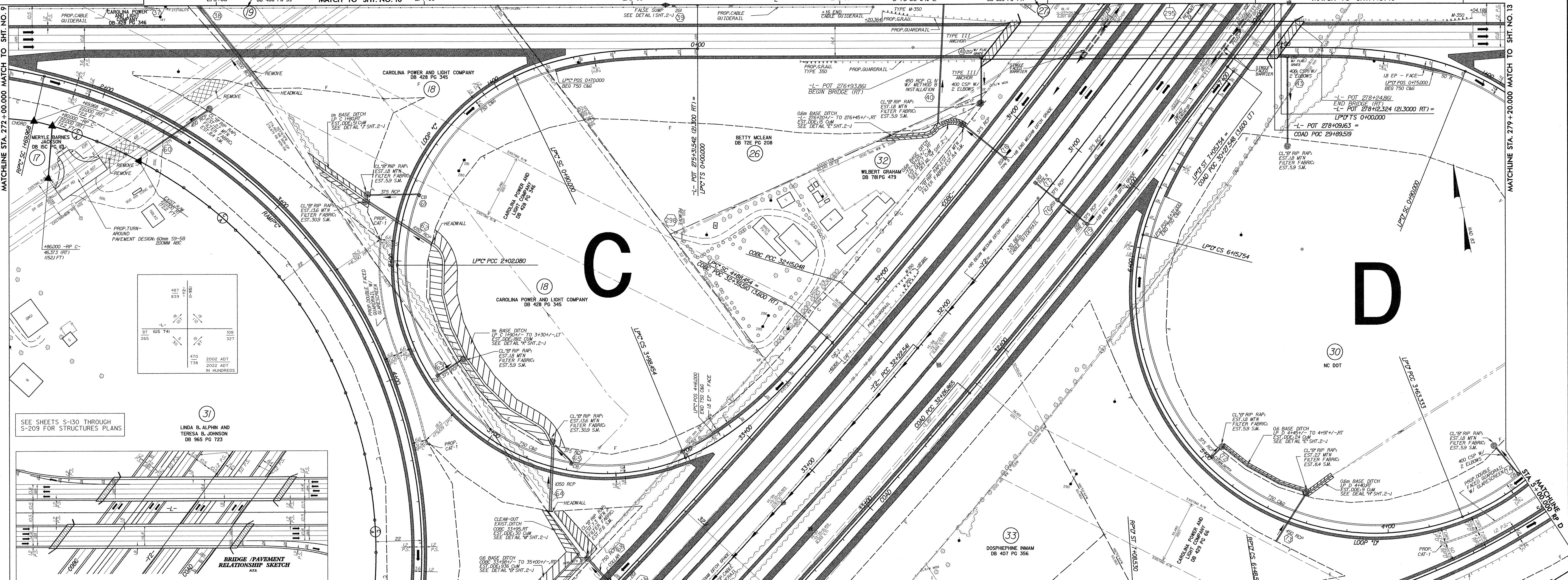

SEE SHEETS S-130 THROUGH S-209 FOR STRUCTURES PLANS

LINDA B. ALPHIN AND TERESA B. JOHNSON DB 965 PG 723

BRIDGE / PAVEMENT RELATIONSHIP SKETCH

SEE SHEETS NO. 55 AND NO. 56 FOR LINE 'L' GRADE AND PROFILE.
SEE SHEETS NO. 81 AND NO. 82 FOR RAMP 'C' GRADE AND PROFILE.
SEE SHEET NO. 83 FOR LOOP 'C' GRADE AND PROFILE.
SEE SHEETS NO. 83 AND NO. 84 RAMP 'D' GRADE AND PROFILE.
SEE SHEETS NO. 84 AND 85 LOOP 'D' GRADE AND PROFILE.
SEE SHEETS NO. 91 AND NO. 98 FOR '-Y2-' RT LN & '-Y2-' LT LN GRADES AND PROFILES.
SEE SHEETS NO. 104 AND NO. 105 FOR COAD GRADE AND PROFILE.
SEE SHEETS NO. 108 AND NO. 109 FOR COBC GRADE AND PROFILE.

DENOTES REMOVAL OF EXIST. PAVEMENT

| COAD | | | COBC | | | LOOP 'C' | | | RAMP 'C' | | | RAMP 'D' | | | | |
|------------------|----------------------|----------------------|-----------------|----------------------|----------------------|------------------|----------------------|-----------------------|------------------|-----------------|----------------------|----------------------|------------------|----------------------|-----------------------|------------------|
| PI Sta 24+927.25 | PI Sta 28+815.15 | PI Sta 36+392.89 | PI Sta 25+03.57 | PI Sta 28+777.312 | PI Sta 36+15.94 | PI Sta 0+60.649 | PI Sta 1+527.50 | PI Sta 3+451.781 | PI Sta 4+299.96 | PI Sta 25+03.57 | PI Sta 28+777.312 | PI Sta 36+15.94 | PI Sta 0+60.649 | PI Sta 1+527.50 | PI Sta 3+451.781 | PI Sta 4+299.96 |
| Δs = 7°55'55.5" | Δ = 12°57'38.2" (RT) | Δ = 14°09'16.0" (RT) | Δs = 0°59'45.8" | Δ = 12°57'02.7" (RT) | Δ = 14°02'13.2" (RT) | Δs = 25°46'59.2" | Δ = 64°17'00.8" (LT) | Δ = 112°30'51.9" (LT) | Δs = 26°34'32.9" | Δs = 0°59'45.8" | Δ = 12°57'02.7" (RT) | Δ = 14°02'13.2" (RT) | Δs = 25°46'59.2" | Δ = 64°17'00.8" (LT) | Δ = 112°30'51.9" (LT) | Δs = 26°34'32.9" |
| Ls = 100.000 | L = 685.978 | L = 800.648 | Ls = 99.458 | L = 670.329 | L = 797.718 | Ls = 112.089 | L = 112.089 | L = 186.375 | Ls = 90.000 | Ls = 99.458 | L = 670.329 | L = 797.718 | Ls = 112.089 | L = 112.089 | L = 186.375 | Ls = 90.000 |
| LT = 66.028 | T = 548.277 | T = 412.424 | LT = 66.306 | T = 340.593 | T = 404.866 | LT = 60.649 | T = 627.50 | T = 149.701 | LT = 3252.500 | LT = 66.028 | T = 548.277 | T = 412.424 | LT = 60.649 | T = 627.50 | T = 149.701 | LT = 3252.500 |
| ST = 33534 | R = 3250.000 | R = 3250.000 | ST = 33534 | R = 3250.000 | R = 3250.000 | ST = 30591 | R = 100.000 | R = 100.000 | ST = 100.000 | ST = 33534 | R = 3250.000 | R = 3250.000 | ST = 30591 | R = 100.000 | R = 100.000 | ST = 100.000 |
| SE = 2.5% | SE = 2.5% | SE = 2.5% | SE = 2.5% | SE = 2.5% | SE = 2.5% | SE = 8% | SE = 8% | SE = 8% | SE = 8% | SE = 2.5% | SE = 2.5% | SE = 2.5% | SE = 8% | SE = 8% | SE = 8% | SE = 8% |

| RAMP 'Y2' | | | RAMP 'Y1' | | | LOOP 'D' | | | RAMP 'Y2' | | | RAMP 'Y1' | | | |
|-------------------|----------------------|----------------------|-----------------|----------------------|----------------------|------------------|-----------------------|-----------------------|------------------|-------------------|----------------------|----------------------|-----------------|----------------------|----------------------|
| PI Sta 25+103.231 | PI Sta 28+803.988 | PI Sta 36+392.89 | PI Sta 1+40.083 | PI Sta 5+168.474 | PI Sta 6+167.883 | PI Sta 0+60.488 | PI Sta 3+475.935 | PI Sta 5+187.879 | PI Sta 6+461.958 | PI Sta 25+103.231 | PI Sta 28+803.988 | PI Sta 36+392.89 | PI Sta 1+40.083 | PI Sta 5+168.474 | PI Sta 6+167.883 |
| Δs = 0°59'45.8" | Δ = 12°57'02.7" (RT) | Δ = 14°09'16.0" (RT) | Δs = 0°59'45.8" | Δ = 13°37'57.1" (RT) | Δ = 14°55'34.7" (RT) | Δs = 25°25'12.3" | Δ = 138°19'51.9" (RT) | Δ = 125°45'43.0" (RT) | Δs = 25°25'12.3" | Δs = 0°59'45.8" | Δ = 12°57'02.7" (RT) | Δ = 14°09'16.0" (RT) | Δs = 0°59'45.8" | Δ = 13°37'57.1" (RT) | Δ = 14°55'34.7" (RT) |
| Ls = 100.000 | L = 685.978 | L = 800.648 | Ls = 90.000 | L = 338.505 | L = 329.500 | Ls = 90.000 | L = 273.333 | L = 294.491 | Ls = 90.000 | Ls = 100.000 | L = 685.978 | L = 800.648 | Ls = 90.000 | L = 338.505 | L = 329.500 |
| LT = 66.028 | T = 548.277 | T = 412.424 | LT = 60.000 | T = 325.000 | T = 235.000 | LT = 60.488 | T = 285.935 | T = 224.546 | LT = 60.488 | LT = 66.028 | T = 548.277 | T = 412.424 | LT = 60.000 | T = 325.000 | T = 235.000 |
| ST = 20044 | R = 350.000 | ST = 30047 | ST = 20044 | R = 100.000 | R = 100.000 | ST = 30444 | R = 115.000 | R = 115.000 | ST = 30444 | ST = 20044 | R = 350.000 | R = 350.000 | ST = 20044 | R = 100.000 | R = 100.000 |
| SE = 7% | SE = 7% | SE = 7% | SE = 7% | SE = 8% | SE = 8% | SE = 8% | SE = 8% | SE = 8% | SE = 8% | SE = 7% | SE = 7% | SE = 7% | SE = 7% | SE = 8% | SE = 8% |

| RAMP 'Y2' | | | RAMP 'Y1' | | | LOOP 'D' | | | RAMP 'Y2' | | | RAMP 'Y1' | | | |
|-----------------|---------------------|-----------------|------------------|-----------------------|-----------------------|------------------|-----------------------|-----------------------|------------------|-----------------|---------------------|-----------------|------------------|-----------------------|-----------------------|
| PI Sta 7+63.024 | PI Sta 8+57.148 | PI Sta 9+59.075 | PI Sta 4+299.96 | PI Sta 5+187.879 | PI Sta 6+167.883 | PI Sta 0+60.488 | PI Sta 3+475.935 | PI Sta 5+187.879 | PI Sta 6+461.958 | PI Sta 7+63.024 | PI Sta 8+57.148 | PI Sta 9+59.075 | PI Sta 4+299.96 | PI Sta 5+187.879 | PI Sta 6+167.883 |
| Δs = 4°54'39.8" | Δ = 2°57'12.0" (LT) | Δs = 4°54'39.8" | Δs = 25°25'12.3" | Δ = 138°19'51.9" (RT) | Δ = 125°45'43.0" (RT) | Δs = 25°25'12.3" | Δ = 138°19'51.9" (RT) | Δ = 125°45'43.0" (RT) | Δs = 25°25'12.3" | Δs = 4°54'39.8" | Δ = 2°57'12.0" (LT) | Δs = 4°54'39.8" | Δs = 25°25'12.3" | Δ = 138°19'51.9" (RT) | Δ = 125°45'43.0" (RT) |
| Ls = 60.000 | L = 166.853 | Ls = 60.000 | Ls = 90.000 | L = 273.333 | L = 294.491 | Ls = 90.000 | L = 273.333 | L = 294.491 | Ls = 90.000 | Ls = 60.000 | L = 166.853 | Ls = 60.000 | Ls = 90.000 | L = 273.333 | L = 294.491 |
| LT = 74.739 | T = 40.015 | LT = 74.739 | LT = 60.488 | T = 285.935 | T = 224.546 | LT = 60.488 | T = 285.935 | T = 224.546 | LT = 60.488 | LT = 74.739 | T = 40.015 | LT = 74.739 | LT = 60.000 | T = 325.000 | T = 235.000 |
| ST = 20044 | R = 350.000 | ST = 30047 | ST = 20044 | R = 100.000 | R = 100.000 | ST = 30444 | R = 115.000 | R = 115.000 | ST = 30444 | ST = 20044 | R = 350.000 | ST = 30047 | ST = 20044 | R = 100.000 | R = 100.000 |
| SE = 7% | SE = 7% | SE = 7% | SE = 8% | SE = 8% | SE = 8% | SE = 8% | SE = 8% | SE = 8% | SE = 8% | SE = 7% | SE = 7% | SE = 7% | SE = 7% | SE = 8% | SE = 8% |

ROADWAY DESIGN ENGINEER

HYDRAULICS ENGINEER

PROJECT REFERENCE NO. SHEET NO. 7

E/W SHEET NO.

METRIC

CONSTANT

E/W REV.

7/16/04

7/16/04