

REVISIONS

RAMP 'D'

Pls Sta 7+63.024 PI Sta 8+57.148 Pls Sta 9+59.175  
 $\theta_s = 4' 54' 39.8"$   $\Delta = 23' 55' 12.0"$  (LT)  $\theta_s = 7' 21' 59.8"$   
 $L_s = 60.000$   $L = 146.119$   $L_s = 90.000$   
 $LT = 40.015$   $T = 74.139$   $LT = 60.052$   
 $ST = 20.014$   $R = 350.000$   $ST = 30.047$   
 $SE = 7\%$

-Y2-

Pls Sta 38+32.987 PI Sta 38+32.987  
 $\theta_s = 2' 01' 45.0"$  (RT)  
 $L_s = 1207.155$   $L = 1207.155$   
 $T = 610.446$   $R = 3,289,000$   
 $SE = 2.5\%$

COAD

Pls Sta 24+99.725 PI Sta 28+81.515 PI Sta 36+39.289  
 $\theta_s = 0' 55' 55.5"$   $\Delta = 12' 51' 38.8"$  (RT)  $\Delta = 14' 09' 16.0"$  (RT)  
 $L_s = 100.540$   $L = 693.628$   $L_s = 820.648$   
 $LT = 67.028$   $T = 348.277$   $T = 412.424$   
 $ST = 33.514$   $R = 3,090,169$   $R = 3,321,900$   
 $SE = 2.5\%$

**METRIC**

5 0 10

CONST. REV.  
R/W REV.

PROJECT REFERENCE NO. R-5130 SHEET NO. 38

R/W SHEET NO.

ROADWAY DESIGN ENGINEER  
NORTH CAROLINA PROFESSIONAL SEAL 12300  
CHARLES LEE FLOWERS

HYDRAULICS ENGINEER  
NORTH CAROLINA PROFESSIONAL SEAL 20754  
T. STEPHENS

TGS ENGINEERS  
975 WALNUT STREET, SUITE 141  
CARY, NC 27511  
PH (919) 319-8850

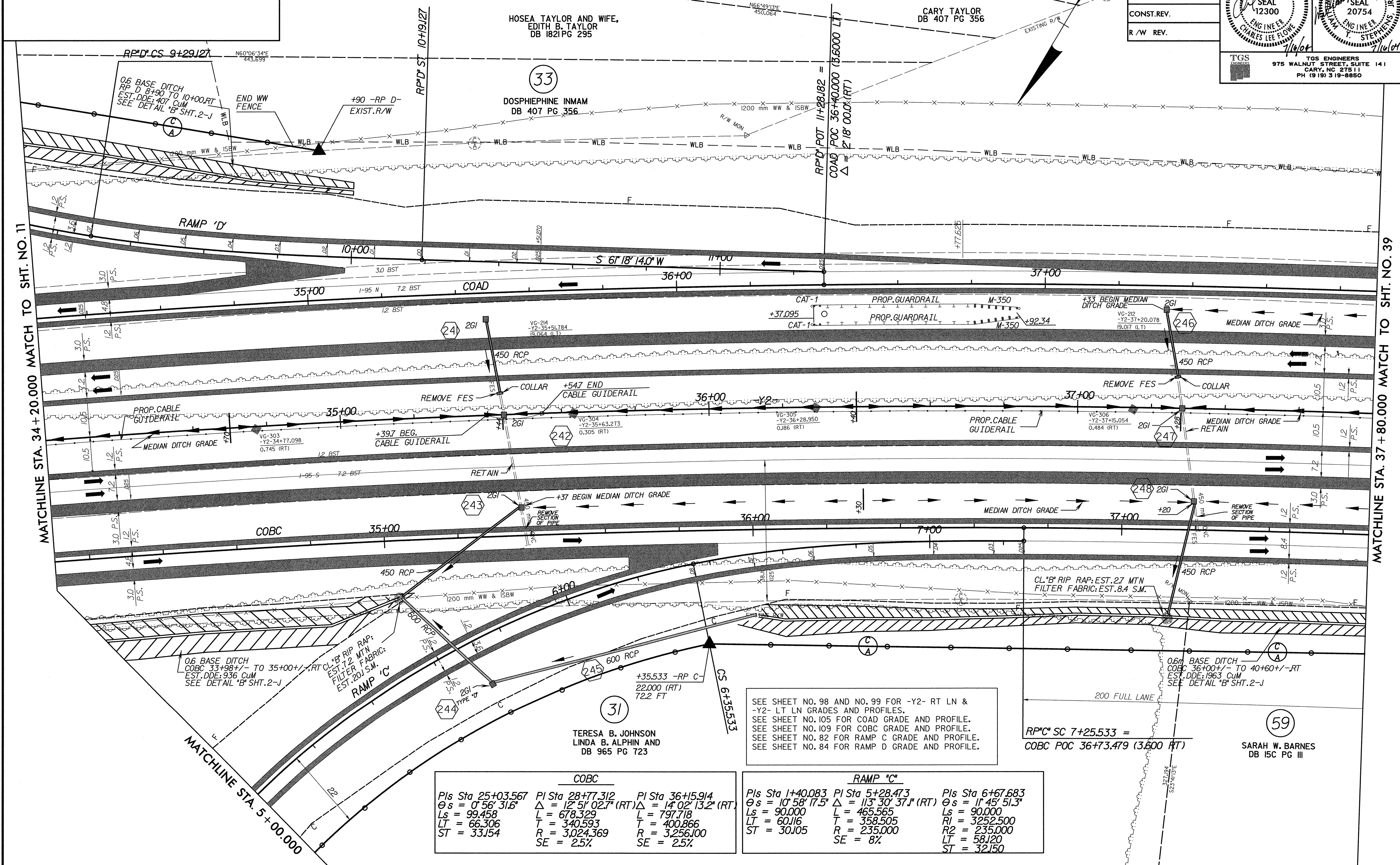

**COBC**

Pls Sta 25+03.567 PI Sta 28+77.312 PI Sta 36+15.914  
 $\theta_s = 0' 58' 31.6"$   $\Delta = 12' 51' 02.7"$  (RT)  $\Delta = 14' 02' 13.2"$  (RT)  
 $L_s = 99.458$   $L = 678.329$   $L = 797.718$   
 $LT = 66.306$   $T = 340.593$   $T = 400.866$   
 $ST = 33.154$   $R = 3,024,369$   $R = 3,256,100$   
 $SE = 2.5\%$

**RAMP 'C'**

Pls Sta 1+40.083 PI Sta 5+28.473 Pls Sta 6+67.683  
 $\theta_s = 10' 58' 17.5"$   $\Delta = 113' 30' 37.1"$  (RT)  $\theta_s = 11' 45' 51.3"$   
 $L_s = 90.000$   $L = 465.565$   $L_s = 90.000$   
 $LT = 60.116$   $R = 358,505$   $R = 3,252,500$   
 $ST = 30.105$   $R = 235,000$   $LT = 58.120$   
 $SE = 8\%$

SEE SHEET NO. 98 AND NO. 99 FOR -Y2- RT LN & -Y2- LT LN GRADES AND PROFILES.  
 SEE SHEET NO. 105 FOR COAD GRADE AND PROFILE.  
 SEE SHEET NO. 109 FOR COBC GRADE AND PROFILE.  
 SEE SHEET NO. 82 FOR RAMP C GRADE AND PROFILE.  
 SEE SHEET NO. 84 FOR RAMP D GRADE AND PROFILE.

15130C.WORK\PS13038.PSH 07/15/04 08:55:05 AM