

REVISIONS

METRIC

5 0 10

CONST. REV.

R/W REV.

PROJECT REFERENCE NO. R-513C	SHEET NO. 49
R/W SHEET NO.	
ROADWAY DESIGN ENGINEER SEAL 12300 CHARLES LEE FLOWERS	HYDRAULICS ENGINEER SEAL 20754 T. STEPHENS, JR.
TGS ENGINEERS 975 WALNUT STREET, SUITE 141 CARY, NC 27511 PH (919) 319-8850	

-Y3-

Pls Sta 40+41.722	Pls Sta 41+44.231	Pls Sta 42+44.590
$\theta_s = 4^\circ 35' 01.2''$	$\Delta = 22^\circ 56' 50.4''$ (RT)	$\theta_s = 4^\circ 35' 01.2''$
$L_s = 64.000$	$L = 160.203$	$L_s = 64.000$
$LT = 42.681$	$T = 81.190$	$LT = 42.681$
$ST = 21.346$	$R = 400.000$	$ST = 21.346$
	$SE = 8\%$	

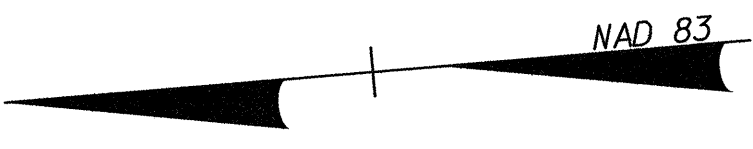
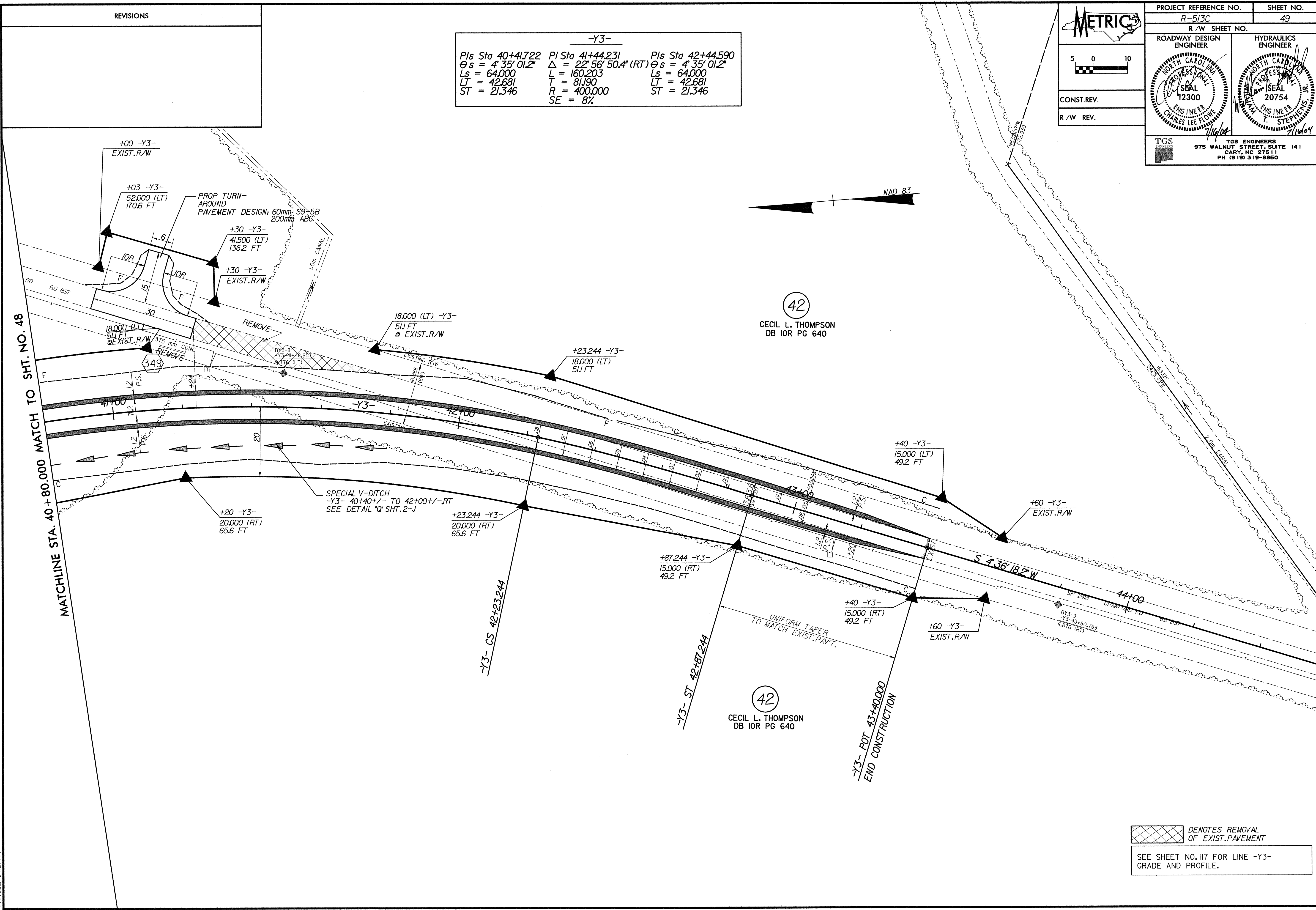

(42)
CECIL L. THOMPSON
DB IOR PG 640

(42)
CECIL L. THOMPSON
DB IOR PG 640

MATCHLINE STA. 40 + 80.000 MATCH TO SHT. NO. 48

DENOTES REMOVAL OF EXIST. PAVEMENT

SEE SHEET NO. 117 FOR LINE -Y3- GRADE AND PROFILE.

11/15/2004 12:06:10 PM
 V:\0513C\WDR\11715149.PSH
 07/15/2004 12:06:10 PM