

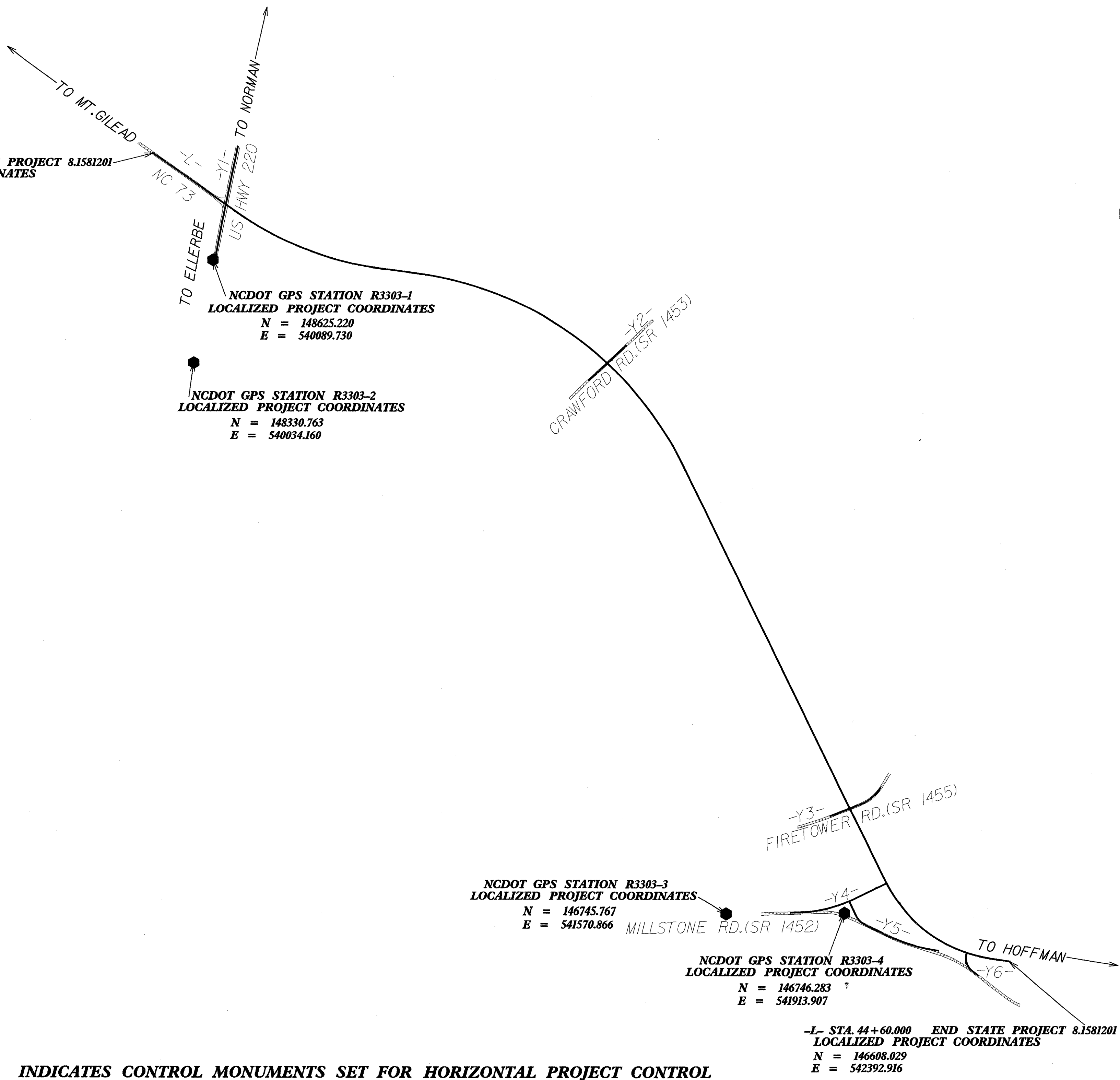

SURVEY CONTROL SHEET

-L- STA. 8+40.000 BEGIN STATE PROJECT 8.1581201
 LOCALIZED PROJECT COORDINATES
 N = 148934.484
 E = 539915.913



NCDOT GPS STATION R3303-1
 LOCALIZED PROJECT COORDINATES
 N = 148625.220
 E = 540089.730

NCDOT GPS STATION R3303-2
 LOCALIZED PROJECT COORDINATES
 N = 148330.763
 E = 540034.160

NCDOT GPS STATION R3303-3
 LOCALIZED PROJECT COORDINATES
 N = 146745.767
 E = 541570.866

NCDOT GPS STATION R3303-4
 LOCALIZED PROJECT COORDINATES
 N = 146746.283
 E = 541913.907

-L- STA. 44+60.000 END STATE PROJECT 8.1581201
 LOCALIZED PROJECT COORDINATES
 N = 146608.029
 E = 542392.916

● INDICATES CONTROL MONUMENTS SET FOR HORIZONTAL PROJECT CONTROL BY THE NCDOT LOCATION AND SURVEYS UNIT. PROJECT CONTROL ESTABLISHED UTILIZING GLOBAL POSITIONING SYSTEM. NETWORK ESTABLISHED FROM EXISTING NAD 83 MONUMENTATION.

NOTE: DRAWING NOT TO SCALE

NOTES

1. THE CONTROL DATA FOR THIS PROJECT CAN BE FOUND ELECTRONICALLY BY SELECTING PROJECT CONTROL DATA AT [HTTP://WWW.DOH.DOT.STATE.NC.US/PRECONSTRUCTION/HIGHWAY/ LOCATION/PROJECT/](http://www.doh.dot.state.nc.us/preconstruction/highway/location/project/) THE FILES TO BE FOUND ARE AS FOLLOWS:
 R3303_LS_CONTROL_030505.TXT
 IF FURTHER INFORMATION IS NEEDED, PLEASE CONTACT THE LOCATION AND SURVEYS UNIT.

DATUM DESCRIPTION

THE LOCALIZED COORDINATE SYSTEM DEVELOPED FOR THIS PROJECT IS BASED ON THE STATE PLANE COORDINATES ESTABLISHED BY NCDOT FOR MONUMENT "R2231-10" WITH NAD 83 STATE PLANE GRID COORDINATES OF NORTHING: 147335.107(M) EASTING: 542189.156(M) THE AVERAGE COMBINED GRID FACTOR USED ON THIS PROJECT (GROUND TO GRID) IS: 0.999861638 THE N.C. LAMBERT GRID BEARING AND LOCALIZED HORIZONTAL GROUND DISTANCE FROM "R2231-10" TO -L- STATION 8+40.000 IS N 21°52' 15.9" W 2779.503 m ALL LINEAR DIMENSIONS ARE LOCALIZED HORIZONTAL DISTANCES VERTICAL DATUM USED IS NGVD 29