



170+00

DEPPE LOOP RD
SR 1330
(-Y1-)

172+00

173+00

EXIST. US 17

BREAKLINE SEE SHEET TCP-20

BREAKLINE SEE SHEET TCP-22

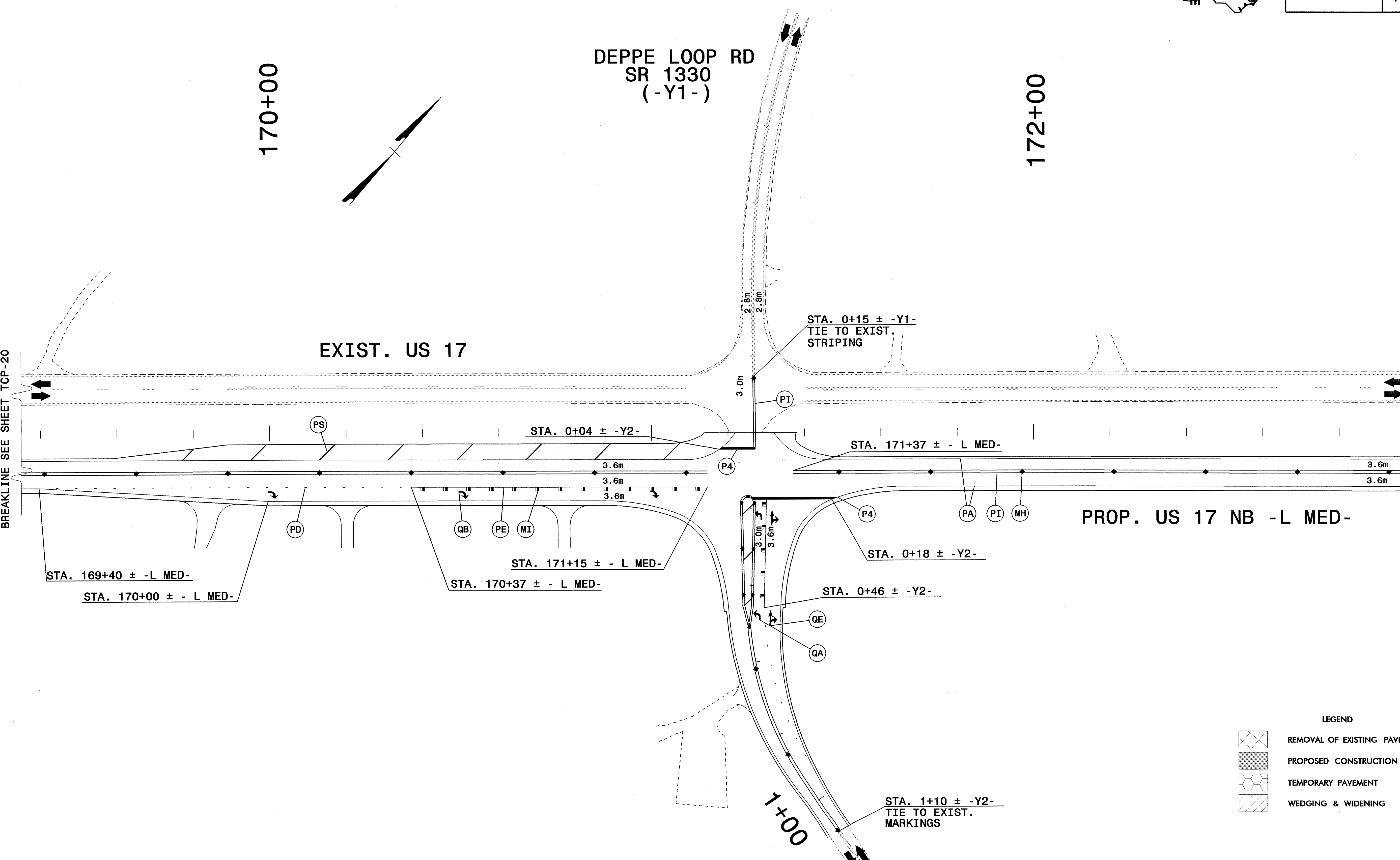

PROP. US 17 NB -L MED-

LEGEND

	REMOVAL OF EXISTING PAVEMENT
	PROPOSED CONSTRUCTION
	TEMPORARY PAVEMENT
	WEDGING & WIDENING

23-NOV-2003 2:00:01
 G:\CAD\2003\CON\N\R-2514A\TrafficControl\TCP\R-2514A_TC_TCP21.dgn
 GUNN AT DUNN

DEPPE LOOP
SR 1436
(-Y2-)

APPROVED:	DATE:	PHASE I TEMPORARY PAVEMENT MARKINGS AND MARKERS						
SCALE:	NONE							
DATE:	11/18/03							
DWG. BY:	KWD							
DESIGN BY:	KWD							
REVIEWED BY:	JHJ	<table border="1"> <thead> <tr> <th colspan="2">REVISIONS</th> </tr> </thead> <tbody> <tr> <td> </td> <td> </td> </tr> <tr> <td> </td> <td> </td> </tr> </tbody> </table>	REVISIONS					
REVISIONS								
		<small>CADD FILE R-2514A_TC_TCP21.DGN</small>						