

6/24/99

See Sheet 1-A For Index of Sheets  
See Sheet 1-B For Conventional Symbols



ALL DIMENSIONS IN THESE PLANS ARE IN METERS UNLESS OTHERWISE SHOWN

STATE	STATE PROJECT REFERENCE NO.	SHEET NO.	TOTAL SHEETS
N.C.	R-2514A	1	
STATE PROJ. NO.	F.A. PROJ. NO.	DESCRIPTION	
34442.1.1	NHF-17(7)	PE	
34442.2.2	NHF-17(7)	RW & UTIL	
34442.3.3		CONST.	

# STATE OF NORTH CAROLINA DIVISION OF HIGHWAYS

## ONslow COUNTY

**LOCATION: US 17 NORTH OF JACKSONVILLE FROM  
SR 1327 /SR 1410 TO SR 1330 /SR 1439 SOUTH OF BELGRADE**

**TYPE OF WORK: WIDENING, GRADING, DRAINAGE, PAVING  
CULVERTS, STRUCTURES AND SIGNING**

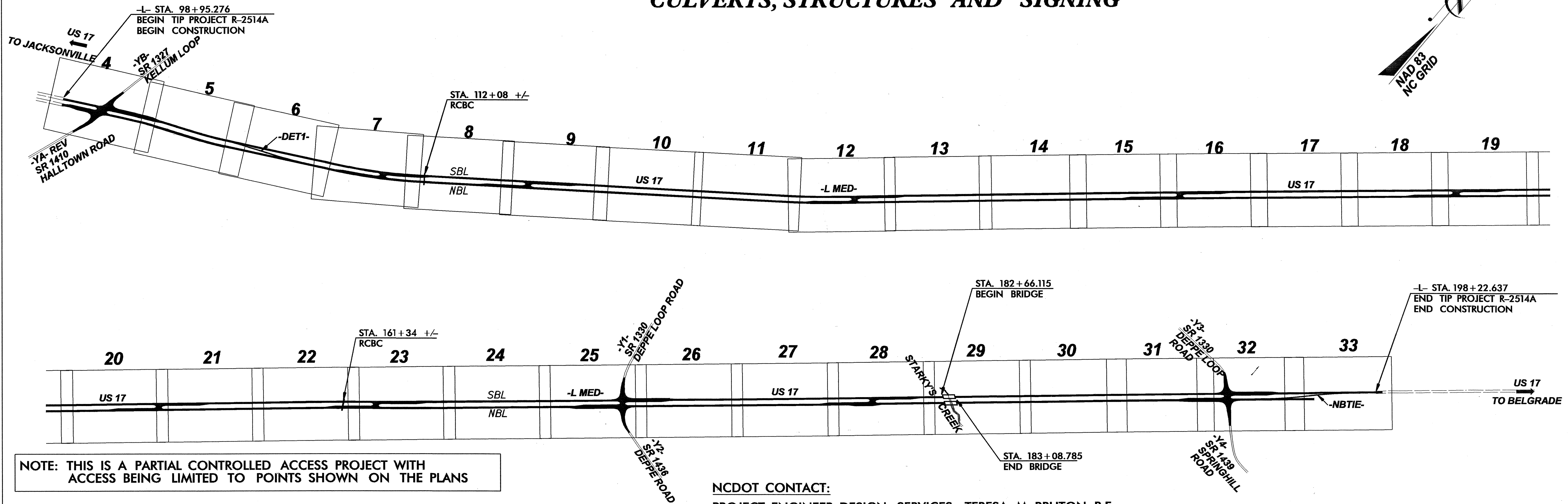
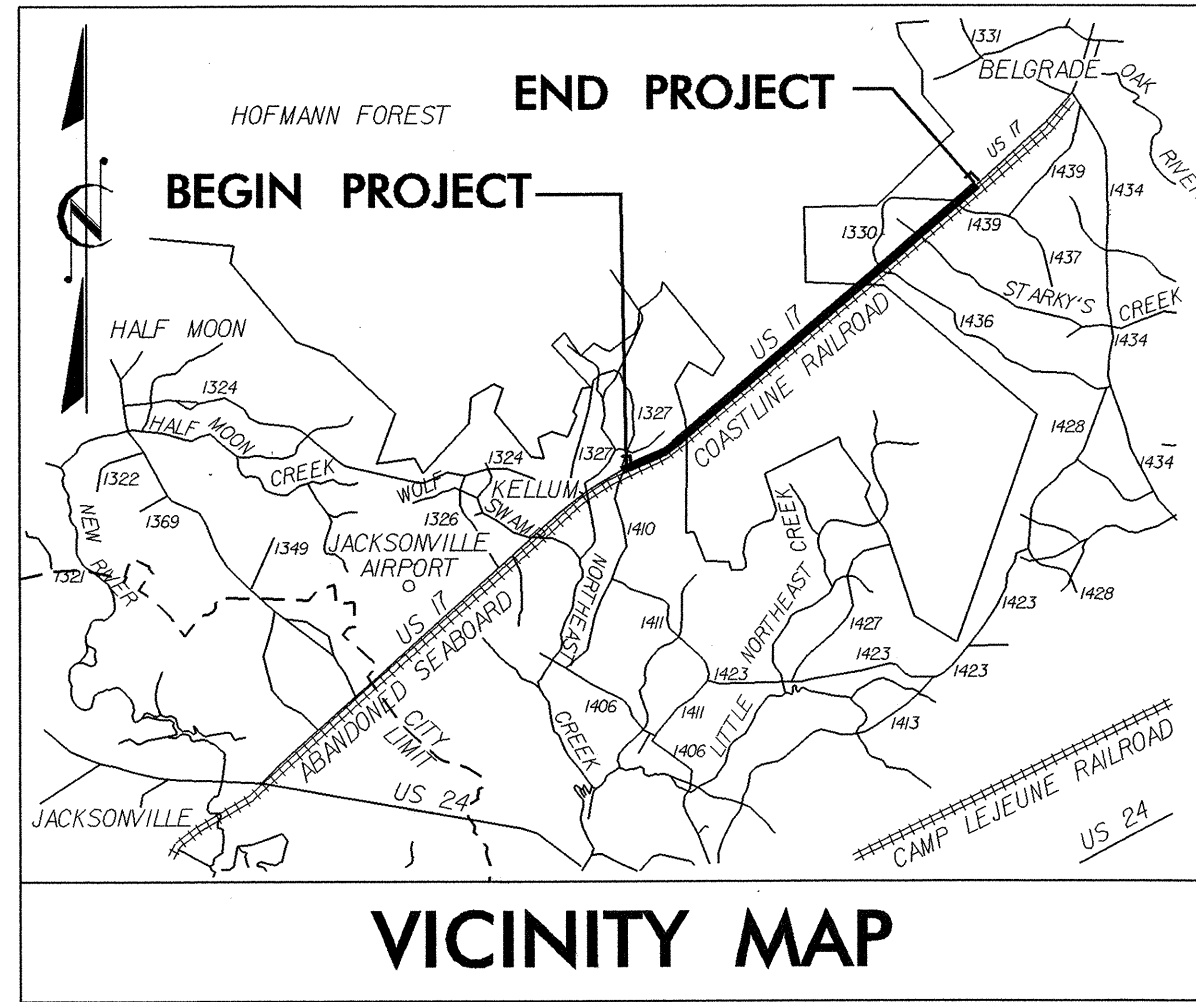

NOTE: THIS IS A PARTIAL CONTROLLED ACCESS PROJECT WITH ACCESS BEING LIMITED TO POINTS SHOWN ON THE PLANS

NCDOT CONTACT:  
PROJECT ENGINEER-DESIGN SERVICES: TERESA M. BRUTON, P.E.

**CONTRACT: C200819 TIP: R-2514A**

### GRAPHIC SCALE

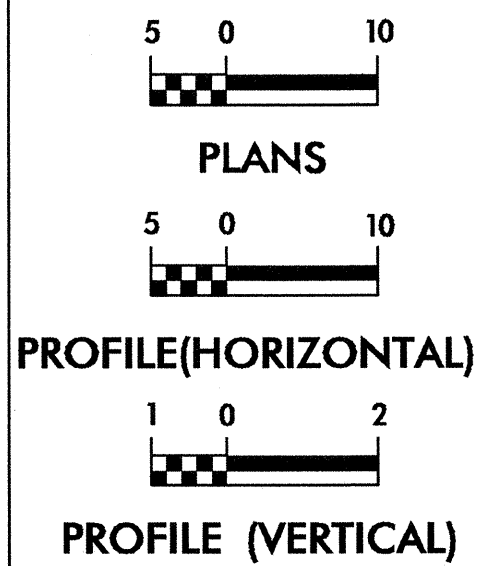

### DESIGN DATA

ADT 2005 = 20,080  
ADT 2025 = 29,600

DHV = 10 %  
D = 60 %  
T = 13 % \*  
V = 100 km/h

\* (TTST 6% + DUAL 7%)

### PROJECT LENGTH

LENGTH ROADWAY TIP PROJECT R-2514A = 9.884 km  
LENGTH STRUCTURE TIP PROJECT R-2514A = 0.043 km  
TOTAL LENGTH TIP PROJECT R-2514A = 9.927 km

Prepared in the Office of:  
**TAYLOR, WISEMAN, & TAYLOR**  
3500 REGENCY PARKWAY, SUITE H  
CARY, NC 27511  
919-297-0085

FOR NORTH CAROLINA DEPARTMENT OF TRANSPORTATION  
2002 STANDARD SPECIFICATIONS

RIGHT OF WAY DATE:  
April, 18 2002

LETTING DATE:  
OCTOBER 19, 2004

**JAMES H. JATKO, P.E.**  
PROJECT ENGINEER

**KENNETH W. DUNN, P.E.**  
DESIGN ENGINEER

### HYDRAULIC ENGINEER

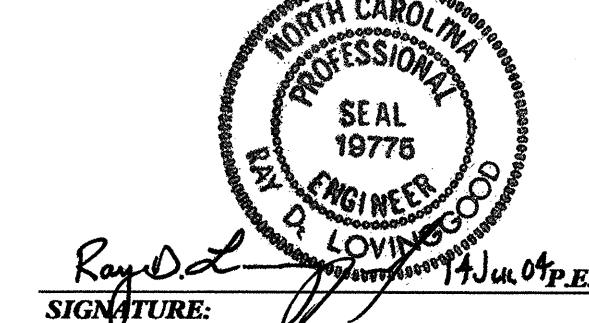

ROADWAY DESIGN ENGINEER  
Professional Engineer Seal  
No. 022392  
**JAMES H. JATKO, P.E.**

### DIVISION OF HIGHWAYS STATE OF NORTH CAROLINA

STATE DESIGN ENGINEER  
**DEPARTMENT OF TRANSPORTATION  
FEDERAL HIGHWAY ADMINISTRATION**

APPROVED  
DIVISION ADMINISTRATOR

DATE

I:\JUL-2004\1526...R-2514A\Roadway\R-2514A\_RDY\_TSH1.dgn