

6/10/03

ROADWAY DESIGN BY:  
**TAYLOR • WISEMAN & TAYLOR**  
 ENGINEERS • SURVEYORS • PLANNERS  
 G.P.S. • SUBSURFACE UTILITY ENGINEERING  
 3500 REGENCY PARKWAY, SUITE H, CARY, N.C. 27511  
 TELEPHONE NO. (919)297-0085 FAX NO. (919)297-0090

**METRIC**

5 0 10

CONST. REV.  
 R/W REV.

PROJECT REFERENCE NO. R-2514A	SHEET NO. 14
R/W SHEET NO.	
ROADWAY DESIGN ENGINEER  JAMES H. JATRO	HYDRAULICS ENGINEER  R. D. LOVINGOOD
HYDRAULIC DESIGN:  TransSystems Corporation	

32

THE ENDOWMENT FUND OF NC STATE UNIVERSITY ET AL. (HOFMANN FOREST).  
 DB. 170, PG. 263  
 DB 516 PG 408  
 HISTORIC PROPERTY

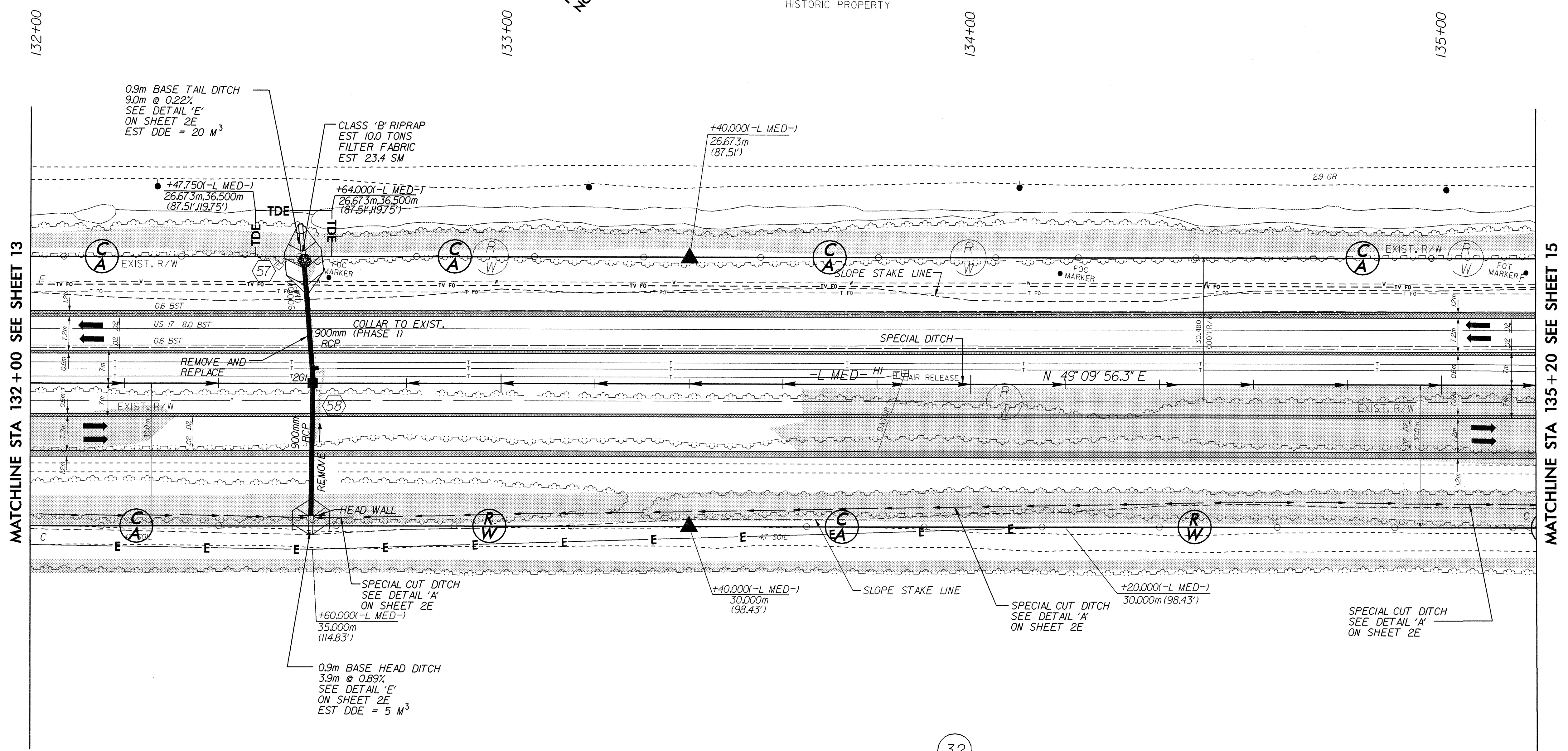
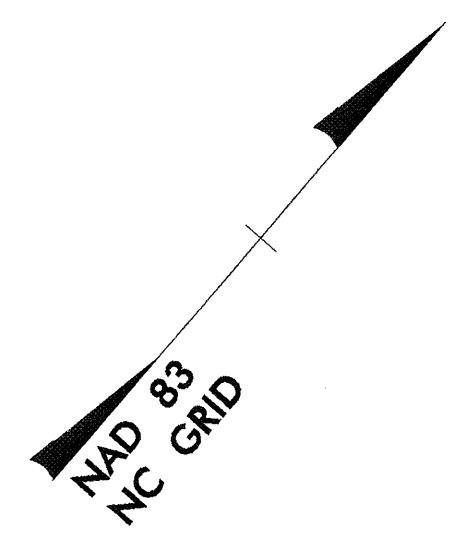

MATCHLINE STA 132 + 00 SEE SHEET 13

MATCHLINE STA 135 + 20 SEE SHEET 15

32

THE ENDOWMENT FUND OF NC STATE UNIVERSITY ET AL. (HOFMANN FOREST).  
 DB. 170, PG. 263  
 DB 516 PG 408  
 HISTORIC PROPERTY

SEE SHEET NO.2E FOR ALL DRIVEWAY DETAILS.

SEE SHEET NO.2E FOR ALL DITCH DETAILS.

SEE SHEET NO. 44 FOR NBL & SBL GRADES AND PROFILES AND ALL DITCH GRADES AND PROFILES

\\cay\70145\0601\AT\PROJECTS\03\0601\N-2514A\_R0Y\_PSH.L14.dgn