

09/09/99

See Sheet 1-A For Index of Sheets

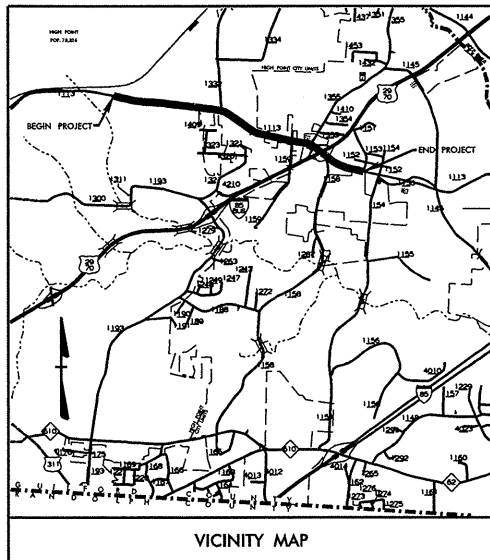

STATE OF NORTH CAROLINA
DIVISION OF HIGHWAYS

GUILFORD COUNTY

LOCATION: HIGH POINT - SR 1113(KIVETT DRIVE) FROM
PENDLETON ST. TO US 29-70

TYPE OF WORK: _____

METRIC

ALL DIMENSIONS IN THESE PLANS ARE IN METERS AND/OR MILLIMETERS UNLESS OTHERWISE SHOWN

| | | | |
|-----------------|-----------------------------|-------------|--------------|
| STATE | STATE PROJECT REFERENCE NO. | SHEET NO. | TOTAL SHEETS |
| N.C. | U-2717 | 3 | 47 |
| STATE PROJ. NO. | F.A. PROJ. NO. | DESCRIPTION | |
| 8.2494001 | STP-1113(2) | | |

U-2717

PROJECT: 8.2494001

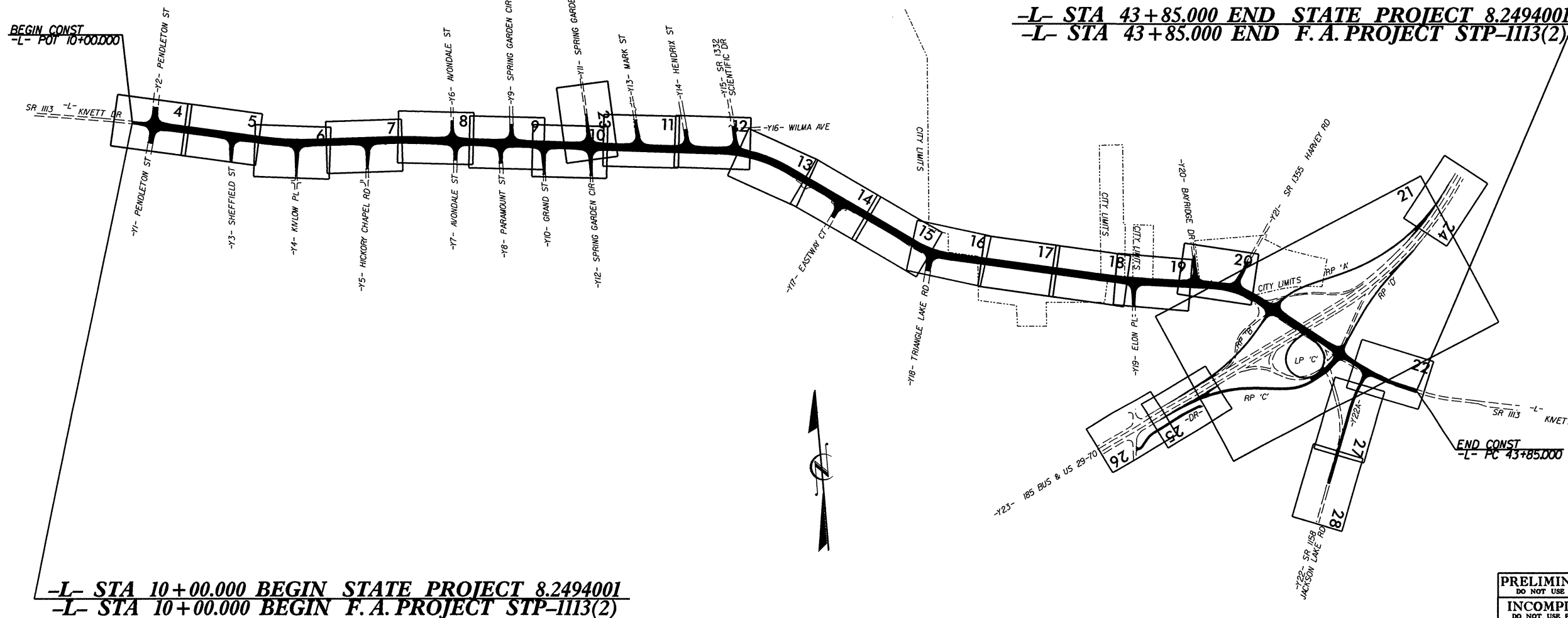

PRELIMINARY PLANS
DO NOT USE FOR CONSTRUCTION
INCOMPLETE PLANS
DO NOT USE FOR R/W ACQUISITION

GRAPHIC SCALES

PLANS: 1" = 2.5'

PROFILE (HORIZONTAL): 1" = 2.5'

PROFILE (VERTICAL): 1" = 0.5'

DESIGN DATA

ADT 1998 = 14,800

ADT 2020 = 25,100

DHV = 10 %

D = 55 %

T = 7 % *

V = 80 kmh

* TTST 4 % DUAL 3 %

PROJECT LENGTH

LENGTH ROADWAY F.A. PROJECT STP-1113(2) = _____ KM

LENGTH STRUCTURE F.A. PROJECT STP-1113(2) = _____ KM

TOTAL LENGTH STATE PROJECT U-2717 = 3.385 KM

Prepared in the Office of:
DIVISION OF HIGHWAYS
1000 Birch Ridge Dr., Raleigh, NC 27610

1995 STANDARD SPECIFICATIONS

RIGHT OF WAY DATE: J. S. GOODNIGHT, PE
PROJECT ENGINEER

LETTING DATE: LEON T. OLIVER
PROJECT DESIGN ENGINEER

HYDRAULICS ENGINEER

SIGNATURE: _____ P.E.

ROADWAY DESIGN ENGINEER

SIGNATURE: _____ P.E.

DIVISION OF HIGHWAYS
STATE OF NORTH CAROLINA

STATE DESIGN ENGINEER: _____ P.E.

DEPARTMENT OF TRANSPORTATION
FEDERAL HIGHWAY ADMINISTRATION

APPROVED: _____ DATE: _____
DIVISION ADMINISTRATOR