

DATUM DESCRIPTION
 THE LOCALIZED COORDINATE SYSTEM DEVELOPED FOR THIS PROJECT IS BASED ON THE STATE PLANE COORDINATES ESTABLISHED BY MOSS FOR MONUMENT "SUNOCO" WITH NAD 83 STATE PLANE GRID COORDINATES OF NORTHING: 245492913mm EASTING: 524931442mm THE AVERAGE COMBINED GRID FACTOR USED ON THIS PROJECT (GROUND TO GRID) IS: 0.999913125 THE N.C. LAMBERT GRID BEARING LOCALIZED HORIZONTAL GROUND DISTANCE FROM "SUNOCO" TO -L- STATION 09+80.000 IS N 75° 03' 28.91" W 2,2979.321m ALL LINEAR DIMENSIONS ARE LOCALIZED HORIZONTAL DISTANCES VERTICAL DATUM USED IS NGVD 29

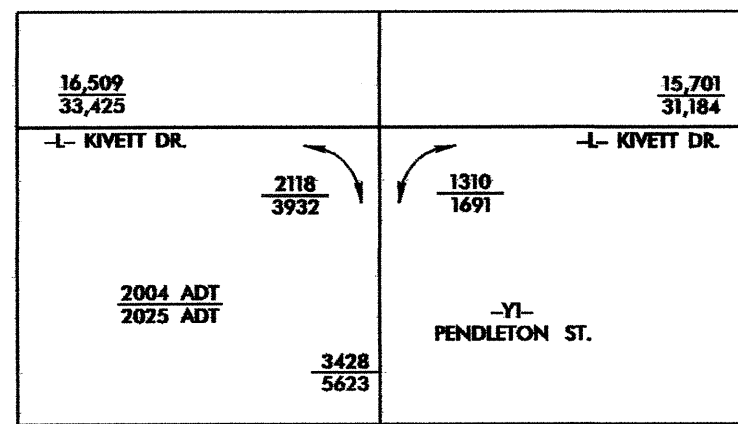

PROJECT REFERENCE NO. U-2717		SHEET NO. EC-31/CONST.4	
R/W SHEET NO.			
ROADWAY DESIGN ENGINEER		HYDRAULICS ENGINEER	
CONST. REV.			
R/W REV.			

TRUSTEES OF HIGH POINT COLLEGE, INC.
 DB 2220 PG 781

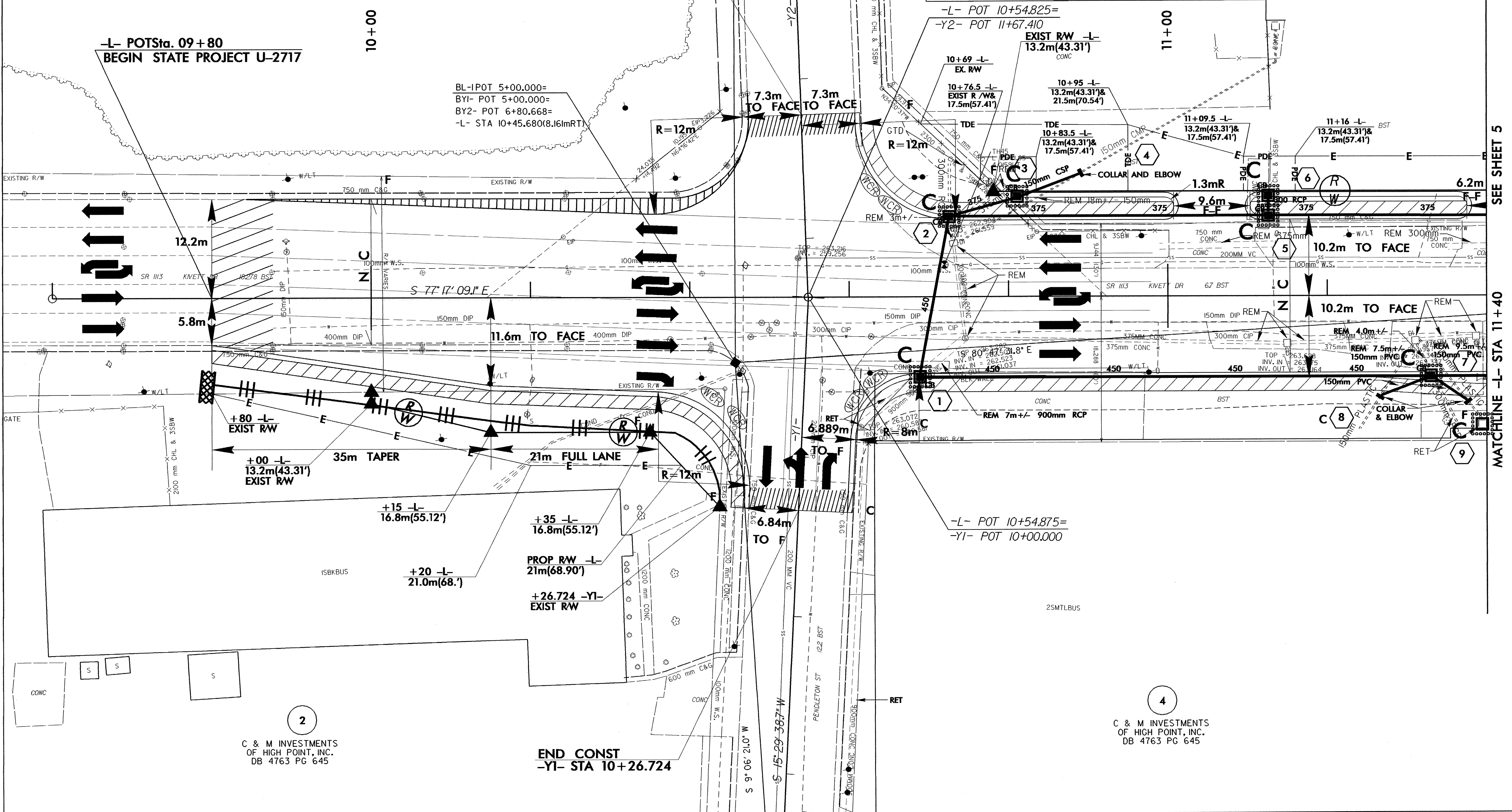

2
 C & M INVESTMENTS
 OF HIGH POINT, INC.
 DB 4763 PG 645

4
 C & M INVESTMENTS
 OF HIGH POINT, INC.
 DB 4763 PG 645

SEE SHEET 5
 MATCHLINE -L- STA 11+40