

# PHASE IV OVERVIEW

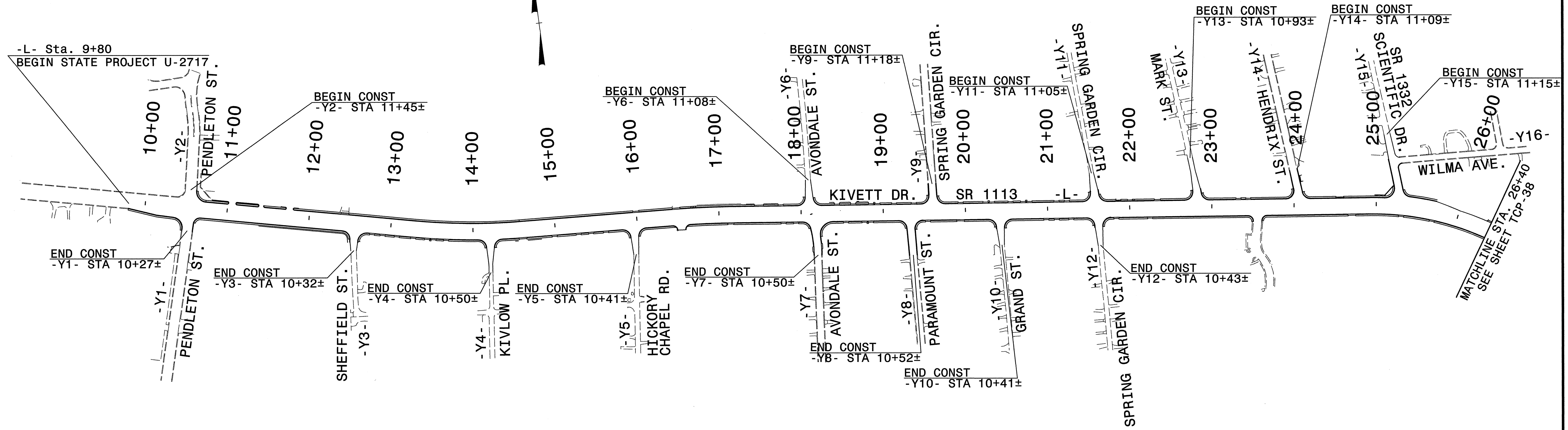

PROJ. REFERENCE NO.	SHEET NO.
U-2717	TCP-37



## PHASE IV

### STEP 1

USING ROADWAY STANDARD DRAWING 1101.02 (SHEET 3 OF 7), PERFORM THE FOLLOWING (SEE SHEETS TCP-40 THRU 42):

- REMOVE PCB FROM MEDIAN OF -Y22- AT PROPOSED BRIDGE.
- PLACE TEMPORARY PAVEMENT MARKINGS AND MARKERS AND SHIFT TRAFFIC TO MEDIAN WIDENING OF -Y22- FROM NB -Y22- STA. 13+90± TO STA. 18+60±
- RESET PCB FROM NB -Y22- STA. 14+40± TO STA. 18+00± (OUTSIDE SHLD.)
- BEHIND BARRIER, CONSTRUCT LOOP 'C' PROPOSED TIE TO EXISTING -Y22-.
- REMOVE PCB ALONG LOOP 'C' AND REPLACE WITH DRUMS.

COMPLETE PROPOSED REPAIR OF EXISTING PAVEMENT ON -L- (BEGUN IN PHASE I).

COMPLETE REMAINING CONSTRUCTION BEGUN IN PHASES I & III.

### STEP 2

USING ROADWAY STANDARD DRAWING 1101.02 (SHEETS 1, 3, 4, 6 & 7 OF 7), PLACE FINAL LAYER OF SURFACE COURSE AND FINAL PAVEMENT MARKINGS & MARKERS ON -L- LINE, ALL -Y- LINES AND RAMPS & LOOP AND OPEN ALL LANES UP TO FINAL TRAFFIC PATTERN.

### STEP 3

REMOVE ALL REMAINING TRAFFIC CONTROL DEVICES.

Plans prepared by:  
**KO & ASSOCIATES, P.C.**  
 Consulting Engineers  
 101 SCHAUB DR., SUITE #202  
 RALEIGH, N.C. 27606  
 For Division of Highways

APPROVED: <i>Michael R. Rzepa</i> DATE: 6-18-04	<b>PHASE IV OVERVIEW &amp; PHASING SHEET 1 OF 2</b>	
	SCALE: NONE	
	DATE: 6-04	
	DWG. BY: MTR	
	DESIGN BY: MTR	
REVIEWED BY: MSA	REVISIONS	

P:\Traffic\U-2717\000\plans\Phase4\over.dgn  
 06/02/2004 04:45:17 PM