

09/08/04

CONTRACT: C201005 TIP PROJECT: B-3840

See Sheet 1-A For Index of Sheets

STATE OF NORTH CAROLINA
DIVISION OF HIGHWAYS

GASTON COUNTY

**LOCATION: BRIDGE 52 OVER SOUTH CROWDERS CREEK
ON SR 1112 (LEWIS ROAD)**

**TYPE OF WORK: GRADING, PAVING, DRAINAGE, CULVERT,
& GUARDRAIL**

STATE	STATE PROJECT REFERENCE NO.	SHEET NO.	TOTAL SHEETS
N.C.	B-3840	1	
STATE PROJ. NO.	F.A. PROJ. NO.	DESCRIPTION	
33288.1.1	BRZ-1112 (3)	P.E.	
33288.2.1	BRZ-1112 (3)	RW, UTIL	
33288.3.1	BRZ-1112(8)	Const.	

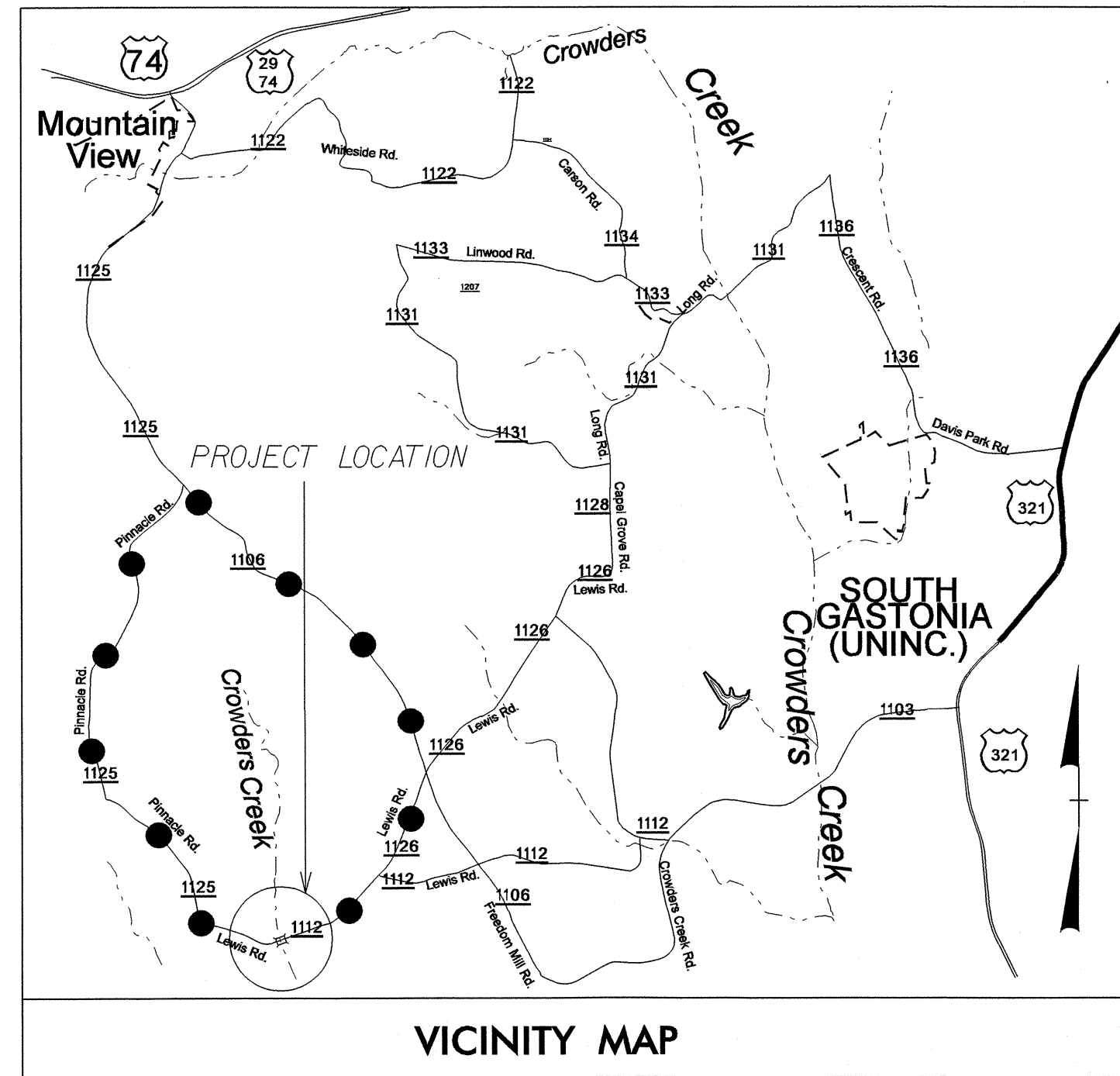

OFF SITE DETOUR ●●●●●●●●●●

BEGIN TIP PROJECT B-3840
-L- STA. 10+00.00

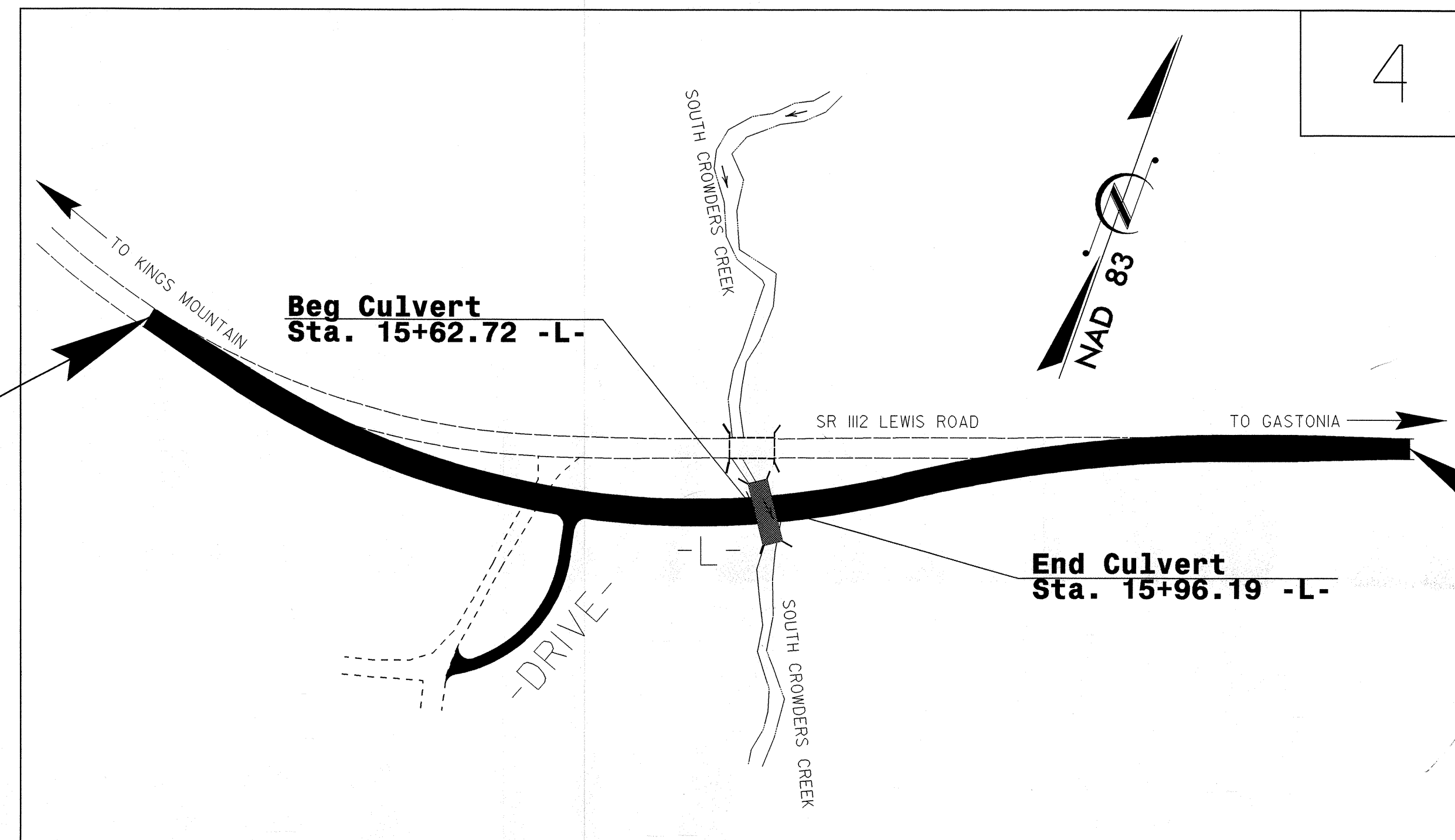

END TIP PROJECT B-3840
-L- STA. 21+65.00

GRAPHIC SCALES

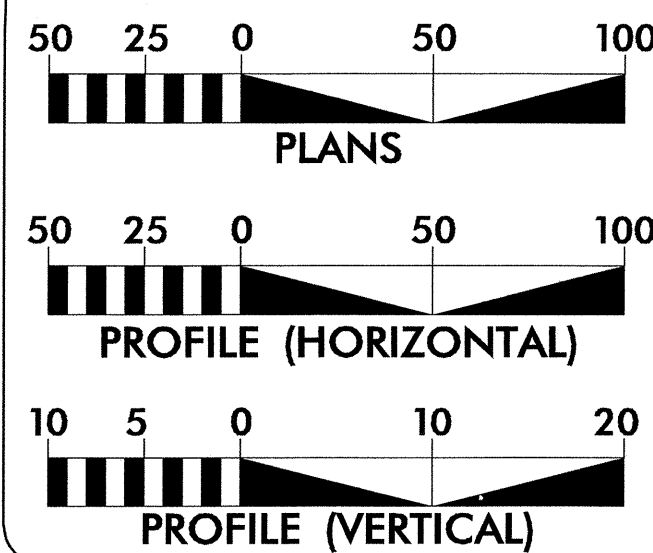

DESIGN DATA

ADT 2003 = 1780 VPD
 ADT 2025 = 2600 VPD
 DHV = 10 %
 D = 60 %
 T = 4 % *
 V = 45 MPH
 * TTST 1% DUAL 3 %

PROJECT LENGTH

LENGTH ROADWAY TIP PROJECT B-3840 = 0.215 mi
 LENGTH STRUCTURE TIP PROJECT B-3840 = 0.006 mi
 TOTAL LENGTH TIP PROJECT B-3840 = 0.221 mi

Prepared in the Office of:
DIVISION OF HIGHWAYS

1000 Birch Ridge Dr., NC, 27610

2002 STANDARD SPECIFICATIONS

RIGHT OF WAY DATE:
SEPTEMBER 30, 2003

LETTING DATE:
OCTOBER 19, 2004

JAMES SPEER, PE
PROJECT ENGINEER

JOHN LANSFORD, PE
PROJECT DESIGN ENGINEER

HYDRAULICS ENGINEER



ROADWAY DESIGN ENGINEER



**DIVISION OF HIGHWAYS
STATE OF NORTH CAROLINA**

STATE DESIGN ENGINEER

**DEPARTMENT OF TRANSPORTATION
FEDERAL HIGHWAY ADMINISTRATION**

APPROVED
DIVISION ADMINISTRATOR

03-AUG-2004 10:49
R:\PROJ\B3840\TIP\dy_tsh.dgn
JBMauney AT RD203033