

5/26/99

PROJECT REFERENCE NO. B-3840	SHEET NO. 5
ROADWAY DESIGN ENGINEER NORTH CAROLINA PROFESSIONAL SEAL 15435 8/3/94 JOHN C. LANSTON	HYDRAULICS ENGINEER NORTH CAROLINA PROFESSIONAL SEAL 18600 RANDALL C. HEBERG

J.C. Lanston
Randall C. Heberg

BM NO. 1
R/R SPIKE SET IN 15" OAK
-BL- STA. 3+98
42 LT
ELEV = 718.90

BM NO. 2
R/R SPIKE SET IN 15" HICKORY
-L- STA. 16+57.49
127.75 LT
ELEV = 686.31

BEGIN RESURFACING
Sta. 10+00.00 -L-

PI = 11+50.00
EL = 710.70'
VC = 190'
K = 76

PI = 16+00.00
EL = 684.50'
VC = 700'
K = 79

CULVERT HYDRAULIC DATA
DESIGN DISCHARGE = 1400 CFS
DESIGN FREQUENCY = 25 YRS
DESIGN HW ELEVATION = 687.6 FT
BASE DISCHARGE = 2000 CFS
BASE FREQUENCY = 50 YRS
BASE HW ELEVATION = 688.1 FT
OVERTOPPING DISCHARGE = 3500 CFS
OVERTOPPING FREQUENCY = 500 YRS
OVERTOPPING ELEVATION = 691.6 FT

PI = 20+30.00
EL = 697.72'
VC = 160'
K = 81

BEGIN GRADE
END RESURFACING
Sta. 10+50.00 -L-
EL = 714.02
(INCL 2.5" RESURFACING)

NOTE: SEE SHEET NO. 4 FOR -L- DESIGN

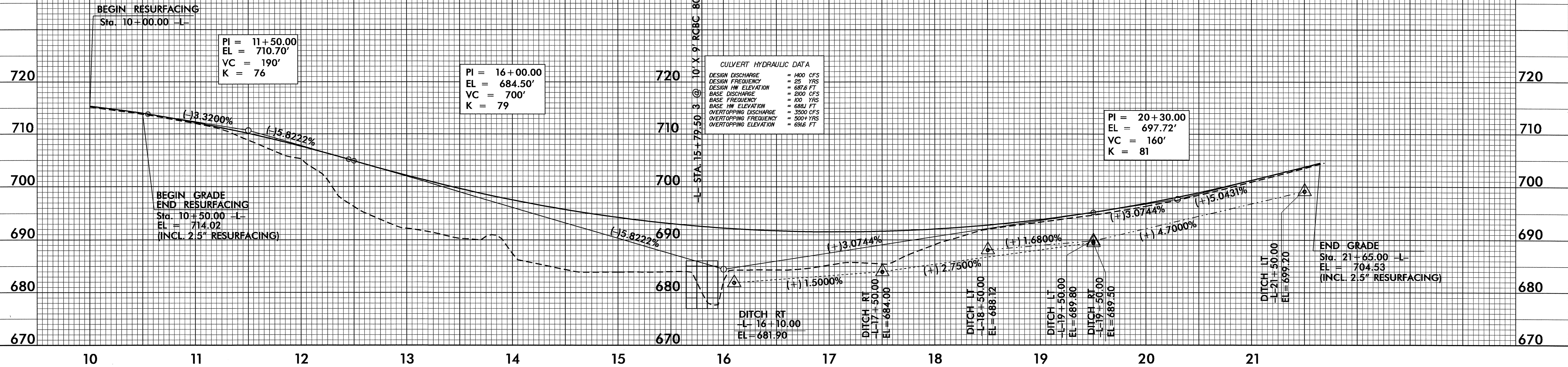

NOTE: SEE SHEET NO. 4 FOR -DRIVE- DESIGN

-DRIVE-

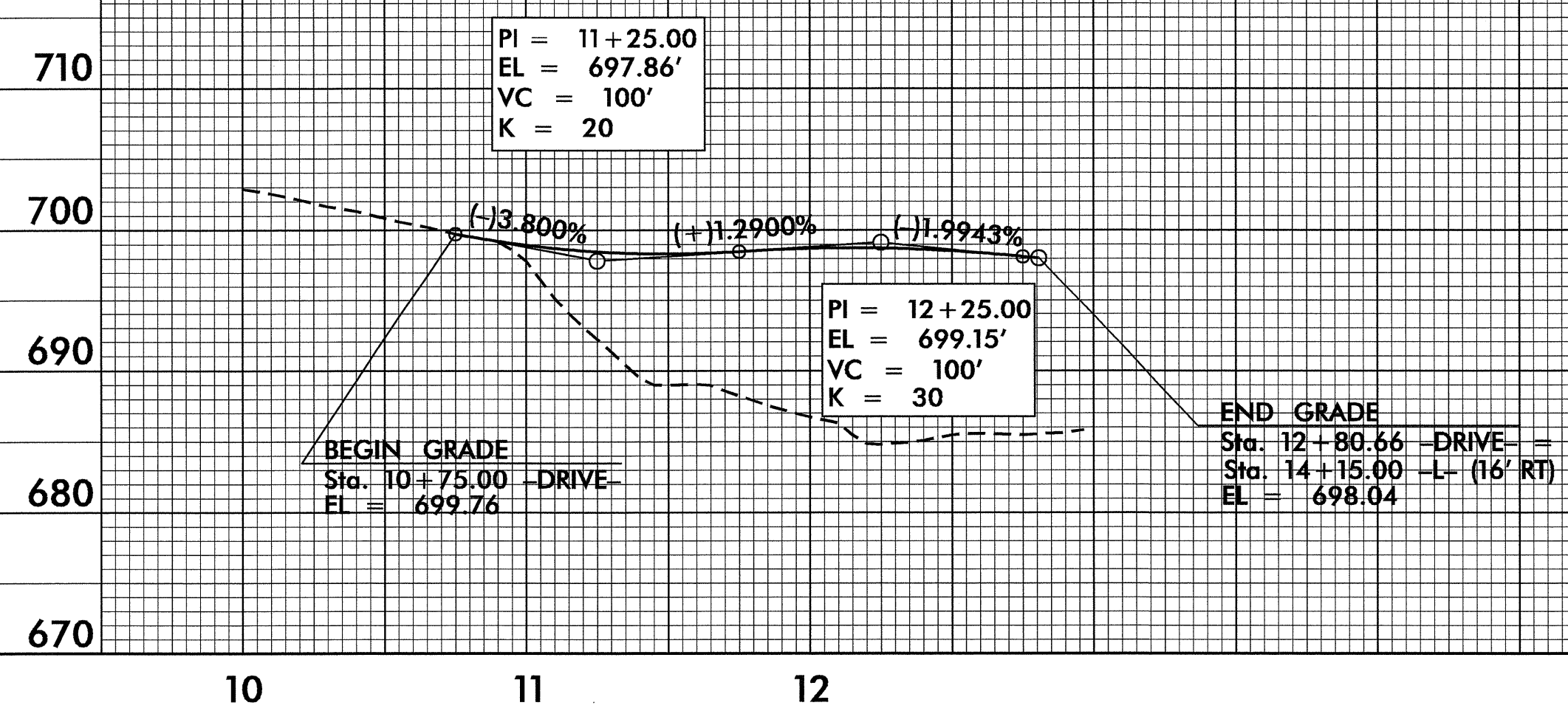

44-JUN-2004 10:26
I:\proj\B3840\rdy_pfl.dgn
juliowilliams