

DETOUR FOR GIRDER PLACEMENT OVER I-40

PROJ. REFERENCE NO.	SHEET NO.
I-2102	TCP-11

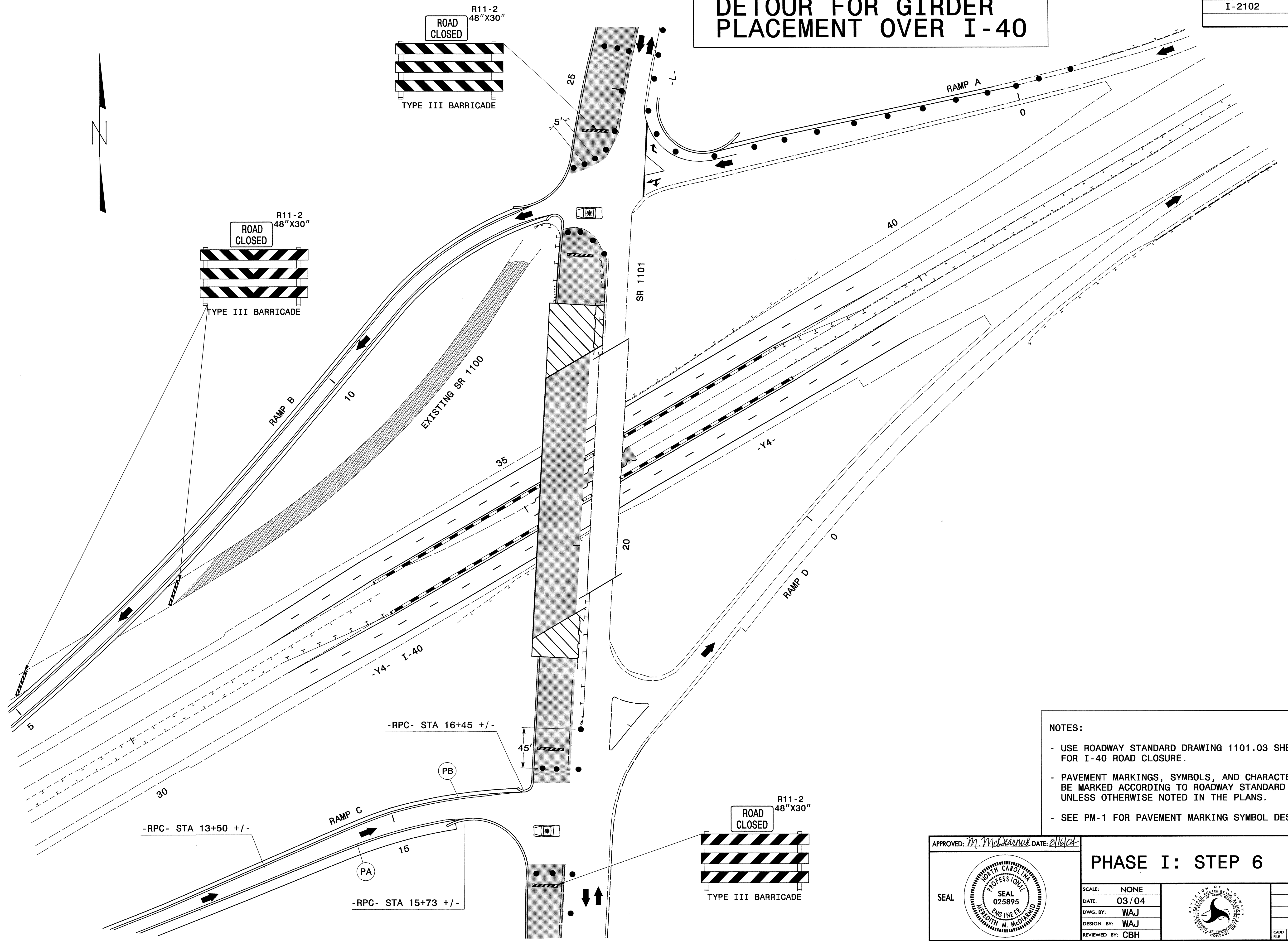

- NOTES:**
- USE ROADWAY STANDARD DRAWING 1101.03 SHEET 7 OF 9 FOR I-40 ROAD CLOSURE.
 - PAVEMENT MARKINGS, SYMBOLS, AND CHARACTERS ARE TO BE MARKED ACCORDING TO ROADWAY STANDARD DRAWINGS UNLESS OTHERWISE NOTED IN THE PLANS.
 - SEE PM-1 FOR PAVEMENT MARKING SYMBOL DESCRIPTION.

APPROVED: *M. McQuinn* DATE: *03/04*

SEAL

PHASE I: STEP 6

SCALE:	NONE		REVISIONS
DATE:	03/04		
DWG. BY:	WAJ		
DESIGN BY:	WAJ		
REVIEWED BY:	CBH		

18-AUG-2004 17:06
 G:\TOP\W\06\12102\12102-TCP11.dgn
 WJDOC AT 11:03:47