

TIP PROJECT: B-3419

CONTRACT: C200826

See Sheet 1-A For Index of Sheets
See Sheet 1-B For Conventional Symbols

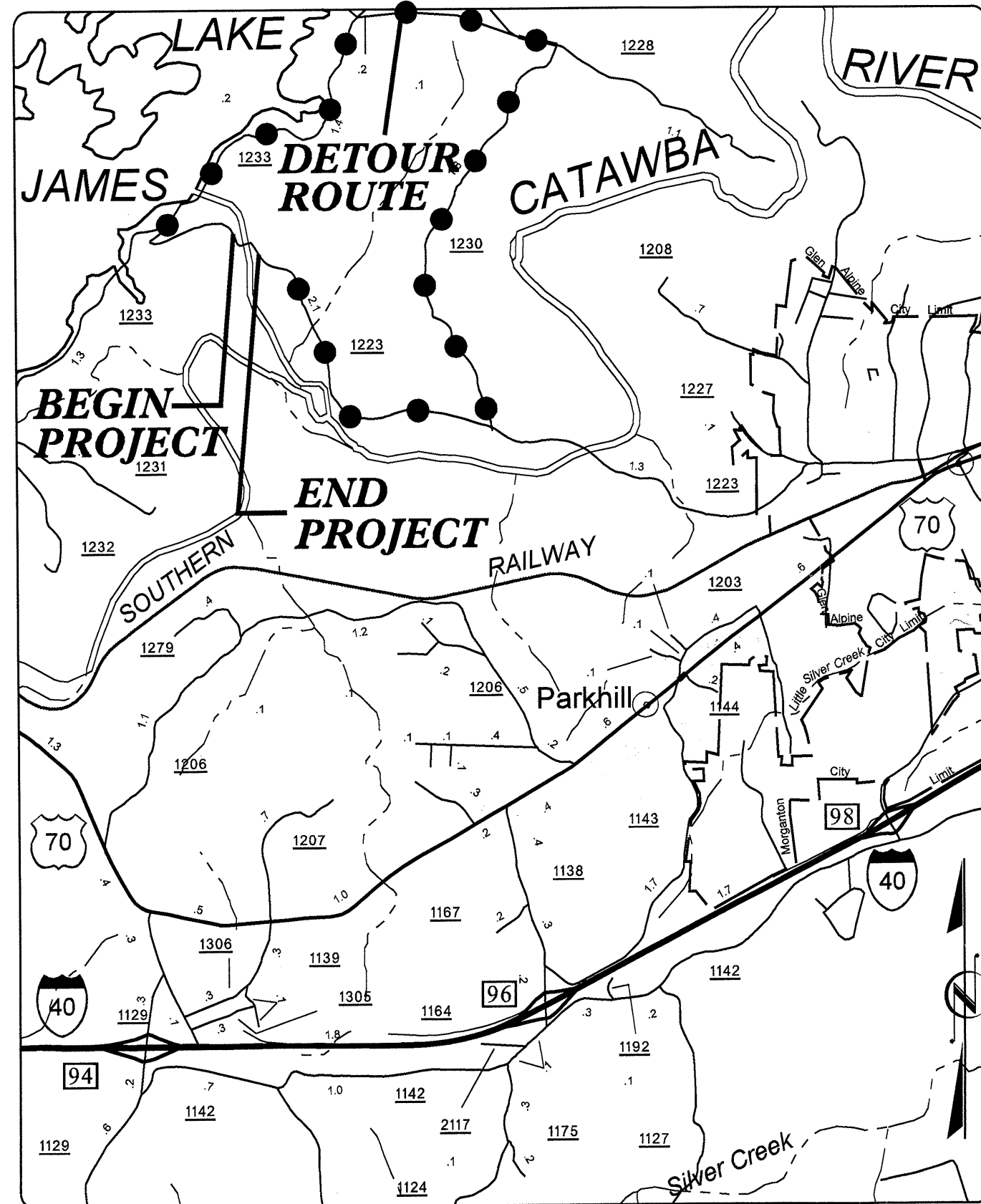

VICINITY MAP OF B-3419

●●●●● DETOUR

STATE OF NORTH CAROLINA
DIVISION OF HIGHWAYS

BURKE COUNTY

LOCATION: BRIDGE NO. 46 ON SR 1223 OVER CATAWBA RIVER

TYPE OF WORK: GRADING, DRAINAGE, PAVING, AND STRUCTURES

STATE	STATE PROJECT REFERENCE NO.	SHEET NO.	TOTAL SHEETS
N.C.	B-3419	1	
STATE PROJ. NO.	F.A. PROJ. NO.	DESCRIPTION	
33046.1.1	BRZ-1223(2)	PE	
33046.2.1	BRZ-1223(2)	R/W, UTIL	
33046.3.2	BRZ-1223(5)	CONSTR.	

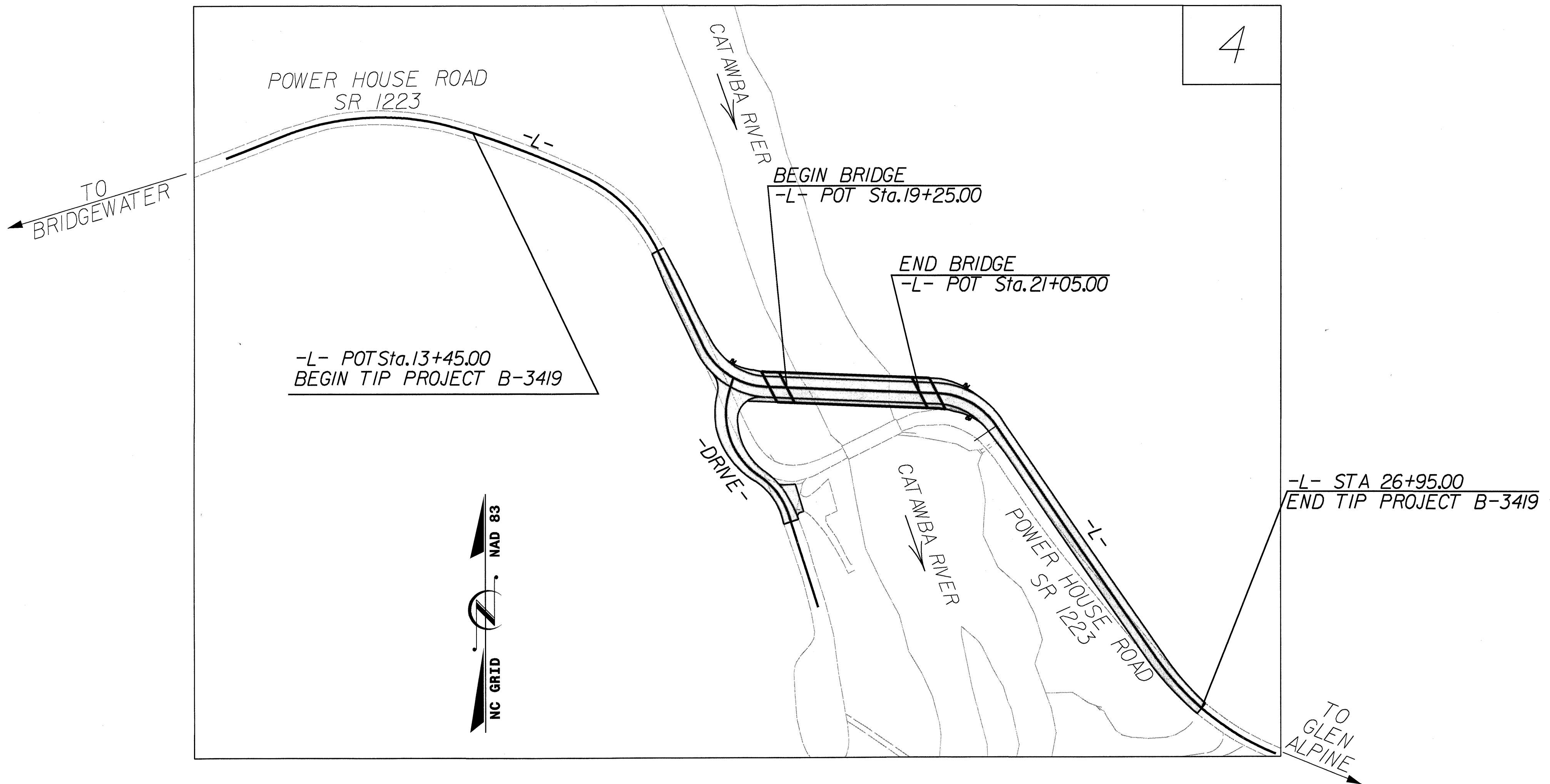

NCDOT CONTACT : CATHY S. HOUSER, P.E.,
PROJECT ENGINEER, DESIGN SERVICES

GRAPHIC SCALES

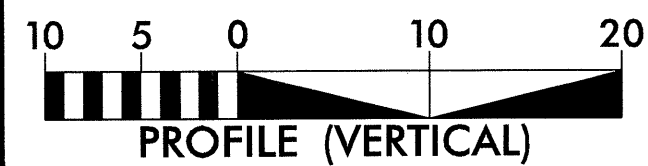
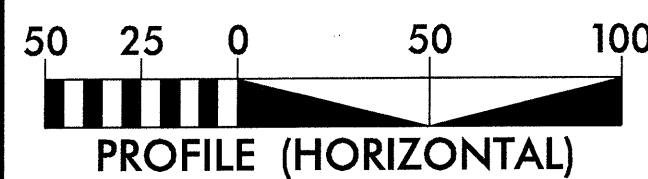
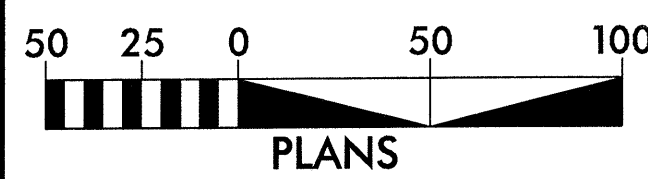

DESIGN DATA

ADT 2004 = 611
ADT 2024 = 981
DHV = 10%
D = 65%
T = 5%

TTST 1% DUAL 4%
V = 60 mph

* DESIGN EXCEPTION FOR HORIZONTAL ALIGNMENT, STOPPING SIGHT DISTANCE, AND SUPERELEVATION IS REQUIRED

PROJECT LENGTH

LENGTH ROADWAY T.J.P. PROJECT B-3419 = 0.222 MILES
LENGTH STRUCTURES T.J.P. PROJECT B-3419 = 0.034 MILES
TOTAL LENGTH OF T.J.P. PROJECT B-3419 = 0.256 MILES

2002 STANDARD SPECIFICATIONS
R/W : MARCH 31, 2003
LETTING : OCTOBER 19, 2004

NEIL J. DEAN, P.E.
EARTH TECH PROJECT MANAGER

Prepared in the Office of:



A tyco INTERNATIONAL LTD. COMPANY

FOR NORTH CAROLINA DEPARTMENT OF TRANSPORTATION
701 Corporate Center Drive
Suite 475
Raleigh, N.C. 27607
(919)-854-6200
FAX (919)-854-6259

HYDRAULICS ENGINEER

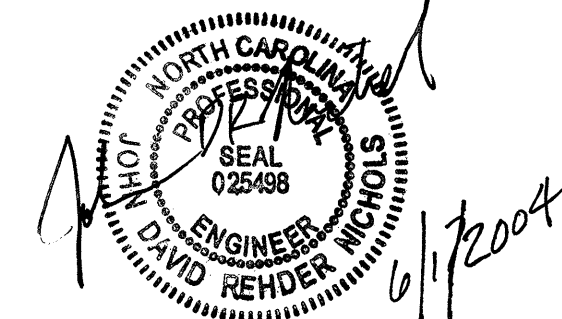

SIGNATURE: JOHN D.R. NICHOLS, P.E.

ROADWAY DESIGN ENGINEER

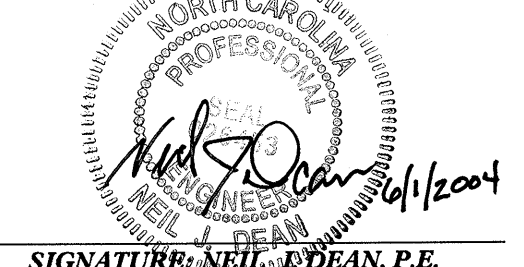

SIGNATURE: NEIL J. DEAN, P.E.

DIVISION OF HIGHWAYS
STATE OF NORTH CAROLINA

STATE DESIGN ENGINEER
DEPARTMENT OF TRANSPORTATION
FEDERAL HIGHWAY ADMINISTRATION

APPROVED DIVISION ADMINISTRATOR DATE