

TIP PROJECT: B-3419

CONTRACT: C200826

STRUCTURE

STATE OF NORTH CAROLINA
DIVISION OF HIGHWAYS

BURKE COUNTY

LOCATION: BRIDGE NO. 46 ON SR 1223 OVER CATAWBA RIVER

TYPE OF WORK: GRADING, DRAINAGE, PAVING, AND STRUCTURE

STATE	STATE PROJECT REFERENCE NO.	SHEET NO.	TOTAL SHEETS
N.C.	B-3419		
STATE PROJ. NO.	F.A. PROJ. NO.	DESCRIPTION	
33046.1.1	BRZ-1223(2)	PE	
33046.2.1	BRZ-1223(2)	RW, UTIL	
33046.3.2	BRZ-1223(5)	CONST	

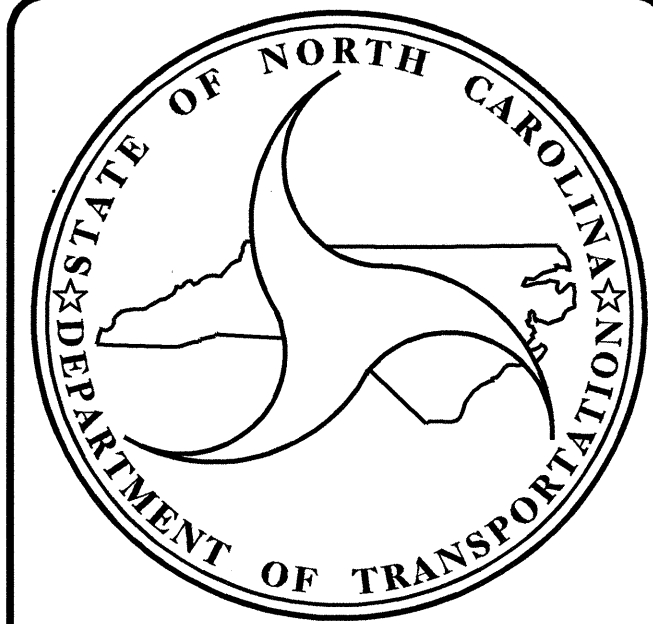
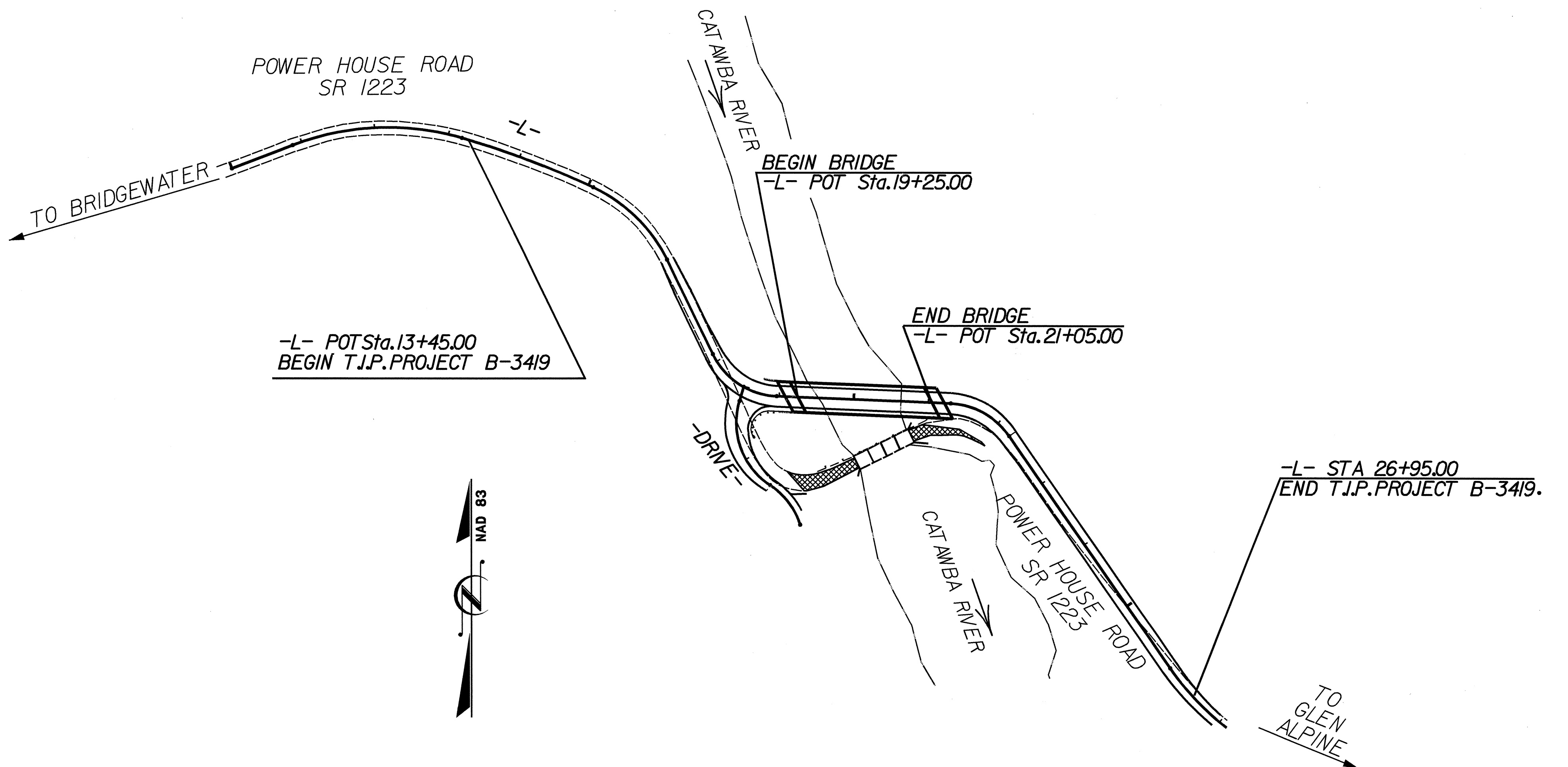
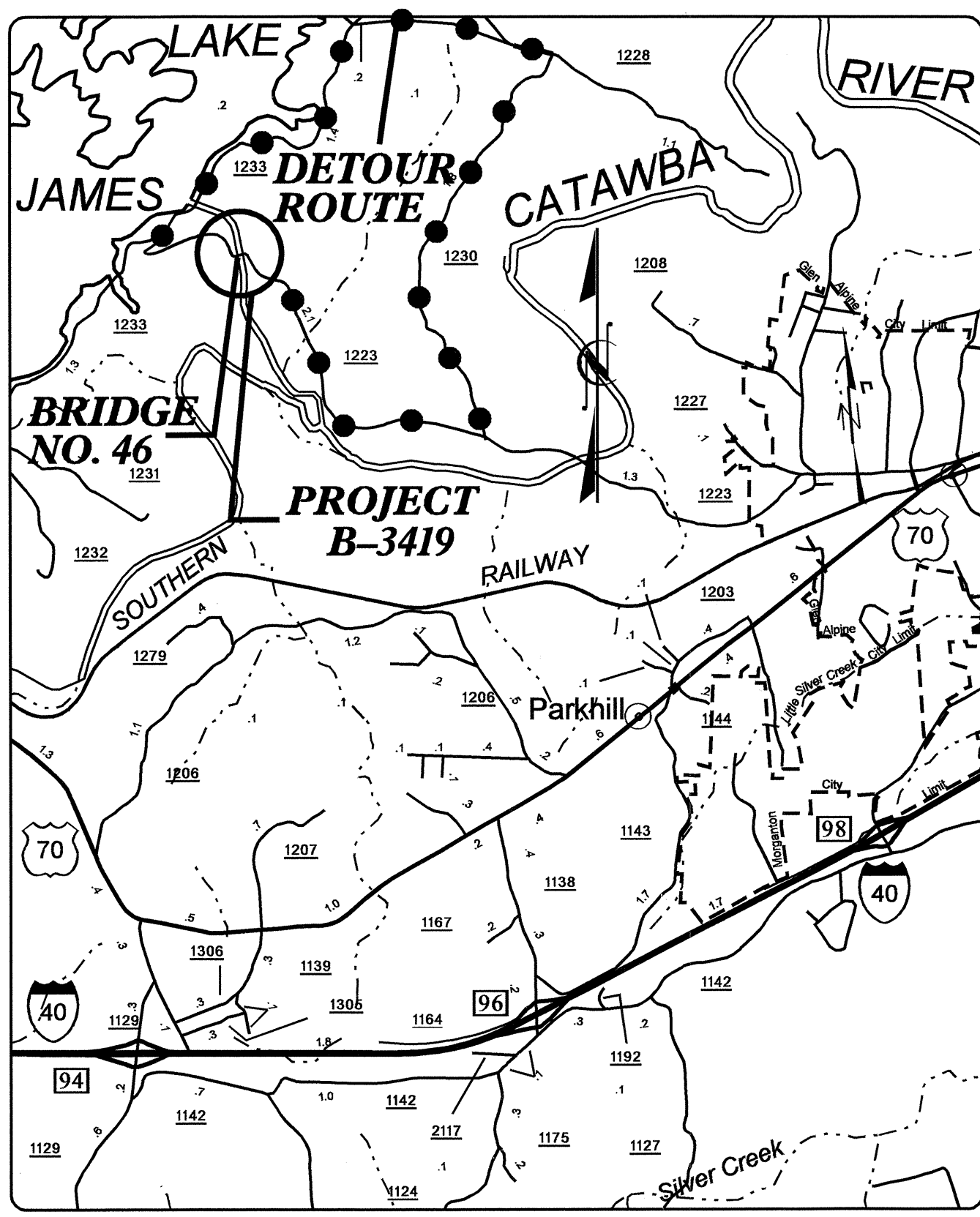

DESIGN DATA
 ADT 2004 = 611
 ADT 2024 = 981
 DHV = 10%
 D = 65%
 T = 5%
 TTST 1% DUAL 4%
 V = 60 mph
 * DESIGN EXCEPTION FOR HORIZONTAL ALIGNMENT, STOPPING SIGHT DISTANCE, AND SUPERELEVATION IS REQUIRED

PROJECT LENGTH

LENGTH ROADWAY T.I.P. PROJECT B-3419 = 0.222 MILES
 LENGTH STRUCTURES T.I.P. PROJECT B-3419 = 0.034 MILES
 TOTAL LENGTH OF T.I.P. PROJECT B-3419 = 0.256 MILES

Prepared In the Office of:
DIVISION OF HIGHWAYS

2002 STANDARD SPECIFICATIONS

**LETTING DATE :
 OCTOBER 19, 2004**

STRUCTURE DESIGN UNIT
 1000 BIRCH RIDGE DR.
 RALEIGH, N.C. 27610

Gregory R. Perfetti
 01/18/04

DIVISION OF HIGHWAYS
 STATE OF NORTH CAROLINA

P.E.
 STATE DESIGN ENGINEER
 DEPARTMENT OF TRANSPORTATION
 FEDERAL HIGHWAY ADMINISTRATION

APPROVED _____ DATE _____
 DIVISION ADMINISTRATOR