



Pre-Construction Notification (PCN) Form

For Nationwide Permits and Regional General Permits
(along with corresponding Water Quality Certifications)

December 4, 2023 Ver 4.3

Please note: fields marked with a red asterisk * below are required. You will not be able to submit the form until all mandatory questions are answered.

Also, if at any point you wish to print a copy of the E-PCN, all you need to do is right-click on the document and you can print a copy of the form.

Below is a link to the online help file.

<https://edocs.deq.nc.gov/WaterResources/DocView.aspx?dbid=0&id=2196924>

A. Processing Information

If this is a courtesy copy, please fill in this with the submission date.

Does this project involve maintenance dredging funded by the Shallow Draft Navigation Channel Dredging and Aquatic Weed Fund, electric generation projects located at an existing or former electric generating facility, or involve the distribution or transmission of energy or fuel, including natural gas, diesel, petroleum, or electricity? *

☐ Yes ☒ No

Is this application for a project associated with emergency response/repairs from Hurricane Helene impacts to your project or property?

☐ Yes ☒ No

Is this project connected with ARPA funding or S.L. 2023-134 (earmark)? *

☐ ARPA ☐ S.L. 2023-134 (earmark) ☒ No

County (or Counties) where the project is located: *

Pamlico

Is this a NCDMS Project? *

☐ Yes ☒ No

Click Yes, only if NCDMS is the applicant or co-applicant.

DO NOT CHECK YES, UNLESS YOU ARE DMS OR CO-APPLICANT.

Is this project a public transportation project? *

☒ Yes ☐ No

This is any publicly funded by municipal, state or federal funds road, rail, airport transportation project.

Is this a NCDOT Project? *

☒ Yes ☐ No

(NCDOT only) T.I.P. or state project number:

BR-0173

WBS # *

67173.1.1

(for NCDOT use only)

1a. Type(s) of approval sought from the Corps: *

- ☐ Section 404 Permit (wetlands, streams and waters, Clean Water Act)
☒ Section 10 Permit (navigable waters, tidal waters, Rivers and Harbors Act)

1b. What type(s) of permit(s) do you wish to seek authorization? *

- ☒ Nationwide Permit (NWP)
☐ Regional General Permit (RGP)
☐ Standard (IP)

1c. Has the NWP or GP number been verified by the Corps? *

☐ Yes ☒ No

Nationwide Permit (NWP) Number:

03 - Maintenance

NWP Numbers (for multiple NWPS):

List all NW numbers you are applying for not on the drop down list.

1d. Type(s) of approval sought from the DWR: *

check all that apply

- ☒ 401 Water Quality Certification - Regular
☐ Non-404 Jurisdictional General Permit
☐ Individual 401 Water Quality Certification

- ☐ 401 Water Quality Certification - Express
☐ Riparian Buffer Authorization

1e. Is this notification solely for the record because written approval is not required?

*

For the record only for DWR 401 Certification:

☐ Yes ☒ No

For the record only for Corps Permit:

☐ Yes ☒ No

1f. Is this an after-the-fact permit application? *

☐ Yes ☒ No

1g. Is payment into a mitigation bank or in-lieu fee program proposed for mitigation of impacts?

If so, attach the acceptance letter from mitigation bank or in-lieu fee program.

☐ Yes ☒ No

Acceptance Letter Attachment

Click the upload button or drag and drop files here to attach document

FILE TYPE MUST BE PDF

1h. Is the project located in any of NC's twenty coastal counties? *

☒ Yes ☐ No

1i. Is the project located within a NC DCM Area of Environmental Concern (AEC)? *

☒ Yes ☐ No ☐ Unknown

1j. Is the project located in a designated trout watershed? *

☐ Yes ☒ No

Link to trout information: <http://www.saw.usace.army.mil/Missions/Regulatory-Permit-Program/Agency-Coordination/Trout.aspx>

B. Applicant Information



1a. Who is the Primary Contact? *

Nancy Oberle

1b. Primary Contact Email: *

nancy.oberle@threeoaksengineering.com

1c. Primary Contact Phone: *

(xxx)xxx-xxxx

(919)732-1300

1d. Who is applying for the permit? *

☒ Owner
(Check all that apply)

☐ Applicant (other than owner)

1e. Is there an Agent/Consultant for this project? *

☒ Yes ☐ No

2. Owner Information

2a. Name(s) on recorded deed: *

North Carolina Department of Transportation Ferry Division

2b. Deed book and page no.:

2c. Contact Person:

(for Corporations)

Brian Doliber

2d. Address *

Street Address

159 Lucinda Lane

Address Line 2

City

Powells Point

Postal / Zip Code

27966

State / Province / Region

NC

Country

USA

2e. Telephone Number: *

(xxx)xxx-xxxx

(252)621-6251

2f. Fax Number:

(xxx)xxx-xxxx

2g. Email Address: *

bcdoliber@ncdot.gov

4. Agent/Consultant (if applicable)

4a. Name: *

Nancy Oberle

4b. Business Name:

(if applicable)

Three Oaks Engineering

4c. Address *

Street Address

324 Blackwell Street, Suite 1200

Address Line 2

City

Durham

Postal / Zip Code

27701

State / Province / Region

NC

Country

USA

4d. Telephone Number: *

(919)732-1300

(xxx)xxx-xxxx

4e. Fax Number:

(xxx)xxx-xxxx

4f. Email Address: *

nancy.oberle@threeoaksengineering.com

C. Project Information and Prior Project History

1. Project Information

1a. Name of project: *

BR-0173 Replacement of Minnesott Beach East Ferry Ramp on Neuse River

1b. Subdivision name:

(if appropriate)

1c. Nearest municipality / town: *

Arapahoe

2. Project Identification

2a. Property Identification Number:

(tax PIN or parcel ID)

6455703463000, 6455702459000

2b. Property size:

(in acres)

3.5

2c. Project Address

Street Address

12254 NC 306

Address Line 2

City

Arapahoe

Postal / Zip Code

28510

State / Province / Region

NC

Country

USA

2d. Site coordinates in decimal degrees

Please collect site coordinates in decimal degrees. Use between 4-6 digits (unless you are using a survey-grade GPS device) after the decimal place as appropriate, based on how the location was determined. (For example, most mobile phones with GPS provide locational precision in decimal degrees to map coordinates to 5 or 6 digits after the decimal place.)

Latitude: *

34.967494

ex: 34.208504

Longitude: *

-76.806244

-77.796371

3. Surface Waters

3a. Name of the nearest body of water to proposed project: *

Neuse River

3b. Water Resources Classification of nearest receiving water: *

SB;Sw;NSW

[Surface Water Lookup](#)

3c. What river basin(s) is your project located in? *

Neuse

3d. Please provide the 12-digit HUC in which the project is located. *

030202040503

[River Basin Lookup](#)

4. Project Description and History

4a. Describe the existing conditions on the site and the general land use in the vicinity of the project at the time of this application: *

The North Carolina Department of Transportation (NCDOT) Project BR-0173 proposes to replace Structure No. 78, the Minnesott Beach east ferry ramp on NC 306 on the Neuse River in Pamlico County. There is an existing ferry terminal and parking lot on the property. Land use in the vicinity of the project area consists of residential, commercial, agricultural, and forested.

4b. Have Corps permits or DWR certifications been obtained for this project (including all prior phases) in the past? *

☒ Yes ☐ No ☐ Unknown

If yes, please give the DWR Certification number or the Corps Action ID (exp. SAW-0000-00000).

4f. List the total estimated acreage of all existing wetlands on the property:

0

4g. List the total estimated linear feet of all existing streams on the property:

(intermittent and perennial)

509

4h. Explain the purpose of the proposed project: *

The purpose of the proposed project is to replace a structurally deficient ferry ramp structure. The existing structure was built in 1996. NCDOT Bridge Management Unit records indicate that Structure No. 78 is considered structurally deficient due to deck, superstructure, and substructure condition appraisals of 4 out of 9, according to the latest inspection performed in accordance with National Bridge Inspection Standards (NBIS).

4i. Describe the overall project in detail, including indirect impacts and the type of equipment to be used: *

The east ferry ramp will be replaced in-place with traffic maintained on the west ferry ramp during construction. Based on a preliminary concept design, the east ferry ramp will be replaced in kind with a 17-foot deck width and will be ADA-compliant.

The replacement ramp will be constructed to provide vertical clearance to gantries.

A notable reduction in ferry service is not anticipated during project construction. No additional right of way or easements will be required since all construction activities will be within the existing right of way of the Minnesott Beach ferry terminal and NC 306. The existing parking lot located east of the ferry terminal queuing lanes, along with a section of the queuing area, will be utilized as a construction staging area.

The project is currently federally funded, and the Federal Highway Administration (FHWA) is the lead federal agency.

Improvements to the facility include:

- Alterations to facilities or vehicles in order to make them accessible for elderly and handicapped persons.

- Rehabilitation or reconstruction of existing ferry facilities that occupy substantially the same geographic footprint, do not result in a change in their functional use, and do not result in a substantial increase in the existing facility's capacity. Example actions include work on pedestrian and vehicle transfer structures and associated utilities, buildings and terminals.

Indirect impacts are not anticipated, as this project replaces an existing ferry ramp.

Typical construction equipment, such as cranes, dump trucks, and dozers, will be used during construction.

1. Contractor shall install a temporary turbidity curtain, which will capture any sediment that results from the driving of the replacement steel piles.

2. It is possible that a small portable cofferdam system will be needed within the turbidity curtain protected area to apply coatings a foot or two below water to the sheet piling on the bulkhead.

3. Limit of disturbance shall be inside of the existing parcel/right of way

5. Jurisdictional Determinations

5a. Have the wetlands or streams been delineated on the property or proposed impact areas? *

☒ Yes ☐ No ☐ Unknown

Comments:

5b. If the Corps made a jurisdictional determination, what type of determination was made? *

☐ Preliminary ☐ Approved ☒ Not Verified ☐ Unknown ☐ N/A

Corps AID Number:

Example: SAW-2017-99999

5c. If 5a is yes, who delineated the jurisdictional areas?

Name (if known): Adam Efird, PWS

Agency/Consultant Company: Three Oaks Engineering

Other:

6. Future Project Plans

6a. Is this a phased project? *

☐ Yes ☒ No

Are any other NWP(s), regional general permit(s), or individual permits(s) used, or intended to be used, to authorize any part of the proposed project or related activity? This includes other separate and distant crossing for linear projects that require Department of the Army authorization but don't require pre-construction notification.

D. Proposed Impacts Inventory

1. Impacts Summary

1a. Where are the impacts associated with your project? (check all that apply):

- ☐ Wetlands ☐ Streams-tributaries ☐ Buffers
☒ Open Waters ☐ Pond Construction

4. Open Water Impacts

If there are proposed impacts to lakes, ponds, estuaries, tributaries, sounds, the Atlantic Ocean, or any other open water of the U.S. then individually list all open water impacts below.

4a. Site # [*] (?)	4a1. Impact Reason	4b. Impact type [*] (?)	4c. Name of waterbody (?)	4d. Activity type [*]	4e. Waterbody type [*]	4f. Impact area [*]
1	Turbidity Curtain and/or temporary cofferdam	T	Neuse River	Dewatering	Sound	0.26 (acres)
1	Proposed Lift Bent and Piles	P	Neuse River	Fill	Sound	0.03 (acres)

4g. Total temporary open water impacts:

0.26

4g. Total permanent open water impacts:

0.03

4g. Total open water impacts:

0.29

4h. Comments:

It is possible that a small portable cofferdam system will be needed within the turbidity curtain protected area to apply coatings a foot or two below water to the sheet piling on the bulkhead. That is why the temporary impacts are listed as turbidity curtain and/or temporary cofferdam.

E. Impact Justification and Mitigation

1. Avoidance and Minimization

1a. Specifically describe measures taken to avoid or minimize the proposed impacts in designing the project: ^{*}

The proposed ferry ramp will replace the existing ferry ramp in the same location. The existing parking lot to the east of the ferry terminal queuing lanes, and a section of the queuing area, will be utilized as a construction staging area. There will be no impacts to any riparian buffer, since any landward work will be limited to areas of existing pavement.

1b. Specifically describe measures taken to avoid or minimize the proposed impacts through construction techniques: ^{*}

Erosion and sedimentation BMPs will be installed prior to construction. Impacts will be minimized by strict enforcement of Best Management Practices for the protection of surface waters, restrictions against the staging of equipment in or adjacent to waters of the US, and coordination with appropriate environmental staff.

2. Compensatory Mitigation for Impacts to Waters of the U.S. or Waters of the State

2a. Does the project require Compensatory Mitigation for impacts to Waters of the U.S. or Waters of the State?

- ☐ Yes ☒ No

2b. If this project DOES NOT require Compensatory Mitigation, explain why:

The ferry ramp replacement has been designed to avoid as many impacts as possible, however, the ramp cannot be replaced without some impacts. These impacts have been minimized to the greatest extent practical (295 linear feet of temporary stream impacts and 56 linear feet of permanent impact that do not require mitigation).

NC Stream Temperature Classification Maps can be found under the Mitigation Concepts tab on the Wilmington District's [RIBITS](#) website.

F. Stormwater Management and Diffuse Flow Plan (required by DWR)

*** Recent changes to the stormwater rules have required updates to this section .***

1. Diffuse Flow Plan

1a. Does the project include or is it adjacent to protected riparian buffers identified within one of the NC Riparian Buffer Protection Rules?

- ☒ Yes ☐ No

1b. All buffer impacts and high ground impacts require diffuse flow or other form of stormwater treatment. If the project is subject to a state implemented riparian buffer protection program, include a plan that fully documents how diffuse flow will be maintained.

All Stormwater Control Measures (SCM)s must be designed in accordance with the [NC Stormwater Design Manual](#). Associated supplement forms and other documentation shall be provided.

What type of SCM are you providing?

- ☐ Level Spreader
- ☐ Vegetated Conveyance (lower SHWT)
- ☐ Wetland Swale (higher SHWT)
- ☐ Other SCM that removes minimum 30% nitrogen
- ☒ Proposed project will not create concentrated stormwater flow through the buffer
- (check all that apply)

For a list of options to meet the diffuse flow requirements, click [here](#).

2. Stormwater Management Plan

2a. Is this a NCDOT project subject to compliance with NCDOT's Individual NPDES permit NCS000250? *

☒ Yes ☐ No

Comments:

See attached Stormwater Management Plan (part of the Permit Package drawings)

G. Supplementary Information



1. Environmental Documentation

1a. Does the project involve an expenditure of public (federal/state/local) funds or the use of public (federal/state) land? *

☒ Yes ☐ No

1b. If you answered "yes" to the above, does the project require preparation of an environmental document pursuant to the requirements of the National or State (North Carolina) Environmental Policy Act (NEPA/SEPA)? *

☒ Yes ☐ No

1c. If you answered "yes" to the above, has the document review been finalized by the State Clearing House? (If so, attach a copy of the NEPA or SEPA final approval letter.) *

☒ Yes ☐ No

2. Violations (DWR Requirement)

2a. Is the site in violation of DWR Water Quality Certification Rules (15A NCAC 2H .0500), Isolated Wetland Rules (15A NCAC 2H .1300), or DWR Surface Water or Wetland Standards or Riparian Buffer Rules (15A NCAC 2B .0200)? *

☐ Yes ☒ No

3. Cumulative Impacts (DWR Requirement)

3a. Will this project (based on past and reasonably anticipated future impacts) result in additional development, which could impact nearby downstream water quality? *

☐ Yes ☒ No

3b. If you answered "no," provide a short narrative description.

The project will be replacement an existing ramp, which will not contribute to any further development or provide any new access to previously inaccessible land parcels.

4. Sewage Disposal (DWR Requirement)

4a. Is sewage disposal required by DWR for this project? *

☐ Yes ☒ No ☐ N/A

5. Endangered Species and Designated Critical Habitat (Corps Requirement)

5a. Will this project occur in or near an area with federally protected species or habitat? *

☒ Yes ☐ No

5b. Have you checked with the USFWS concerning Endangered Species Act impacts? *

☒ Yes ☐ No

5c. If yes, indicate the USFWS Field Office you have contacted.

Raleigh

5d. Is another Federal agency involved? *

☒ Yes ☐ No ☐ Unknown

What Federal Agency is involved?

Federal Highway Administration

5e. Is this a DOT project located within Division's 1-8? *

☒ Yes ☐ No

5j. What data sources did you use to determine whether your site would impact Endangered Species or Designated Critical Habitat? *

IPaC. Please see attached Categorical Exclusion for details.

Atlantic Sturgeon, Shortnose Sturgeon, West Indian Manatee - May Affect, Not Likely to Adversely Affect

Northern Long-eared Bat, Tricolored Bat - May Affect, Likely to Adversely Affect - covered under Programmatic Biological Opinion

Eastern Black Rail, Red-cockaded Woodpecker, Rufa Red Knot, Green Sea Turtle, Kemp's Ridley Sea Turtle, Leatherback Sea Turtle, Rough-leaved Loosestrife, Bald Eagle - No Effect

American Alligator - Not Required

6. Essential Fish Habitat (Corps Requirement)

6a. Will this project occur in or near an area designated as an Essential Fish Habitat? *

☒ Yes ☐ No

Are there submerged aquatic vegetation (SAV) around the project vicinity? *

☐ Yes ☒ No ☐ Unknown

6b. What data sources did you use to determine whether your site would impact an Essential Fish Habitat? *

Essential Fish Habitat Mapper. Due to the presence of numerous areas designated as Primary Nursery Areas (PNA) and Secondary Nursery Areas (SNA) near the project location (but not within the project study area), NC Division of Marine Fisheries (NCDMF) initially recommended an in-water construction moratorium from April 1 through September 30 to minimize the potential impacts to species that utilize designated PNAs and SNAs. However, after additional coordination with NMFS and NCDMF, both agencies agreed that a moratorium is not required.

7. Historic or Prehistoric Cultural Resources (Corps Requirement)

Link to the State Historic Preservation Office Historic Properties Map (does not include archaeological data: <http://gis.ncdcr.gov/hpweb/>)

7a. Will this project occur in or near an area that the state, federal or tribal governments have designated as having historic or cultural preservation status (e.g., National Historic Trust designation or properties significant in North Carolina history and archaeology)? *

☐ Yes ☒ No

7b. What data sources did you use to determine whether your site would impact historic or archeological resources? *

SHPO coordination. Please see attached Categorical Exclusion

8. Flood Zone Designation (Corps Requirement)

Link to the FEMA Floodplain Maps: <https://msc.fema.gov/portal/search>

8a. Will this project occur in a FEMA-designated 100-year floodplain? *

☒ Yes ☐ No

8b. If yes, explain how project meets FEMA requirements:

This project involves construction activities on or adjacent to Federal Emergency Management Agency (FEMA)-regulated stream(s). Therefore, the Division shall submit sealed as-built construction plans to the Hydraulics Unit upon completion of project construction, certifying that the drainage structure(s) and roadway embankment that are located within the 100-year floodplain were built as shown in the construction plans, both horizontally and vertically.

8c. What source(s) did you use to make the floodplain determination? *

FEMA Flood Map Service Center

Miscellaneous

Comments

Please use the space below to attach all required documentation or any additional information you feel is helpful for application review. Documents should be combined into one file when possible, with a Cover Letter, Table of Contents, and a Cover Sheet for each Section preferred.

Click the upload button or drag and drop files here to attach document

BR-0173_Buffer Permit Package_20250428.pdf	717.62KB
BR-0173_CE_Type_IA_signed.pdf	5.77MB
BR-0173_Permit Package_20250429 (1).pdf	1.63MB
BR0173_PGD_04-23-2025.pdf	369.8KB

File must be PDF or KMZ

Signature

*

☒ By checking the box and signing below, I certify that:

- The project proponent hereby certifies that all information contained herein is true, accurate, and complete to the best of my knowledge and belief; and
- The project proponent hereby requests that the certifying authority review and take action on this CWA 401 certification request within the applicable reasonable period of time.
- I have given true, accurate, and complete information on this form;
- I agree that submission of this PCN form is a "transaction" subject to Chapter 66, Article 40 of the NC General Statutes (the "Uniform Electronic Transactions Act");
- I agree to conduct this transaction by electronic means pursuant to Chapter 66, Article 40 of the NC General Statutes (the "Uniform Electronic Transactions Act");
- I understand that an electronic signature has the same legal effect and can be enforced in the same way as a written signature; AND
- I intend to electronically sign and submit the PCN form.

Full Name: *

Brian Doliber

Signature *

Brian Doliber

Date

5/8/2025

Permit Application Report

Application ID	Application Type	Submitted	App Complete	Deadline	Decision	Expiration
PA-2061	DCM Major Permit	Click or tap here to enter text.	Click or tap here to enter text.	Click or tap here to enter text.		

Primary Applicant Information							
Applicant Type	Title	Business Name	Name	Email	Business Phone	Mobile Phone	
State Government	Click or tap here to enter text.	NCDOT Ferry	Brian Doliber	bcdoliber@ncdot.gov	252-621-6251	252-232-8025	
Physical Address				Mailing Address			
Street 1	City	State	Zip	Street 1	City	State	Zip
159 Lucinda Lane	Powells Point	North Carolina	27966	159 Lucinda Lane	Powells Point	North Carolina	27966

Registered Agent Information								
Agent Type	Title	Business Name	Name	Email		Business Phone	Mobile Phone	
Business/Company		Three Oaks Engineering	Three Oaks Engineering	nancy.oberle@threeoaksengineering.com		919-900-6535		
Physical Address				Mailing Address				
Street 1	City	State	Zip	Street 1		City	State	Zip
324 Blackwell Street	Durham	North Carolina	27701	324 Blackwell Street		Durham	North Carolina	27701

Project Information						
Project Name		Project Type		Disturbed Land Area (Sq Ft/Acres)		
BR-0173 Minnesott Beach East Ferry Replacement on NC 306 on Neuse River		Public/Government		436 Sq. Ft. / 0.01 Acres		
Is proposed project located in national registered historic district or national register listed/eligible: False						
List of previous state or federal permits for work on project tract: CAMA Permit No. 138 (dredging) and CAMA Permit No. 67-95 (ferry ramp construction)						
Project Location Information						
Address	County	River Basin	Subdivision	County Parcel ID	Latitude	Longitude
12254 NC 306, Arapahoe, NC 28510	Pamlico	Neuse			34.967494	-76.806244
Project Discharges to State Waters						
Discharge Type	Surface Runoff	Sanitary Wastewater	Industry/Commercial Effluent	Vessel Wash Down	Residential	Other
Wastewater/Stormwater Discharged Into Wetland?		Discharge Same Salinity as Receiving Waters			Is There Any Mitigation Proposed	
False		False			False	

Size of tract – 152460 sq ft (3.5 acres)

Vegetation on Tract: Grass, Tree/shrubs, ornamental, scrub

Existing drinking water source: public system

Proposed drinking water source: public system

Shoreline length: 450 feet

Parcel #: 6455703463000, 6455702459000

Detailed Description of the Existing Development Located on the Property

Existing Man-Made Features:

Existing Ferry Terminal

Existing Land Uses:

Sound, beach, summer camp areas, residential, forested, and recreational.

Existing Wastewater Treatment/Disposal:

n/a

Solid Waste/Fish Offal/Trash Disposal:

n/a

Use and Daily Operations of the Project When Complete**Proposed Development Purpose:**

The proposed project will replace a structurally deficient ferry ramp structure. The existing structure was built in 1996. NCDOT Bridge Maintenance Unit records indicate that Structure No. 78 is considered structurally deficient due to deck, superstructure, and substructure condition appraisals of 4 out of 9, according to the latest inspection performed in accordance with National Bridge Inspection Standards (NBIS).

Buildings/Facilities/Units/Structures:

The old east ferry ramp will be replaced with a new ferry ramp.

Use & Daily Operations:

The use & daily operations for this project will remain the same as existing.

Construction Methodology & Equipment:

Methodology: Contractor shall install temporary turbidity curtain. Limit of disturbance shall be inside of the existing right of way.

Standard construction equipment will be used, such as cranes, dump trucks, skid steers, excavators, and dozers.

Development Activities Narrative Specifics:

No additional development will result from this project, as the proposed project will replace an existing ferry ramp.

Application Narrative:

The North Carolina Department of Transportation (NCDOT) Project BR-0173 proposes to replace Structure No. 78, the Minnesott Beach east ferry ramp on NC 306 on the Neuse River in Pamlico County. There is an existing ferry terminal and parking lot on the property. Land use in the vicinity of the project area consists of residential, commercial, agricultural, and forested. The project is located near the Town of Arapahoe, on the Neuse River in Pamlico County.

The east ferry ramp will be replaced in-place with traffic maintained on the west ferry ramp during construction. Based on a preliminary concept design, the east ferry ramp will be replaced in kind with a 17-foot deck width and will be ADA-compliant.

The replacement ramp will be constructed to provide vertical clearance to gantries.

A notable reduction in ferry service is not anticipated during project construction. No additional right of way or easements will be required since all construction activities will be within the existing right of way of the Minnesott Beach ferry terminal and NC 306. The existing parking lot located east of the ferry terminal queuing lanes, along with a section of the queuing area, will be utilized as a construction staging area.

The project is currently federally funded, and the Federal Highway Administration (FHWA) is the lead federal agency.

Improvements to the facility include:

- Alterations to facilities or vehicles in order to make them accessible for elderly and handicapped persons.
- Rehabilitation or reconstruction of existing ferry facilities that occupy substantially the same geographic footprint, do not result in a change in their functional use, and do not result in a substantial increase in the existing facility's capacity. Example actions include work on pedestrian and vehicle transfer structures and associated utilities, buildings and terminals.

Indirect impacts are not anticipated, as this project replaces an existing ferry ramp.

Typical construction equipment, such as cranes, dump trucks, skid steers, excavators and dozers, will be used during construction.

1. Contractor shall install a temporary turbidity curtain, which will capture any sediment that results from the driving of the replacement steel piles.
2. It is possible that a small portable cofferdam system will be needed within the turbidity curtain protected area to apply coatings a foot or two below water to the sheet piling on the bulkhead.
3. Limit of disturbance shall be inside of the existing parcel/right of way

Boat Ramp Development Activity Included: False

Shoreline Stabilization Development Activity Included: False

Living Shoreline Development Activity Included: False

Piers & Docking Facilities Development Activity Included: False

Excavation Development Activity Included: False

Bridges & Culverts Development Activity Included: False

Oceanfront Erosion Control Development Activity Included: False

Temporary Structures Development Activity Included: False

Utility Crossings Development Activity Included: False

Freestanding Moorings, Buoys & Bird Nesting Poles Development Activity Included: False

Log Removal/Marine Debris Development Activity Included: No

Navigational Aids Development Activity Included: False

Other Fill Below Water Level Development Activity Included: True

Fill in Open Water: 1307 sq ft

Purpose: To replace bents of existing east ferry ramp

How will fill material be kept onsite and erosion controlled? The existing parking lot located east of the ferry terminal queuing lanes, along with a section of the queuing area, will be utilized as a construction staging area. A turbidity curtain will be installed prior to any in-water work. Impacts will be minimized by strict enforcement of Best Management Practices for the protection of surface waters, restrictions against the staging of equipment in or adjacent to waters of the US, and coordination with appropriate environmental staff.

Fill Details: Length: 23 ft, Width: 56 ft

Purpose: To replace bents of existing east ferry ramp

Fill material: Steel

Stormwater Structures Development Activity Included: False

“Upland Development” Development Activity Included: False

Energy Facilities Development Activity Included: False

Aquaculture Development Activity Included: False

Submerged Lands Mining Development Activity Included: False

General Development Activity Details Required

Marina Development Activity Details Required



North Carolina Department of Transportation

Highway Stormwater Program
STORMWATER MANAGEMENT PLAN

FOR NCDOT PROJECTS



(Version 3.02; Released April 23, 2024)

WBS Element: 67173.1.1 TIP/Proj No: BR-0173 County(ies): Pamlico Page 1 of 2

General Project Information

WBS Element:	67173.1.1	TIP Number:	BR-0173	Project Type:	Other	Date:	4/28/2025
NCDOT Contact:	Alexander J. Foster, PE			Contractor / Designer:	Joshua G. Dalton, PE		
	Address:	Project Management Team - Divisions 1, 2, 3, 4, and 6 1000 Birch Ridge Dr Raleigh, NC 27610			Address:	Sungate Design Group, PA 905 Jones Franklin Rd Raleigh, NC 27606	
	Phone:	919-707-6239			Phone:	919-710-8333	
	Email:	ajfoster@ncdot.gov			Email:	jdalton@sungatedesign.com	
City/Town:	Minnesott Beach			County(ies):	Pamlico		
River Basin(s):	Neuse			CAMA County?	Yes		
Wetlands within Project Limits?	No						

Project Description

Project Length (lin. miles or feet):	N/A	Surrounding Land Use:	Sound, beach, summer camp areas, residential, forest, and recreational.					
	Proposed Project		Existing Site					
Project Built-Upon Area (ac.)	1.09	ac.	1.08	ac.				
Typical Cross Section Description:	N/A		N/A					
Annual Avg Daily Traffic (veh/hr/day):	Design/Future:	2600	Year:	2040	Existing:	1300	Year:	2018

General Project Narrative:
(Description of Minimization of Water
Quality Impacts)

The North Carolina Department of Transportation - Project Management Unit has proposed to replace and/or improve the east ferry ramp on NC 306 at the north (Minnesott Beach) side of the Minnesott Beach-Cherry Branch Ferry Route in Pamlico County, NC. The proposed structure will be designed to have as little environmental and surface water impacts as possible.



North Carolina Department of Transportation

Highway Stormwater Program
STORMWATER MANAGEMENT PLAN
FOR NCDOT PROJECTS

(Version 3.02; Released April 23, 2024)

WBS Element: 67173.1.1

TIP/Proj No.: BR-0173

County(ies): Pamlico

Page 2 of 2

General Project Information

Waterbody Information

Surface Water Body (1):	Neuse River		NCDWR Stream Index No.:	27-(104)	
NCDWR Surface Water Classification for Water Body	Primary Classification:		Class SB		
	Supplemental Classification:		Swamp Waters (Sw)		(NSW)
Other Stream Classification:					
Impairments:					
Aquatic T&E Species?	Yes	Comments: Atlantic sturgeon, shortnose sturgeon, west indian manatee, northern long-eared bat, tricolored bat, eastern black rail, red knot, RCW, others.			
NRTR Stream ID:			Buffer Rules in Effect:	Neuse	
Project Includes Bridge Spanning Water Body?	Yes	Deck Drains Discharge Over Buffer?	No	Dissipator Pads Provided in Buffer?	No
Deck Drains Discharge Over Water Body?	No	(If yes, provide justification in the General Project Narrative)		(If yes, describe in the General Project Narrative; if no, justify in the General Project Narrative)	
(If yes, provide justification in the General Project Narrative)					
Surface Water Body (2):			NCDWR Stream Index No.:		
NCDWR Surface Water Classification for Water Body	Primary Classification:				
	Supplemental Classification:				
Other Stream Classification:					
Impairments:					
Aquatic T&E Species?		Comments:			
NRTR Stream ID:			Buffer Rules in Effect:		
Project Includes Bridge Spanning Water Body?		Deck Drains Discharge Over Buffer?		Dissipator Pads Provided in Buffer?	
Deck Drains Discharge Over Water Body?		(If yes, provide justification in the General Project Narrative)		(If yes, describe in the General Project Narrative; if no, justify in the General Project Narrative)	
(If yes, provide justification in the General Project Narrative)					
Surface Water Body (3):			NCDWR Stream Index No.:		
NCDWR Surface Water Classification for Water Body	Primary Classification:				
	Supplemental Classification:				
Other Stream Classification:					
Impairments:					
Aquatic T&E Species?		Comments:			
NRTR Stream ID:			Buffer Rules in Effect:		
Project Includes Bridge Spanning Water Body?		Deck Drains Discharge Over Buffer?		Dissipator Pads Provided in Buffer?	
Deck Drains Discharge Over Water Body?		(If yes, provide justification in the General Project Narrative)		(If yes, describe in the General Project Narrative; if no, justify in the General Project Narrative)	
(If yes, provide justification in the General Project Narrative)					

09/08/25

TIP PROJECT: BR-0173

CONTRACT:

See Sheet 1A For Index of Sheets
See Sheet 1B For Conventional Symbols

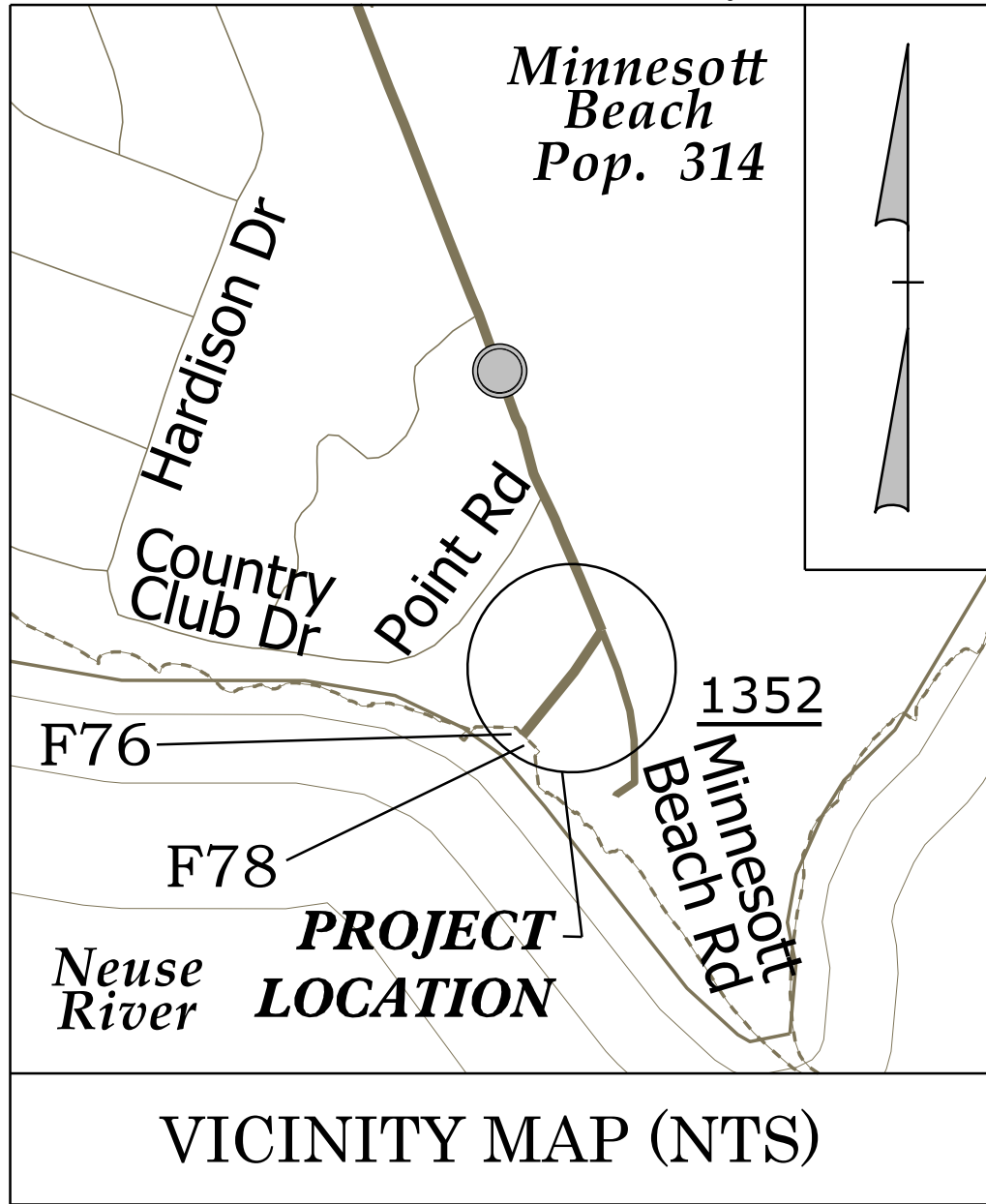

FI PLANS

STATE OF NORTH CAROLINA DIVISION OF HIGHWAYS

PAMLICO COUNTY

LOCATION: *REPLACE BRIDGE 680078 ON NC306 FERRY OVER NEUSE RIVER*

TYPE OF WORK: *GRADING, PAVING, DRAINAGE, AND STRUCTURES (BRIDGE).*

PERMIT DRAWING
SHEET 1 OF 5

DATE: 4/29/2025

STATE	STATE PROJECT REFERENCE NO.	SHEET NO.	TOTAL SHEETS
N.C.	BR-0173	11	
STATE PROJ. NO.	F. A. PROJ. NO.	DESCRIPTION	
67173.1.1		PE	
67173.2.1		R/W	
67173.3.1		CONST.	

WETLAND AND SURFACE WATER IMPACTS PERMIT

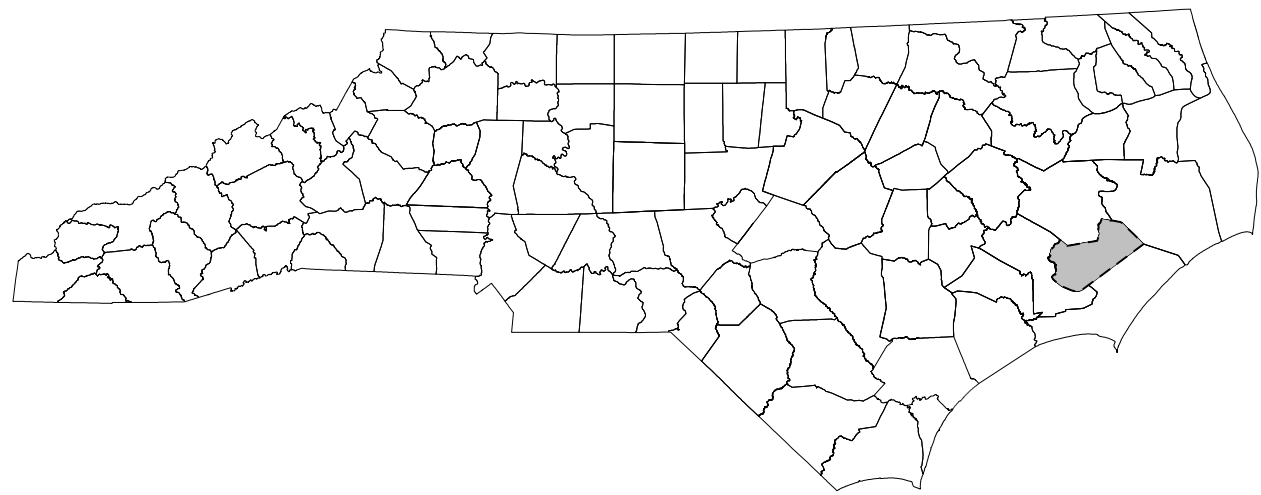
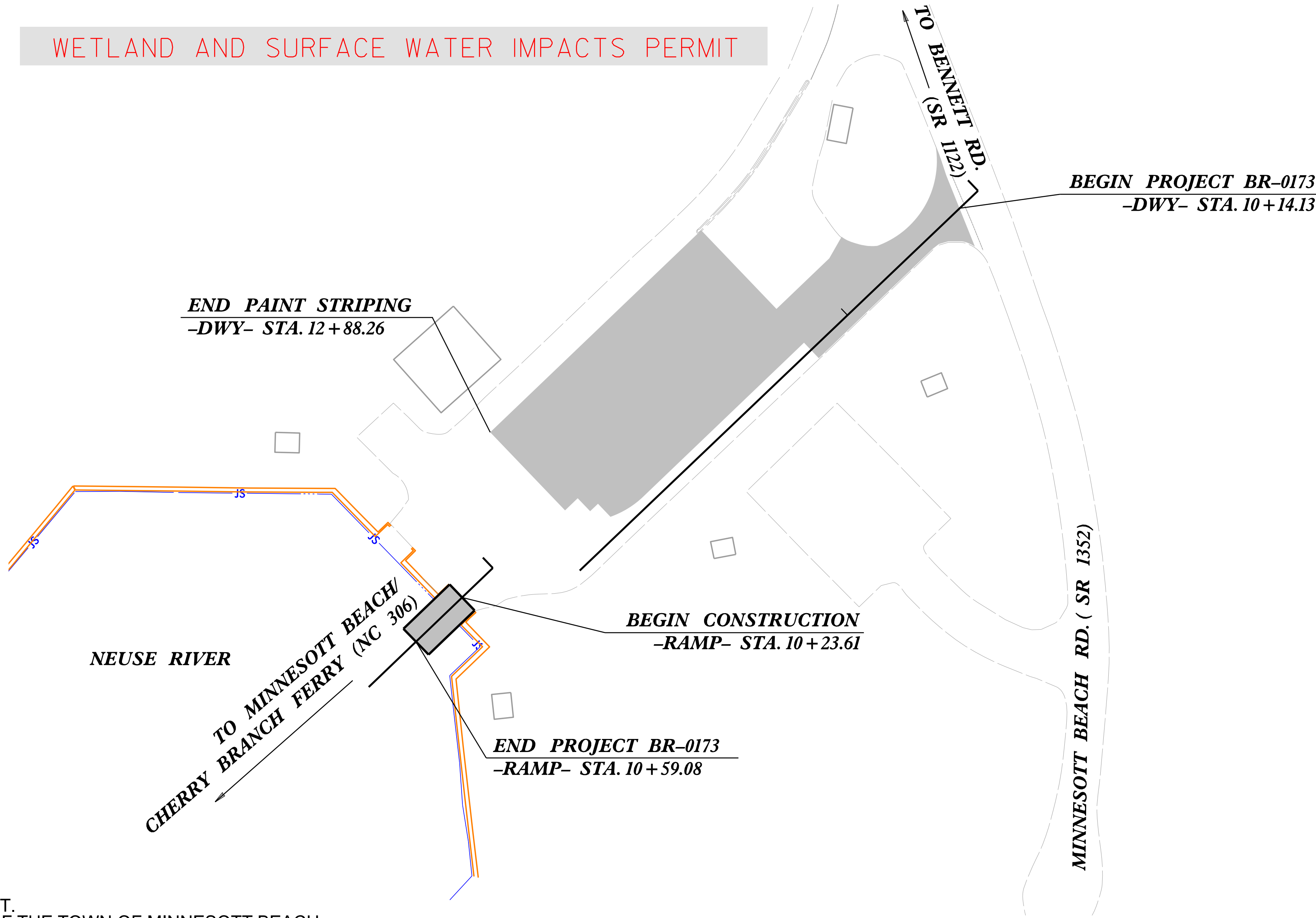

THERE IS NO CONTROL OF ACCESS ON THIS PROJECT.
THIS PROJECT IS WITHIN THE MUNICIPALITY LIMITS OF THE TOWN OF MINNESOTT BEACH.
CLEARING ON THIS PROJECT SHALL BE PERFORMED TO THE LIMITS ESTABLISHED BY MODIFIED METHOD III.

GRAPHIC SCALES

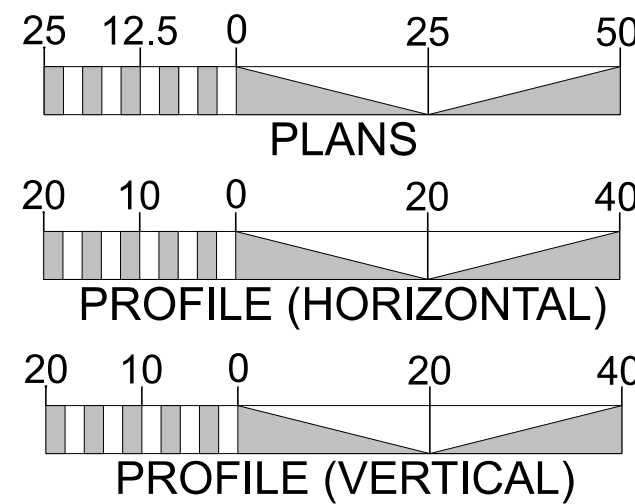

PROJECT LENGTH

LENGTH ROADWAY TIP PROJECT BR-0173 = 0.052 MILES

LENGTH STRUCTURES TIP PROJECT BR-0173 = 0.007 MILES

TOTAL LENGTH TIP PROJECT BR-0173 = 0.059 MILES

PREPARED IN THE OFFICE OF:

RS&H

8521 SIX FORKS ROAD, SUITE 400
RALEIGH, NC 27615
NC FIRM LICENSE No: F-0493

FOR THE NORTH CAROLINA DEPARTMENT OF TRANSPORTATION

2024 STANDARD SPECIFICATIONS

RIGHT OF WAY DATE:
JULY 1, 2025

LETTING DATE:
JANUARY 20, 2026

SEAN KORTOVICH, PE
PROJECT ENGINEER

ALLISON HARRIS, PE
PROJECT DESIGN ENGINEER

ALEX FOSTER, PE
NCDOT CONTACT

HYDRAULICS ENGINEER

SIGNATURE: P.E.

ROADWAY DESIGN ENGINEER

SIGNATURE: P.E.

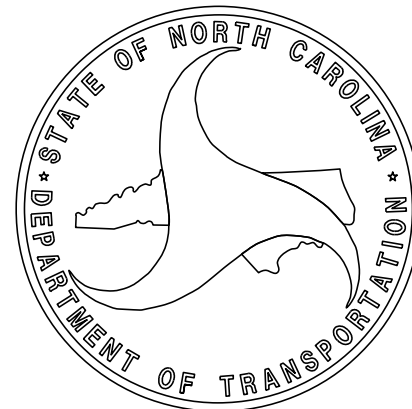

INCOMPLETE PLANS
DO NOT USE FOR R/W ACQUISITION

DOCUMENT NOT CONSIDERED FINAL
UNLESS ALL SIGNATURES COMPLETED

SURFACE WATER IMPACTS

TEMPORARY SURFACE WATER IMPACTS

PERMIT DRAWING
SHEET 2 OF 5

DATE: 4/29/2025

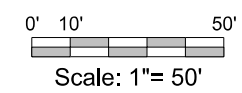

BR-0173

004

NORTH CAROLINA
DEPARTMENT OF TRANSPORTATION
PAMLICO COUNTY

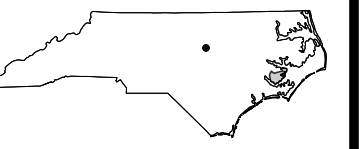

ROADWAY DESIGN UNIT

ROADWAY DESIGN
ENGINEER

DOCUMENT NOT CONSIDERED FINAL
UNLESS ALL SIGNATURES COMPLETED

HYDRAULICS
ENGINEER

INCOMPLETE PLANS
DO NOT USE FOR R/W ACQUISITION

GUNGATE DESIGN GROUP, P.A.



REVISIONS

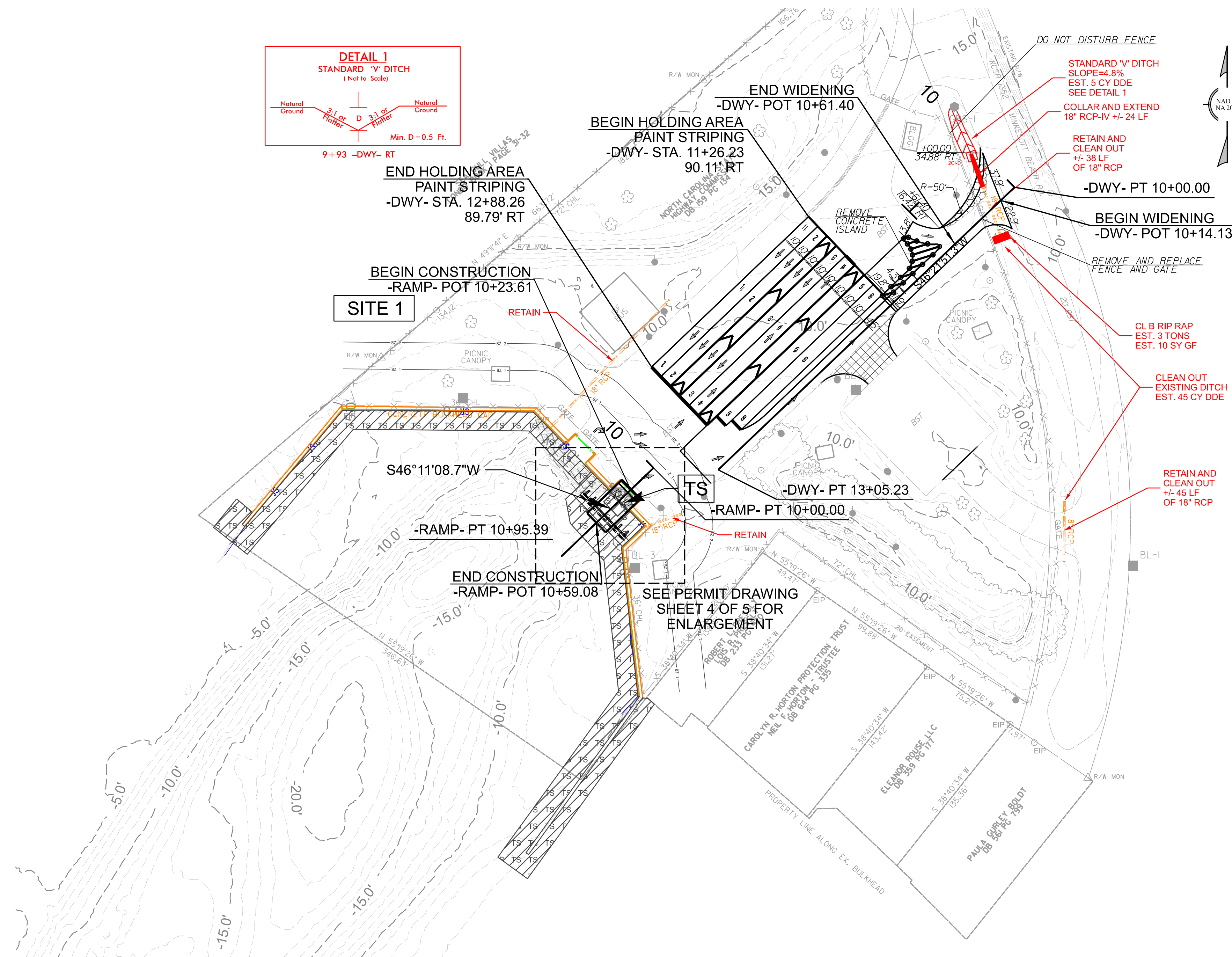



SURFACE WATER IMPACTS



TEMPORARY SURFACE WATER IMPACTS

PERMIT DRAWING
SHEET 3 OF 5

DATE: 4/29/2025

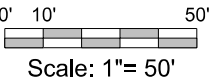

BR-0173

004

NORTH CAROLINA
DEPARTMENT OF TRANSPORTATION
PAMLICO COUNTY

ROADWAY DESIGN UNIT
ROADWAY DESIGN
ENGINEER

DOCUMENT NOT CONSIDERED FINAL
UNLESS ALL SIGNATURES COMPLETED

HYDRAULICS
ENGINEER

INCOMPLETE PLANS
DO NOT USE FOR R.W. ACQUISITION

SUNGATE DESIGN GROUP, P.A.

600 POWER FRANKLIN ROAD
DURHAM, NORTH CAROLINA 27605
TEL: 919.286.1000
WWW.SUNGATEDESIGN.COM
EIN: 27-0870000

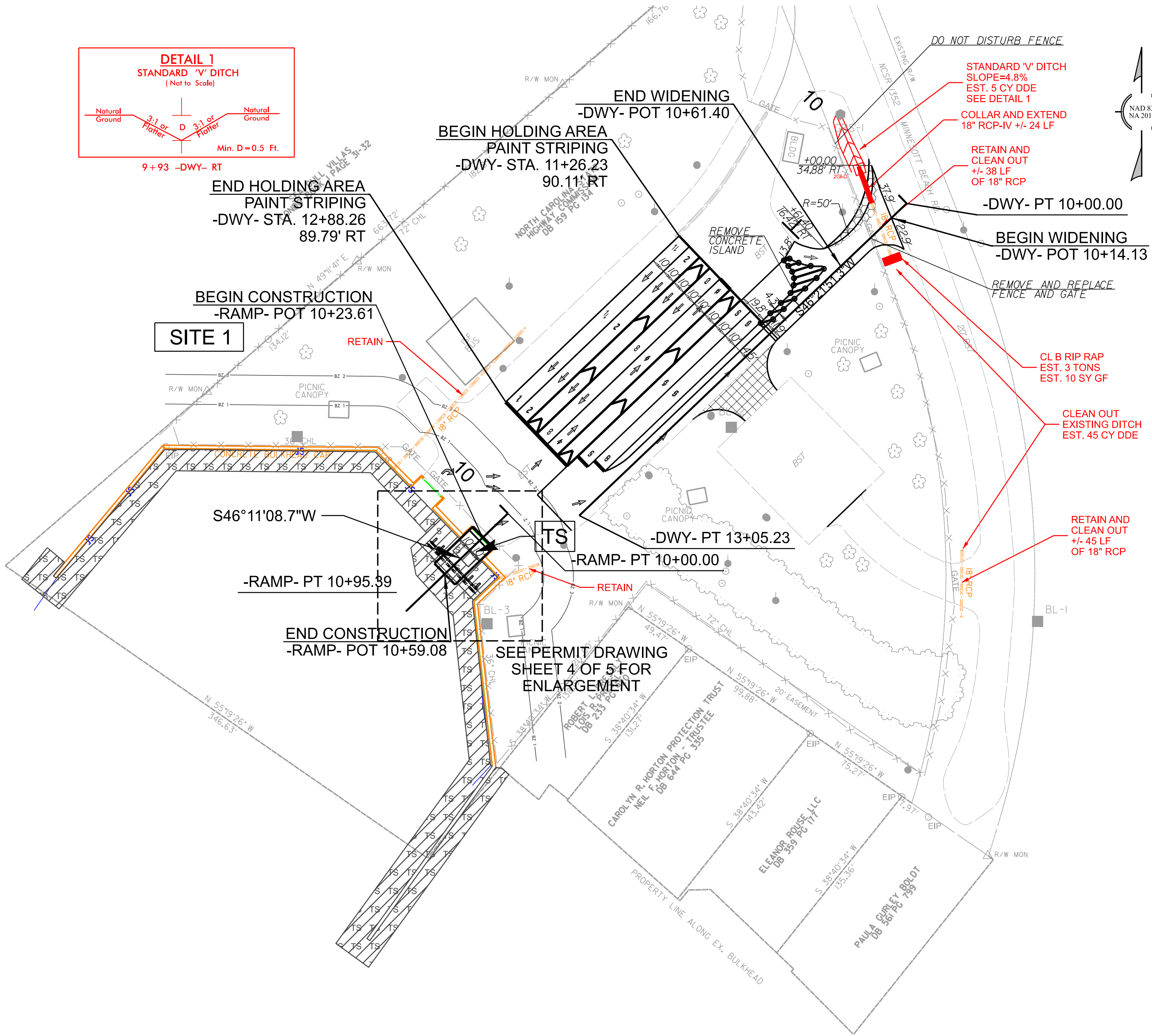

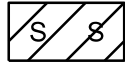

SURFACE WATER IMPACTS

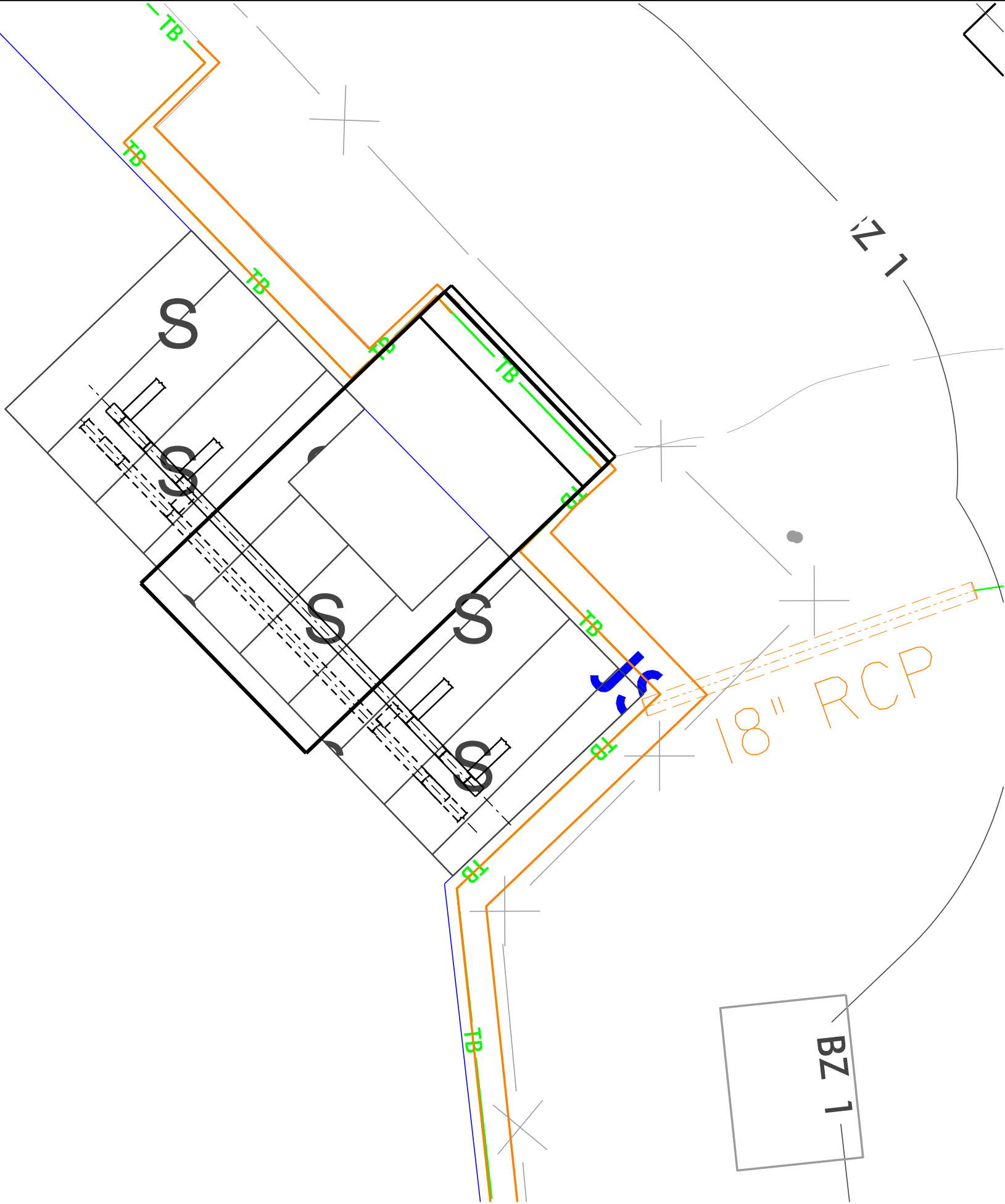

PERMIT DRAWING
SHEET 4 OF 5

DATE: 4/29/2025



Scale: 1"= 10'



BR-0173

004-2

NORTH CAROLINA
DEPARTMENT OF TRANSPORTATION
PAMLICO COUNTY



ROADWAY DESIGN UNIT
ROADWAY DESIGN
ENGINEER

DOCUMENT NOT CONSIDERED FINAL
UNLESS ALL SIGNATURES COMPLETED

HYDRAULICS
ENGINEER

INCOMPLETE PLANS
DO NOT USE FOR R.O.W. ACQUISITION

SUNGATE DESIGN GROUP, P.A.



REVISIONS

WETLAND AND SURFACE WATER IMPACTS SUMMARY

			WETLAND IMPACTS					SURFACE WATER IMPACTS				
Site No.	Station (From/To)	Structure Size / Type	Permanent Fill In Wetlands (ac)	Temp. Fill In Wetlands (ac)	Excavation in Wetlands (ac)	Mechanized Clearing in Wetlands (ac)	Hand Clearing in Wetlands (ac)	Permanent SW impacts (ac)	Temp. SW impacts (ac)	Existing Channel Impacts Permanent (ft)	Existing Channel Impacts Temp. (ft)	Natural Stream Design (ft)
1		Floating Turbidity Curtain							0.26		295	
1		Proposed Lift Gate and Ten 2' Diameter Piles						0.03		56		
TOTALS*:								0.03	0.26	56	295	0

*Rounded totals are sum of actual impacts

NOTES:

NC DEPARTMENT OF TRANSPORTATION
 DIVISION OF HIGHWAYS

4/29/25

PAMLICO

BR-0173

BR-0173

SHEET 5 OF 5

SHEET 5 OF 5

SHEET 5 OF 5

SHEET 5 OF 5

09/08/25

TIP PROJECT: BR-0173

CONTRACT:

See Sheet 1A For Index of Sheets
See Sheet 1B For Conventional Symbols

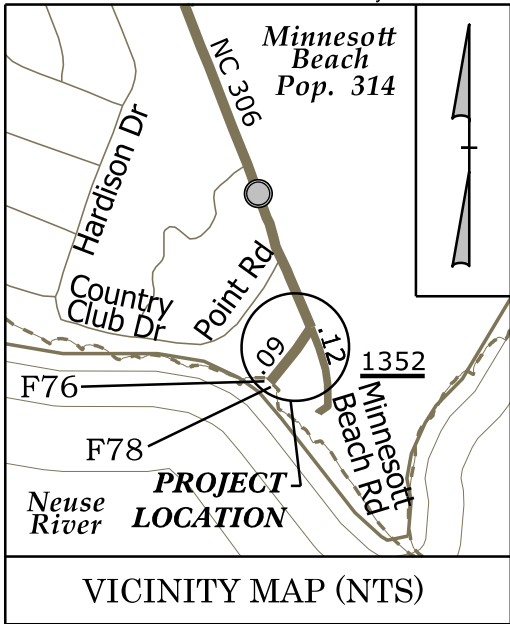

FI PLANS

STATE OF NORTH CAROLINA DIVISION OF HIGHWAYS PAMLICO COUNTY

LOCATION: *REPLACE BRIDGE 680078 ON NC306 FERRY OVER NEUSE RIVER*
TYPE OF WORK: *GRADING, PAVING, DRAINAGE, AND STRUCTURES (BRIDGE).*

BUFFER IMPACTS PERMIT

**BUFFER DRAWING
SHEET 1 OF 3**
DATE: 4/28/2025

STATE	STATE PROJECT REFERENCE NO.	SHEET NO.	TOTAL SHEETS
N.C.	BR-0173	11	
STATE PROJ. NO.	F. A. PROJ. NO.	DESCRIPTION	
67173.1.1		PE	
67173.2.1		R/W	
67173.3.1		CONST.	

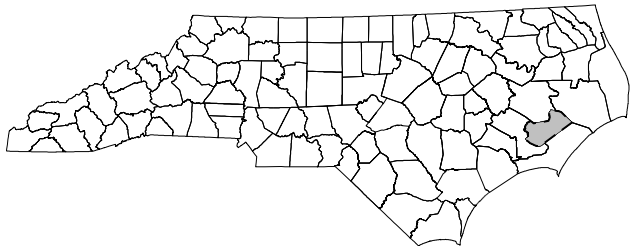
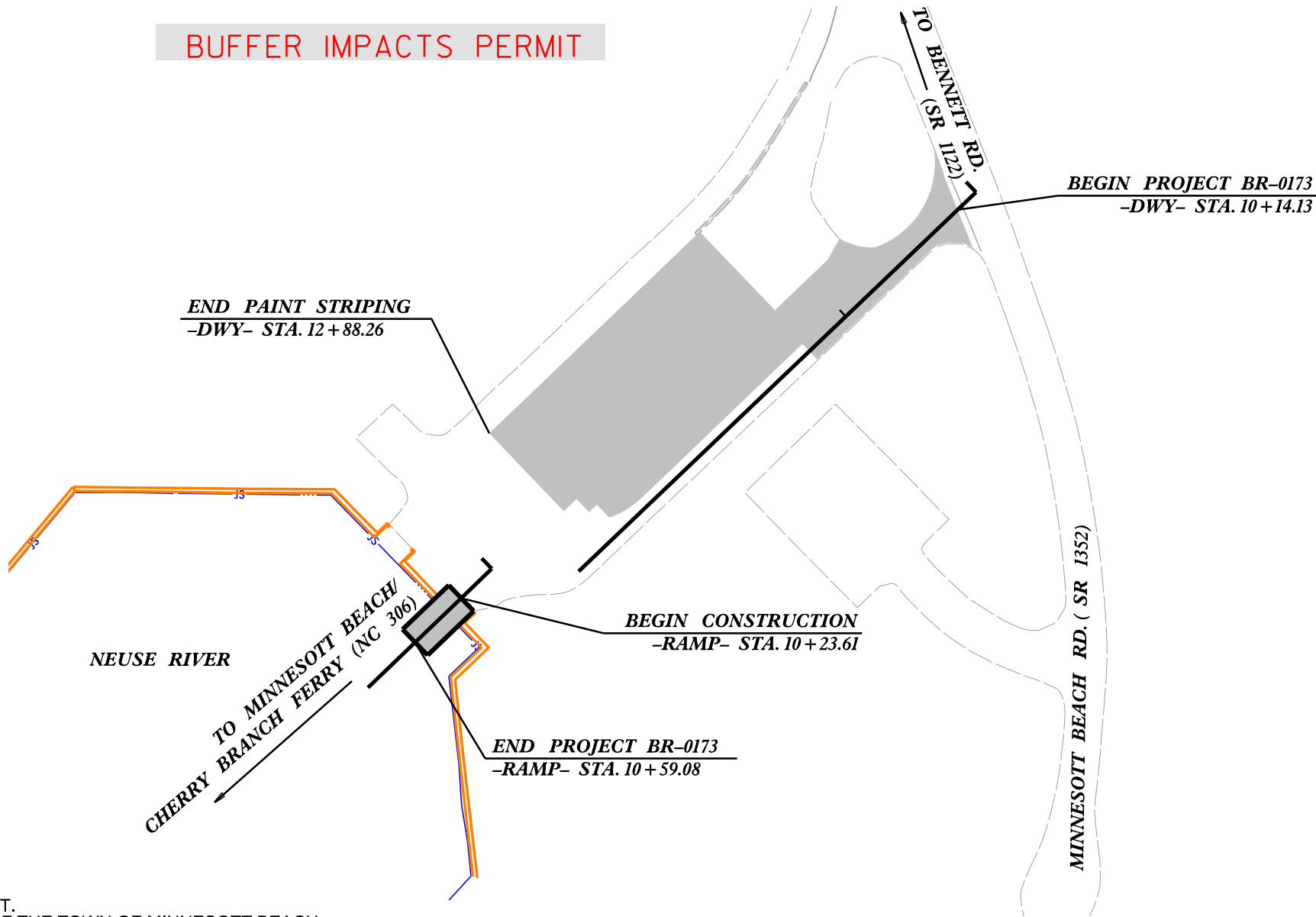

THERE IS NO CONTROL OF ACCESS ON THIS PROJECT.
THIS PROJECT IS WITHIN THE MUNICIPALITY LIMITS OF THE TOWN OF MINNESOTT BEACH.
CLEARING ON THIS PROJECT SHALL BE PERFORMED TO THE LIMITS ESTABLISHED BY MODIFIED METHOD III.

GRAPHIC SCALES

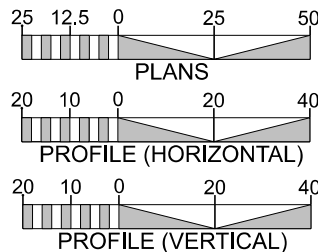

PROJECT LENGTH

LENGTH ROADWAY TIP PROJECT BR-0173 = 0.052 MILES
LENGTH STRUCTURES TIP PROJECT BR-0173 = 0.007 MILES
TOTAL LENGTH TIP PROJECT BR-0173 = 0.059 MILES

PREPARED IN THE OFFICE OF:

RS&H

8521 SIX FORKS ROAD, SUITE 400
RALEIGH, NC 27615
NC FIRM LICENSE No: F-0493

FOR THE NORTH CAROLINA DEPARTMENT OF TRANSPORTATION

2024 STANDARD SPECIFICATIONS

RIGHT OF WAY DATE:
JULY 1, 2025

LETTING DATE:
JANUARY 20, 2026

SEAN KORTOVICH, PE
PROJECT ENGINEER

ALLISON HARRIS, PE
PROJECT DESIGN ENGINEER

ALEX FOSTER, PE
NCDOT CONTACT

HYDRAULICS ENGINEER

SIGNATURE: P.E.

ROADWAY DESIGN ENGINEER

SIGNATURE: P.E.

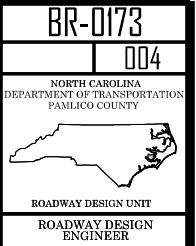

INCOMPLETE PLANS
DO NOT USE FOR R/W ACQUISITION
DOCUMENT NOT CONSIDERED FINAL
UNLESS ALL SIGNATURES COMPLETED

HYDRAULICS
ENGINEER

15/05/2014



885 JONES FRANKLIN ROAD
RALEIGH, NORTH CAROLINA 27606
TEL: (919) 893-2263
ENG. FIRM LICENSE NO. C-890

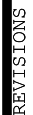

RIPARIAN BUFFER IMPACTS SUMMARY

			IMPACTS									BUFFER REPLACEMENT	
Site No.	Station (From/To)	Structure Size / Type	TYPE			ALLOWABLE			MITIGABLE				
			ROAD CROSSING	BRIDGE	PARALLEL IMPACT	ZONE 1 (ft²)	ZONE 2 (ft²)	TOTAL (ft²)	ZONE 1 (ft²)	ZONE 2 (ft²)	TOTAL (ft²)	ZONE 1 (ft²)	ZONE 2 (ft²)
1		Roadway						0					
TOTALS*:						0	0	0	0	0	0	0	0

NOTES:

NC DEPARTMENT OF TRANSPORTATION
DIVISION OF HIGHWAYS
4-28-2025
PAMLICO
BR-0173
BR-0173
SHEET 3 OF 3

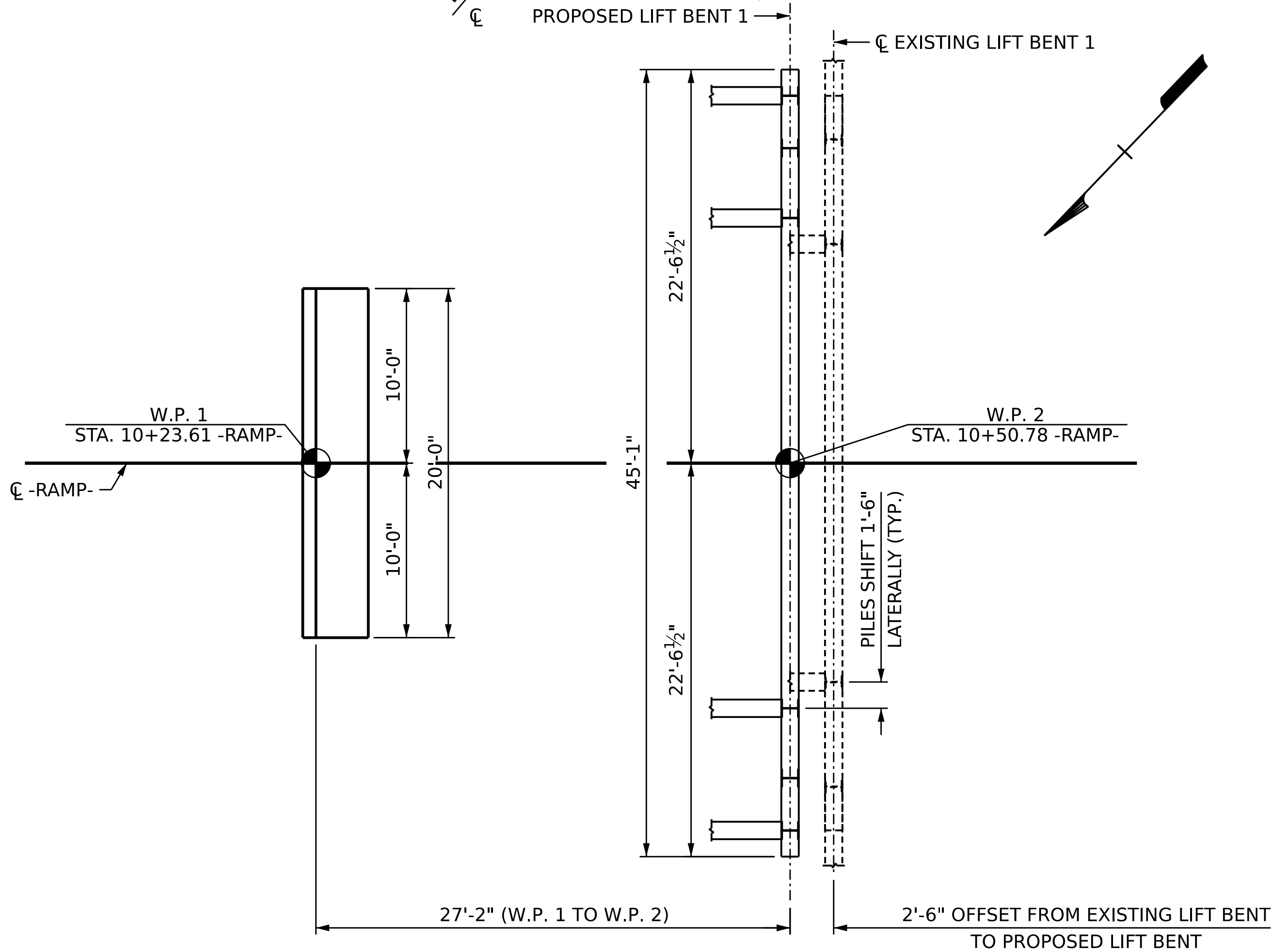
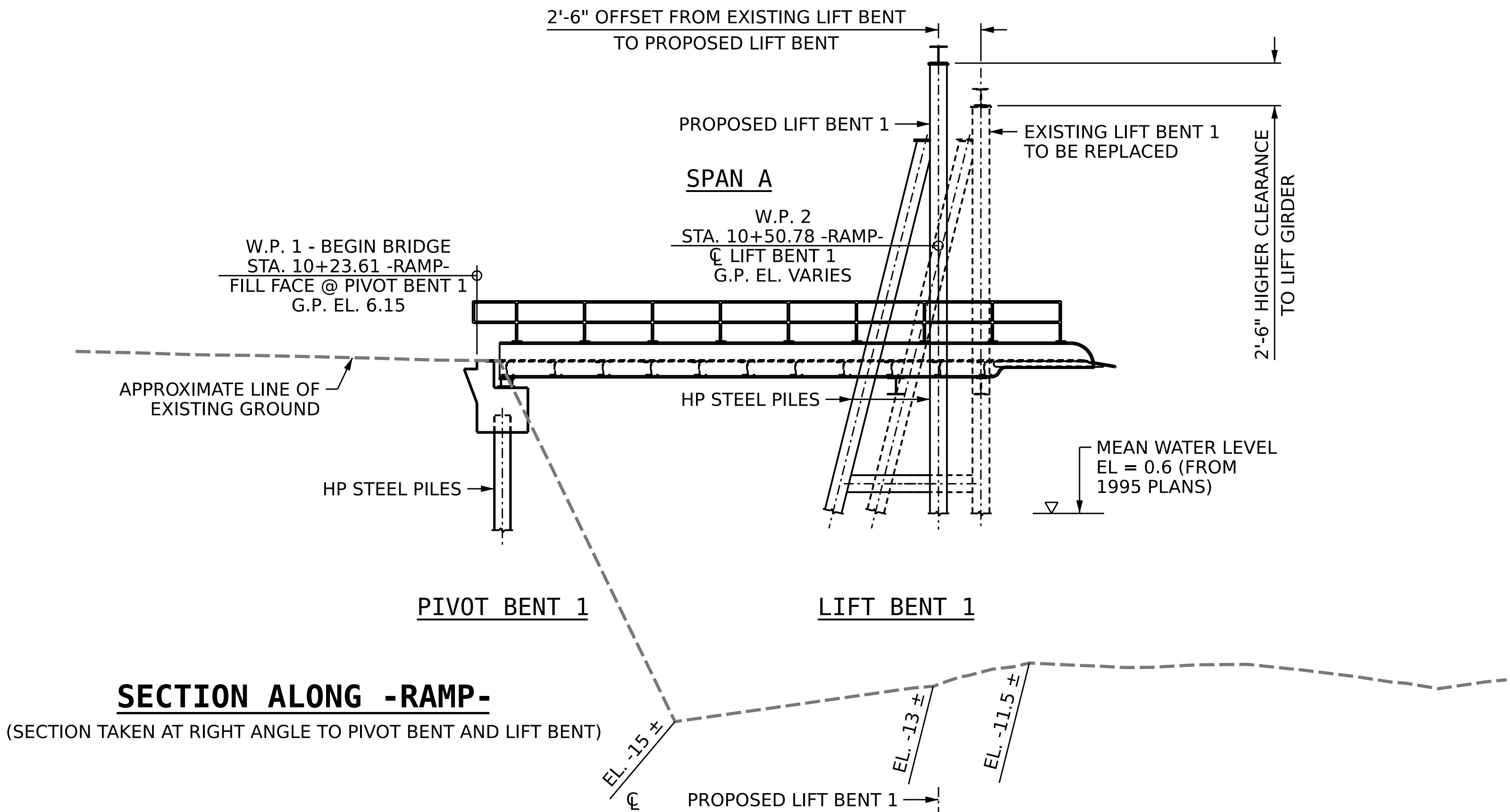

PROJECT NO. **BR-0173**
PAMLICO COUNTY
STATION: **10+23.61 -RAMP-**

SHEET 1 OF 3 BRIDGE NO. 680078

STATE OF NORTH CAROLINA
DEPARTMENT OF TRANSPORTATION
RALEIGH
PRELIMINARY
GENERAL DRAWING
FOR BRIDGE ON NC 306
FERRY OVER NEUSE RIVER

DRAWN BY : P. N. DRYE DATE : 3-10-25
CHECKED BY : V. D. KOLLIPARA DATE : 3-10-25
DESIGN ENGINEER OF RECORD: V. D. KOLLIPARA DATE : 3-10-25

4/23/2025
c:\work\dir\ncdot-pw.bentley.com.ncdot-pw-01\philip drye\d0135358\401_001_BR0173_SMU_PGD_S1-01_680078.dgn
pdrye

H&H
Hardesty & Hanover, LLP
3100 Smoketree Court, Suite 1005
Raleigh, North Carolina 27604
Phone: 919-896-7428
License #: F-0277

DOCUMENT NOT CONSIDERED
FINAL UNLESS ALL
SIGNATURES COMPLETED

REVISIONS					SHEET NO.
NO.	BY:	DATE:	NO.	BY:	
1			3		S1-01
2			4		TOTAL SHEETS 3

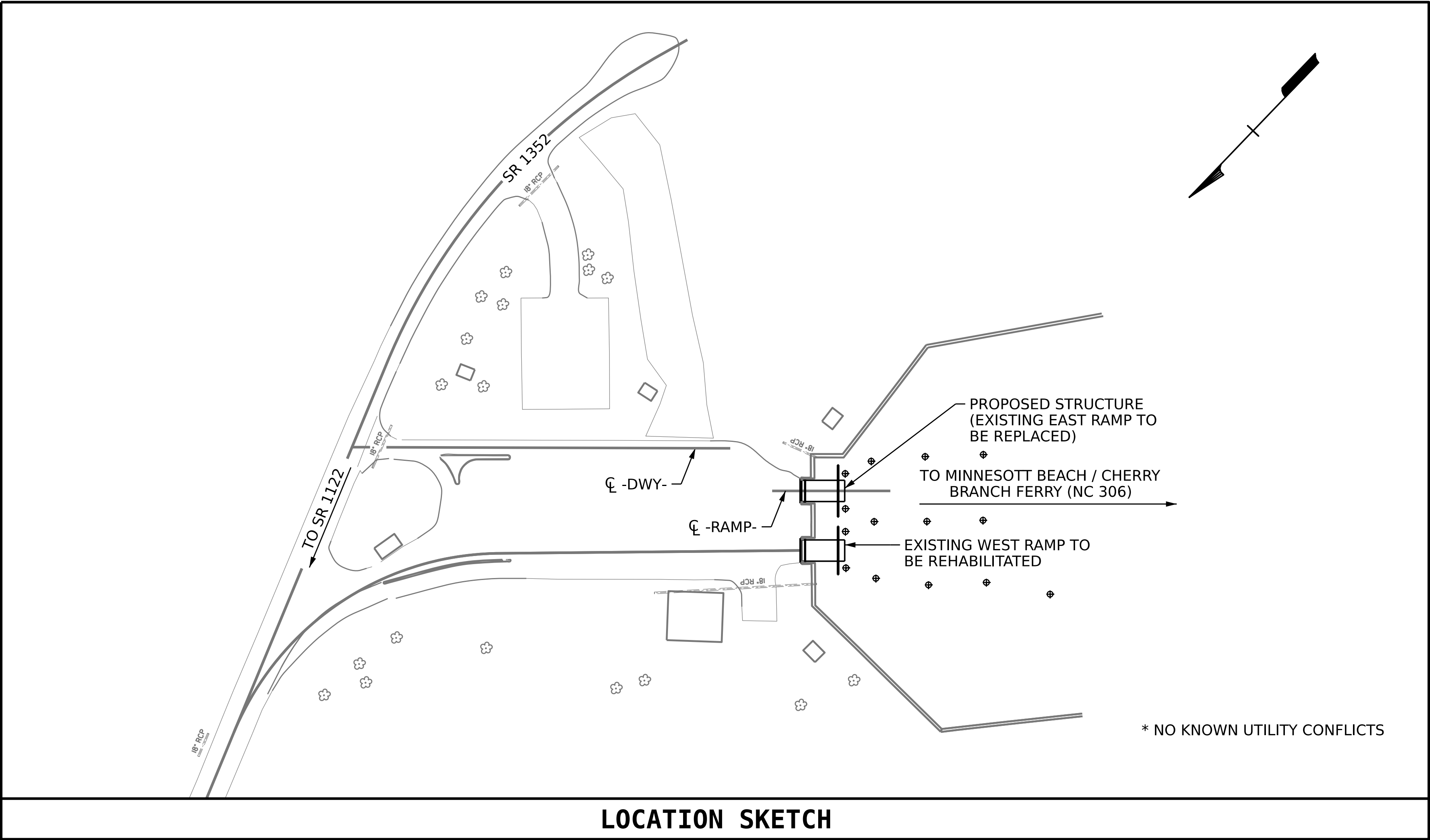

GENERAL NOTES:

ASSUMED LIVE LOAD = HL-93 OR ALTERNATE LOADING.

THIS BRIDGE HAS BEEN DESIGNED IN ACCORDANCE WITH THE REQUIREMENTS OF THE AASHTO LRFD BRIDGE DESIGN SPECIFICATIONS.

THIS BRIDGE IS LOCATED IN SEISMIC ZONE 1.

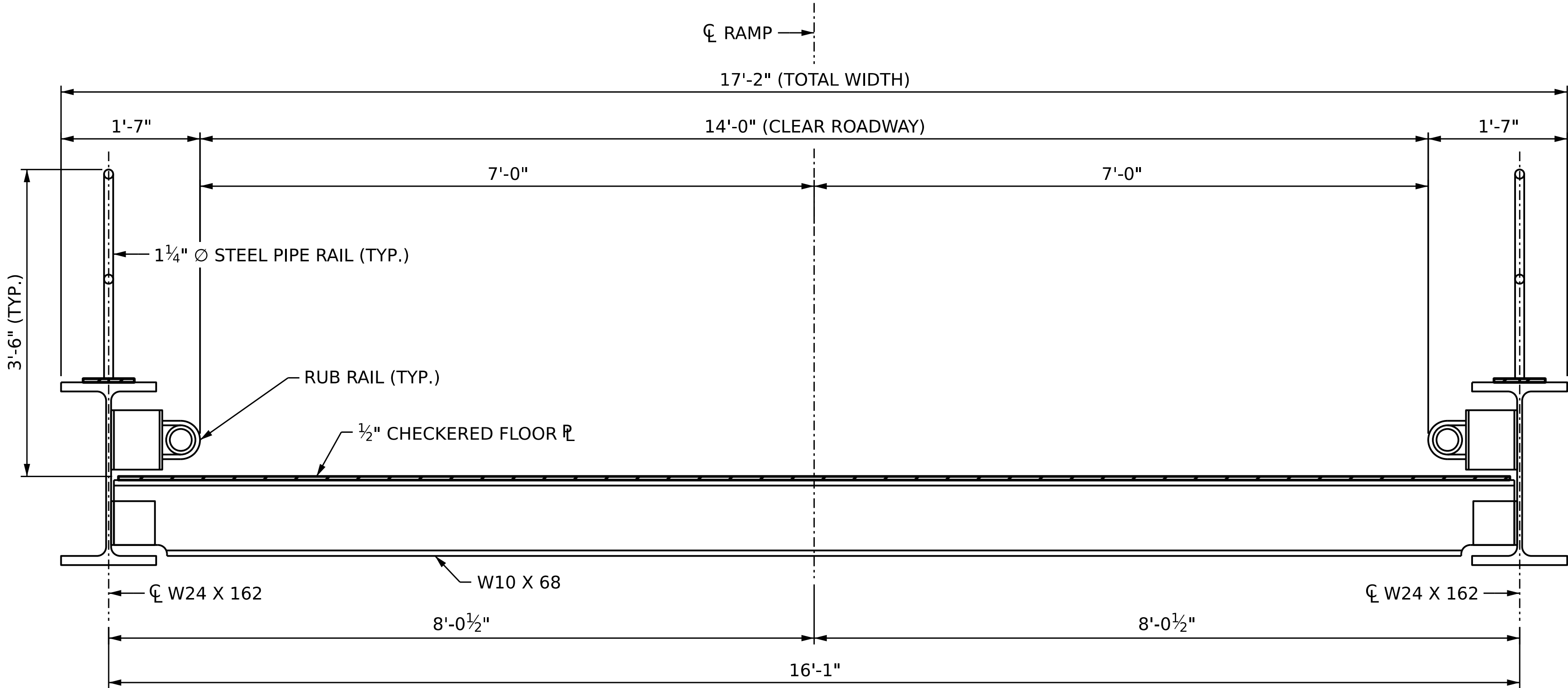

PROJECT NO. **BR-0173**
PAMLICO COUNTY
STATION: **10+23.61 -RAMP-**

SHEET 2 OF 3

STATE OF NORTH CAROLINA DEPARTMENT OF TRANSPORTATION RALEIGH						
PRELIMINARY						
GENERAL DRAWING						
FOR BRIDGE ON NC 306 FERRY OVER NEUSE RIVER						
REVISIONS						SHEET NO.
NO.	BY:	DATE:	NO.	BY:	DATE:	S1-02
1			3			TOTAL SHEETS
2			4			3

DRAWN BY : P. N. DRYE DATE : 3-10-25
CHECKED BY : V. D. KOLLIPARA DATE : 3-10-25
DESIGN ENGINEER OF RECORD: V. D. KOLLIPARA DATE : 3-10-25

ONE SIMPLE SPAN NON-CONTINUOUS STEEL FLOOR
PLATE ON STEEL FLOORBEAMS AND STEEL I-BEAMS



Hardesty & Hanover, LLP
3100 Smoketree Court, Suite 1005
Raleigh, North Carolina 27604
Phone: 919-896-7428
License #: F-0277

DOCUMENT NOT CONSIDERED
FINAL UNLESS ALL
SIGNATURES COMPLETED

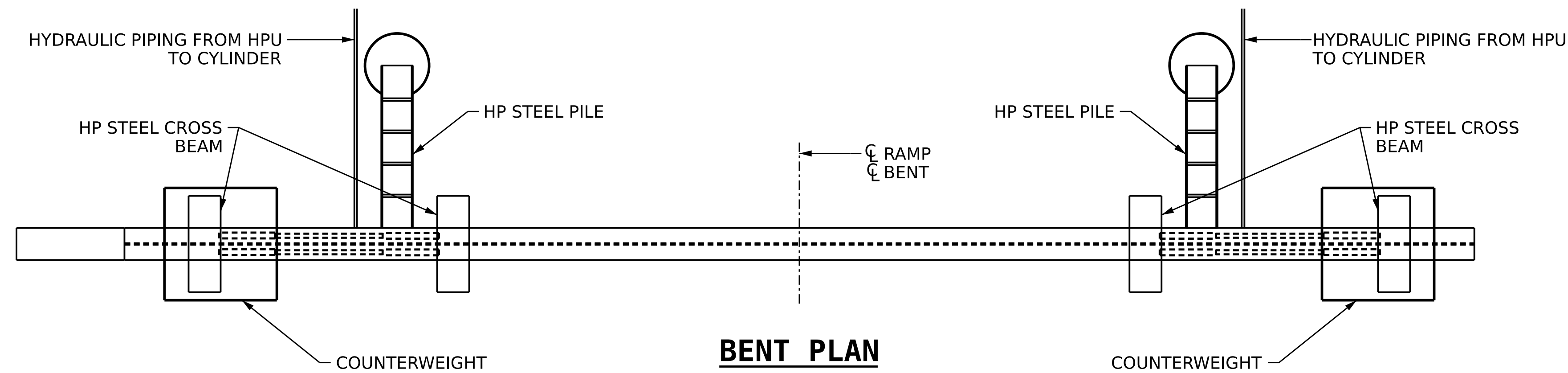
**GENERAL NOTES:**

THE HPU SHALL BE LOCATED ON THE SHORE BETWEEN THE TWO RAMPS. HYDRAULIC PIPING SHALL BE ROUTED FROM THE HPU TO THE CYLINDERS.

RAMP MACHINERY SHALL MEET THE REQUIREMENTS OF AASHTO MOVABLE HIGHWAY BRIDGE DESIGN.

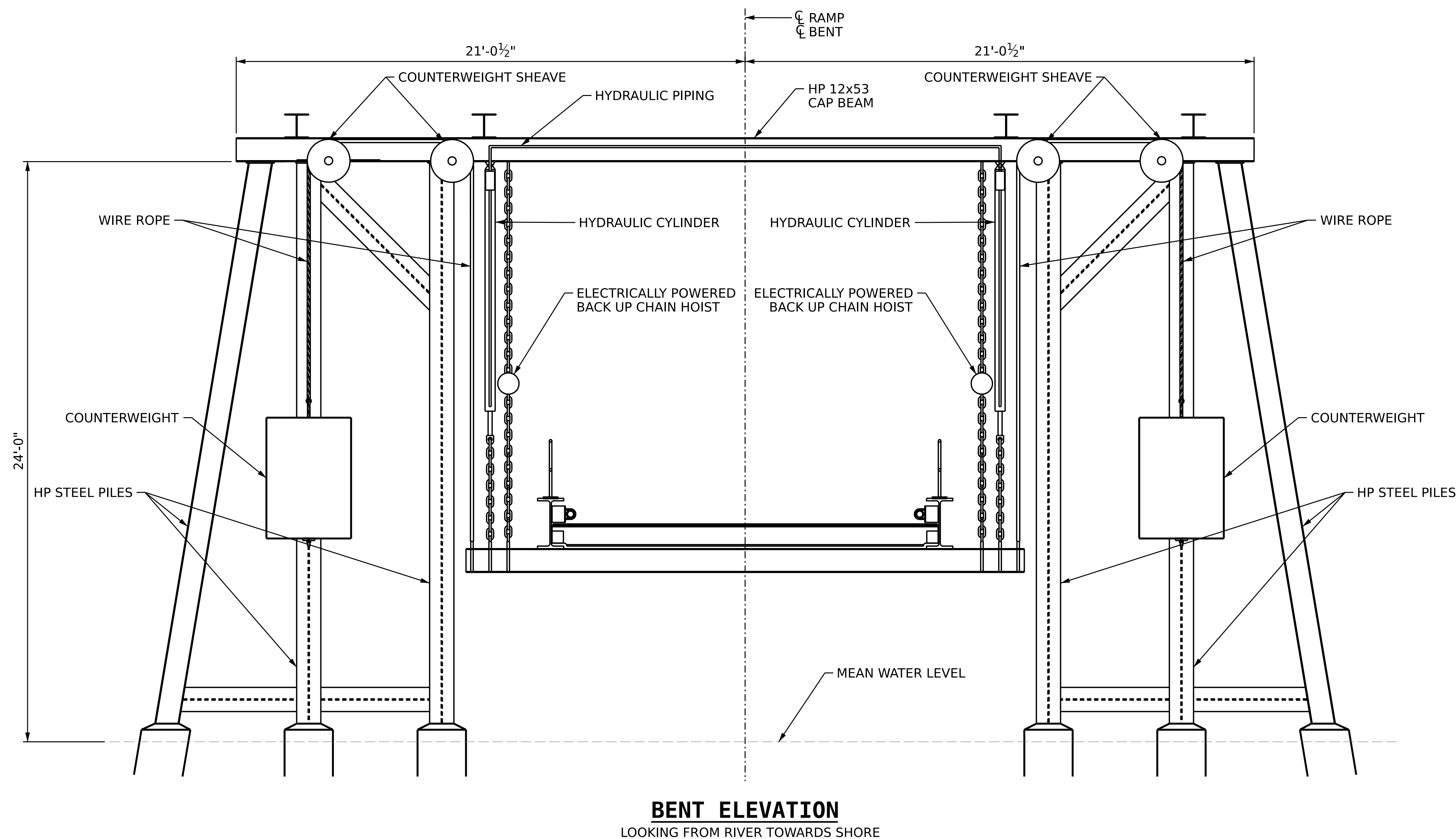
PROJECT NO. **BR-0173****PAMLICO** COUNTYSTATION: **10+23.61 -RAMP-**

SHEET 3 OF 3

STATE OF NORTH CAROLINA
DEPARTMENT OF TRANSPORTATION
RALEIGHPRELIMINARY
GENERAL DRAWINGFOR BRIDGE ON NC 306
FERRY OVER NEUSE RIVER

DRAWN BY : J. R. GENTILE DATE : 3-25-25
 CHECKED BY : D. N. WIGGINS DATE : 3-25-25
 DESIGN ENGINEER OF RECORD: J. R. GENTILE DATE : 3-25-25

3/25/2025
 c:\workdir\ncdot-pw.bentley.com\ncdot-pw-01\james_gentile\d0135358\401.005_BR0173_SMU_PGD_S1-03.680078.dgn
 jgentile

H&H
 Hardesty & Hanover, LLP
 3100 Smokefree Court, Suite 1005
 Raleigh, North Carolina 27604
 Phone: 919-896-7428
 License #: F-0277

DOCUMENT NOT CONSIDERED
 FINAL UNLESS ALL
 SIGNATURES COMPLETED

REVISIONS					SHEET NO.
NO.	BY:	DATE:	NO.	BY:	
1			3		S1-03
2			4		TOTAL SHEETS 3